

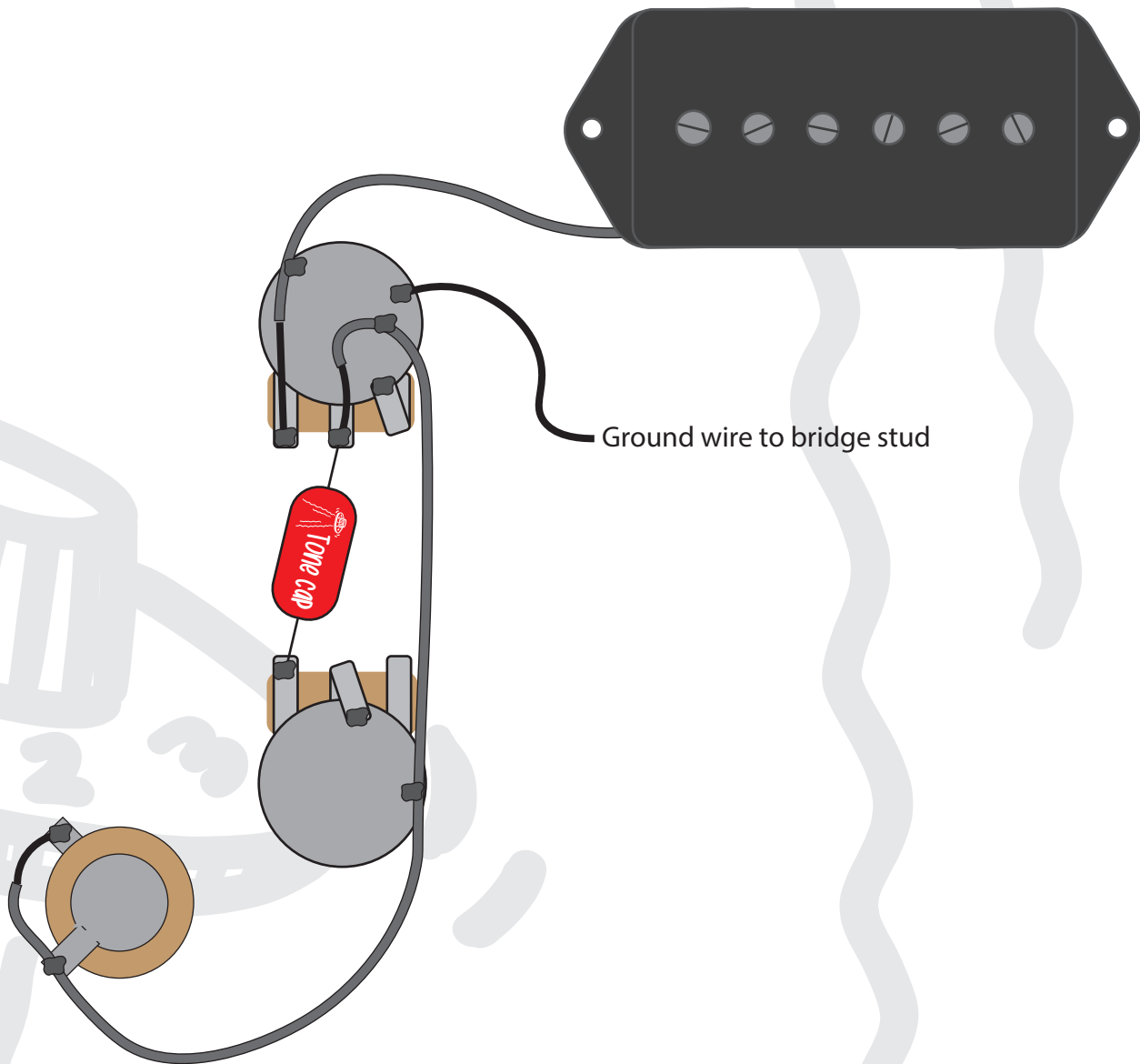

Guitar Type | Les Paul Junior Double Cut
Pickup Configuration | One P90
Volumes | 1x Master Volume
Tones | 1x Master Tone
Switch | N/A
Orientation | Right Handed
Additional items | 50's style wiring



This diagram has been drawn with traditional 2 conductor braided pickup wires in mind. If your pickup is different to this, then please refer to that manufacturer's wire colour coding prior to installing.

Important note

Please take care of yourself and your guitar when carrying out any guitar wiring work.

James' Home of Tone cannot be held responsible for any damage or injury caused by dangerous or incorrect techniques used. If possible, support your local businesses and have your trusted local guitar tech carry out your re-wire!

Imagery is copyright of James' Home of Tone 2023.