

Toekick Cap

NOTES ✓

- ▶ TKC dimension: $\frac{3}{4}$ " x 4" x $\frac{3}{4}$ "
- ▶ Sold in pairs.

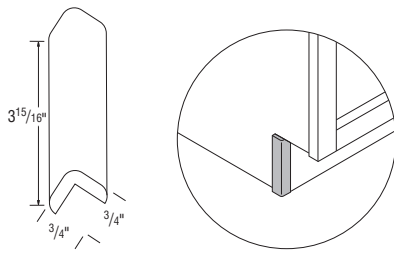

TKC

Exterior Shelves

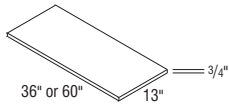

WSS36 (2/ctn.)
WSS60 (2/ctn.)

Shelf	Description	Size (T x W x D)	Edge Finish	Color Side 1	Color Side 2	Finish
WSS36	Wall System Shelves	$\frac{3}{4}$ " x 36" x 13"	1 Long	Exterior	Exterior	Veneer
WSS60	Wall System Shelves	$\frac{3}{4}$ " x 60" x 13"	1 Long	Exterior	Exterior	Veneer

Bookshelf Kit

NOTES ✓

- ▶ Recommended for use with Bookcase units where loads on shelves will exceed over 60 lbs.
- ▶ One Shelf Kit required per shelf.
- ▶ When ordered in a Rustic Birch style, will not feature rustic characteristics.

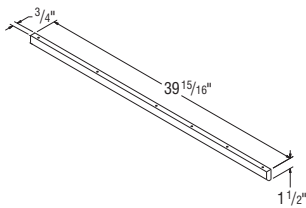

BKSHELFKIT*

*Order under door style number.

Appliance Centers (Under Wall Cabinet Accessory)

NOTES ✓

- ▶ AC2417.5 is designed to be used between countertop and Diagonal Wall cabinet.
- ▶ AC2417.5 designed to fit under DC24.
- ▶ AC2417.5 opening – 12" W x 14½" H.
- ▶ ACS1817.5 opening – 13" W x 14½" H.
- ▶ ACS2417.5 opening – 19" W x 14½" H.
- ▶ ACS3017.5 opening – 25" W x 14½" H.

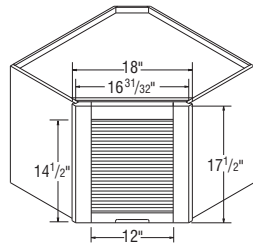

Diagonal
AC2417.5

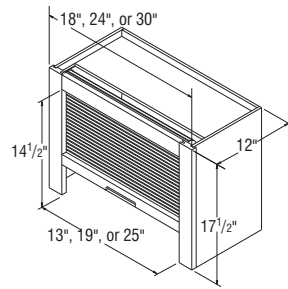

Straight
ACS1817.5
ACS2417.5
ACS3017.5

Stem Glass Holders (Under Wall Cabinet Accessory)

NOTES ✓

- ▶ Designed to be mounted underneath a standard Wall cabinet.
- ▶ SGH30 holds 7 rows.
- ▶ SGH36 holds 9 rows.
- ▶ SGH30 - space between rails is 1 11/32" wide.
- ▶ SGH36 - space between rails is 1 1/18" wide.

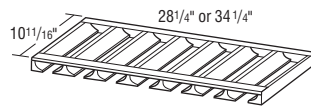

SGH30
SGH36

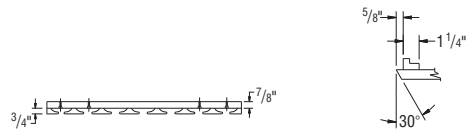

Side View

Organizer Shelves (Under Wall Cabinet Accessory)

NOTES ✓

- ▶ Designed to mount underneath Wall cabinet.
- ▶ Top, bottom, and sides are finished.

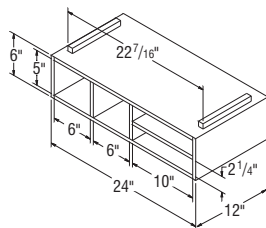

ORG24

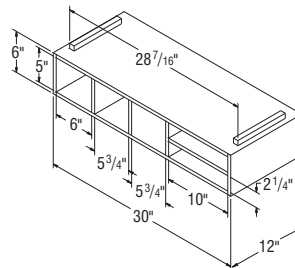

ORG30

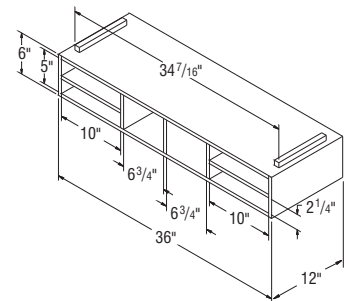

ORG36

Stem Glass Holders (Wall Open Cabinet Accessory)

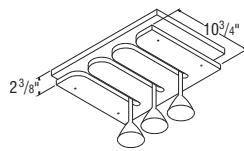

SGH18
SGH21

NOTES ✓

- ▶ One 3/4" thick matching Aristex™ shelf mounted to each Stem Glass Holder.
- ▶ Stem Glass Holder is installed by placing shelf in position with included shelf clips.
- ▶ SGH18 fits 18" wide Wall cabinets.
- ▶ SGH21 fits 21" wide Wall cabinets.



Wall Spice Racks (Wall Cabinet Accessory)

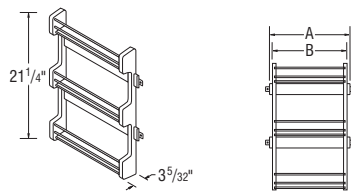

SRD15
SRD18
SRD21

NOTES ✓

- ▶ Natural wood finish with chrome bars.
- ▶ Designed for Wall cabinets (30", 36", and 42" high), Base cabinets, Utility cabinets, and Linen Closet cabinets. Make sure to avoid interference with Roll Trays, full-depth shelves, or other interior cabinet accessories.
- ▶ Mounts to door frame with provided screws.
- ▶ Order under style #010.

DESIGN SOLUTIONS

- ▶ Great for use in the bathroom to hold vitamins, medications, etc.



Model	Recommended	A Dimension	B Dimension
SRD15	15" or 30" wide	10 1/2"	9 1/2" wide
SRD18	18" or 36" wide	13 1/2"	12 1/2" wide
SRD21	21" or 42" wide	16 1/2"	15 1/2" wide

NOTES ✓

- ▶ PDO includes 8 wooden posts and board.
- ▶ PDOPOSTS includes 4 wooden posts.
- ▶ Pegged board is 3/8" thick.
- ▶ Recommended for use in DB36, DB36-4, DBFP36, and DBFP36-4. Pegged board can be trimmed for use in smaller applications.
- ▶ Order under style #010.

Pegged Dish Organizer (Drawer Accessory)

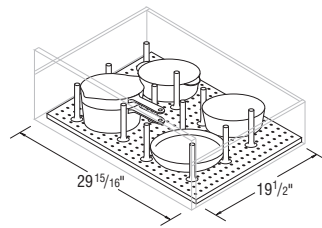

PDO



PDOPOSTS



NOTES ✓

- ▶ Place a cabinet with a PCDT or WCDDT next to the dishwasher for convenience.
- ▶ PCDT - plastic.
- ▶ WCDDT - wood.
- ▶ PCDT is designed to fit in the Particle Board (PABD) drawer box only.
- ▶ The WCDDT can be cut to fit either wood or Particle Board (PABD) drawer boxes.

Wood and Plastic Cutlery Tray

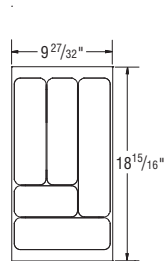

PCDT15

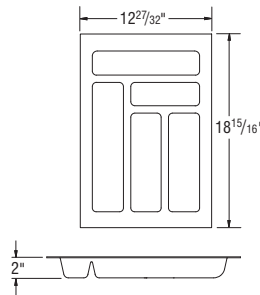

PCDT18

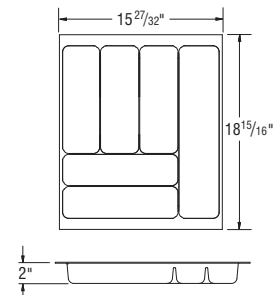

PCDT21

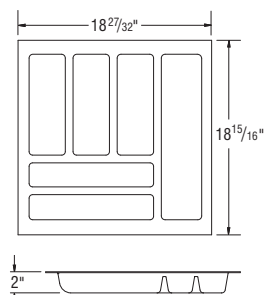

PCDT24

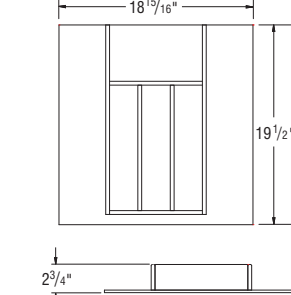

WCDDT



SKU	Width	Depth	Usage Details
PCDT15	9 27/32"	18 15/16"	Designed to be used in 12 7/8" wide Particle Board Drawer Boxes.
PCDT18	12 27/32"	18 15/16"	Designed to be used in 15 7/8" wide Particle Board Drawer Boxes.
PCDT21	15 27/32"	18 15/16"	Designed to be used in 18 7/8" wide Particle Board Drawer Boxes.
PCDT24	18 27/32"	18 15/16"	Designed to be used in 21 7/8" wide Particle Board Drawer Boxes.
WCDDT	18 15/16"	19 1/2"	Designed to fit in all wood drawer boxes. Can be trimmed to fit in Particle Board Drawer Boxes.

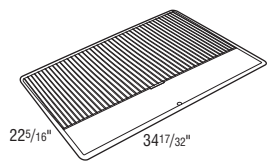

CABMAT36

- ▶ Designed to capture spills and is removable for cleaning.
- ▶ Will contain a spill of up to 3 quarts (2.8 liters).
- ▶ CABMAT36 is not trimmable.

Glass Shelf Kits, 12" Deep

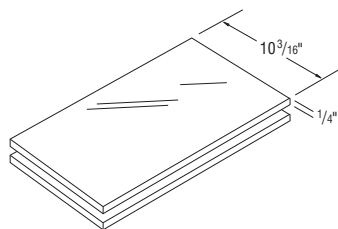

- GSK1512**
- GSK1812**
- GSK2112**
- GSK2412**
- GSK3012**
- GSK3612**

- ▶ Meets KCMA standards of 15 lbs. per square foot.
- ▶ Cannot be trimmed.
- ▶ Kit includes two 1/4" thick tempered glass shelves and shelf clips.
- ▶ Order under style #010.



Glass Shelf Kits, Diagonal

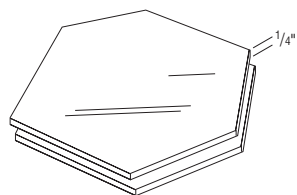

Fits DC...24
GSKDC24

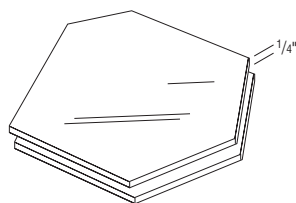

Fits DC...27
GSKDC27

- ▶ Meets KCMA standards of 15 lbs. per square foot.
- ▶ Cannot be trimmed.
- ▶ Kit includes two 1/4" thick tempered glass shelves and shelf clips.
- ▶ Order under style #010.



NOTES ✓

- ▶ Sold in pairs.
- ▶ Used to deflect heat from self-cleaning ovens, away from cabinet doors and drawer fronts.
- ▶ Includes installation screws.
- ▶ White finish.
- ▶ For use on cabinets next to an oven/range when an additional $\frac{1}{8}$ " cannot be added to the oven manufacturer's recommended space requirement between the oven and each adjacent cabinet.
- ▶ Cabinet door cannot be hinged on the same side as the angled heat shield, not compatible with double door cabinets.
- ▶ Installs on the front of the face frame of each cabinet adjacent to the oven.



Heat Shield, Angled

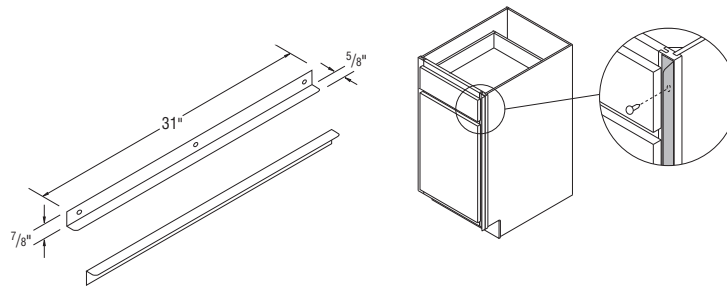

HEATSHIELDAN

NOTES ✓

- ▶ Sold in pairs.
- ▶ Used to deflect heat from self-cleaning ovens, away from cabinet doors and drawer fronts.
- ▶ Includes installation screws.
- ▶ White finish.
- ▶ For use on cabinets next to an oven/range when an additional $\frac{1}{8}$ " can be added to the oven manufacturer's recommended space requirement.
- ▶ Installs on the side of the face frame of each cabinet adjacent to the oven.



Heat Shield, Straight

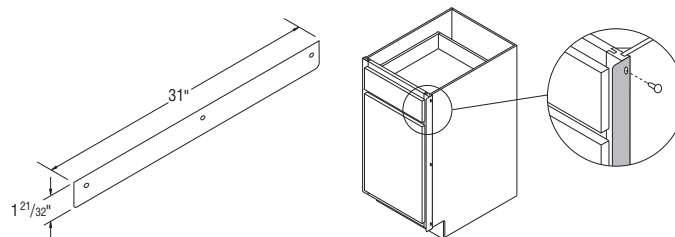

HEATSHIELDST

NOTES ✓

- ▶ Two metal brackets to support ovens and microwaves.
- ▶ Designed to be used with OCSD, OD, and OMS cabinets.
- ▶ Cabinet not included.
- ▶ Order under style #010.



Oven Installation Kit

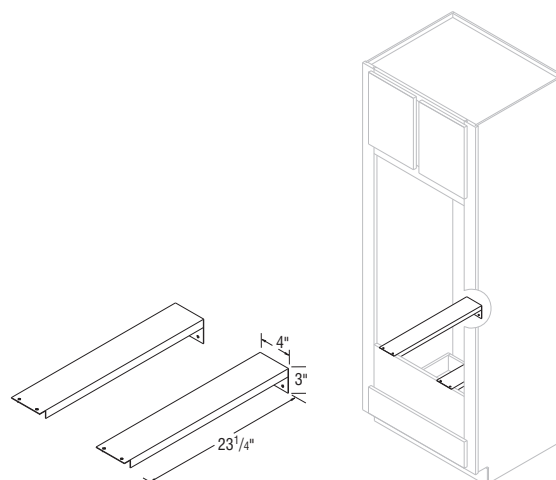

OCINSTALLKIT

PRODUCT CODES

Dimensions

Natural Maple Laminate

White Laminate

Plywood

Fits 12" Deep

Fits 24" Deep

Utility Shelf Kits

UKS15	13½" x 22½"	✓			✓
UKS18	16½" x 22½"	✓			✓
UKS24	22½" x 22½"	✓			✓
UKS30	28½" x 22½"	✓			✓
UKS36	34½" x 22½"	✓			✓
UKS1512	13½" x 10 ¹¹ / ₃₂ "	✓		✓	
UKS1812	16½" x 10 ¹¹ / ₃₂ "	✓		✓	
UKS2412	22½" x 10 ¹¹ / ₃₂ "	✓		✓	
UKS3012	28½" x 10 ¹¹ / ₃₂ "	✓		✓	
UKS3612	34½" x 10 ¹¹ / ₃₂ "	✓		✓	
UKS15PL	13½" x 22½"	✓	✓		✓
UKS18PL	16½" x 22½"	✓	✓		✓
UKS24PL	22½" x 22½"	✓	✓		✓
UKS30PL	28½" x 22½"	✓	✓		✓
UKS36PL	34½" x 22½"	✓	✓		✓
UKS1512PL	13½" x 10 ¹¹ / ₃₂ "	✓	✓	✓	
UKS1812PL	16½" x 10 ¹¹ / ₃₂ "	✓	✓	✓	
UKS2412PL	22½" x 10 ¹¹ / ₃₂ "	✓	✓	✓	
UKS3012PL	28½" x 10 ¹¹ / ₃₂ "	✓	✓	✓	
UKS3612PL	34½" x 10 ¹¹ / ₃₂ "	✓	✓	✓	

NOTES ✓

- ▶ Utility Shelf Kits contain two shelves and eight clips.
- ▶ Shelves are ¾" thick.
- ▶ Maximum weight per square foot is 15 lbs.
- ▶ Utility Shelf Kits are natural maple laminate.
- ▶ Order under style #010.

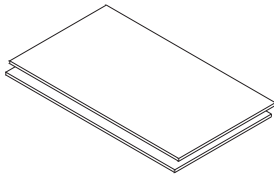

Utility Shelf Kit Shelves

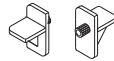

Utility Shelf Kit Clips

Pantry Roll Tray Kit

NOTES ✓

- ▶ Pantry Roll Tray Kits feature 1/2" thick solid wood front and furniture board sides and back.
- ▶ Pantry Roll Tray Kits contain four trays, eight suspension tracks, and eight bumper pads with installation screws.
- ▶ Maximum weight per square foot is 15 lbs.
- ▶ Pantry Roll Tray Kits cannot be used in any Utility cabinet 12" deep.
- ▶ Order under style #010.
- ▶ Smart Stop™ Pantry Roll Tray Kits are not available.

DESIGN SOLUTIONS

- ▶ Shelf or Roll Tray Kits can be used to convert a standard Utility cabinet into a Pantry.

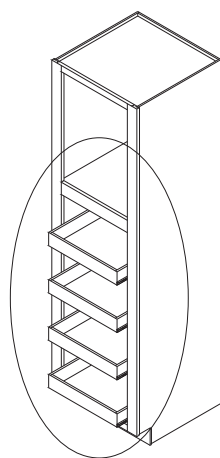

Pantry Roll Tray Kit

- UPK15**
- UPK18**
- UPK24**
- UPK30**
- UPK36**

Model	Dimensions	Natural Maple Laminate	Thickness
UPK15	10 ¹ / ₁₆ " x 20 ³ / ₁₆ "	✓	3 ¹ / ₈ "
UPK18	13 ¹ / ₁₆ " x 20 ³ / ₁₆ "	✓	3 ¹ / ₈ "
UPK24	19 ¹ / ₁₆ " x 20 ³ / ₁₆ "	✓	3 ¹ / ₈ "
UPK30	25 ¹ / ₁₆ " x 20 ³ / ₁₆ "	✓	3 ¹ / ₈ "
UPK36	31 ¹ / ₁₆ " x 20 ³ / ₁₆ "	✓	3 ¹ / ₈ "

NOTES ✓

- ▶ Roll Tray Kits feature 1/2" thick solid wood front and furniture board sides and back.
- ▶ Maximum weight per square foot is 15 lbs.
- ▶ All guides are white.
- ▶ Order under style #010.
- ▶ See Storage Accessories Matrix on pages 182 & 183.
- ▶ Bumper pads for field installation included.
- ▶ Smart Stop™ Roll Tray Kits are not available.

DESIGN SOLUTIONS

- ▶ An additional Roll-Out Tray can be installed above the Base cabinet half-depth shelf.



Roll Tray Kits

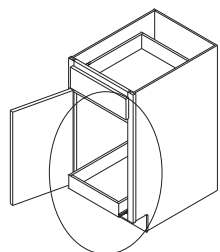

- TKIT15**
- TKIT18**
- TKIT21**
- TKIT24**
- TKIT27**
- TKIT30**
- TKIT33**
- TKIT36**
- TKIT39**
- TKIT45**

Model	Recommended Width of Face Frame Opening	Trays	Track Sliders	Mounting Blocks	2 1/2" Wood Screws	5/8" Wood Screws	1/8" Spacers
TKIT15	12"	1	2	2	2	4	2
TKIT18	15"	1	2	2	2	4	2
TKIT21	18"	1	2	2	2	4	2
TKIT24	21"	1	2	2	2	4	2
TKIT27	24"	1	2	2	2	4	2
TKIT30	27"	1	2	2	2	4	2
TKIT33	30"	1	2	2	2	4	2
TKIT36	33"	1	2	2	2	4	2
TKIT39	16 1/2"	2	4	4	2	8	2
TKIT45	19 1/2"	2	4	4	2	8	2

Chrome Tray Divider Kit

DESIGN SOLUTIONS

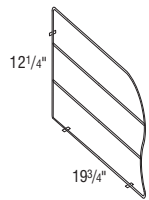

CTDK

- ▶ Not recommended in BMD...FH, BMD...FHB, BPG...FH, BPG...FHB.
- ▶ Includes 1 divider, 3 clips.
- ▶ Tray divider is chrome wire.

Roll Tray Bumper Pad

NOTES ✓

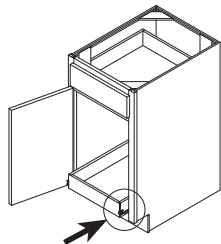

RTBP

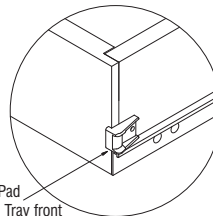

Place Bumper Pad on edge of Roll Tray front on top of Roll Tray Slide.

- ▶ RTBP includes two bumpers and two screws for installation.
- ▶ Used to protect door from roll tray corners.
- ▶ Included with roll tray cabinets and with roll tray kits.
- ▶ Can be retrofitted to all roll trays.
- ▶ Order under style #010.



Double Wastebasket Roll-Out Kit

NOTES ✓

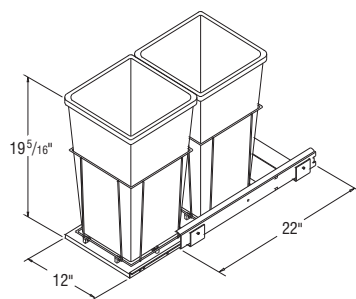

DWBR*

*Fits 15" wide Base cabinet.

- ▶ White epoxy coated wire with Full Extension guides (non Smart Stop™).
- ▶ Includes two 27 quart Wastebaskets with wire storage compartment.
- ▶ Mounted on white melamine board and installs to floor of cabinet.
- ▶ Order under style #010.
- ▶ Installation of this accessory requires removing half-depth shelf. See matrix on pages 182 & 183 for installation recommendations.



NOTES ✓

- ▶ Pulls to add to the false front must be ordered separately.
- ▶ If STOTs are used on a full overlay style, it is recommended that a pull be used.
- ▶ STOT30WHB & STOT36WHB are for cabinets with one false front.
- ▶ Two white trays, 2¹/₄" deep.
- ▶ Order under style #010.
- ▶ See Storage Accessory Matrix on pages 182 & 183.

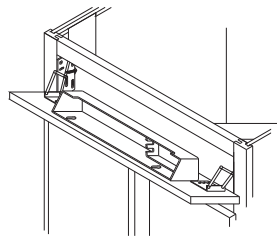

Sink Tip-Out Trays

STOT30WHB
STOT36WHB

Model	Cabinet Width	Description
STOT30WHB	30"	two 11 ¹ / ₂ " white trays, 2 hinges
STOT36WHB	36"	two 14 ¹ / ₂ " white trays, 2 hinges

NOTES ✓

- ▶ Creates a smooth and silent closing motion.
- ▶ Recommended usage per cabinet: 1 per door on any door with 2 hinges and 2 per door on any door with 3 or more hinges (cabinets under 36" high have 2 hinges, 36" and higher have 3 hinges). Additional units may be required when an accessory item is attached to the cabinet door.
- ▶ Not recommended for use on bi-fold doors or Base SuperCabinets™.



Smart Stop Door Mechanism

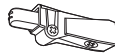

SSDM

Hinges

HINGE6WAY*
HINGE6WAYSC *

*Order under door style number.

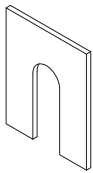
Frame Spacers



HNGSPCRF
HNGSPCRF50

NOTES ✓

- ▶ For use to provide additional door adjustment in field.
- ▶ Designed to be placed between the face frame and hinge mounting plate.
- ▶ HNGSPCRF sold in pairs.
- ▶ HNGSPCRF50 sold in packs of 50.
- ▶ Use to decrease gap between BUTT door - insert behind screw on face frame.

Hinge Spacers

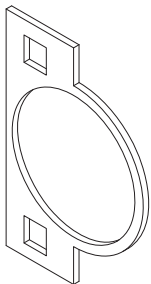

HNGSPCRD
HNGSPCRD50

NOTES ✓

- ▶ For use to provide additional door adjustment in field.
- ▶ Designed to be placed around the hinge cup and against the back of the door.
- ▶ HNGSPCRD sold in pairs.
- ▶ HNGSPCRD50 sold in packs of 50.
- ▶ Use to reduce appearance of a slight warp in a door - insert behind cup of hinge on door, opposite of warp.

Hinge Angle Restrictor Clips



HNGRESCLP

NOTES ✓

- ▶ For use in applications with cabinets installed at varying depths to prevent the door damage caused by opening into an adjacent cabinets.
- ▶ Restricts hinges to 86 degree opening capability.
- ▶ Not recommended for cabinets with roll trays specified in partial overlay styles.
- ▶ Sold in pairs.

NOTES ✓

- ▶ Order 1 pint of Toner for 1 quart of Stain.
- ▶ For white and antique styles, Touch-Up is only recommended for face frames and End Panels.
- ▶ Use Maple/Birch for Rustic finishes.



Stain, Toner, and Touch-Up

Touch-Up Kit

TUKIT*



Pint of Toner

TONERPT**

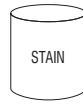

Quart of Stain

STAINPT**

Quart of Stain

STAINQT**

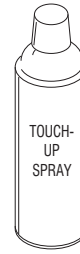

Touch-Up Spray Can

TUPSPRAY****

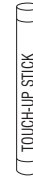

Touch-Up Stick

TUPSTICK***















*Touch-Up Kit contains one felt marker and one putty stick.

**TONEPT, STAINPT, and STAINQT are not available in Antique, Glacier Gray, Stone Gray, or White.

***Touch-Up Stick – when ordering TUPSTICK, a single putty stick in the selected color is sent.

****TUPSPRAY is a 13 oz. can (400 ml)

Wood Specie	Color	TONERPT Required	STAINPT or STAINQT Required
Cherry	Café	✓	✓
	Flagstone	✓	✓
	Java Glaze	✓	✓
	Pumpnickel Glaze	✓	✓
	Rouge	✓	✓
	Saddle	✓	✓
	Umber	✓	✓
	Wheat	•	✓
Hickory	Saddle	✓	✓
	Wheat	•	✓
Maple/Birch	Autumn	✓	✓
	Café	✓	✓
	Fawn	✓	•
	Flagstone	✓	✓
	Java Glaze	✓	✓
	Pumpnickel Glaze	✓	✓
	Rouge	✓	✓
	Saddle	✓	✓
	Sarsaparilla	✓	✓
Umber	✓	✓	
Oak	Saddle	✓	✓
	Sarsaparilla	✓	✓
	Umber	✓	✓
	Wheat	•	✓

	PRODUCT CODE	Item Description	Finish/Color	Drill Center
	H311 *	Pull 5 ² / ₃ "	Antique Pewter	128mm
	H312 *	Cup Pull 2 ¹ / ₂ "	Antique Pewter	64mm
	H313	Knob 1 ¹ / ₄ "	Antique Pewter	N/A
	H412 <i>New</i>	Pull 7 ⁵ / ₁₆ "	Brushed Pewter	160mm
	H413 <i>New</i>	Knob 1 ¹ / ₄ "	Brushed Pewter	N/A
	H314 *	Pull 4 ⁷ / ₈ "	Brushed Satin Nickel	96mm
	H315 *	Pull 5 ¹ / ₃ "	Brushed Satin Nickel	128mm
	H316	Knob 1 ¹ / ₄ "	Brushed Satin Nickel	N/A
	H332 *	Pull 5"	Brushed Satin Nickel	96mm
	H343 *	Pull 6 ¹ / ₄ "	Brushed Satin Nickel	128mm
	H344	Pull 4 ¹ / ₂ "	Brushed Satin Nickel	96mm
	H345	Knob 1 ¹ / ₄ "	Brushed Satin Nickel	N/A
	H346	Pull 4 ¹ / ₈ "	Brushed Satin Nickel	96mm
	H347	Pull 4 ¹ / ₈ "	Brushed Satin Nickel	3"
	H348	Knob 1 ¹ / ₁₆ "	Brushed Satin Nickel	N/A

► Screws included with hardware.

► Order under style #010.

► Hardware is recommended for use on all full overlay and miter door styles (except Avalon and Radford). All other door styles have a reverse bevel and hardware is not required.

► For 5-Piece drawer front panel dimensions, please see page 181.

*Hardware does not fit certain door styles with 5-Piece drawers because of small width of recessed center drawer panel.



Hardware Chart



- ▶ Screws included with hardware.
- ▶ Order under style #010.
- ▶ Hardware is recommended for use on all full overlay and miter door styles (except Avalon and Radford). All other door styles have a reverse bevel and hardware is not required.

▶ **For 5-Piece drawer front panel dimensions, please see page 181.**

*Hardware does not fit certain door styles with 5-Piece drawers because of small width of recessed center drawer panel.



	PRODUCT CODE	Item Description	Finish/Color	Drill Center
	H349	Pull 7"	Brushed Satin Nickel	96mm
	H350	Pull 8 1/8"	Brushed Satin Nickel	128mm
	H400 <i>New</i>	Pull 5"	Brushed Satin Nickel	96mm
	H401 <i>New</i>	Pull 6 3/4"	Brushed Satin Nickel	128mm
	H402 <i>New</i>	Knob 1 1/4"	Brushed Satin Nickel	N/A
	H411 <i>New</i>	Pull 7"	Brushed Satin Nickel	6"
	H403 <i>New</i>	Pull 5"	Dark Bronze	96mm
	H404 <i>New</i>	Pull 6 3/4"	Dark Bronze	128mm
	H405 <i>New</i>	Knob 1 1/4"	Dark Bronze	N/A
	H318 *	Pull 5 3/8"	Flat Black	128mm
	H323	Knob 1 1/4"	Flat Black	N/A
	H416 <i>New</i>	Pull 4 3/16"	Flat Black	96mm
	H417 <i>New</i>	Pull 6 11/16"	Flat Black	160mm
	H418 <i>New</i>	Knob 1 3/16"	Flat Black	N/A
	H419 <i>New</i>	Pull 5 1/2"	Gun Metal	128mm
	H420 <i>New</i>	Knob 1 1/4"	Gun Metal	N/A

	PRODUCT CODE	Item Description	Finish/Color	Drill Center
	H409 <i>New</i>	Pull 7"	Matte Black	6"
	H410 <i>New</i>	Knob 1/4"	Matte Black	N/A
	H333 *	Pull 4 3/8"	Oil Rubbed Bronze	4"
	H334	Knob 1/4"	Oil Rubbed Bronze	N/A
	H300	Knob 1/4"	Patina Black	N/A
	H302 *	Pull 4 3/8"	Patina Black	4"
	H303	Knob 1/4"	Patina Black	N/A
	H304 *	Pull 4 3/8"	Patina Rouge	4"
	H307	Knob 1/4"	Patina Rouge	N/A
	H319	Large Flower Twist Knob 1/4"	Pewter	N/A
	H335 *	Birdcage Pull 4 1/3"	Pewter	4"
	H167	Knob 1/4"	Polished Brass Plated	N/A
	H317	Knob 1/4"	Polished Chrome	N/A
	H406 <i>New</i>	Pull 4 3/8"	Polished Chrome	96mm
	H407 <i>New</i>	Pull 5"	Polished Chrome	128mm

► Screws included with hardware.

► Order under style #010.

► Hardware is recommended for use on all full overlay and miter door styles (except Avalon and Radford). All other door styles have a reverse bevel and hardware is not required.

► **For 5-Piece drawer front panel dimensions, please see page 181.**

*Hardware does not fit certain door styles with 5-Piece drawers because of small width of recessed center drawer panel.











Hardware Chart

- ▶ Screws included with hardware.
- ▶ Order under style #010.
- ▶ Hardware is recommended for use on all full overlay and miter door styles (except Avalon and Radford). All other door styles have a reverse bevel and hardware is not required.

▶ **For 5-Piece drawer front panel dimensions, please see page 181.**

*Hardware does not fit certain door styles with 5-Piece drawers because of small width of recessed center drawer panel.



	PRODUCT CODE	Item Description	Finish/Color	Drill Center
	H408 <i>New</i>	Knob 1 1/8"	Polished Chrome	N/A
	H414 <i>New</i>	Pull 4 13/16"	Polished Nickel	96mm
	H415 <i>New</i>	Pull 6 1/16"	Polished Nickel	128mm
	H336 *	Pull 5 2/3"	Venetian Bronze	128mm
	H337 *	Birdcage Pull 4 1/3"	Venetian Bronze	4"
	H339	Birdcage Knob 1 1/4"	Venetian Bronze	N/A
	H340	Knob 1 1/4"	Venetian Bronze	N/A
	H421 <i>New</i>	Pull 5 1/2"	Venetian Bronze	128mm
	H422 <i>New</i>	Knob 1 1/4"	Venetian Bronze	N/A

5-Piece Drawer Front Dimensions - Based on a 12" Wide Base Cabinet

5-PIECE STYLE NAME	DRAWER FRONT WIDTH	DRAWER FRONT HEIGHT	FLAT PANEL WIDTH	FLAT PANEL HEIGHT
Ayden 5-Piece	9 ⁷ / ₈ "	5 ¹ / ₈ "	5 ⁷ / ₈ "	1 ¹ / ₈ "
Benton 5-Piece	9 ⁷ / ₈ "	5 ¹ / ₈ "	5 ⁷ / ₈ "	1 ¹ / ₈ "
Briarcliff II	11 ¹ / ₂ "	5 ³ / ₄ "	6"	1 ¹ / ₈ "
Durham	11 ¹ / ₂ "	5 ³ / ₄ "	7 ¹ / ₂ "	1 ³ / ₄ "
Eastland 5-Piece	11 ¹ / ₂ "	5 ³ / ₄ "	6"	1 ¹ / ₈ "
Harrison 5-Piece	11 ¹ / ₂ "	5 ³ / ₄ "	7 ¹ / ₁₆ "	1 ⁵ / ₁₆ "
Korbett 5-Piece	11 ¹ / ₂ "	5 ³ / ₄ "	5 ¹ / ₂ "	1 ⁵ / ₁₆ "
Landen 5-Piece	9 ⁷ / ₈ "	5 ¹ / ₈ "	5 ⁷ / ₈ "	1 ¹ / ₈ "
Lillian <i>New</i>	9 ⁷ / ₈ "	5 ¹ / ₈ "	5 ⁵ / ₈ "	⁷ / ₈ "
Overton	11 ¹ / ₂ "	5 ³ / ₄ "	7 ¹ / ₂ "	1 ³ / ₄ "
Radford 5-Piece	9 ⁷ / ₈ "	5 ¹ / ₈ "	5 ⁷ / ₈ "	1 ¹ / ₈ "
Saybrooke 5-Piece	9 ⁷ / ₈ "	5 ¹ / ₈ "	5 ⁷ / ₈ "	1 ¹ / ₈ "
Wentworth	11 ¹ / ₂ "	5 ³ / ₄ "	7 ¹ / ₂ "	1 ³ / ₄ "
Winstead 5-Piece	11 ¹ / ₂ "	5 ³ / ₄ "	7 ¹ / ₁₆ "	1 ⁵ / ₁₆ "

5-Piece Drawer Front Dimensions - Based on a VSB36 Wide Cabinet

5-PIECE STYLE NAME	DRAWER FRONT WIDTH	DRAWER FRONT HEIGHT	FLAT PANEL WIDTH	FLAT PANEL HEIGHT
Ayden 5-Piece	7 ⁵ / ₈ "	5 ¹ / ₈ "	3 ⁵ / ₈ "	1 ¹ / ₈ "
Benton 5-Piece	7 ⁵ / ₈ "	5 ¹ / ₈ "	3 ⁵ / ₈ "	1 ¹ / ₈ "
Briarcliff II	9 ¹ / ₄ "	5 ³ / ₄ "	3 ³ / ₄ "	1 ¹ / ₈ "
Durham	9 ¹ / ₄ "	5 ³ / ₄ "	5 ¹ / ₄ "	1 ³ / ₄ "
Eastland 5-Piece	9 ¹ / ₄ "	5 ³ / ₄ "	3 ³ / ₄ "	1 ¹ / ₈ "
Harrison 5-Piece	9 ¹ / ₄ "	5 ³ / ₄ "	4 ¹³ / ₁₆ "	1 ⁵ / ₁₆ "
Korbett 5-Piece	9 ¹ / ₄ "	5 ³ / ₄ "	3 ¹ / ₄ "	1 ⁵ / ₁₆ "
Landen 5-Piece	7 ⁵ / ₈ "	5 ¹ / ₈ "	3 ⁵ / ₈ "	1 ¹ / ₈ "
Lillian <i>New</i>	7 ⁵ / ₈ "	5 ¹ / ₈ "	3 ⁵ / ₈ "	⁷ / ₈ "
Overton	9 ¹ / ₄ "	5 ³ / ₄ "	5 ¹ / ₄ "	1 ³ / ₄ "
Radford 5-Piece	7 ⁵ / ₈ "	5 ¹ / ₈ "	3 ⁵ / ₈ "	1 ¹ / ₈ "
Saybrooke 5-Piece	7 ⁵ / ₈ "	5 ¹ / ₈ "	3 ⁵ / ₈ "	1 ¹ / ₈ "
Wentworth	9 ¹ / ₄ "	5 ³ / ₄ "	5 ¹ / ₄ "	1 ³ / ₄ "
Winstead 5-Piece	9 ¹ / ₄ "	5 ³ / ₄ "	4 ¹³ / ₁₆ "	1 ⁵ / ₁₆ "

Drawer Front sizes are representative of a VSB36 cabinet, smallest drawer front available.

Trim Items with Rustic Characteristics

Use Rustic Common Style Numbers to order items with Rustic Characteristics.

For all other trim items, use Maple Common Style Numbers (see page 25).

Product Code	Description	Page #
BBCPO	Base Box Column Pull-Out Cabinet	91
MCROWN8	Moulding Crown	146
MICROWN8	Moulding Insert Crown	146
MFOLCR8	Moulding Full Overlay Crown	146
MTCROWN8	Moulding Tall Crown	146
MSHKRCROWN8	Moulding Shaker Crown	146
MBS8	Moulding Base Shoe	150
FBC3X3	Filler - Base Corner	151
F3_ _ & F6_ _	Filler - Base & Tall Straight	151
V_ _ _ RA & V_ _ _ ST	Valance - Arch & Straight	159
PDWP	Dishwasher Front Panel	160
PEPR335 **	Aristex™ End Panel with 3" Stile	160
PEPRPLY_ _35 *	Plywood End Panel with 1 ¹ / ₂ " or 3" Stile	160
PREF23_ _	Plywood Refrigerator End Panel	160
PREPRP_ _ _ _ *	Plywood Refrigerator End Panel with 1 ¹ / ₂ " Stile	160
PREPR33096	Veneer Furniture Board Refrigerator End Panel with 3" Stile	160
PP9635	Stock Panel	161
P48_ _	Stock Panel	161
EPV_ _ _ _	Veneer End Panel	162

** Rustic characteristics on PEPR335 Filler only.

* Rustic characteristics on PEPRPLY1.535, PREPRP1.584, and PREPRP1.596 panels only.

KEY

- F** Must remove full-depth shelf.
H Must remove half-depth adjustable shelf.
I Can be installed without modification to cabinet.
P Location of plumbing should be checked prior to installation of storage accessory.
✓ Recommended for ideal fit, and can be installed without modification to cabinet.
• Not applicable.
† Only one tray will fit.

Traditional Storage Accessory Matrix

Cabinet	Double Wastebasket Roll-Out	STOT30WHB Sink Tip-Out Tray 30" Two 11 1/2" trays, 2 hinges	STOT36WHB Sink Tip-Out Tray 36" Two 14 1/2" trays, 2 hinges	Roll-Out Kit*
B12	•	•	•	•
B12TD	•	•	•	•
B15	H	•	•	TKIT15
B15RT	•	•	•	TKIT15
B18	H	•	•	TKIT18
B18RT	•	•	•	TKIT18
B21	H	•	•	TKIT21
B21RT	•	•	•	TKIT21
B24	H	•	•	TKIT24
B24RT	•	•	•	TKIT24
B24DD	H	•	•	TKIT24
B24DDRT	•	•	•	TKIT24
B27B	•	•	•	TKIT27
B27RTB	•	•	•	TKIT27
B30B	H	•	•	TKIT30
B30RTB	•	•	•	TKIT30
B33B	H	•	•	TKIT33
B33RTB	•	•	•	TKIT33
B36B	H	•	•	TKIT36
B36RTB	•	•	•	TKIT36
B39	H	•	•	TKIT39
B39RT	•	•	•	TKIT39
B42	H	•	•	TKIT21
B42RT	•	•	•	TKIT21
B45	H	•	•	TKIT45
B45RT	•	•	•	TKIT45
B48	H	•	•	TKIT24
B48RT	•	•	•	TKIT24
B15FH	✓	•	•	TKIT15
B18FH	I	•	•	TKIT18
B21FH	I	•	•	TKIT21
B24FH	I	•	•	TKIT24
B30FHB	I	•	•	TKIT30
B36FHB	I	•	•	TKIT36
BWB15FH	•	•	•	•
BWB18	•	•	•	•
BWB21	•	•	•	•
BC36	•	•	•	•
BC39	H	•	•	•
BC42	H	•	•	TKIT15
BC45	H	•	•	TKIT18
BC48	H	•	•	TKIT39
BC51	H	•	•	TKIT21
SCER36	•	•	•	•
SB24	P	I [†]	I [†]	TKIT24
SB24DD	P	I [†]	I [†]	TKIT24
SB27B	P	I [†]	•	TKIT27
SB30B	P	✓	•	TKIT30
SB33B	P	✓	•	TKIT33
SB36B	P	I	✓	TKIT36
SB39	P	•	•	TKIT39
SB42	P	•	•	TKIT21
SB45	P	•	•	TKIT45
SB48	P	•	•	TKIT24

Traditional Storage Accessory Matrix

NOTES ✓

Cabinet	Double Wastebasket Roll-Out	STOT30WHB Sink Tip-Out Tray 30" Two 1 1/2" trays, 2 hinges	STOT36WHB Sink Tip-Out Tray 36" Two 14 1/2" trays, 2 hinges	Roll-Out Kit*
SBDC36	P	I [†]	•	•
SBDC42	P	I [†]	•	•
SF30 (POL)	P	•	•	•
SF30B (FOL)	P	I	•	•
SF36B (POL)	P	I	•	•
SF36B (FOL)	P	I	✓	•
SF42	P	•	•	•
SF48	P	•	•	•
SFC36	P	I [†]	•	•
SFC42	P	I [†]	I [†]	•
PB18	F	•	•	•
PB24	F	•	•	•
PB24DD	F	•	•	•
PB30B	F	•	•	•
PB36B	F	•	•	•
PB42	F	•	•	•
PB48	F	•	•	•
PBSC27B	F	•	•	•
PBSC42	F	•	•	•
PBSC48	F	•	•	•
U15/U1590/U1596	I	•	•	TKIT15
U18/U1890/U18596	I	•	•	TKIT18
U24/U2490/U2496	I	•	•	TKIT24
U30B/U3090B/U3096B	I	•	•	TKIT30
U36B/U3690B/U3696B	I	•	•	TKIT36
B30FH32.5B	I	•	•	TKIT30
B33FH32.5B	I	•	•	TKIT33
B36FH32.5B	I	•	•	TKIT36
SB3032.5B	•	✓	•	TKIT30
SB3632.5B	•	I	✓	TKIT36
U1832.5	I	•	•	TKIT18
U2432.5	I	•	•	TKIT24

KEY

- F** Must remove full-depth shelf.
- H** Must remove half-depth adjustable shelf.
- I** Can be installed without modification to cabinet.
- P** Location of plumbing should be checked prior to installation of storage accessory.
- ✓ Recommended for ideal fit, and can be installed without modification to cabinet.
- Not applicable.
- † Only one tray will fit.

Glass Size Chart for Wall Prepped for Glass Cabinets

ACCESSORIES AND PARTS

	Briarcliff II Dryden Durham Eastland Overton Wentworth		Brellin		Korbett		Harrison Winstead		Benton Saybrooke		Grayson Landen		Ayden Avalon Oakland Pioneer Radford Sinclair Westbury	
	Width	Height	Width	Height	Width	Height	Width	Height	Width	Height	Width	Height	Width	Height
RECOMMENDED GLASS SIZES														
BPG2412FH	18 ⁵ / ₈ "	25 ¹ / ₄ "	19 ¹³ / ₁₆ "	26 ⁷ / ₁₆ "	18 ¹ / ₄ "	24 ⁷ / ₈ "	19 ⁷ / ₈ "	26 ¹ / ₂ "	18 ¹ / ₄ "	25 ¹ / ₄ "	17 ¹ / ₈ "	24 ⁷ / ₈ "	18 ⁵ / ₈ "	25 ⁵ / ₈ "
BPG2415FH	18 ⁵ / ₈ "	25 ¹ / ₄ "	19 ¹³ / ₁₆ "	26 ⁷ / ₁₆ "	18 ¹ / ₄ "	24 ⁷ / ₈ "	19 ⁷ / ₈ "	26 ¹ / ₂ "	18 ¹ / ₄ "	25 ¹ / ₄ "	17 ¹ / ₈ "	24 ⁷ / ₈ "	18 ⁵ / ₈ "	25 ⁵ / ₈ "
BPG3012FHB	9 ¹ / ₁₆ "	25 ¹ / ₄ "	11"	26 ⁷ / ₁₆ "	9 ⁷ / ₁₆ "	24 ⁷ / ₈ "	11 ¹ / ₁₆ "	26 ¹ / ₂ "	10 ¹ / ₄ "	25 ¹ / ₄ "	9 ¹ / ₈ "	24 ⁷ / ₈ "	10 ⁵ / ₈ "	25 ⁵ / ₈ "
BPG3015FHB	9 ¹ / ₁₆ "	25 ¹ / ₄ "	11"	26 ⁷ / ₁₆ "	9 ⁷ / ₁₆ "	24 ⁷ / ₈ "	11 ¹ / ₁₆ "	26 ¹ / ₂ "	10 ¹ / ₄ "	25 ¹ / ₄ "	9 ¹ / ₈ "	24 ⁷ / ₈ "	10 ⁵ / ₈ "	25 ⁵ / ₈ "
BPG3612FHB	12 ¹³ / ₁₆ "	25 ¹ / ₄ "	14"	26 ⁷ / ₁₆ "	12 ⁷ / ₁₆ "	24 ⁷ / ₈ "	14 ¹ / ₁₆ "	26 ¹ / ₂ "	13 ³ / ₄ "	25 ¹ / ₄ "	12 ¹ / ₈ "	24 ⁷ / ₈ "	13 ³ / ₈ "	25 ⁵ / ₈ "
BPG3615FHB	12 ¹³ / ₁₆ "	25 ¹ / ₄ "	14"	26 ⁷ / ₁₆ "	12 ⁷ / ₁₆ "	24 ⁷ / ₈ "	14 ¹ / ₁₆ "	26 ¹ / ₂ "	13 ³ / ₄ "	25 ¹ / ₄ "	12 ¹ / ₈ "	24 ⁷ / ₈ "	13 ³ / ₈ "	25 ⁵ / ₈ "
DCPG2430	9 ⁵ / ₈ "	24 ⁵ / ₈ "	10 ¹³ / ₁₆ "	25 ¹³ / ₁₆ "	9 ¹ / ₄ "	24 ¹ / ₄ "	10 ⁵ / ₈ "	25 ⁵ / ₈ "	12 ¹ / ₄ "	24 ¹ / ₄ "	11 ¹ / ₈ "	23 ³ / ₈ "	12 ⁵ / ₈ "	24 ⁵ / ₈ "
DCPG2436	9 ⁵ / ₈ "	30 ⁵ / ₈ "	10 ¹³ / ₁₆ "	31 ¹³ / ₁₆ "	9 ¹ / ₄ "	30 ¹ / ₄ "	10 ⁵ / ₈ "	31 ⁵ / ₈ "	12 ¹ / ₄ "	30 ¹ / ₄ "	11 ¹ / ₈ "	29 ³ / ₈ "	12 ⁵ / ₈ "	30 ⁵ / ₈ "
DCPG2442	9 ⁵ / ₈ "	36 ⁵ / ₈ "	10 ¹³ / ₁₆ "	37 ¹³ / ₁₆ "	9 ¹ / ₄ "	36 ¹ / ₄ "	10 ⁵ / ₈ "	37 ⁵ / ₈ "	12 ¹ / ₄ "	36 ¹ / ₄ "	11 ¹ / ₈ "	35 ³ / ₈ "	12 ⁵ / ₈ "	36 ⁵ / ₈ "
DCPG2730	9 ⁵ / ₈ "	24 ⁵ / ₈ "	10 ¹³ / ₁₆ "	25 ¹³ / ₁₆ "	9 ¹ / ₄ "	24 ¹ / ₄ "	10 ⁵ / ₈ "	25 ⁵ / ₈ "	12 ¹ / ₄ "	24 ¹ / ₄ "	11 ¹ / ₈ "	23 ³ / ₈ "	12 ⁵ / ₈ "	24 ⁵ / ₈ "
DCPG2736	9 ⁵ / ₈ "	30 ⁵ / ₈ "	10 ¹³ / ₁₆ "	31 ¹³ / ₁₆ "	9 ¹ / ₄ "	30 ¹ / ₄ "	10 ⁵ / ₈ "	31 ⁵ / ₈ "	12 ¹ / ₄ "	30 ¹ / ₄ "	11 ¹ / ₈ "	29 ³ / ₈ "	12 ⁵ / ₈ "	30 ⁵ / ₈ "
DCPG2742	9 ⁵ / ₈ "	36 ⁵ / ₈ "	10 ¹³ / ₁₆ "	37 ¹³ / ₁₆ "	9 ¹ / ₄ "	36 ¹ / ₄ "	10 ⁵ / ₈ "	37 ⁵ / ₈ "	12 ¹ / ₄ "	36 ¹ / ₄ "	11 ¹ / ₈ "	35 ³ / ₈ "	12 ⁵ / ₈ "	36 ⁵ / ₈ "
PWPG3024B	9 ¹ / ₁₆ "	18 ⁵ / ₈ "	11"	19 ¹³ / ₁₆ "	9 ⁷ / ₁₆ "	18 ¹ / ₄ "	11 ¹ / ₁₆ "	19 ⁷ / ₈ "	10 ¹ / ₄ "	18 ¹ / ₄ "	9 ¹ / ₈ "	17 ¹ / ₈ "	10 ⁵ / ₈ "	18 ⁵ / ₈ "
PWPG3624B	12 ¹³ / ₁₆ "	18 ⁵ / ₈ "	14"	19 ¹³ / ₁₆ "	12 ⁷ / ₁₆ "	18 ¹ / ₄ "	14 ¹ / ₁₆ "	19 ⁷ / ₈ "	13 ³ / ₄ "	18 ¹ / ₄ "	12 ¹ / ₈ "	17 ¹ / ₈ "	13 ³ / ₈ "	18 ⁵ / ₈ "
WPG1214	6 ⁵ / ₈ "	8 ⁵ / ₈ "	7 ¹³ / ₁₆ "	9 ¹³ / ₁₆ "	6 ¹ / ₄ "	8 ¹ / ₄ "	7 ⁷ / ₈ "	9 ⁷ / ₈ "	6 ¹ / ₄ "	8 ¹ / ₄ "	5 ¹ / ₈ "	7 ¹ / ₈ "	6 ⁵ / ₈ "	8 ⁵ / ₈ "
WPG1218	6 ⁵ / ₈ "	12 ⁵ / ₈ "	7 ¹³ / ₁₆ "	13 ¹³ / ₁₆ "	6 ¹ / ₄ "	12 ¹ / ₄ "	7 ⁷ / ₈ "	13 ³ / ₈ "	6 ¹ / ₄ "	12 ¹ / ₄ "	5 ¹ / ₈ "	11 ¹ / ₈ "	6 ⁵ / ₈ "	12 ⁵ / ₈ "
WPG1230	6 ⁵ / ₈ "	24 ⁵ / ₈ "	7 ¹³ / ₁₆ "	25 ¹³ / ₁₆ "	6 ¹ / ₄ "	24 ¹ / ₄ "	7 ⁷ / ₈ "	25 ⁵ / ₈ "	6 ¹ / ₄ "	24 ¹ / ₄ "	5 ¹ / ₈ "	23 ³ / ₈ "	6 ⁵ / ₈ "	24 ⁵ / ₈ "
WPG1236	6 ⁵ / ₈ "	30 ⁵ / ₈ "	7 ¹³ / ₁₆ "	31 ¹³ / ₁₆ "	6 ¹ / ₄ "	30 ¹ / ₄ "	7 ⁷ / ₈ "	31 ⁷ / ₈ "	6 ¹ / ₄ "	30 ¹ / ₄ "	5 ¹ / ₈ "	29 ³ / ₈ "	6 ⁵ / ₈ "	30 ⁵ / ₈ "
WPG1242	6 ⁵ / ₈ "	36 ⁵ / ₈ "	7 ¹³ / ₁₆ "	37 ¹³ / ₁₆ "	6 ¹ / ₄ "	36 ¹ / ₄ "	7 ⁷ / ₈ "	37 ⁵ / ₈ "	6 ¹ / ₄ "	36 ¹ / ₄ "	5 ¹ / ₈ "	35 ³ / ₈ "	6 ⁵ / ₈ "	36 ⁵ / ₈ "
WPG1514	9 ⁵ / ₈ "	8 ⁵ / ₈ "	10 ¹³ / ₁₆ "	9 ¹³ / ₁₆ "	9 ¹ / ₄ "	8 ¹ / ₄ "	10 ⁵ / ₈ "	9 ⁵ / ₈ "	9 ¹ / ₄ "	8 ¹ / ₄ "	8 ¹ / ₈ "	7 ¹ / ₈ "	9 ⁵ / ₈ "	8 ⁵ / ₈ "
WPG1518	9 ⁵ / ₈ "	12 ⁵ / ₈ "	10 ¹³ / ₁₆ "	13 ¹³ / ₁₆ "	9 ¹ / ₄ "	12 ¹ / ₄ "	10 ⁵ / ₈ "	13 ³ / ₈ "	9 ¹ / ₄ "	12 ¹ / ₄ "	8 ¹ / ₈ "	11 ¹ / ₈ "	9 ⁵ / ₈ "	12 ⁵ / ₈ "
WPG1530	9 ⁵ / ₈ "	24 ⁵ / ₈ "	10 ¹³ / ₁₆ "	25 ¹³ / ₁₆ "	9 ¹ / ₄ "	24 ¹ / ₄ "	10 ⁵ / ₈ "	25 ⁵ / ₈ "	9 ¹ / ₄ "	24 ¹ / ₄ "	8 ¹ / ₈ "	23 ³ / ₈ "	9 ⁵ / ₈ "	24 ⁵ / ₈ "
WPG1536/WPG153615	9 ⁵ / ₈ "	30 ⁵ / ₈ "	10 ¹³ / ₁₆ "	31 ¹³ / ₁₆ "	9 ¹ / ₄ "	30 ¹ / ₄ "	10 ⁵ / ₈ "	31 ⁵ / ₈ "	9 ¹ / ₄ "	30 ¹ / ₄ "	8 ¹ / ₈ "	29 ³ / ₈ "	9 ⁵ / ₈ "	30 ⁵ / ₈ "
WPG1542/WPG154215	9 ⁵ / ₈ "	36 ⁵ / ₈ "	10 ¹³ / ₁₆ "	37 ¹³ / ₁₆ "	9 ¹ / ₄ "	36 ¹ / ₄ "	10 ⁵ / ₈ "	37 ⁵ / ₈ "	9 ¹ / ₄ "	36 ¹ / ₄ "	8 ¹ / ₈ "	35 ³ / ₈ "	9 ⁵ / ₈ "	36 ⁵ / ₈ "
WPG1814	12 ⁵ / ₈ "	8 ⁵ / ₈ "	13 ¹³ / ₁₆ "	9 ¹³ / ₁₆ "	12 ¹ / ₄ "	8 ¹ / ₄ "	13 ³ / ₈ "	9 ⁵ / ₈ "	12 ¹ / ₄ "	8 ¹ / ₄ "	11 ¹ / ₈ "	7 ¹ / ₈ "	12 ⁵ / ₈ "	8 ⁵ / ₈ "
WPG1818	12 ⁵ / ₈ "	12 ⁵ / ₈ "	13 ¹³ / ₁₆ "	13 ¹³ / ₁₆ "	12 ¹ / ₄ "	12 ¹ / ₄ "	13 ³ / ₈ "	13 ³ / ₈ "	12 ¹ / ₄ "	12 ¹ / ₄ "	11 ¹ / ₈ "	11 ¹ / ₈ "	12 ⁵ / ₈ "	12 ⁵ / ₈ "
WPG1830	12 ⁵ / ₈ "	24 ⁵ / ₈ "	13 ¹³ / ₁₆ "	25 ¹³ / ₁₆ "	12 ¹ / ₄ "	24 ¹ / ₄ "	13 ³ / ₈ "	25 ⁵ / ₈ "	12 ¹ / ₄ "	24 ¹ / ₄ "	11 ¹ / ₈ "	23 ³ / ₈ "	12 ⁵ / ₈ "	24 ⁵ / ₈ "
WPG1836/WPG183615	12 ⁵ / ₈ "	30 ⁵ / ₈ "	13 ¹³ / ₁₆ "	31 ¹³ / ₁₆ "	12 ¹ / ₄ "	30 ¹ / ₄ "	13 ³ / ₈ "	31 ⁵ / ₈ "	12 ¹ / ₄ "	30 ¹ / ₄ "	11 ¹ / ₈ "	29 ³ / ₈ "	12 ⁵ / ₈ "	30 ⁵ / ₈ "
WPG1842/WPG184215	12 ⁵ / ₈ "	36 ⁵ / ₈ "	13 ¹³ / ₁₆ "	37 ¹³ / ₁₆ "	12 ¹ / ₄ "	36 ¹ / ₄ "	13 ³ / ₈ "	37 ⁵ / ₈ "	12 ¹ / ₄ "	36 ¹ / ₄ "	11 ¹ / ₈ "	35 ³ / ₈ "	12 ⁵ / ₈ "	36 ⁵ / ₈ "
WPG2114	15 ⁵ / ₈ "	8 ⁵ / ₈ "	16 ¹³ / ₁₆ "	9 ¹³ / ₁₆ "	15 ¹ / ₄ "	8 ¹ / ₄ "	16 ⁷ / ₈ "	9 ⁵ / ₈ "	15 ¹ / ₄ "	8 ¹ / ₄ "	14 ¹ / ₈ "	7 ¹ / ₈ "	15 ⁵ / ₈ "	8 ⁵ / ₈ "
WPG2118	15 ⁵ / ₈ "	12 ⁵ / ₈ "	16 ¹³ / ₁₆ "	13 ¹³ / ₁₆ "	15 ¹ / ₄ "	12 ¹ / ₄ "	16 ⁷ / ₈ "	13 ³ / ₈ "	15 ¹ / ₄ "	12 ¹ / ₄ "	14 ¹ / ₈ "	11 ¹ / ₈ "	15 ⁵ / ₈ "	12 ⁵ / ₈ "
WPG2130/WPG213016	15 ⁵ / ₈ "	24 ⁵ / ₈ "	16 ¹³ / ₁₆ "	25 ¹³ / ₁₆ "	15 ¹ / ₄ "	24 ¹ / ₄ "	16 ⁷ / ₈ "	25 ⁵ / ₈ "	15 ¹ / ₄ "	24 ¹ / ₄ "	14 ¹ / ₈ "	23 ³ / ₈ "	15 ⁵ / ₈ "	24 ⁵ / ₈ "
WPG2136/WPG213615	15 ⁵ / ₈ "	30 ⁵ / ₈ "	16 ¹³ / ₁₆ "	31 ¹³ / ₁₆ "	15 ¹ / ₄ "	30 ¹ / ₄ "	16 ⁷ / ₈ "	31 ⁷ / ₈ "	15 ¹ / ₄ "	30 ¹ / ₄ "	14 ¹ / ₈ "	29 ³ / ₈ "	15 ⁵ / ₈ "	30 ⁵ / ₈ "
WPG2142/WPG214215	15 ⁵ / ₈ "	36 ⁵ / ₈ "	16 ¹³ / ₁₆ "	37 ¹³ / ₁₆ "	15 ¹ / ₄ "	36 ¹ / ₄ "	16 ⁷ / ₈ "	37 ⁵ / ₈ "	15 ¹ / ₄ "	36 ¹ / ₄ "	14 ¹ / ₈ "	35 ³ / ₈ "	15 ⁵ / ₈ "	36 ⁵ / ₈ "
WPG2414	18 ⁵ / ₈ "	8 ⁵ / ₈ "	19 ¹³ / ₁₆ "	9 ¹³ / ₁₆ "	18 ¹ / ₄ "	8 ¹ / ₄ "	19 ⁷ / ₈ "	9 ⁵ / ₈ "	18 ¹ / ₄ "	8 ¹ / ₄ "	17 ¹ / ₈ "	7 ¹ / ₈ "	18 ⁵ / ₈ "	8 ⁵ / ₈ "
WPG2418	18 ⁵ / ₈ "	12 ⁵ / ₈ "	19 ¹³ / ₁₆ "	13 ¹³ / ₁₆ "	18 ¹ / ₄ "	12 ¹ / ₄ "	19 ⁷ / ₈ "	13 ³ / ₈ "	18 ¹ / ₄ "	12 ¹ / ₄ "	17 ¹ / ₈ "	11 ¹ / ₈ "	18 ⁵ / ₈ "	12 ⁵ / ₈ "
WPG2424	18 ⁵ / ₈ "	18 ⁵ / ₈ "	19 ¹³ / ₁₆ "	19 ¹³ / ₁₆ "	18 ¹ / ₄ "	18 ¹ / ₄ "	19 ⁷ / ₈ "	19 ⁷ / ₈ "	18 ¹ / ₄ "	18 ¹ / ₄ "	17 ¹ / ₈ "	17 ¹ / ₈ "	18 ⁵ / ₈ "	18 ⁵ / ₈ "
WPG2430/WPG243015	18 ⁵ / ₈ "	24 ⁵ / ₈ "	19 ¹³ / ₁₆ "	25 ¹³ / ₁₆ "	18 ¹ / ₄ "	24 ¹ / ₄ "	19 ⁷ / ₈ "	25 ⁵ / ₈ "	18 ¹ / ₄ "	24 ¹ / ₄ "	17 ¹ / ₈ "	23 ³ / ₈ "	18 ⁵ / ₈ "	24 ⁵ / ₈ "
WPG2436/WPG2436														

Glass Size Chart for Wall Prepped for Glass Cabinets

	Briarcliff II Dryden Durham Eastland Overton Wentworth		Brellin		Korbett		Harrison Winstead		Benton Saybrooke		Grayson Landen		Ayden Avalon Oakland Pioneer Radford Sinclair Westbury	
	Width	Height	Width	Height	Width	Height	Width	Height	Width	Height	Width	Height	Width	Height
RECOMMENDED GLASS SIZES														
WPG3612B	12 ¹³ / ₁₆ "	6 ⁵ / ₈ "	14"	7 ¹³ / ₁₆ "	12 ⁷ / ₁₆ "	8 ¹ / ₄ "	14 ¹ / ₁₆ "	7 ⁷ / ₈ "	13 ¹ / ₄ "	8 ¹ / ₄ "	12 ¹ / ₈ "	5 ¹ / ₈ "	13 ⁵ / ₈ "	6 ⁵ / ₈ "
WPG3614B	12 ¹³ / ₁₆ "	8 ⁵ / ₈ "	14"	9 ¹³ / ₁₆ "	12 ⁷ / ₁₆ "	10 ¹ / ₄ "	14 ¹ / ₁₆ "	9 ⁷ / ₈ "	13 ¹ / ₄ "	10 ¹ / ₄ "	12 ¹ / ₈ "	7 ¹ / ₈ "	13 ⁵ / ₈ "	8 ⁵ / ₈ "
WPG3618B	12 ¹³ / ₁₆ "	12 ⁵ / ₈ "	14"	13 ¹³ / ₁₆ "	12 ⁷ / ₁₆ "	12 ¹ / ₄ "	14 ¹ / ₁₆ "	13 ³ / ₈ "	13 ¹ / ₄ "	12 ¹ / ₄ "	12 ¹ / ₈ "	11 ¹ / ₈ "	13 ⁵ / ₈ "	12 ⁵ / ₈ "
WPG3621B/WPG362115B	12 ¹³ / ₁₆ "	15 ⁵ / ₈ "	14"	16 ¹³ / ₁₆ "	12 ⁷ / ₁₆ "	15 ¹ / ₄ "	14 ¹ / ₁₆ "	16 ⁷ / ₈ "	13 ¹ / ₄ "	15 ¹ / ₄ "	12 ¹ / ₈ "	14 ¹ / ₈ "	13 ⁵ / ₈ "	15 ⁵ / ₈ "
WPG3624B/WPG362415B	12 ¹³ / ₁₆ "	18 ⁵ / ₈ "	14"	19 ¹³ / ₁₆ "	12 ⁷ / ₁₆ "	18 ¹ / ₄ "	14 ¹ / ₁₆ "	19 ⁷ / ₈ "	13 ¹ / ₄ "	18 ¹ / ₄ "	12 ¹ / ₈ "	17 ¹ / ₈ "	13 ⁵ / ₈ "	18 ⁵ / ₈ "
WPG3630B/WPG363015B	12 ¹³ / ₁₆ "	24 ⁵ / ₈ "	14"	25 ¹³ / ₁₆ "	12 ⁷ / ₁₆ "	24 ¹ / ₄ "	14 ¹ / ₁₆ "	25 ⁷ / ₈ "	13 ¹ / ₄ "	24 ¹ / ₄ "	12 ¹ / ₈ "	23 ³ / ₈ "	13 ⁵ / ₈ "	24 ⁵ / ₈ "
WPG3636B/WPG363615B	12 ¹³ / ₁₆ "	30 ⁵ / ₈ "	14"	31 ¹³ / ₁₆ "	12 ⁷ / ₁₆ "	30 ¹ / ₄ "	14 ¹ / ₁₆ "	31 ⁷ / ₈ "	13 ¹ / ₄ "	30 ¹ / ₄ "	12 ¹ / ₈ "	29 ¹ / ₈ "	13 ⁵ / ₈ "	30 ⁵ / ₈ "
WPG3642B/WPG364215B	12 ¹³ / ₁₆ "	36 ⁵ / ₈ "	14"	37 ¹³ / ₁₆ "	12 ⁷ / ₁₆ "	36 ¹ / ₄ "	14 ¹ / ₁₆ "	37 ⁷ / ₈ "	13 ¹ / ₄ "	36 ¹ / ₄ "	12 ¹ / ₈ "	35 ¹ / ₈ "	13 ⁵ / ₈ "	36 ⁵ / ₈ "
WPG3912	14 ¹ / ₈ "	6 ⁵ / ₈ "	15 ⁵ / ₁₆ "	7 ¹³ / ₁₆ "	•	•	15 ⁵ / ₈ "	7 ⁷ / ₈ "	13 ³ / ₄ "	8 ¹ / ₄ "	12 ⁵ / ₈ "	5 ¹ / ₈ "	14 ¹ / ₈ "	6 ⁵ / ₈ "
WPG3914	14 ¹ / ₈ "	8 ⁵ / ₈ "	15 ⁵ / ₁₆ "	9 ¹³ / ₁₆ "	13 ³ / ₄ "	10 ¹ / ₄ "	15 ⁵ / ₈ "	9 ⁷ / ₈ "	13 ³ / ₄ "	10 ¹ / ₄ "	12 ⁵ / ₈ "	7 ¹ / ₈ "	14 ¹ / ₈ "	8 ⁵ / ₈ "
WPG3918	14 ¹ / ₈ "	12 ⁵ / ₈ "	15 ⁵ / ₁₆ "	13 ¹³ / ₁₆ "	13 ³ / ₄ "	12 ¹ / ₄ "	15 ⁵ / ₈ "	13 ³ / ₈ "	13 ³ / ₄ "	12 ¹ / ₄ "	12 ⁵ / ₈ "	11 ¹ / ₈ "	14 ¹ / ₈ "	12 ⁵ / ₈ "
WPG3930/WPG393015	14 ¹ / ₈ "	24 ⁵ / ₈ "	15 ⁵ / ₁₆ "	25 ¹³ / ₁₆ "	13 ³ / ₄ "	24 ¹ / ₄ "	15 ⁵ / ₈ "	25 ⁷ / ₈ "	13 ³ / ₄ "	24 ¹ / ₄ "	12 ⁵ / ₈ "	23 ³ / ₈ "	14 ¹ / ₈ "	24 ⁵ / ₈ "
WPG4212 (MIDDLE)	9 ⁵ / ₈ "	6 ⁵ / ₈ "	10 ¹³ / ₁₆ "	7 ¹³ / ₁₆ "	9 ¹ / ₄ "	8 ¹ / ₄ "	10 ⁷ / ₈ "	7 ⁷ / ₈ "	9 ¹ / ₄ "	8 ¹ / ₄ "	8 ¹ / ₈ "	5 ¹ / ₈ "	9 ⁵ / ₈ "	6 ⁵ / ₈ "
WPG4212 (OUTER)	8 ¹ / ₈ "	6 ⁵ / ₈ "	8"	7 ¹³ / ₁₆ "	7 ³ / ₄ "	8 ¹ / ₄ "	9 ³ / ₈ "	7 ⁷ / ₈ "	7 ³ / ₄ "	8 ¹ / ₄ "	6 ⁵ / ₈ "	5 ¹ / ₈ "	8 ¹ / ₈ "	6 ⁵ / ₈ "
WPG4214 (MIDDLE)	9 ⁵ / ₈ "	8 ⁵ / ₈ "	10 ¹³ / ₁₆ "	9 ¹³ / ₁₆ "	9 ¹ / ₄ "	10 ¹ / ₄ "	10 ⁷ / ₈ "	9 ⁷ / ₈ "	9 ¹ / ₄ "	10 ¹ / ₄ "	8 ¹ / ₈ "	7 ¹ / ₈ "	9 ⁵ / ₈ "	8 ⁵ / ₈ "
WPG4214 (OUTER)	8 ¹ / ₈ "	8 ⁵ / ₈ "	8"	9 ¹³ / ₁₆ "	7 ³ / ₄ "	10 ¹ / ₄ "	9 ³ / ₈ "	9 ⁷ / ₈ "	7 ³ / ₄ "	10 ¹ / ₄ "	6 ⁵ / ₈ "	7 ¹ / ₈ "	8 ¹ / ₈ "	8 ⁵ / ₈ "
WPG4218	15 ⁵ / ₈ "	12 ⁵ / ₈ "	16 ¹³ / ₁₆ "	13 ¹³ / ₁₆ "	15 ¹ / ₄ "	12 ¹ / ₄ "	16 ⁷ / ₈ "	13 ³ / ₈ "	15 ¹ / ₄ "	12 ¹ / ₄ "	14 ¹ / ₈ "	11 ¹ / ₈ "	15 ⁵ / ₈ "	12 ⁵ / ₈ "
WPG4230/WPG423015	15 ⁵ / ₈ "	24 ⁵ / ₈ "	16 ¹³ / ₁₆ "	25 ¹³ / ₁₆ "	15 ¹ / ₄ "	24 ¹ / ₄ "	16 ⁷ / ₈ "	25 ⁷ / ₈ "	15 ¹ / ₄ "	24 ¹ / ₄ "	14 ¹ / ₈ "	23 ³ / ₈ "	15 ⁵ / ₈ "	24 ⁵ / ₈ "
WPG4530/WPG453015	17 ¹ / ₈ "	24 ⁵ / ₈ "	18 ⁵ / ₁₆ "	25 ¹³ / ₁₆ "	16 ³ / ₄ "	24 ¹ / ₄ "	18 ³ / ₈ "	25 ⁷ / ₈ "	16 ³ / ₄ "	24 ¹ / ₄ "	15 ⁵ / ₈ "	23 ³ / ₈ "	17 ¹ / ₈ "	24 ⁵ / ₈ "
WPG4812 (MIDDLE)	9 ⁵ / ₈ "	6 ⁵ / ₈ "	10 ¹³ / ₁₆ "	7 ¹³ / ₁₆ "	9 ¹ / ₄ "	8 ¹ / ₄ "	10 ⁷ / ₈ "	7 ⁷ / ₈ "	9 ¹ / ₄ "	8 ¹ / ₄ "	8 ¹ / ₈ "	5 ¹ / ₈ "	9 ⁵ / ₈ "	6 ⁵ / ₈ "
WPG4812 (OUTER)	11 ¹ / ₈ "	6 ⁵ / ₈ "	12 ⁵ / ₁₆ "	7 ¹³ / ₁₆ "	11 ³ / ₄ "	8 ¹ / ₄ "	12 ³ / ₈ "	7 ⁷ / ₈ "	11 ³ / ₄ "	8 ¹ / ₄ "	9 ⁵ / ₈ "	5 ¹ / ₈ "	11 ¹ / ₈ "	6 ⁵ / ₈ "
WPG4814 (MIDDLE)	9 ⁵ / ₈ "	8 ⁵ / ₈ "	10 ¹³ / ₁₆ "	9 ¹³ / ₁₆ "	9 ¹ / ₄ "	10 ¹ / ₄ "	10 ⁷ / ₈ "	9 ⁷ / ₈ "	9 ¹ / ₄ "	10 ¹ / ₄ "	8 ¹ / ₈ "	7 ¹ / ₈ "	9 ⁵ / ₈ "	8 ⁵ / ₈ "
WPG4814 (OUTER)	11 ¹ / ₈ "	8 ⁵ / ₈ "	12 ⁵ / ₁₆ "	9 ¹³ / ₁₆ "	11 ³ / ₄ "	10 ¹ / ₄ "	12 ³ / ₈ "	9 ⁷ / ₈ "	11 ³ / ₄ "	10 ¹ / ₄ "	9 ⁵ / ₈ "	7 ¹ / ₈ "	11 ¹ / ₈ "	8 ⁵ / ₈ "
WPG4830	18 ⁵ / ₈ "	24 ⁵ / ₈ "	19 ¹³ / ₁₆ "	25 ¹³ / ₁₆ "	18 ¹ / ₄ "	24 ¹ / ₄ "	19 ⁷ / ₈ "	25 ⁷ / ₈ "	18 ¹ / ₄ "	24 ¹ / ₄ "	17 ¹ / ₈ "	23 ³ / ₈ "	18 ⁵ / ₈ "	24 ⁵ / ₈ "