

Raingler

NETS & GRIPS

Install for Behind Front Seat Barrier

Most Trucks & SUVs

NOTE: Many newer trucks have B-pillar handles and even overhead on the ceiling that will be used for some of the top mounting locations. Check to see if you prefer to use these factory locations as the nets typically have enough adjustment to allow for this option. If your vehicle must or you prefer to install mounting points for better fitment, please follow the below steps.

IMPORTANT: READ INSTRUCTIONS FULLY BEFORE STARTING

Time: 45 -60 minutes

Skill Level: 3 of 5

Tools: (may vary by vehicle)

1. Drill and small drill bit for pilot holes (pre-drilling) mounting footman screws.
2. Panel removal tool
3. Wrenches and Torx sockets depending on vehicle

Step 1. Here is the finished anchor point for the top mount strap installed correctly in place



NOTE: the SRS stamp in the plastic is simply an identification marking and generally the actual SRS bags are in the overhead ceiling or in the seat themselves. Do look and verify that no plugs are unhooked, wires or actual components are damaged or altered.



Step 2. This step is done similarly in most vehicles by loosening the upper part of the trim panel. Some vehicles this can be done by simply popping the trim snaps loose and carefully pulling out. Other vehicles may have a two-piece trim panel that requires the lower piece removed first as shown:

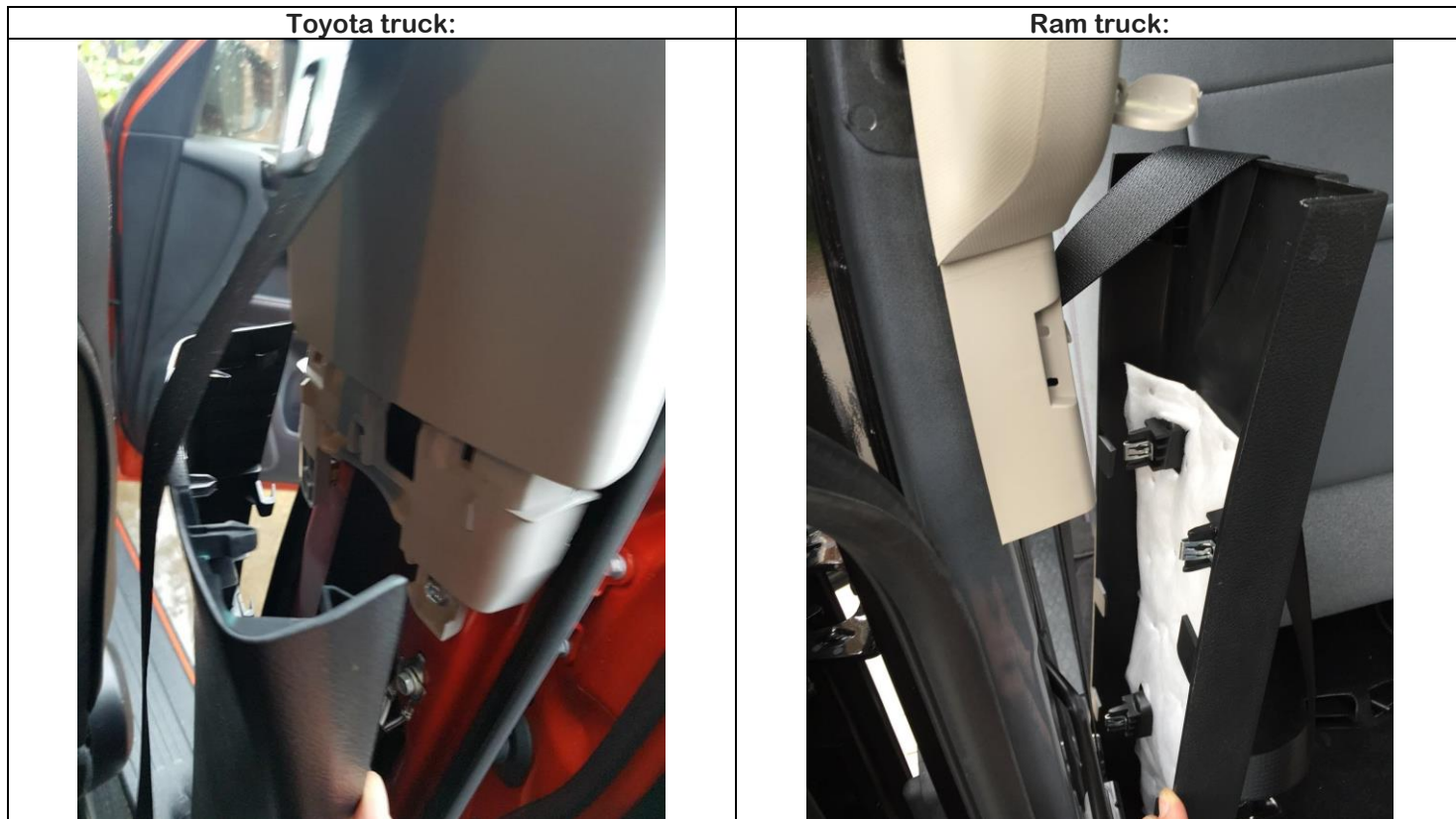

Be sure to look for fasteners in handle cover pop-outs and upper seat belt anchor bolts like the Torx bolt



Step 3: Remove upper trim panel enough for access to the inner metal structure near the headliner



Step 4: Mount the footman strap by locating a good open metal surface as to not be too low to push down on the re-assembled plastic trim and not too high to interfere with the headliner material. Mark location on holes and pre-drill the mounting screws again being careful to check that no lines, wiring or seat belt interference will occur when re-assembled.

| | |
|--|--|
| <p data-bbox="293 254 472 281">Toyota Truck:</p>  | <p data-bbox="1040 254 1187 281">Ram Truck:</p>  |
| <p data-bbox="131 1077 639 1136">Ford F250 Supercab using OE Torx bolt location</p>  | <p data-bbox="948 1077 1281 1104">Toyota FJ using Torx bolt:</p>  |

Step 5: Reassemble and check to ensure there are no obstructions to upper seat belt adjustment or trim panel fasteners, etc.

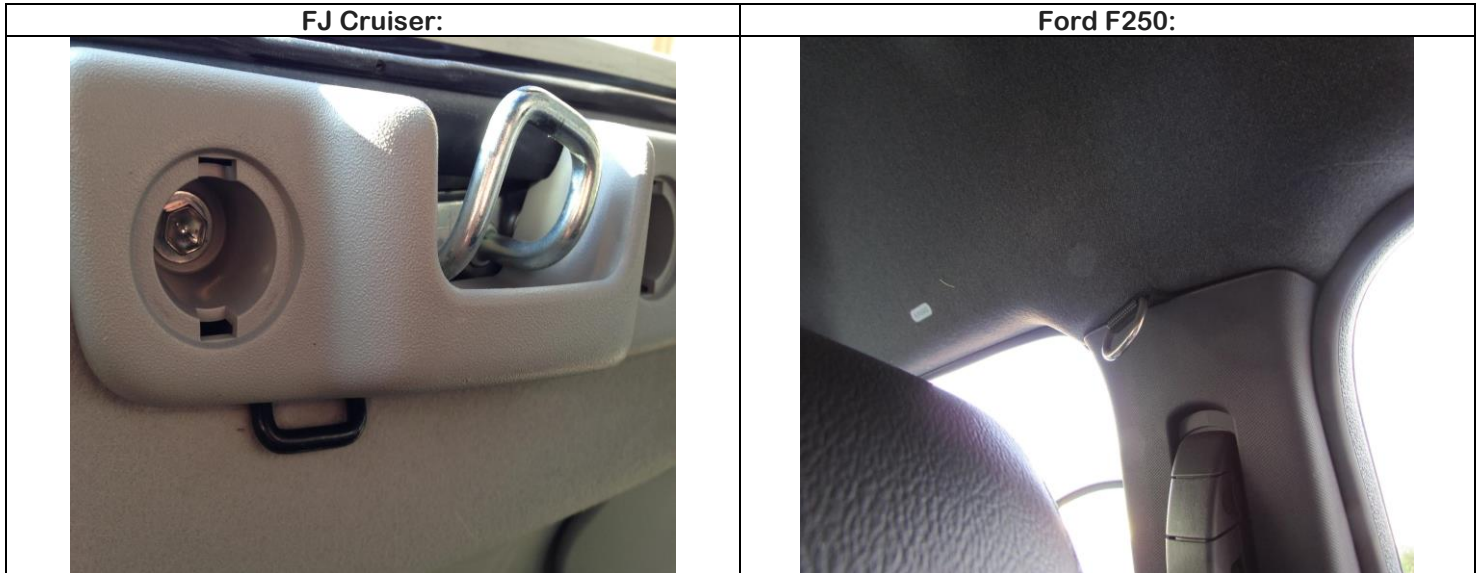

Step 6: Many trucks will have the lower straps either attach to factory seat brackets to the bottom of the seat. Do check that where the strap is installed there are no abrasive or sharp edges. (We offer flat hooks on our hardware section, but generally a simple relocation of the strap will do.)

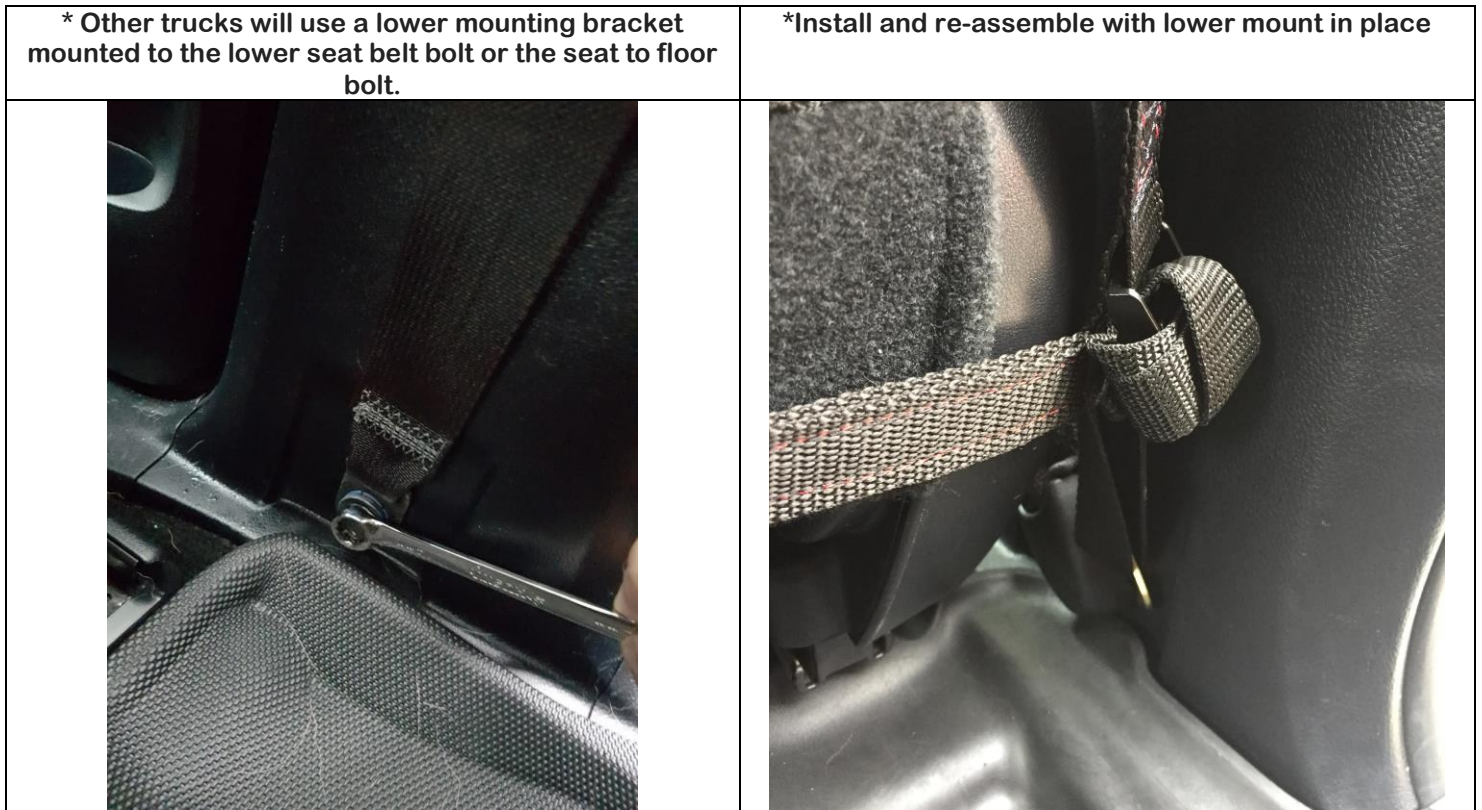

Step 7: Tighten the tension from top first, working your way to the floor. Pay attention to adjusting for normal seat positioning, wrap and tie off the excess adjusting straps.
To see how to wrap and tuck up the excess strap visit our Raingler Youtube channel.



Enjoy!

Thank you for purchasing Raingler Nets

If you have any questions please contact us, we are here to help!

Tech@RAINGLER.COM or [866-905-7625](tel:866-905-7625)