

INSTALLATION MANUAL

VEHICLE APPLICATION

Year: 2014 - 2016
 Make: Polaris
 Model: RZR 1000, XP4
 Engine: 1000cc, Turbo (2016)

TOOLS REQUIRED

- 4mm, 5mm, & 6mm Hex Key
- 8mm & 13 mm Wrench & Socket
- T25 Torx
- Phillips Screwdriver, Flat Blade Screwdriver, Razor Blade, and Wire Cutters

BEFORE YOU START

- Please read the entire installation manual before proceeding.
- Ensure all components listed on page 6 are present.
- If you are missing any of the components, call our customer support at (909) 947-0015.
- Do not work on your vehicle while engine is hot.
- Make sure the engine is turned off and the vehicle is in Park and/or the Parking Brake is set.

WARNING:

THIS EQUIPMENT SHOULD BE INSTALLED, ADJUSTED, AND SERVICED BY PERSONNEL FAMILIAR WITH THE CONSTRUCTION AND OPERATION OF THIS TYPE OF EQUIPMENT AND THE HAZARDS INVOLVED. FAILURE TO OBSERVE THIS PRECAUTION COULD RESULT IN SEVERE INJURY. READ THIS MANUAL THOROUGHLY AND MAKE SURE YOU UNDERSTAND THE PROCEDURES BEFORE YOU ATTEMPT TO OPERATE THIS EQUIPMENT. THE PURPOSE OF THIS MANUAL IS TO PROVIDE YOU WITH INFORMATION NECESSARY TO SAFELY OPERATE, MAINTAIN, AND TROUBLESHOOT THIS EQUIPMENT. DO NOT USE THIS EQUIPMENT FOR ANY REASON OTHER THAN ITS INTENDED PURPOSE. FAILURE TO FOLLOW THESE INSTRUCTIONS WILL VOID ANY WARRANTY. KEEP THIS MANUAL FOR FUTURE REFERENCE. THE INFORMATION CONTAINED IN THIS MANUAL IS SUBJECT TO CHANGE WITHOUT NOTICE.

Product will intake and expel both air and loose materials with high force and velocity.

- Install product on roll cage, so air inlet is not blocked.
- Do not place face, hair, extremities, clothing, or other loose material in front of air inlet or outlet during use.
- Install product securely to roll cage and avoid placing hair, extremities, clothing, or other loose material in front of air inlet during use.

Moving parts are sharp and could cause personal injury.

- Keep fan safety guard and exhaust cover in place while operating and after service.
- Disconnect product from power source before servicing.

Scavenge Fan is designed for use in conjunction with an UTV's operating manual, and state and federal law.

- Keep your seat belt fastened and wear a helmet while operating the vehicle.

Risk of electric shock!

- Improper installation, maintenance or operation could cause serious injury or property damage.

1. Install the Housing Mount (L) onto the bottom of the Particle Separator (A) using the provided Screws (D), Washers (C) and Nuts (B). Use a 5mm hex key and a 13mm socket to tighten the housing mount onto the bottom of the particle separator. Note that the Housing Mounts (L) can be installed in either of the two front or rear positions, depending on how close you want the particle separator to be to the roll cage. The picture below shows the clamps installed so that the particle separator is in the rear position, which provides clearance for accessory mounting tabs if your roll cage was equipped with them. (Optional) Either of the housing mounts can also be flipped around to position the clamps further inward if required for your application. If either of the clamps are flipped around, the particle separator will have to be installed in the rear position.



SEE EXPLODED VIEW ON PAGE 8



INSTALLATION MANUAL (CONTINUED)

2. Insert the Clamp Adapter (M) into both the left and right Housing Mount (L) through the ridges and install the Screw (P) and Washer (Q) with a 5mm hex key. Do not tighten fully yet.

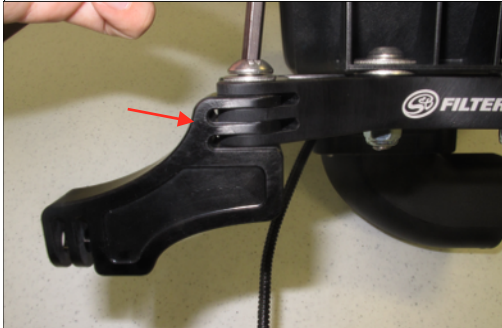

3. Insert the Tube Clamp Screw Side (N) into both the left and right Clamp Adapter (M) through the ridges. Push in the Screw (R) through the backside of the clamp adapter and install the Tube Clamp Nut Side (O) with a 6mm hex key. Only turn the screw a couple turns to leave enough room for the clamps to go around the roll bar.



4. Find a place on the roll bar that you want to mount the Particle Separator (A). You can mount it either on the top or lower bar. Pivot the adjustments in the clamp assembly to match the curve of your roll bar if necessary. You may need an extra hand to help with this step. You can use tape to protect the finish on your roll bar while you determine the best position for the Particle Separator. Use a 6mm hex key to tighten the clamp onto the roll bar. Tighten the screw installed in Step 2 holding the Clamp Adapter (M) to the Housing Mounts (L) to the base with a 5mm hex key.



5. Loosen the screw for the passenger side factory frog skin side cover. Lift up and pull towards the front of the vehicle to remove the frog skin side cover.



6. Place a Hose Clamp (G) over the stock air box inlet. Install the Adapter (F) into the stock air box inlet with the small OD side down and tighten the hose clamp.



7. Insert one end the Duct (E) onto the Adapter (F). Bring the other end towards the opening on the Particle Separator (A). Note the length on the duct you want to cut. We recommend cutting the duct an extra 3" longer so that the ends, along with any wire and strings, can be folded in for a cleaner look.



8. Pierce the duct using a razor, centered between the two wire reinforcements. Cut all the way around.

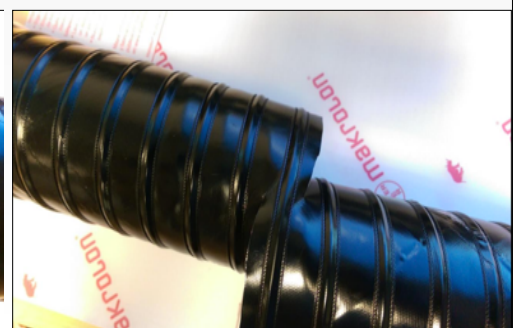

SEE EXPLODED VIEW ON PAGE 8



INSTALLATION MANUAL (CONTINUED)

9. Use scissors to begin the cut. Aim the scissors towards the start of the cut. Do not try to cut through the wire with scissors. Use a mini-bolt or a heavy duty wire cutter to finish the cut, cutting through the wire and strings. (Optional) Regular staples can be used to secure the ends of the strings to the duct.



10. (Optional) For a cleaner appearance, take the end of the wire and tuck it inside the duct. Do this for both ends of the duct if needed.



11. Position a Hose Clamp (G) over each end of the duct. Install the Duct (E) onto the Adapter (F) and the Particle Separator (A). Tighten both hose clamps.



12. Install the Side Cover (I) and use a 4mm hex key on the Screw (J) and Washer (K).



13. Remove the screw for the stock panel near the driver's side shock reservoir using a T25 Torx bit.



14. Familiarize yourself with the Wire Harness (X) and each of the connectors. Coming from the relay should be three branches. Connector A has the T-harness for the tail light assembly. Connector B has the fuse holder with the red and black ring terminals for the battery. Connector C is for the particle separator exhaust fan.

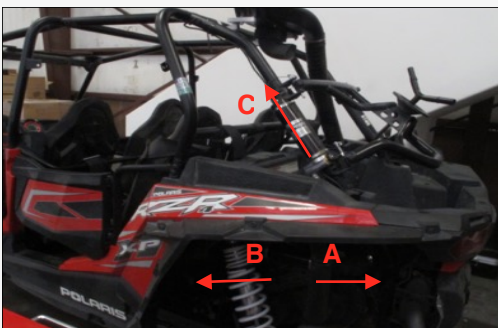
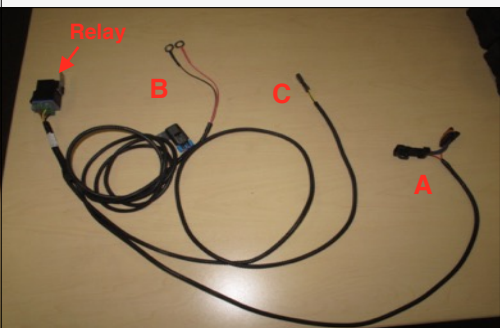

15. Place the Nylon Spacer (W) over the mounting hole. Mount the relay on top of the spacer using the provided Screw (T) and Washer (U) using a screwdriver.



SEE EXPLODED VIEW ON PAGE 8



INSTALLATION MANUAL (CONTINUED)

16. Find Connector A and tuck the wire along the frame towards the tail light assembly.

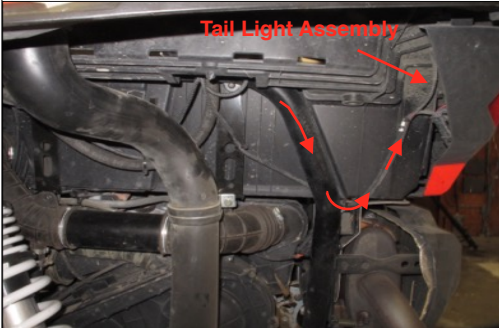

17. Remove the factory male connector on the Driver's side tail light assembly. If necessary use a flat head screwdriver to lift the tab slightly so you can pull the connector out.



18. Connect the male factory connector into the Connector A female connector. Then install the Connector A male connector into the tail light assembly. Use Cable Ties (S) effectively to secure the harness. Route the harness so that the wires will not get damaged or pinched while the UTV is operating. Keep it away from any exhaust components or moving parts.



19. Locate Connector B and run the wire along the back of the fender well to the hole that leads to the battery compartment. Feed the connector through to the other side. Use Cable Ties (S) effectively to secure the harness. Route the harness so that the wires will not get damaged or pinched while the UTV is operating. Keep it away from any exhaust components or moving parts.

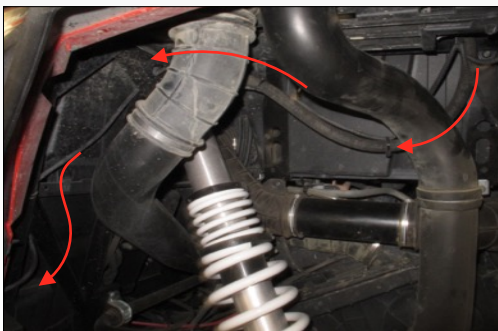
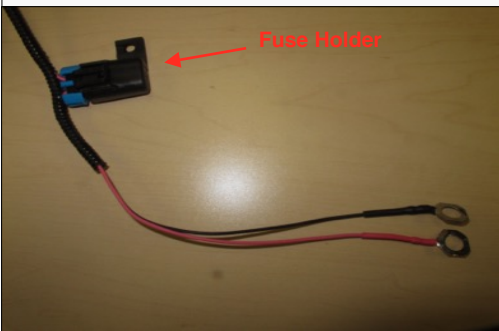

20. Run Connector C up the roll bar and connect the harness into the connector on the Particle Separator (A). Make sure not to cross the connectors. Power to power and ground (black) to ground (black). The connector should snap into each other with very little resistance. Do not try to force the connectors into each other. Use the Cable Ties (S) provided to secure the wire to the roll bar. If desired, insert the Cable Tie Push Mount (V) into one of the holes on the Housing Mount (L) to secure the harness with a cable tie.



SEE EXPLODED VIEW ON PAGE 8



INSTALLATION MANUAL (CONTINUED)

21. Remove the rear seat on the driver's side by pulling the latch under the seat to reveal the battery compartment. If the vehicle is a two-seater, remove the driver's seat.



22. Remove the nut from the negative battery terminal clamp and disconnect the terminal from the battery. Then, remove the nut from the positive battery terminal clamp. Install the ring terminals onto the battery terminal clamps. Red to (+) and Black to (-) and reinstall the nuts. Secure the positive terminal first, replace the rubber terminal boot, then secure the negative terminal. Secure the fuse holder to the hole as shown with a Cable Tie (S). You may have to temporarily loosen the screws holding the fuse box to have access to the mounting hole.

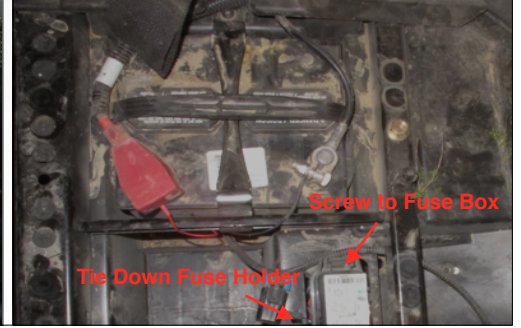

23. Reinstall the seat. There are two tabs at the base of the seat. Slide the tab through metal rail first and then push the seat down. You should hear a click when the adapter on the bottom of the seat snap into the seat adapter.

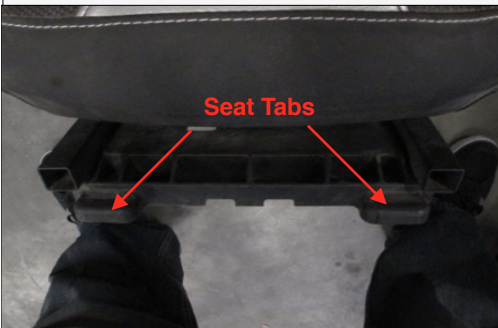

24. Make sure the connectors are all plugged in and secure. Turn the ignition on and make sure air is blowing out the exhaust. If air is not blowing out, double check your electrical connections. When you turn the ignition off, the fan will stay on for several seconds, and is normal. Your installation is now complete. As a side note, S&B recommends that you apply a layer of waterproof grease, such as made by Bel-Ray, on the inside flange of the stock air filter to keep dust from bypassing the seal.



RELATED ITEMS FOR YOUR PURCHASE

- Clutch Ventilation System (Coming Soon)

Order online today at www.sbfilters.com or through your local S&B distributor.

ONGOING MAINTENANCE

Your Particle Separator requires very little if any maintenance depending on where you drive; however, you should check to make sure that none of the openings on front of the Particle Separators are blocked by mud or other debris each time you exit the UTV. You should also make sure the scavenge fan is operating properly. To do so, simply check to make sure the fan is still blowing out air (for about 15-20 seconds) when you turn off your UTV as this is a normal condition. If the fan is not blowing out air or the airflow seems lower than when you initially installed your system, please contact S&B tech support. To clean your Particle Separator, review the cleaning instructions below.

SEE EXPLODED VIEW ON PAGE 8

HOW TO CLEAN YOUR PARTICLE SEPARATOR

1. For a quick cleaning, blow compressed air through the front with the fan on. Doing routine cleaning will prevent any buildup of dirt and debris over time.



2. For a deeper cleaning, disconnect any electrical harness connected to your particle separator. Remove the particle separator from your roll bar by loosening the clamps. Lay the particle separator face down and use a 2.5mm hex key to remove the five screws securing the plenum. Remove the plenum and the back plate underneath. You may also want to place a shop towel down to protect the face plate from any unnecessary scratches. **WARNING:** Do not power the fan on while the particle separator is partially or completely disassembled. Doing so may cause serious injury.

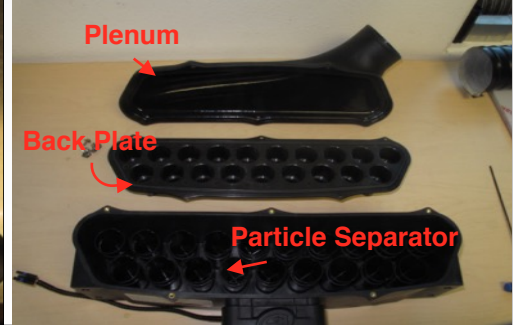

3. Once the back plate is removed, blow compressed air into the particle separator to remove any noticeable debris. Using water is not recommended to clean the particle separator with the fan installed.



4. If compressed air is not available, water can be used only if the fan is removed from the particle separator. Start by removing the four screws securing the fan exhaust using a 2.5mm hex key.



5. Remove the fan exhaust and fan. Note where the fan harness is located and how the fan is sitting on the housing. The fan guard is installed on the exhaust side of the fan. Do not remove the fan guard. Removal of the fan guard will not increase the performance of the particle separator. The fan must be reinstalled the same way it was disassembled.



6. Rinse off the particle separator, plenum, and back plate with low pressure water at an angle to remove any debris. Do not spray water directly at the tubes as this may dislodge the tubes from the housing.



7. If the tubes come out just snap them back in place by aligning the tab on the tube with the notch on the particle separator. Push the tube until it snaps into place.

SEE EXPLODED VIEW ON PAGE 8

HOW TO CLEAN YOUR PARTICLE SEPARATOR (CONTINUED)

8. After cleaning the particle separator, reinstall the fan into the housing. Make sure that the fan guard is positioned as shown. The opening for the wire on the fan should be facing the left side with the front of the housing facing towards you.

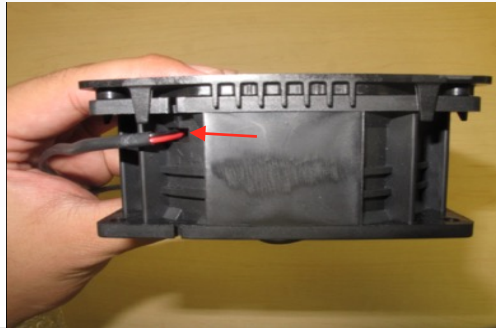
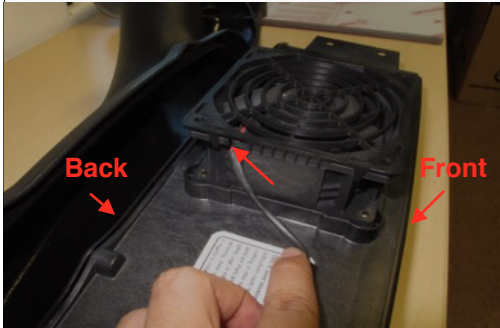

13. Reinstall the fan exhaust. The fan exhaust should be pointed rearward. Insert the two rear screws first before installing the fan exhaust.



11. Align the screws with the holes on the fan.



12. There is a notch on the fan exhaust so make sure that the wire exits there. Hug the wire alongside the body of the fan until the wire reaches the notch.



13. Insert the remaining two screws and washers and tighten all four screws. Do not over tighten and make sure the screws are on finger tight (20 in-lbs).



14. Reinstall the back plate. Be careful and make sure that the tubes line up. Failing to do so may misalign the tubes and cause the tubes to come loose. Make sure that the back plate is fully seated.



15. Push down the edges around the plenum onto the separator.



16. Reinstall the five screws and washers that were taken out. Do not over tighten and make sure the screws are on finger tight (20 in-lbs). The cleaning is complete.



SEE EXPLODED VIEW ON PAGE 8



EXPLODED VIEW

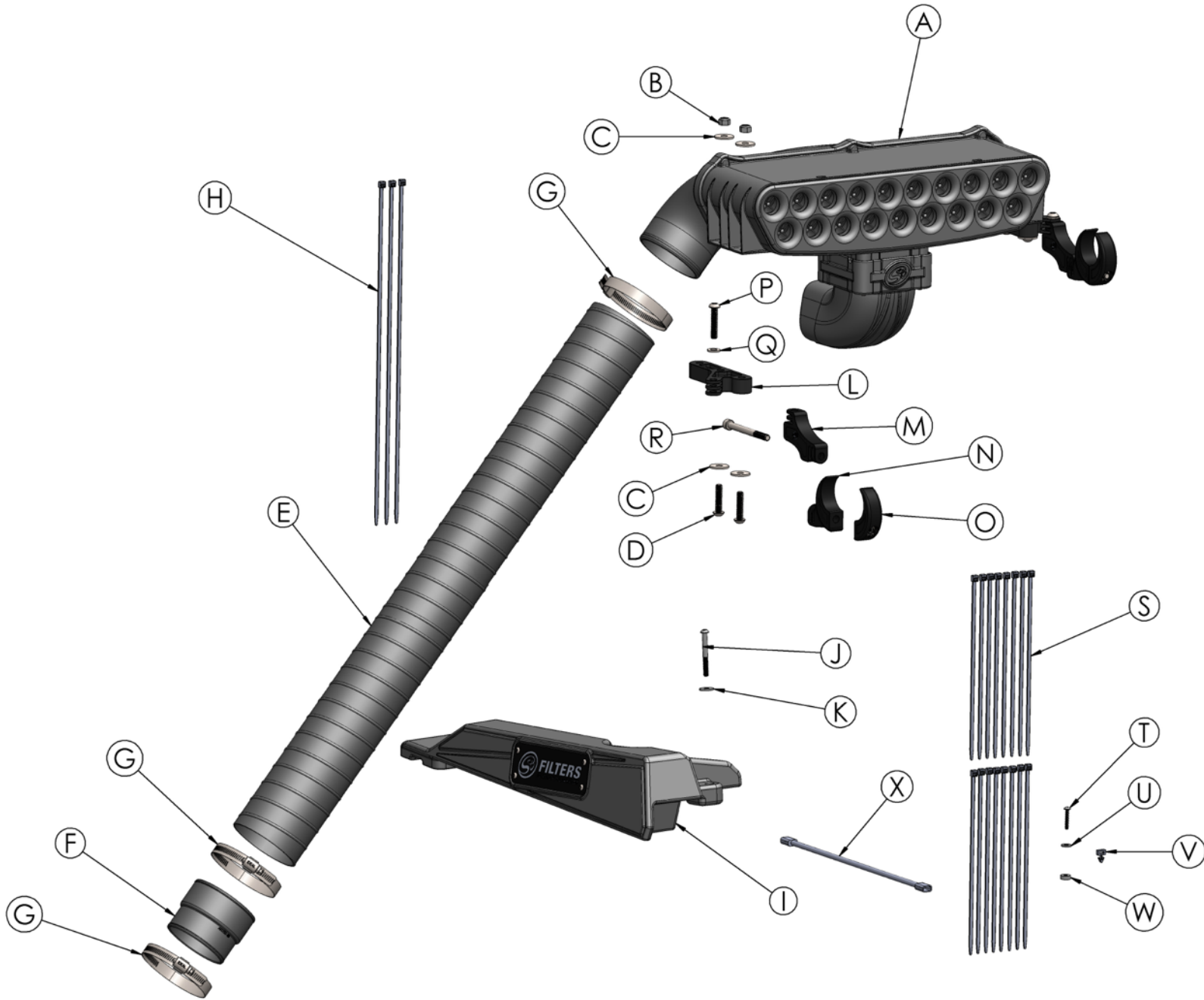

ITEM	QTY.	DESCRIPTION	PART NUMBER	ITEM	QTY.	DESCRIPTION	PART NUMBER
A	1	PARTICLE SEPARATOR	AL1242-00	M	2	CLAMP ADAPTER, 90 DEG	AI1757-02
B	4	M8 X 1.25 LOCKNUT ZINC-PLATED	AI1736-00	N	2	TUBE CLAMP, SCREW SIDE	AI1757-03
C	8	M8 SS FENDER WASHER	AI1742-00	O	2	TUBE CLAMP, NUT SIDE	AI1757-04
D	4	M8 X 1.25 X 35 SS BUTTON HEAD SCREW	AI1741-00	P	2	M8 X 1.25 X 40 SS BUTTON HEAD SCREW	AI1739-00
E	1	3.5" ID FLEXIBLE DUCT CUT TO 39"	AI1735-01	Q	2	M8 SS FLAT WASHER	AI1740-00
F	1	ADAPTER, 3.5" ID DUCT TO 3.25" ID STOCK INLET	AI1731-00	R	2	M8 X 1.25 X 90 SS SOCKET HEAD SCREW	AI1738-00
G	3	HOSE CLAMP, SIZE 56	AG1019-00	S	16	CABLE TIE, 9" LONG	AI1750-00
H	3	CABLE TIE, 17" LONG	AI1753-00	T	1	#10-16 X 1 IN PAN HEAD HI-LO SCREW	AI1746-00
I	1	SIDE COVER	AL1244-00	U	1	SAE FLAT WASHER, #10 ZINC-PLATED	AI1748-00
J	1	M6 X 1 X 55 SS BUTTON HEAD SCREW	AI1754-00	V	1	CABLE TIE PUSH MOUNT, FOR 1/4" HOLE, 0.18" WIDE CABLE TIE	AI1749-00
K	1	M6 SS FENDER WASHER	AI1755-00	W	1	NYLON SPACER, #10, 3/16" LONG	AI1747-00
L	2	HOUSING MOUNT, DUAL POSITION	AI1757-01	X	1	WIRE HARNESS	AI1751-00