

# Wall Plate for Blink Video Doorbell

USER MANUAL



WASSERSTEIN

Thoughtful Products for your Smart Home

## In the Box



1 x wall plate



2 x mount screws



2 x wall anchors

## Safety Information

- Read these instructions carefully before use. Failure to follow the safety instructions may cause injury or damage to your property.
- Small parts contained in the box can be a choking hazard. Keep small parts away from children.
- Only use this mount with the Blink Video Doorbell.

## How to Install

**Note:** before you install the wall mount, take down your Blink Video Doorbell if it is already installed. Detach the doorbell backplate using the opening key that comes with it.

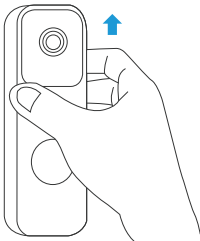
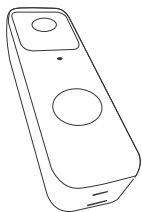

1. Place the backplate in the middle of the wall plate. Line up the holes on the top and bottom.

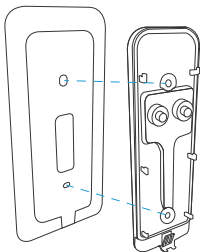

2. Attach the wall plate and backplate to the wall using the screws and anchors provided. The drill bit size is 1/8 in. If your doorbell is hardwired, make sure that the wires go through the cutout and are connected to the backplate before mounting.

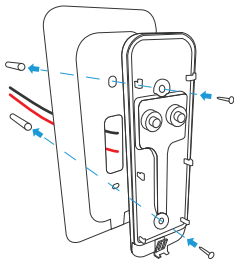

3. Hook the doorbell to the backplate. Press the top in first, then firmly press the bottom in until it clicks.

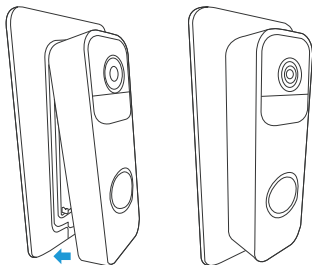

## Specifications

Material:	ABS plastic
Dimensions:	3.1 x 6.4 x 0.2 in
Cutout dimensions:	1.7 x 0.6 in

## Get More Support

Scan the QR code below or email us at [contact@wasserstein-home.com](mailto:contact@wasserstein-home.com).

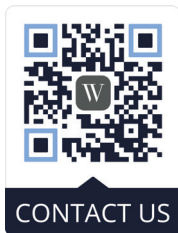

Blink Video Doorbell is not included.  
Blink is the trademark of Immedia Semiconductor, LLC  
Wasserstein is a trademark of Dropcases Ltd.  
Wasserstein is not affiliated with  
Immedia Semiconductor, LLC

**W**  
**WASSERSTEIN**  
[www.wasserstein-home.com](http://www.wasserstein-home.com)  
Made in China