

60 mm

No-drill Mount for
Blink Video Doorbell

USER MANUAL



W
WASSERSTEIN
Thoughtful Products for your Smart Home

In the Box

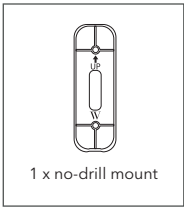

1 x no-drill mount



1 x extra adhesive tape

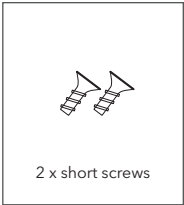

2 x short screws

Page 1

Safety Information

- Read this manual and instructions carefully before use. Failure to follow the safety instructions may cause injury or damage to your property.
- Small parts contained in the box can be a choking hazard. Keep small parts away from children.
- Only use with the Blink Video Doorbell.

Pre-Installation

1. Thoroughly clean the wall surface and let it dry.
2. For best results, tape should be applied at a minimum temperature of 60°F (15°C).
3. Be sure to completely cover the holes around the backplate so water and dirt doesn't get inside and damage your doorbell.

Page 2

Installation

Warning: the surface can be damaged when removing the mount from the wall.

1. Remove the protective film without touching the adhesive.

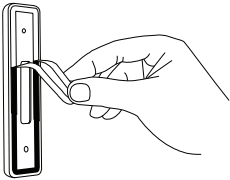

2. Carefully attach the mount in one go, since the tape cannot be repositioned once it touches the surface.

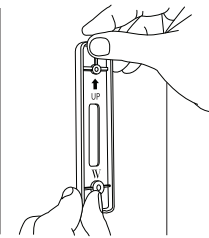

3. Apply strong pressure to the mount to ensure maximum adhesion.

Page 3

4. Use the short screws provided to install the doorbell's backplate onto the mount.

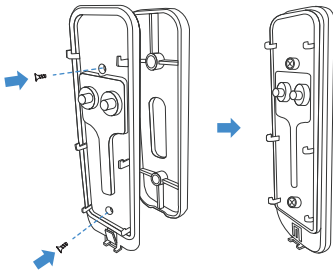

5. Line up the back of the doorbell with the hooks on the backplate. Push the top in first, then push the bottom in, so it clicks firmly into place.

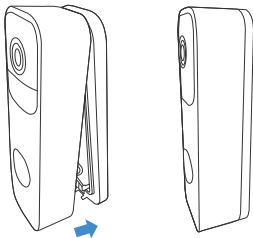

Page 4

6. To replace the doorbell battery, remove it from the mount using the key that comes with the doorbell.

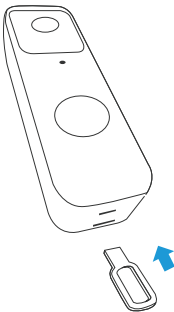

Page 5

Removing the Mount

1. First, remove the doorbell and backplate from the mount.
2. Slowly twist and pull the mount from the top and bottom. Gently lift it up to prevent damage to the wall.

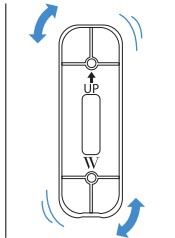

3. Remove the tape by pulling it downwards. Wipe off any leftover residue.

FAQ

What kind of wall can I attach the mount to?

The mount will stick to most smooth surfaces, such as tile, marble, glass, metal, plastic, or wood. It will not stick to brick, stucco, or wall paper.

Get More Support

Scan the QR code below or email us at: contact@wasserstein-home.com

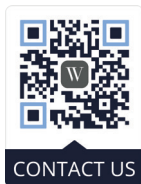

CONTACT US

Blink Video Doorbell is not included.
Wasserstein is not affiliated with Immedia Semiconductor Inc.
Wasserstein is a trademark of Dropcases Ltd.

W
WASSERSTEIN
www.wasserstein-home.com
Made in China

240 mm