

WTag

USER MANUAL



Works with

Apple Find My

W

WASSERSTEIN

Smart Home. Smarter Living

Find lost items effortlessly with WTag

Locate Your Item

The Apple® Find My® network provides an easy, secure way to locate compatible personal items on a map using the Find My app on your iPhone®, iPad®, or Mac®. Simply pair your compatible product with the Apple Find My app to view it right alongside your Apple devices. If your item ever goes missing, you can put it in Lost Mode to display a message and contact information to anyone who might find it. The Find My network is encrypted and anonymous, so no one else, not even Apple or the maker of your personal item, can view its location.

Product Description

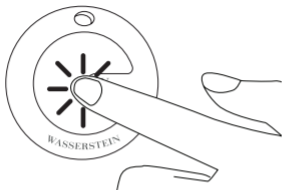

- 1. Power on**
Click the button (long beep)
- 2. Power off**
Hold the button for 3 seconds (beep twice)
- 3. Play Sound**
Press "Play Sound" in Find My app (beep 13 times)
- 4. Remove Item**
Press "Remove Item" in Find My app (long beep)
- 5. Reset**
Click the button 5 times and hold it until there is a long beep (Need to remove WTag from Find My app before reset it)

Battery

The WTag necessitates the use of a CR2032 battery, which might require replacement over the course of its lifespan. When replacing the battery, ensure that only the same type and rating of battery with the correct polarity are used.

Replacing the battery

1. Open the back cover through the gap between the top and bottom cover.
2. Remove the existing battery.
3. Insert the CR2032 battery into the device with the positive (+) side facing up
4. Assemble the top and bottom cover and press tightly.

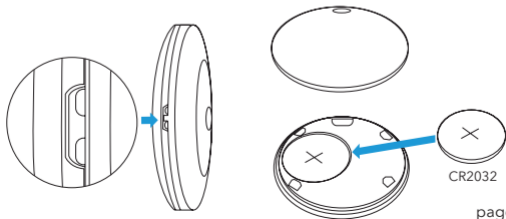

Start Guide

1. **Power On / Off**

Press the center button to activate WTag

2. **Add Your WTag**

- Open the "Find My" app, select the "Items" tab and tap on the "Add Item" icon.
- Choose "Other Supported Item" then tap "Connect" once WTag is recognized.
- Enter a name for your device and choose an emoji to represent it, then tap "continue".
- Confirm your Apple ID. Tap "agree" and "finish" to proceed.
- Congratulations! Your WTag has been successfully set up and is ready to use

3. **Find Your WTag**

- Open the "Find My" app, select the "Items" tab and choose the item you are looking for.
- Tap on "Play Sound" to enable the beeping sound on your WTag,.
- Once you have located your WTag, tap on "Stop Sound" to stop the beeping.

- (Alternatively, if you have an Apple Watch®, you can also use the Find Items app on your Apple Watch® to locate your WTag.)

4. **Locate Your WTag**

- Open the “Find My” app, select the “Items” tab and choose the item you are looking for.
- The location of your WTag will appear on the map along with a timestamp indicating when the item was last located.
- Tap “Direction” to navigate to your lost item’s location.
- (Alternatively, if you have an Apple Watch, you can also use the Find Items app on your Apple Watch to locate your WTag.)

5. **Enable Lost Mode**

- Open the “Find My” app, select the “Items” tab and choose the item you are looking for.
- Scroll down and tap the “Lost Mode” section.
- NOTE: When Lost Mode is enabled, the “Notify When Found” feature will automatically be enabled as well. Additionally, your WTag will not be able to pair with a new iOS® device while Lost Mode is active.
- (Alternatively, if you have an Apple Watch, you can also use the Find Items app on your watch to enable Lost Mode for your WTag).

Factory Reset

- Open the Find My app and navigate to the "Items" tab.
- Select the relevant item and ensure that the "Lost Mode" is disabled.
- Scroll down to the bottom of the screen and tap on "Remove Item."
- A pop-up window will appear. Confirm the removal by tapping on "Remove."
- Once the WTag has been successfully removed from the Find My app, proceed to the next step.
- Press the on / off button five times and hold it until you hear a beep sound.
- The WTag has now been reset and is ready to be paired with a new iOS device.

Safety Information

Please be advised that proper handling and care of the WTag is of utmost importance. It incorporates delicate electronic components, including batteries, and mishandling may result in damage, functional impairment, or potential injury. To ensure longevity and optimal performance, it is crucial to avoid dropping, burning, puncturing, crushing, disassembling, or exposing it to excessive heat, liquids, or environments with high concentrations of industrial chemicals. Furthermore, it is imperative not to utilize a damaged WTag under any circumstances.

Specifications

Model:	WTag
Material:	ABS
Dimensions:	Dia 1.6"
Weight:	9 g (0.3 oz)
Battery Type:	CR2032 (included)
Battery Life:	> 1 year (Note: this is an estimate on typical usage and may not reflect your actual usage)
Connectivity:	Bluetooth
Compatibility:	iPhone 6s above; iOS®14.5 or above

Notice

Use of the Works with Apple badge means that a product has been designed to work specifically with the technology identified in the badge and has been certified by the product manufacturer to meet Apple Find My network specifications and requirements. Apple is not responsible for the operation of this device or use of this product or its compliance with safety and regulatory standards.

Apple, Apple Find My, Apple Watch, Find My, iPhone, iPad, iPadOS®, Mac, macOS® and watchOS® are trademarks of Apple Inc., registered in the U.S. and other countries. iOS is a trademark or registered trademark of Cisco in the U.S. and other countries and is used under license

Get More Support

Scan the QR code below or email us at
contact@wasserstein-home.com



W

WASSERSTEIN

www.wasserstein-home.com

Wasserstein is not affiliated with Apple, Inc.
Wasserstein is a trademark of Dropcases Ltd.

Made in China