

# Pogo Pin Cable and Adaptor for Nest Cam (battery)

## User Manual



W  
WASSERSTEIN

### In the Box

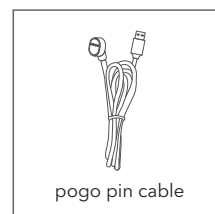

pogo pin cable

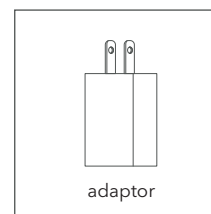

adaptor

Refer to the illustration below for setting up the pogo pin cable with your Nest Cam:

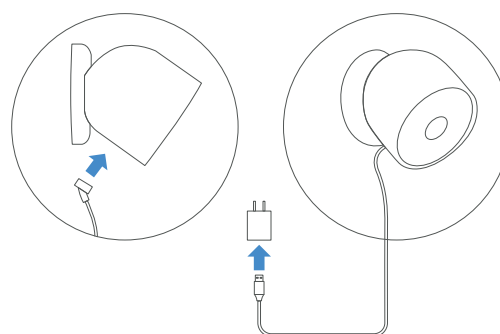

Page 1

### How to Install

1. Mount your Nest Cam.

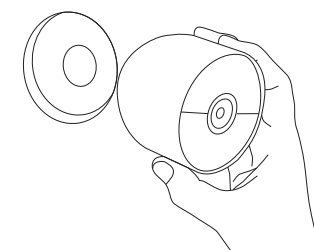

2. Plug the pogo pin end of the cable into your Nest Cam.

**Note:**

Cable must be facing toward you to connect to the Nest Cam.

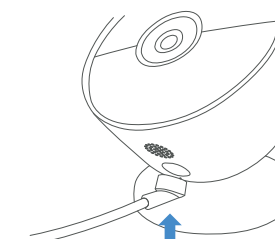

Page 2

3. Plug the USB end of the cable into the adaptor provided.

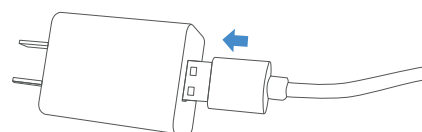

4. Plug the adaptor into an outlet.

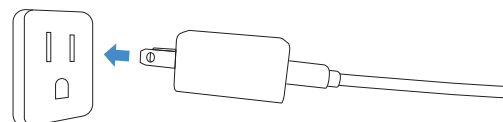

Page 3

5. After the pogo pin is connected, open the Google Home app on your mobile device to confirm it is synched and ready to use.

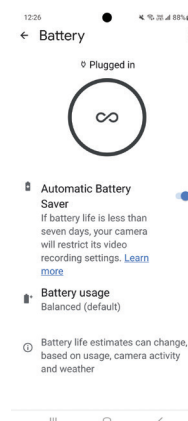

### Specifications

Adaptor output: 5.2V DC, 2A  
Adaptor input: 100 - 240V AC, 50/60Hz  
Cable length: 26.25 ft

Page 4

### Get More Support

Scan the QR code below or email us at:  
contact@wasserstein-home.com



Google Nest Cam (battery) is not included.  
Google Nest Cam is a trademark of Google LLC.  
Wasserstein is not affiliated with Google LLC.  
Wasserstein is a trademark of Dropcases Ltd.

W  
WASSERSTEIN  
www.wasserstein-home.com  
Made in China