

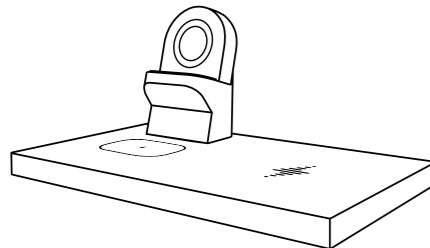

# 3-in-1 Modular Wireless Fast Charging Stand

Compatible with Samsung, Apple, Google, LG and other Qi-compatible devices

User Manual



One charging stand to wirelessly charge your Smartphone, Smartwatch, and Wireless Buds.

## Table of Contents

Package Includes	2
Safety Information	2
Feature	2
Introduction	3
Installation	3
Compatibility	4
Charging your devices	4
Charging your smartphone	4
Charging your smartwatch	5
Charging your wireless buds	5
Troubleshooting	5
Specifications	5

Need help? Send us an email at: [contact@wasserstein-home.com](mailto:contact@wasserstein-home.com) Page 1 - 5

## Package Includes

- 1 x USB Samsung Watch Charger Module
- 1 x USB Apple Watch Charger Module
- 1 x Wireless Charging Station
- 1 x USB Type-C Cable
- 1 x Power Adapter
- 1 x User Manual

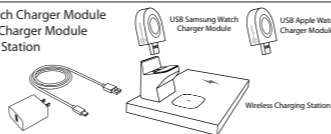

## Safety Information

- Do not disassemble or put this wireless charging stand into water or fire.
- Please use it in the temperature range of 14 to 113°F (-10 to +45 °C). Store it in the temperature range of -40 to 158°F (-40 to +70 °C) to avoid equipment failure.
- Do not use it in severe damp or corrosive environments to avoid circuit damage.
- Do not place magnetic or magnetic cards (ID Card, Bank Card, etc.) too close to this wireless charging stand to avoid magnetic card failure.
- Do not allow children or pets to play with it to avoid injuries and accidents.
- Do not use unauthorized or incompatible power adapters to avoid damage to this wireless charging stand.

## Feature

- **3-in-1 Modular Wireless Charger**  
Wasserstein 3-in-1 Modular Wireless Charging Stand can charge your smartphone, smartwatch, and wireless buds at the same time. Easy to use and delivers reliable fast charging.
- **Fast Wireless Charging**  
Designed to work seamlessly with the latest wireless technology, the 3-in-1 Modular Wireless Charging Stand delivers up to 10W charge to charge your devices wirelessly.

Need help? Send us an email at: [contact@wasserstein-home.com](mailto:contact@wasserstein-home.com) Page 2 - 5



- **USB Watch Charger Module**  
The USB Watch Charger Module can be used alone and deliver up to 2.5W charge. Can be easily connected to power adapters, laptops, etc.



- **Wireless Buds Wireless Charging**  
Easily charge your Galaxy Buds/Buds+, AirPods 2/Pro with the 5W wireless charging.

## Introduction

The Wasserstein 3-in-1 Modular Wireless Charging Stand consists of an independent Watch Charging Module and has separate wireless charging areas for smartphones and smartwatches. Refer to the diagram for more details.

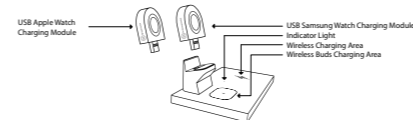

## Installation

Connect the USB Type-C end of the included charging cable to the wireless charging stand and the USB Type-A end of the cable either to the included power adapter or a laptop. The indicator light will turn on once it connects successfully to a power source.

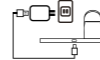

Note: Please keep this wireless charging stand connected to the power source at all times when charging your other devices. This wireless charging stand does not have any battery component and thus, you need constant power to operate it.

Need help? Send us an email at: [contact@wasserstein-home.com](mailto:contact@wasserstein-home.com) Page 3 - 5

## Compatibility

Smartphones	iPhone 11/ 11 Pro/ 11 Pro Max/ XS/ XS Max/ XR/ X/ 8/ 8 Plus Samsung Galaxy S9/ S9 Plus/ S8/ S8 Plus/ S7/ S7 Plus Edge/ S6/ S6 Plus Edge LG G10/ G3/ G2 Nokia Lumia 930/ 1010/ 830/ 1520/ 920
Smartwatches	Samsung Galaxy Watch 42mm/46mm Samsung Galaxy Watch Active/Active 2 Samsung Gear Sport/Gear S3 Apple Watch
Wireless Buds	Galaxy Buds. Galaxy Buds+ AirPods 2, AirPods Pro

## Charging your devices

To begin charging your device, ensure that this wireless charging stand is connected to a power source, either to a power adapter or a laptop.

## Charging your smartphone

Place your smartphone on the induction area of the wireless charging area for charging. Once successfully placed, your smartphone will begin charging automatically.



Need help? Send us an email at: [contact@wasserstein-home.com](mailto:contact@wasserstein-home.com) Page 4 - 5

## Charging your smartwatch

Place your smartwatch on the magnetic puck of the watch charging module bracket for charging. Once successfully placed, your smartwatch will begin charging automatically.



The watch charging module bracket can be taken out and used on its own. Just plug its USB-A end to the USB Port of either a power adapter or a laptop, and place your smartwatch on a magnetic puck for charging.

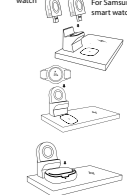

## Charging your wireless buds

Place your smartwatch on the headset wireless charging area close to the watch charging module bracket for charging.

## Troubleshooting

1. My devices are not being charged by the 3-in-1 Modular Wireless Charging Stand.

Ensure that the Modular Wireless Charging Stand is connected to a power source.

Check if the indicator light turns on after you connect the Modular Wireless Charging Stand to a power source.

## Specification

Power Input	: 5V3A, 9V2A
Charging Efficiency	: >75%
Charging Power	: 5W/7.5W/10W (Smart Phone) 5W (Buds); 2.5W (Watch)

Wasserstein is a trademark of Dropcases Ltd.  
Wasserstein is not affiliated with Samsung Inc., Apple Inc., Google LLC., LG Inc., Nokia Inc.



Need help? Send us an email at: [contact@wasserstein-home.com](mailto:contact@wasserstein-home.com) Page 5 - 5