

Mini Aroma Diffuser

User Manual

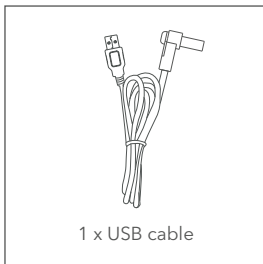

In the Box

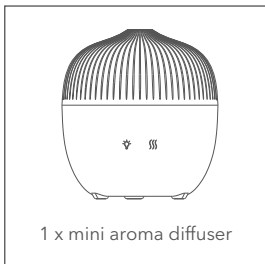

Warning

1. Children should never be left unattended when this device is on or plugged in.
2. Keep away from other heating sources while in use, such as portable heaters, radiators, stoves, open flames, etc.
3. Keep away from dust, dirt, smoke, and chemical/corrosive materials.
4. Make sure to clean and store safely after use.
5. Clean this device thoroughly before adding essential oil.
6. Overuse can cause damage to the device.
7. Only use 100% natural oils with this device, chemicals can damage the device.
8. Never drop or knock over this device.
9. Do not overfill with water.
10. This device can be affected by water type, humidity, temperature, and air currents.
11. Never switch on this device when the tank is empty.

Introduction to Parts

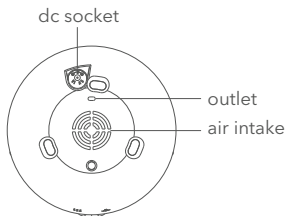
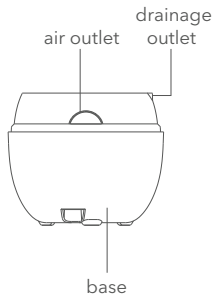
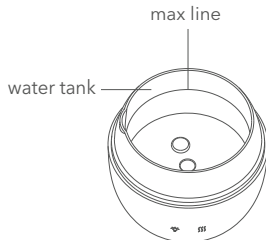
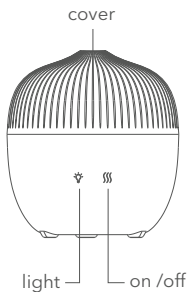

How to Use

1. Plug one end of the USB cable into the device. Plug the other end into a USB adapter or wall outlet.

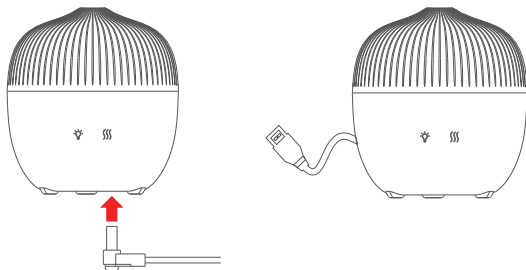

2. Remove the water tank cover. Using a measuring cup to pour water into the water tank (room - temperature). Do not exceed the max water line.

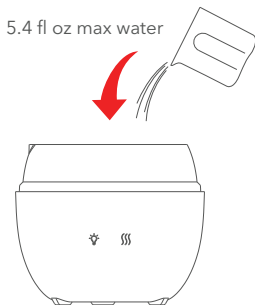

3. Add 5 - 10 drops of essential oil into the tank (optional / not included).

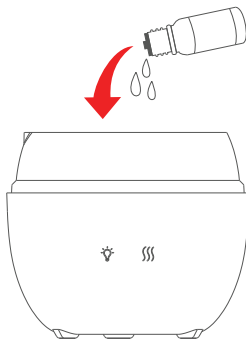

4. Place the cover back on the water tank.

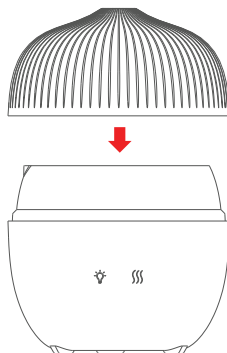

5. To turn on / off, press the mist button on the side of the diffuser. Press once for continuous mist for around 10 hours of use. Press twice for intervals of 15 seconds on, 15 seconds off, and up to 20 hours of use.

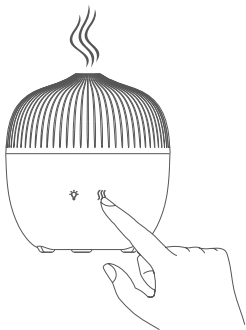

Note: Device will turn off automatically if it runs out of water.

6. Press the light button on the side of the diffuser to turn on and change the light color to your preference.

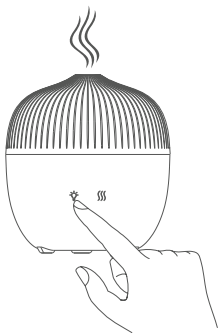

Accidental Leakage

In the event the device gets knocked or tipped over during use, please do the following:

1. Unplug the device and remove the cover.
2. Pour out any remaining water from the water tank.
3. Gently shake out any remaining water and let the device air dry for 24 hours.

Cleaning Guidelines

It is recommended that you clean the device after using it every 5 - 6 times. Clean as follows:

1. Turn off the power and unplug the USB cable from the device.
2. Remove the cover.
3. Pour out any remaining water from the drainage outlet.



4. Pour a small amount of cleaning detergent and dilute it with water (use neutral detergents only).
5. Dip a soft cloth into the detergent and gently wipe around the inside of the tank, removing any dirt or built-up residue.

Troubleshooting

If the device fails to operate, please refer to the following:

Device fails to turn on.	Check the water level. Add water if there is not enough, reduce water if it is above the max line.
The device shut off suddenly.	Check the water level. Check the USB connection to the device / outlet. Unplug and plug back in.
There is no mist or the mist is abnormal.	Check the water level. There may be some dirt or built-up residue. Clean the device thoroughly (including the air intake).
Water leaking from the product.	Check the device thoroughly. If there is no damage, check the temperature and humidity levels in the room (low temperatures and high humidity may cause the water to condense too quickly).

Specifications

Size:	4.7 x 4.7 x 5.1 in
Weight:	8.2 oz
Input:	DC 5V 1A
Cable length:	4.9 ft
Electric consumption:	5 W
Mist mode:	continuous / intermittent
Water capacity:	5.4 fl oz
Material:	PP / ABS
Accessories:	USB cable
Ultrasonic vibration:	3 M

Get More Support

Scan the QR code below or email us at: contact@wasserstein-home.com



CONTACT US



www.wasserstein-home.com

Made in China