

# SLRP SERIES Commercial Lighting

SLRP-8FT-40-80W-MCTP  
PREMIUM STRIP-LIGHT LED RETROFIT KIT WITH LENS  
**MCTP** Multi Color Temperature & Multi Power/Wattage (Selectable)

Customer Name: \_\_\_\_\_  
Project Name: \_\_\_\_\_  
Note: \_\_\_\_\_ | Type: \_\_\_\_\_

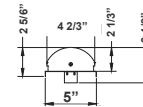
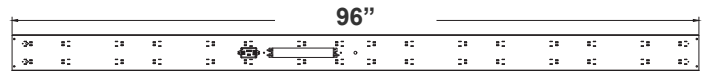

96"(L) x 4 2/3"(W) x 3 4/9"(H)

LED Strip Light is a cost-effective, energy-efficient lighting fixture for surface mount applications such as corridors, stairwells, public rooms, schools, hospitals utility areas, etc. Engineered with stable performance LED engines and the world's top brand LED driver. Same footprint as traditional 2-lamp strip lights

## Features

- LED Strip Lights
- Strip Line Cover
- 5-Year Warranty
- 50,000 Hours Rated Life
- Lens: Frosted Diffuse Polycarbonate Lens with Strip Lines Inside
- MCTP: Multi Color Temperature & Multi Power/Wattage (Selectable Switch Inside Fixture)

## Technical Specifications

### Electrical:

- Voltage: 120-277VAC 50/60Hz
- Wattage: 40W/60W/80W
- Power Factor: >0.98
- Efficacy: 127 LPW

### Mechanical:

- White Finish
- Housing: Heavy Die-Formed Steel, White Powder Coated
- Lens Snaps into the tabs of the Housing Fixture
- Ceiling-Mounted
- Same Footprint as Traditional 2-lamp Strip Lights
- Mounting: Surface Mount, Wall Mount or Suspended
- Operating Temperature: -22°F -104°F
- IP Rating: IP44

### Lighting:

- Dimmable: 0~10V Dimming
- Chip: Samsung
- Total Lumens: 10160LM Max.
- Color Temperatures: 3500K/4000K/5000K
- Multi-CCT (selectable switch inside fixture)
- Color Rendering Index: CRI ≥ 80

### Applications:

- Ideal for architectural lighting solutions, a variety of industrial, commercial and residential applications

### Other Models:

- 40W | 5080LM | SLRP-4FT-20-40W-MCTP



## Photometrics: SLRP-8FT-40-80W-MCTP

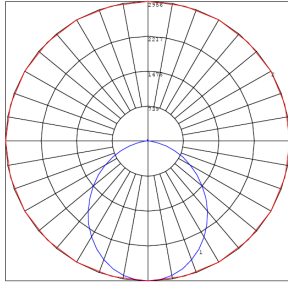
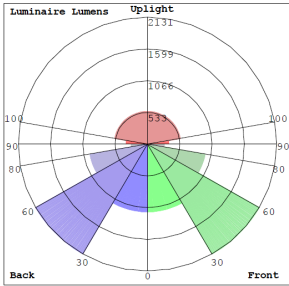

BUD Rating: B3-U4-G3

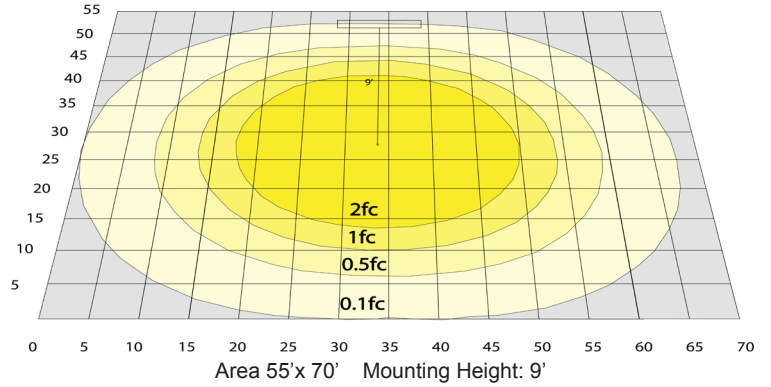

## Other Views:



Front View

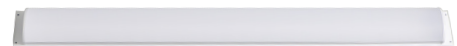

Side View

## Performance Table: SLRP-8FT-40-80W-MCTP

MODEL NO.	Wattage	Voltage	Lumens	Color Temp.	BUG Rating	LPW
SLRP-8FT-40-80W-MCTP	40W 60W 80W	120~277V	5080LM 7620LM 10160LM	3500K 4000K 5000K	B3-U4-G3	127

## Sample Ordering

Model	Size	Wattage	Wattage	Color Temp.
SLRP	8FT	40	80W	MCTP

## Accessories:

Blank = No Option For Accessories  
 LSL-4FT-WG = WIRE GUARD KIT FOR 4FT. STRIP LIGHT  
 LSL-4FT-WK = SHOP LIGHT WING KIT

## Factory-Installed Options:

Blank = No Option For Accessories  
 OPT-EM-CM1INT= INTERNAL EMERGENCY BACKUP BATTERY  
 OPT-SEN-2US= ULTRASONIC BI-LEVEL DIMMING  
 OPT-SEN-2USRC = OPTIONAL RC  
 OPT-SEN-LLHB-OC1 = LLHB-OC1 EXTERNAL STANDARD PIR OPT-SENSOR  
 OPT-SEN-DAYLIGHT = DAYLIGHT HARVESTING SENSOR WORKS WITH ABOVE OPT-SEN-2US

## FACTORY-INSTALLED OPTIONS:



OPT-EM-CM1INT



OPT-SEN-2US



OPT-SEN-LLHB-OC1



OPT-SEN-2USRC



OPT-SEN-DAYLIGHT

