

# LCFD SERIES RESIDENTIAL LIGHTING

LCFD-MCT5-BK

12" LED VINTAGE PENDANT LIGHTS

**WESTGATE**  
THE FUTURE IS HERE...AND IT'S QUITE BRIGHT!



Pendant lights are stylish hanging light fixtures that double as task lighting. Perfect for kitchens, office or living areas, our vintage pendant lighting is available in 2 finishes that will look good in any home.

Customer Name: \_\_\_\_\_

Project Name: \_\_\_\_\_

Note: \_\_\_\_\_

Type: \_\_\_\_\_

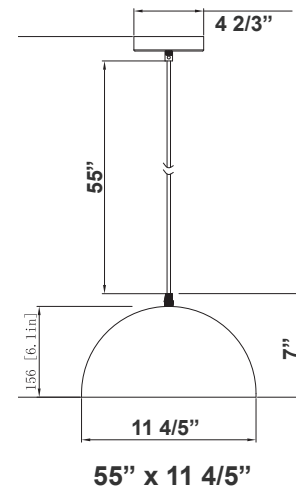

## Features

- Multi CCT (Selectable Switch under the lens)
- Black Finish
- 5-Year Warranty
- Polycarbonate lens

## Technical Specifications

### Electrical:

- Voltage: 120V AC 50/60Hz
- Wattage: 25W
- Power Factor: >0.90
- Efficacy: 52 LPW

### Mechanical:

- Black Finish
- Spun Steel Housing
- Polycarbonate Lens
- Power Cord is 60" Long
- Maximum Ambient Temperature: -22°F to 104°F
- IP20 indoor only

### Lighting:

- Dimming: TRIAC Dimming (Dimmable Down to 5% Compatible with Traic and ELV Dimmers)
- Total Lumens: 1300LM
- Color Temperatures: 2700K/3000K/3500K/4000K/5000K
- Multi CCT (Selectable Switch under the lens)
- Color Rendering Index: CRI ≥ 90
- Beam Angle: 120°
- Rated life: 50,000 Hrs

### Applications:

- Pendant lights are stylish hanging light fixtures that double as task lighting. Perfect for kitchens, office or living areas, our vintage pendant lighting is available in 2 finishes that will look good in any home.

### Other Models:

- 25W | 1300LM | LCFD-MCT5-WH



Phone: (877) 805-2252 | Fax: (877) 805-2252  
www.westgatemfg.com



## Photometrics: LCFD-MCT5-BK

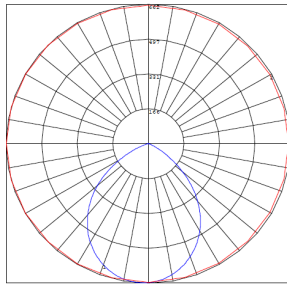
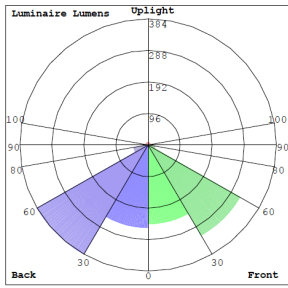

BUG Rating: B1-U1-G0

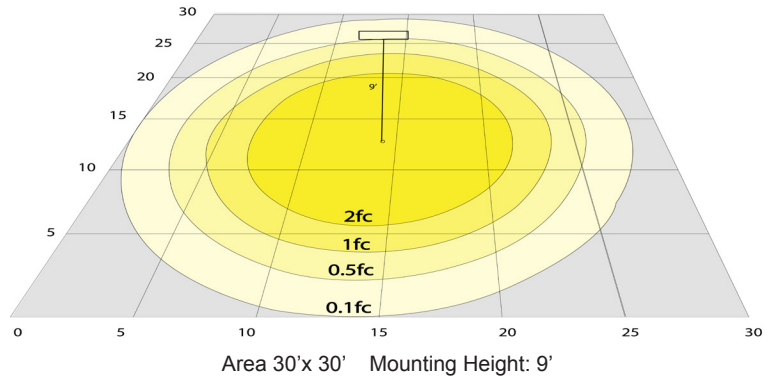

## Other Views:



Side View



Front View



Lens View

## Performance Table: LCFD-MCT5-BK

MODEL NO.	Wattage	Voltage	Lumens	Color Temp.	BUG Rating	LPW
LCFD-MCT5-BK	25W	120V	1300LM	2700K/ 3000K/ 3500K/ 4000K/ 5000K	B1-U1-G0	52

## Sample Ordering

Model	Power	Finish
LCFD	MCT5	BK

## Example:

1. LCFD-MCT5-BK

(FOR LCFD 25W MCT5 FIXTURE 120V)

## Other Model:

LCFD-MCT5-WH



Side View



Front View



Lens View

