

Refrigerator
SIDE BY SIDE SERIES



SmartHome



Download the app
& activate product

USER MANUAL

MDRS791MIE45

Warning notices: Before using this product, please read this manual carefully and keep it for future reference. The design and specifications are subject to change without prior notice for product improvement. Consult with your dealer or manufacturer for details. The diagram above is just for reference. Please take the appearance of the actual product as the standard.

THANK YOU LETTER

Thank you for choosing Midea! Before using your new Midea product, please read this manual thoroughly to ensure that you know how to operate the features and functions that your new appliance offers in a safe way.

CONTENTS

THANK YOU LETTER	01
SPECIFICATIONS	02
PRODUCT OVERVIEW	03
PRODUCT INSTALLATION	05
OPERATION INSTRUCTIONS	12
APP SETUP AND OPERATION	17
CLEANING AND MAINTENANCE	19
TROUBLESHOOTING	20

SPECIFICATIONS

Product model	MDRS791MIE45
Fresh food compartment Volume	390L
Freezer compartment Volume	220L
Rated Defrost Power	196W
Lamp Rated Power	5W
Refrigerant,Amount	R600a,74g
Rated Voltage/Frequency	220-240V~/50Hz
Rated Current	1.9A
Temperature Rise Time	7h
Freezing Capacity	12kg/24h
Product Overall Dimensions (W x D x H)	910 x 698 x 1775mm

PRODUCT OVERVIEW

Names of components

Normal type

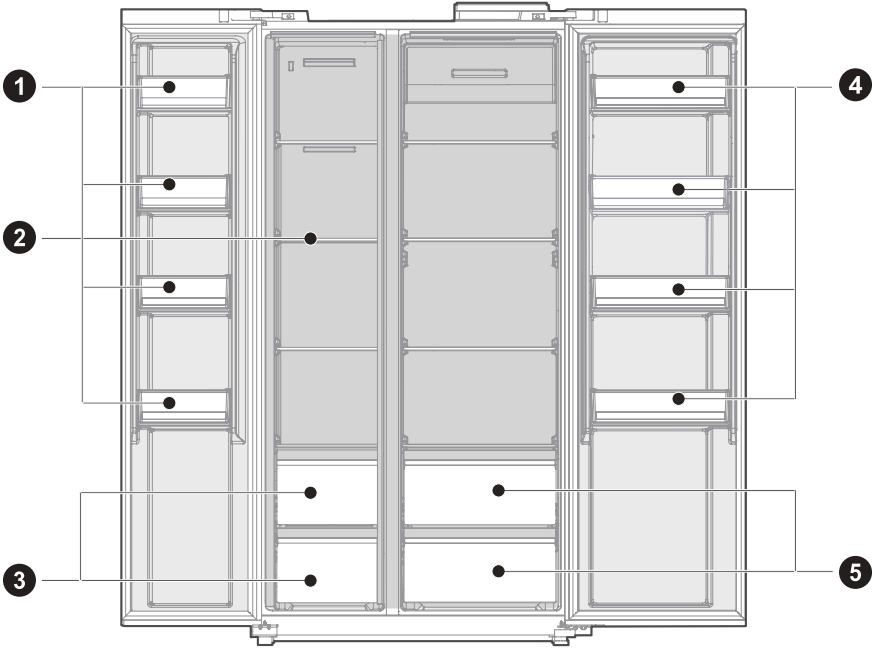

1 Door Tray

2 Glass Shelf

3 Drawer

4 Door Tray

5 Fruits And Vegetables Box

ATTENTION

The picture above is only for reference. The actual configuration will depend on the physical product or statement by the distributor

Dispenser type

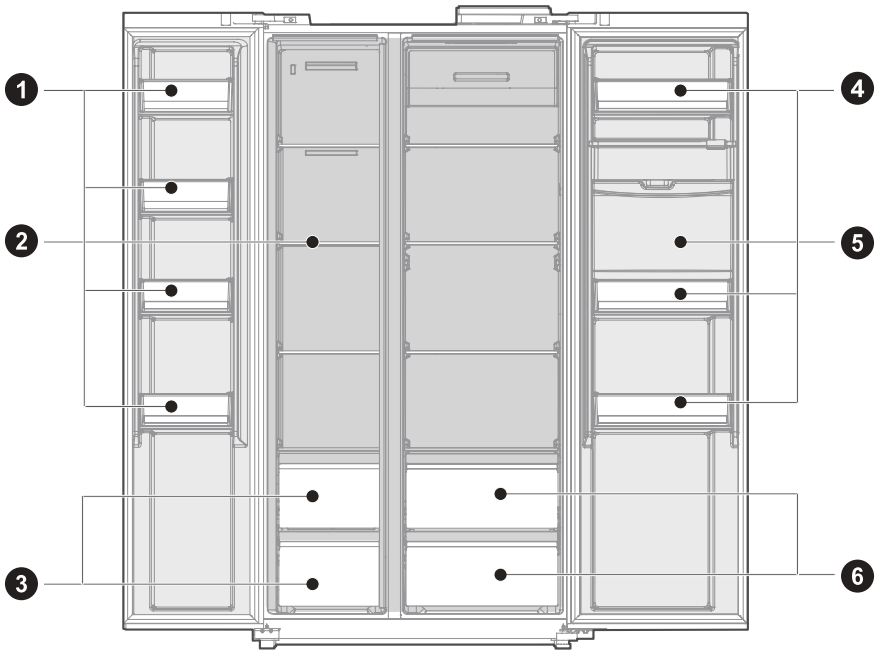

1 Door Tray

2 Glass Shelf

3 Drawer

4 Door Tray

5 Water Dispenser (Optional)

6 Fruits And Vegetables Box

● ATTENTION

The picture above is only for reference. The actual configuration will depend on the physical product or statement by the distributor

PRODUCT INSTALLATION

Install Instruction

For refrigerating appliances with climate class

- Depending on the climate class, This refrigerating appliance is intended to be used at ambient temperatures range as specified following table.
- The climate class can be found on the rating plate. The product may not operate properly at temperatures outside of the specific range.
- You can find the climate class on the product label.

Effective temperature range

- The product is designed to operate normally in the temperature range specified by its class rating.

Class	Symbol	Ambient temperature range °C	
		IEC 62552 (ISO 15502)	ISO 8561
Extended temperate	SN	+ 10 to + 32	+ 10 to + 32
Temperate	N	+ 16 to + 32	+ 16 to + 32
Subtropical	ST	+ 16 to + 38	+ 18 to + 38
Tropical	T	+ 16 to + 43	+ 18 to + 43

Dimensions and Clearances

- Too small of a distance from adjacent items may result in the degradation of freezing capability and increased electricity costs. Allow over 100 mm of clearance from each adjacent wall when installing the appliance.

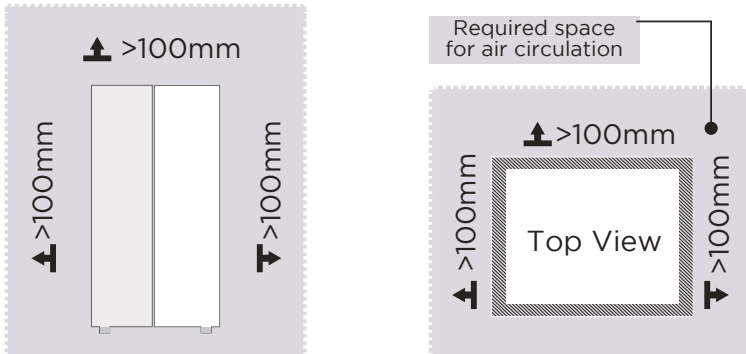

ATTENTION

The picture above is only for reference. The actual configuration will depend on the physical product or statement by the distributor

Space requirement diagram (when the door is open and when the door is closed)

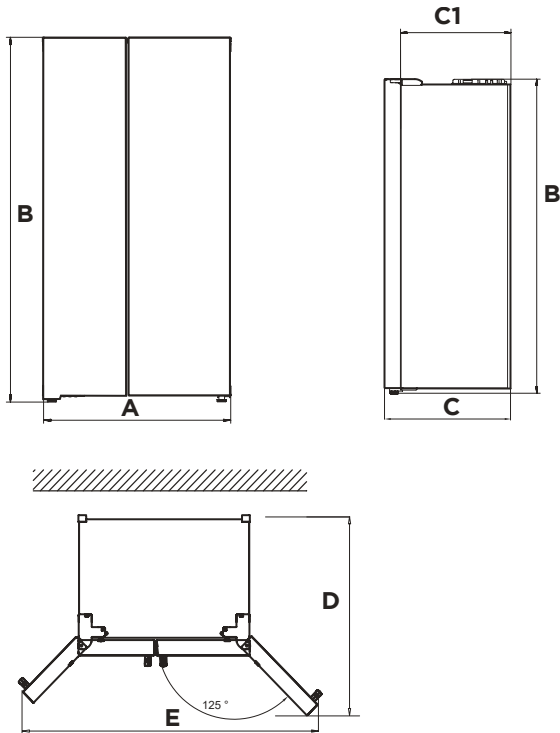

Width	Overall Height	Depth	Without door	Depth doors open 125°	Width doors open 125°
A	B	C	C1	D	E
910	1775	698	617	1010	1470

Notice: All dimensions in mm

Leveling feet

To avoid vibration, the unit must be leveled.

If required, adjust the leveling screws to compensate for the uneven floor.

The front should be slightly higher than the rear to aid in door closing.

Leveling screws can be turned easily by tipping the cabinet slightly.

Turn the leveling screws counterclockwise ↺ to raise the unit, clockwise ↻ to lower it.

Leveling doors

If the doors are not at the same height, the door can be adjusted with a spanner.

A- To raise the door, turn the nut (1) anticlockwise.

B- To lower the door, turn the nut (1) clockwise.

C- When the door is correctly aligned, fix it with the nut (2).

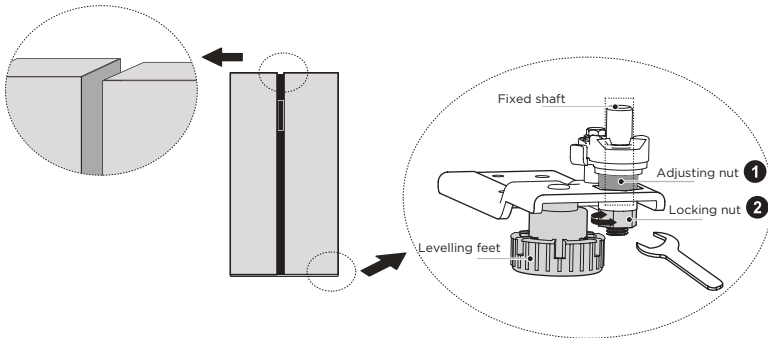

Moving the appliance

1. Remove all food from inside the appliance.
2. Pull the power plug out, insert and fix it into the power plug hook at the rear or on top of the appliance.
3. Tape parts such as shelves and the door handle to prevent from falling off while moving the appliance.
4. Move the appliance with more than two people carefully. When transporting the appliance over a long distance, keep the appliance upright.
5. After installing the appliance, connect the power plug into a socket out to switch on the appliance.

● ATTENTION

Precautions before operation:

Before making changes the refrigerator must be disconnected from power. precautions should be taken to prevent any personal injury.

Changing the light

- Any replacement or maintenance of the LED lamps is intended to be made by the manufacturer, its service agent or similar qualified person.

ATTENTION

This product contains two light sources of energy efficiency class (G).

Connecting the appliance

After installing the appliance, connect the power plug into a socket outlet.

ATTENTION

After connecting the power supply cord (or plug) to the outlet, wait 2 or 3 hours before you put food into the appliance. If you add food before the appliance has cooled completely, your food may spoil.

Tips for energy saving

- Do not place the appliance near cookers, radiators or other heat sources. If the ambient temperature is high, the compressor will run more frequently and for longer, resulting in increased energy consumption.
- Ensure that there is sufficient ventilation at the base of the appliance, on the sides of the appliance and at the back of the appliance. Never cover ventilation openings.
- Please also observe the spacing dimensions in the chapter "Installation".
- The arrangement of drawers, shelves and racks as shown in the illustration offers the most efficient use of energy and should therefore be retained as far as possible. All drawers and shelves should remain in the appliance to keep the temperature stable and save energy.
- To obtain a larger storage space (e.g. for large refrigerated/frozen goods), the middle drawers can be removed. The top and bottom drawers and shelves should be removed last if necessary.
- An evenly filled refrigerator/freezer compartment contributes to optimal energy use. Therefore, avoid empty or half-empty compartments.
- Allow warm food to cool before placing it in the refrigerator/freezer. Food that has already cooled down increases energy efficiency.
- Allow frozen food to defrost in the refrigerator. The coldness of the frozen food reduces the energy consumption in the refrigerator compartment and thus increases the energy efficiency.
- Open the door only as briefly as necessary to minimise cold loss. Opening the door briefly and closing it properly reduces energy consumption.
- Setting the temperature no colder than necessary contributes to optimal energy use. The optimum temperature in the refrigerator is +7°C. It should be measured as far forward as possible in the top compartment of refrigerators.
- The door seals of your appliance must be perfectly intact so that the doors close properly and energy consumption is not increased unnecessarily.

How to use the water dispenser (optional)

1. NOTE: Only purified and cold boiled water have access to this water dispenser, and the two kinds must free from any impurity. Coke, apple juice and other soft drinks that contain Carbon dioxide are forbidden.
2. It is not allowed to fill water when the water box is removed from the machine door.
3. Never fill more water than the maximum limit indicated on the water box.
4. Check out whether the water box is on its foundation bed if you are not able to get water normally as usual.
5. When you are trying to move the water box, make sure that there is no water in it.
6. You are not allowed to remove any element of the water valve.
7. When you are using the machine for the first time or it has been out of application for a long time, remove and clean it up before you put it into application.
8. If water in this machine has been out of use for a long period, you should better drain it out of the dispenser and add pure water, and then it can be used as usual.
9. It is suggested that the water dispenser tank should be cleaned up every three to six months.
10. When you are cleaning the tank and if cleaning solution is used, you should better put the water box to its original position, and fill the water box, then you shall drain 5 to 6 cups of water, in case there is any rudimental dirt of water dispenser after you used cleaning solution.
11. When you are opening or closing the door of the water dispenser, try to avoid overexerting to prevent water in the box to move and overflow.
12. Do not touch the bottle frame above when adding water.

Instruction of Water Dispenser

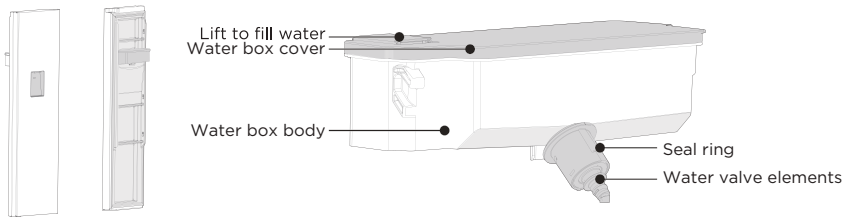

Filling of Drinking Water

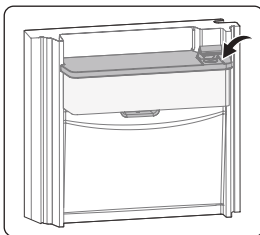

- Open the lid of water box, add water and close the lid.
- Water shall be filled here

How to Get the Drinking Water

- Push the water shank inward by the cup
- When you put the hand shank inward, there will be some water outflow,when the hand shank is in its original position,there is no water outflow

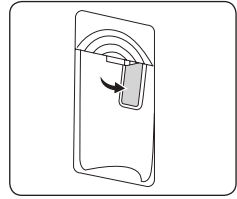

How to Remove and Clean up the Water Dispenser

Step 1: Remove

- Take out the elements of the water box , stick to both sides of the water box elements with both of your hands,and draw out the elements of the water box outwards through 45 degrees above. You can translate the water box (to the side of the user) and get the elements when the elements are out of water valve elements (when you move the box,be sure that there is no water in it.)
- Take down the seal ring of the water box elements.
- Step to remove the elements of water valve : Use the screwdriver and make the edge directs to the water valve elements and then insert it in the free place that highlights outskirts, rotates the screwdriver clockwise or anticlockwise,with the screwdriver moving, when it tops the penstock, extracts the water valve elements by hands at the direction of above 45°(You can not remove the elements of water valve)

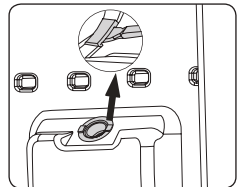
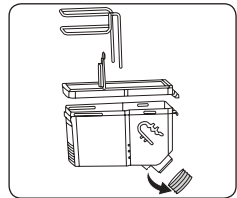
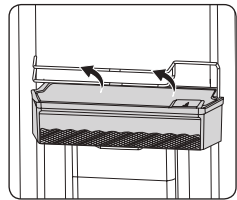

Step 2: Clean up

- Remove the water box itself, and the water box cover, the seal ring and the water valve elements.
- Clean up the elements of the water box with cold or warm water.
- Wipe out the water with dry cloth.

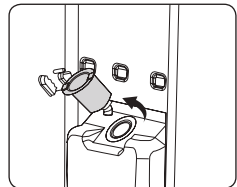

● ATTENTION

When you are cleaning the tank and if cleaning solution is used, you should better put the water box to its original position, and fill the water box, then you shall drain 5 to 6 cups of water, in case there is any rudimental dirt of water dispenser after you used cleaning solution.

How to Get the Drinking Water

Step 3: Installation

- Installation of water valve elements: Put the guide projecting platform directed to the guide groove, after that, push it downside with 45° slantly at full tilt, until you hear a crack.
- Installation of seal ring of the water box: Put the seal ring to the bottom of the water box, and be sure that the seal ring is in place. Avoid wrinkle of seal ring and it's placement in wrong place.
- The Installation of water box elements: Keep the hanging slot of the water box elements direct to the hangers on the door liner. The seal ring at the bottom of the box shall directed to the entrance of the water valve elements, insert it to the corresponding position along with the 45° slantly.

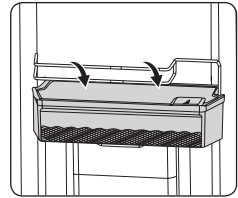
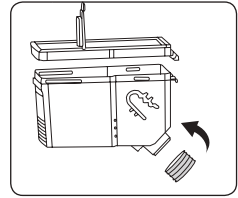
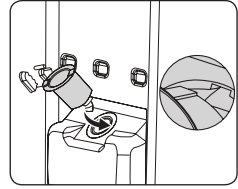

OPERATION INSTRUCTIONS

Control panel

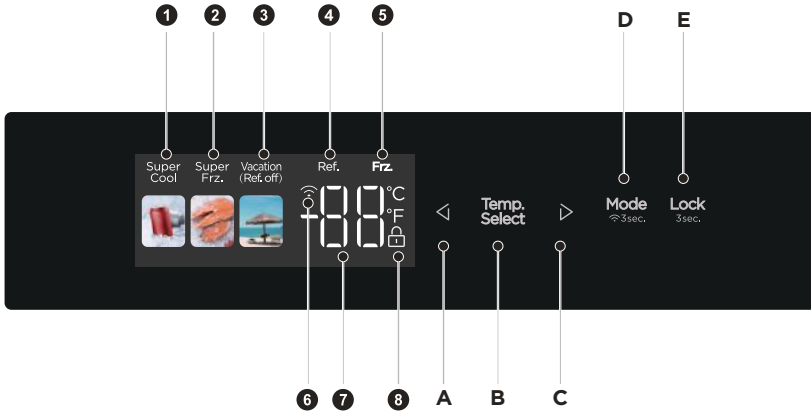

	Display		Button
1	Super Cooling icon	A	Temperature down button
2	Super Freezing icon	B	Temperature zone selection button
3	Vacation icon	C	Temperature up button
4	Refrigerating compartment temperature	D	Mode/network configuration button
5	Freezer compartment temperature	E	Lock/Unlock button
6	Wireless Network icon		
7	Temperature display icon		
8	Lock icon		

● ATTENTION

The actual control panel may differ from model to model.

The control panel will turn off automatically for energy saving.

If there is any finger or skin contacts to the control panel while cleaning it, the button function may operate.

Lock / unlock

- In the unlocked state, long press the button **Lock**^{3sec} for 3 seconds, enter the lock  state; In the locked state, long press the button **Lock**^{3sec} for 3 seconds, the lock icon disappears and enters the unlock state. All the following functions must be operated in the unlocking status.

Vacation mode

- Click the button **Mode**^{3sec} to enter the vacation mode. Icon  lights up, the vacation mode will start after locking the control panel.
- Under vacation mode, the refrigerating compartment is turned off and temperature area display -the freezer compartment temperature is set at -18 °C .

Super Cooling mode

- Click the button **Mode**^{3sec} to enter the quick cooling mode. Icon  lights up, the quick refrigerating mode will start after locking the control panel. Quick cool exits for 6h.



Super Freezing mode

- Click the button **Mode**^{3sec} to enter the quick freezing mode. Icon  lights up, the quick freezing mode will start after locking the control panel. Quick freeze exits for 24h.

Temperature setting of refrigerating compartment

- Click temperature zone selection button **Temp. Select**, refrigerating compartment temperature will blink. Then click the button  or  again to set the temperature, and will hear one beep. Setting scope is between 2°C and 8°C. Every time you click the button, the temperature will be changed 1°C. After adjusting, the digital tube will keep blinking for 5 seconds. New temperature setting will take effect after locking the control panel.

Temperature setting of freezer compartment

- Click temperature zone selection button **Temp. Select**, freezer compartment temperature will blink. Then click the button  or  again to set the temperature, and you will hear one beep. Setting scope is between -16°C and -24°C. Every time you click the button, the temperature will be changed 1°C. After adjusting, the digital tube will keep blinking for 5 seconds. New temperature setting will take effect after locking the control panel.

ATTENTION

Recommended setting: Refrigerated chamber 5°C, freezing chamber - 18°C.

The quick-freezing function is designed to maintain the nutritional value of the food in the freezer. It can freeze the food in the shortest time. If a large amount of food is frozen at one time, it is recommended that the user turn on the quick-freezing function and put the food in. At this time, the freezing speed of the freezer compartment is increased, which can quickly freeze the food, effectively lock the nutrition of the food, and facilitate storage.

Wireless network setting-AP configuration

- Please start AP mode before connecting to the mobile app. Whether in the locked or unlocked state, press and hold the mode button  for 3s to force the refrigerator wireless module to set to AP mode, and then the temperature display area will display AP; After the module is successfully configured to enter the AP mode, it will automatically exit the AP mode, and the temperature display area will return to normal temperature display; After setting the AP mode, if the module is not configured successfully for 10s, it will forcibly exit the AP mode and restore the normal temperature display.



Storage upon power failure

- In case of power failure, the instant working state will be locked and maintained till re-electrification.

Opening warning and alarm control

- when open the refrigerator doors, the opening music will play. If the door is not closed in two minutes, the buzzer will sound once every minute until the door is closed. Press anyone button to stop the buzzer alarm.

ATTENTION

Disable the door opening tone: Press and hold the combination key  and  for 3 seconds to disable or enable the door opening tone (the tone is enabled by default).

Disable the door opening alarm sound: Not possible

Error code

- The following warnings appearing on the display indicate corresponding faults of the refrigerator. Though the refrigerator may still have cold storage function with the following faults, the user shall contact a maintenance specialist for maintenance, so as to ensure optimized operation of the appliance.

Fault Code	Fault Description
E1	Temperature sensor failure of refrigerating chamber
E2	Temperature sensor failure of freezing chamber
E5	Freezing defrost sensor detection circuit error
E6	Communication error
E7	Ambient temperature sensor error

Tips on storing food

Freezer compartment

- The freezer is designated for the storage of food frozen at very low temperature, long-term storage of frozen food, and for the production of ice.
- Only use the shelves in the door of the freezer to store frozen food, not for storing hot food designated for freezing.
- Do not put fresh and frozen food next to each other. The frozen food may thaw.
- When freezing fresh food (such as meat, fish or chopped meat), cut them into parts that can be used at the same time.
- Storing frozen food: instructions are usually stated on the packages, which must be followed. If there is no information on the packaging, food should not be stored for longer than three months from the date of purchase.
- When purchasing frozen food, make sure that it was frozen at a suitable temperature and that the packaging is not damaged.
- Frozen food should be kept in suitable packages to retain the quality and should be returned to the freezer compartment as soon as possible.
- If a package of frozen food shows moisture or abnormal bulging, it is probable that it was stored at the wrong temperature and the content is spoiled.
- The storage period for frozen food depends on the room temperature, the thermostat setting, the frequency of opening the door of the freezer, the type of food and the time of transporting the product from the shop to the household. Always follow the instructions printed on the packaging and never exceed the maximum storage time stated on the package.

Refrigerating compartment

- To reduce moisture and subsequent ice build-up, never put liquid into the refrigerator in unsealed containers. Frost tends to concentrate in the coolest parts of the evaporator. Storing uncovered liquids results in a more frequent need for defrosting.
- Never put warm foods in the refrigerator. These should first cool down at room temperature and then be placed so as to ensure adequate air circulation in the refrigerator.
- Foods or food containers should not touch the back wall of the refrigerator because they could freeze to the wall. Do not keep regularly opening the door of the refrigerator.
- Meat and clean fish (packed in a package or plastic foil) can be placed in the refrigerator, which can be used in 1-2 days.
- Fruit and vegetables without packaging can be placed in the part designated for fresh fruit and vegetables.

Recommended Temperature

The optimal temperature setting for food storage:

- Fridge: 5 °C , Freezer: -18 °C

ATTENTION

The optimal temperature setting of each compartment depends on the ambient temperature. Above optimal temperature is based on the ambient temperature of 25 °C.

Order	Compartments TYPE	Target storage temp. [°C]	Appropriate food
1	Fridge	+2 ~ +8	Eggs, cooked food, packaged food, fruits and vegetables, dairy products, cakes, drinks and other foods are not suitable for freezing.
2	(***)*-Freezer	≤-18	Seafood (fish, shrimp, shellfish), freshwater aquatic products and meat products (recommended for 3 months, the longer the storage time, the worse the taste and nutrition), suitable for frozen fresh food.
3	***-Freezer	≤-18	Seafood (fish, shrimp, shellfish), freshwater aquatic products and meat products (recommended for 3 months, the longer the storage time, the worse the taste and nutrition), suitable for frozen fresh food.
4	** -Freezer	≤-12	Seafood (fish, shrimp, shellfish), freshwater aquatic products and meat products (recommended for 3 months, the longer the storage time, the worse the taste and nutrition), suitable for frozen fresh food.
5	*-Freezer	≤-6	Seafood (fish, shrimp, shellfish), freshwater aquatic products and meat products (recommended for 3 months, the longer the storage time, the worse the taste and nutrition), suitable for frozen fresh food.
6	0-star	-6 ~ 0	Fresh pork, beef, fish, chicken, some packaged processed foods, etc. (Recommended to eat within the same day, preferably no more than 3 days). Partially encapsulated processed foods (non-freezable foods).
7	Chill	-2 ~ +3	Fresh/ frozen pork, beef, chicken, freshwater aquatic products, etc. (7 days below 0°C and above 0°C is recommended for consumption within that day, preferably no more than 2 days).Seafood (less than 0 for 15 days, it is not recommended to store above 0°C).
8	Fresh food	0 ~ +4	Fresh pork, beef, fish, chicken, cooked food, etc.(Recommended to eat within the same day, preferably no more than 3 days)
9	Wine	+5 ~ +20	Red wine, white wine, sparkling wine, etc.

ATTENTION

please store different foods according to the compartments or target storage temperature of your purchased

APP SETUP AND OPERATION

Download the Smarthome App

On an app market (Google Play Store, Apple App Store), search for “ SmartHome* ” and find the SmartHome app. Download and install it on your phone. You can also download the app by scanning the QR code below.



Register and log in

Open the SmartHome app, and create a new account (you can also register through a third-party account). If you already have an existing account, use the account to log in.



Connect your devices to Smarthome

1. Please make sure your mobile phone is connected to a wireless network. If it is not, go to Settings and enable wireless networks and Bluetooth.
2. Please power on your devices.
3. Open Smarthome App on your phone.
4. If a message of "Smart devices discovered nearby" appears, click to add.
5. If no message appears, select "+" on the page and select your device in the list of nearby devices available. If your device is not listed, please add your device manually by the device category and device model.
6. Connect your device to the wireless network according to instructions on app. If the connection fails, please follow the instructions provided by the app to continue with the operation.

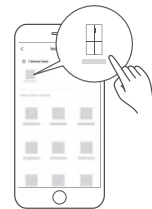

 **NOTE**

1. Make sure your devices are powered on.
2. Keep your mobile phone close enough to your device when you are connecting your device to the network.
3. Connect your mobile phone to the wireless network at home, and make sure you know the password of the wireless network.
4. Check if your wireless router supports 2.4 GHz band and turn it on. If you are not sure whether the router supports 2.4 GHz band, please contact the router manufacturer.
5. The device cannot connect to the wireless network that requires authentication, and it usually appears in public areas such as hotels, restaurants, etc. Please connect to a wireless network that does not require authentication.
6. Turn off the WLAN+ (Android) or WLAN Assistant (iOS) function of your mobile phone when connecting your device to the network.
7. In the case that your device connected to a wireless network before but it needs to reconnect, please click “+” on the app Home page, and add your device again by the device category and model according to the instructions on app.

CLEANING AND MAINTENANCE

Defrosting

- The refrigerator is made based on the air-cooling principle and thus has automatic defrosting function. Frost formed due to change of season or temperature may also be manually removed by disconnection of the appliance from power supply or by wiping with a dry towel.

Cleaning of door tray

- According to the direction arrow in the figure below, use both hands to squeeze the tray, and push it upward, then you can take it out.
- After washing the tray having been taken out, you can adjust its installing height in accordance with your requirement.

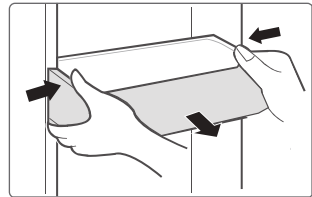

Cleaning of glass shelf

- As the innermost part of the refrigerator liner where contacting the shelves has a backstop, you shall raise the shelves upward, then you can be able to take it out.
- Adjust or clean the shelves according to your requirement.

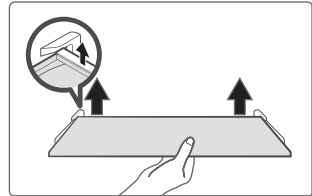

Cleaning the vegetable drawer

1. Remove the contents of the drawer. Hold the handle of the vegetable drawer and pull it out completely until it stops.
2. Lift the vegetable drawer up and remove it by pulling it out.

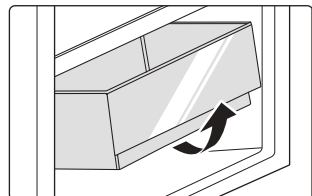

ATTENTION

Soft towels or sponge dipped in water and non-corrosive neutral detergents are suggested for cleaning. The freezer of shall be finally cleaned with clean water and dry cloth. Open the door for natural drying before the power is turned on. Do not use hard brushes, clean steel balls, wire brushes, abrasives, such as toothpastes, organic solvents (such as alcohol, acetone, banana oil, etc.), boiling water, acid or alkaline items clean refrigerator considering that this may damage the fridge surface and interior.

TROUBLESHOOTING

The following simple issues can be handled by the user. Please call the after-sale service department if the issues are not solved.

Problem	Possible reason
Failed operation	<ul style="list-style-type: none"> • Check whether the appliance is connected to power or whether the plug is in well contact.
	<ul style="list-style-type: none"> • Check whether the voltage is too low.
	<ul style="list-style-type: none"> • Check whether there is a power failure or partial circuits have tripped.
Odor	<ul style="list-style-type: none"> • Odorous foods shall be tightly wrapped.
	<ul style="list-style-type: none"> • Check whether there is any rotten food.
	<ul style="list-style-type: none"> • Clean the inside of the refrigerator.
Long-time operation of the compressor	<ul style="list-style-type: none"> • Long operation of the refrigerator is normal in summer.
	<ul style="list-style-type: none"> • when the ambient temperature is high It is not suggestible having too much food in the appliance at the same time.
	<ul style="list-style-type: none"> • Food shall get cool before being put into the appliance.
	<ul style="list-style-type: none"> • The doors are opened too frequently.
Light fails to get lit	<ul style="list-style-type: none"> • Check whether the refrigerator is connected to power supply and whether the illuminating light is damaged.
	<ul style="list-style-type: none"> • Have the light replaced by a specialist.
Door can not be properly closed	<ul style="list-style-type: none"> • The door is stuck by food packages Too much food is placed.
	<ul style="list-style-type: none"> • The refrigerator is tiltedr.
Loud noises	<ul style="list-style-type: none"> • Check whether the floor is level and whether the refrigerator is placed stably.
	<ul style="list-style-type: none"> • Check whether accessories are placed at proper locations.

Problem	Possible reason
Door seal fails to be tight	<ul style="list-style-type: none"> • Remove foreign matters on the door seal. • Heat the door seal and then cool it for restoration (or blow it with an electrical drier or use a hot towel for heating).
Water pan overflows	<ul style="list-style-type: none"> • There is too much food in the chamber or food stored contains too much water,resulting in heavy defrosting. • The doors are not closed properly, resulting in frosting due to entry of air and increased water due to defrosting.
Hot housing	<ul style="list-style-type: none"> • Heat dissipation of the built-in condenser via the housing, which is normal When housing becomes hot due to high ambient temperature, storage of too much food or shutdown of the compressor is shut down, provide sound ventilation to facilitate heat dissipation.
Surface condensation	<ul style="list-style-type: none"> • Condensation on the exterior surface and door seals of the refrigerator is normal when the ambient humidity is too high. Just wipe the condensate with a clean towel.



make yourself at home



www.midea.com

© Midea 2022 all rights reserved