

1 PRODUCT INTRODUCTION

Ceiling mount type ventilating fan is a kind of ventilating device that installed onto ceiling, could be used for ventilating, exhausting, desiccating. It is with characteristics of extra-quiet, easily installed, large air delivery, large using range, etc.. As a kind of new top-class product for modern life, ceiling mount type ventilating fan is applicable in houses, shops, hotels, restaurants, entertainment place and so on. It also could be used matching device of air conditioner.

1.1 Parts And Dimensions

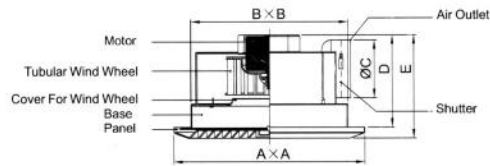

Unit: mm

Model	A	B	ØC	D	E
ERW-10F-1	250×250	210×210	98	165	185

2 WIRING DIAGRAM

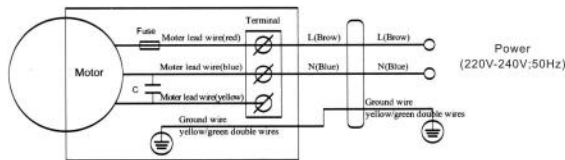

6 CAUTIONS

- 6.1 Installation height: more than 2.3m from floor.
- 6.2 Never install the fan into wall, or the place where it would be exposed to water splash, excess vapor or high temperature. Never install ducts into flue with poisonous gas.
- 6.3 Distance for contact gaps of polarity switch has to be 3mm at least.
- 6.4 When using switch to control power, avoid to turn on/off the switch frequently. Turn off switch if the fan is not used for long time.
- 6.5 Avoid the air back into room through the open flue or other open-flame appliances.
- 6.6 If the supply cord damage, must be replaced by staff specialist from maintenance department of manufacturer or similar specialized electrical personnel, using specialized cord or from manufacturer or maintenance department.
- 6.7 This product must be earthed.

7 MAINTENANCE

- 7.1 Switch off power at first.
- 7.2 Removing louver hood, cover, blade and so on, wash them in water with brush. Using soft cloth to wipe off grease with natural cleanser. Never use water over 60 °C, petrol, benzene, thinner or any other such organic solvent to clean. Do not allow water to enter into motor.
- 7.3 Dry the cleaned parts by itself or soft dry cloth. Then reset in turn.
- 7.4 Within guarantee, under normal operation, any malfunction caused by manufacturer can be repaired or replaced freely.
- 7.5 Carry out lifelong maintenance, exceed guarantee time, shall collect cost fee of parts and materials.
- 7.6 Guarantee is not applicable to following cases.
 - * Used or exchanged the parts made by other company.
 - * Failure caused by wrong operation, maintenance or repair, force majeure and so on.
 - * No invoice, no stamp of appointed sellers or no date.

3 TECHNICAL PARAMETERS

Notice: Below parameters are just for reference. Detailed should subject to the ones on product nameplate

Model	Voltage VAC	Frequency Hz	Power W	Air Volume m ³ /h	Noise dB
ERW-10F-1	220-240V	50Hz	25W	130m ³	42

4 INSTALLATION INSTRUCTION

- 4.1 Open hole on ceiling, the diameter should be 5mm larger than ØC
- 4.2 Fix constructed wood frame onto ceiling grille (pic.1).
- 4.3 Press circlip to remove panel from ventilation fan.
- 4.4 Connect power cord of fan to room's electrical circuit in correct way.
- 4.5 Connect fan's air outlet to self-contained ventiduct, then fasten the joint by clamp or cable tie (pic.2).
- 4.6 Fix base of the fan onto wood frame using screw.
- 4.7 Turn on power to check all things are OK, then turn off the power and fit panel onto fan.

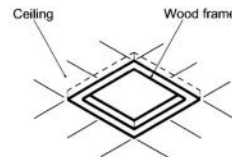

Pic.1

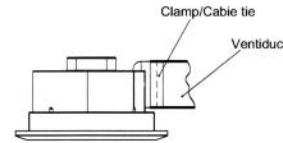

Pic.2

Notice: Below cases have to be avoided when connect air outlet to ventiduct



Overbending

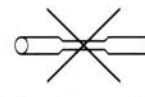

Reduce diameter of joint

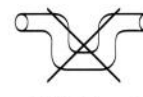

Multiple bends

5 INSTALLATION DIAGRAM

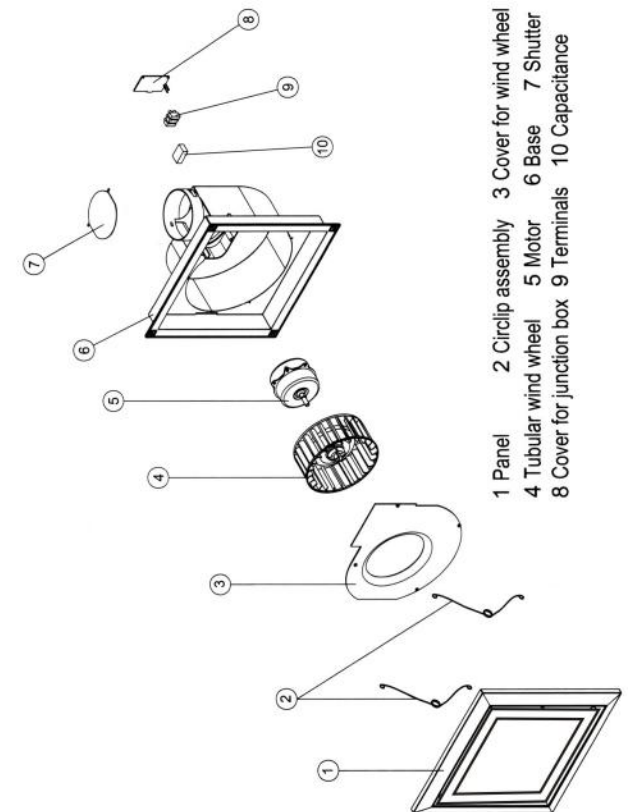

- 1 Panel
- 2 Circlip assembly
- 3 Cover for wind wheel
- 4 Tubular wind wheel
- 5 Motor
- 6 Base
- 7 Shutter
- 8 Cover for junction box
- 9 Terminals
- 10 Capacitance

Ceiling Vent-Type Ventilation Fan Operating Instructions

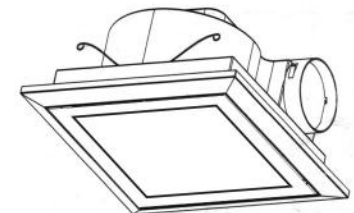

- ERW-10F-1/S
- ERW-10F-1/W