

The diagram above is just for reference. Please take the appearance of the actual product as the standard.

WATER PURIFIER

# Instruction Manual

Model: JN1742T-RO

Before installing and operating your water purifier, please read the instruction manual carefully and keep it for future reference.

# Table of Contents

General Instructions	2
Importance Of Water Purification	3
General Instructions	4
Product Overview	5
Function of Indicators	5
Rinse The Activated Carbon Filters	6
Replace The Filters	6
Replace The Filters	7
Key Features	8
Safety Precautions	9-12
How To Maintain Your Product	13
Troubleshooting	14
Water Flow Diagram	15
Electric Diagram	15
Technical Specifications	16
Recommended Filter Change Frequency	17
1 Year Limited Warranty	18

## Check List

Content's in the box?



Water Purifier



User Guide

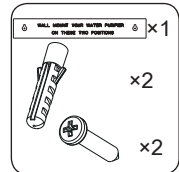

Mounting Accessories

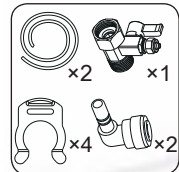

Tube & Connections

# General Instructions

---

Your safety and the safety of your loved ones is paramount to us. There are several safety related messages in this manual, which have been provided during various stages such as installation, operation and maintenance of your RO Water Purifier. These messages point out potential hazards and also educate on how to reduce any potential risks. Please always read and follow all safety messages as provided in this manual.

*This sign is for Caution about things and manipulations that may cause danger. Read carefully and follow the directions to avoid danger.*



*If not followed correctly, the user may be dead or sustain a serious injury.*



*If not followed correctly, the user may sustain an injury or may lose properties.*



These instructions have been written as a guide for the proper installation and operation of your RO Water Purifier. For your safety and damage caused by improper installation, it is recommended that water purifier is installed by Authorized Service Technician only.

## **Pre - Installation Instructions:**

1. Inspect the RO Water Purifier and its component parts for possible damage. DO NOT install or attempt to repair any damaged component parts. If you detect any damage in your RO Water Purifier please contact the company through Customer care center, details of which are mentioned in this manual and on the product.



2. Verify that the voltage being supplied corresponds to that which is mentioned in the RO Water Purifier manual.



# Importance of Water purification .....

---

This RO Water Purifier uses one of the latest technology that are used in water purification process. This RO Water Purifier works under the principle of RO (Reverse Osmosis) technology which is found to be one of the most effective process. In this process water under pressure is passed through a semi-permeable membrane. Purified water is collected for drinking in a storage tank and impurities in the water are flushed to the drain.

## **Why water purification is important?**

This water purification, today is essential due to the presence of harmful contaminants present in the water supply. Fast pace of urbanization and rapid industrial growth have led to significant pollutants and contaminants being found in the water supply. Drinking water may reasonably be expected to contain at least small amounts of some contaminants. Below is a compiled list of the most common water pollutants found today in the water supply which if consumed in excess can be detrimental to human health.

- TDS (Total Dissolved Solids) like Sulphates, Chlorides, etc.
- VOCs (Volatile Organic Compounds), Pesticides and other disinfection by products.
- Heavy metals like Mercury, Arsenic, Lead, Chromium and Cadmium etc.
- Micro - Organisms such as bacteria, virus, protozoa and cysts.

## **Working of Water Purifier ?**

RO Water Purifier has 4 stages of purification system, where the water is passed through the various stages and progressively filtered to get purified water which is stored in the independent storage tank made from PP material.

## **Safety Instruction:**

- 1.This appliance is not intended for use by persons (including children) with reduced physical, sensory or mental capabilities, or lack of experience and knowledge, unless they have been given supervision or instruction concerning use of the appliance by a person responsible for their safety.
- 2.Children should be supervised to ensure that they do not play with the appliance.
- 3.If the supply cord is damaged, it must be replaced by the manufacturer, its service agent or similarly qualified persons in order to avoid a hazard.
- 5.Do not store explosive substances such as aerosol cans with a flammable propellant in this appliance.
- 6.This appliance is intended to be used in household and similar applications such as
  - staff kitchen areas in shops, offices and other working environments;
  - farm houses and by clients in hotels, motels and other residential type environments;
  - bed and breakfast type environments;
  - catering and similar non-retail applications.
- 7.**WARNING:** To avoid a hazard due to instability of the appliance, it must be fixed in accordance with the instructions.
- 8.The appliance must not be immersed

# General Instructions

---

## Stage 1 - Sediment filter (PP)

The Sediment filter is used to reduce fine and coarse physical contaminants present in the water. This improves life of the Pre Carbon filter and ensures efficient working of RO membrane.

## Stage 2 – Pre Carbon filter (PC)

The Pre Carbon filter uses active carbon granule with high adsorption capacity which reduces harmful chemicals including pesticides, volatile organic compounds, residual chlorine etc., from water. It also absorbs bad taste and odour causing organic compounds from water.

## Stage 3 – RO (Reverse Osmosis) filter (RO)

RO filter contains semi-permeable membrane where the water is passed through the semi-permeable membrane to reduce TDS (Total Dissolved Solids) and heavy metals like mercury, arsenic, lead, chromium, cadmium etc. It also removes microorganisms like bacteria, virus, protozoa and cysts.

## Stage 4 – After/Post Carbon filter

This filter contains activated carbon which help to enhance the taste and quality of water.

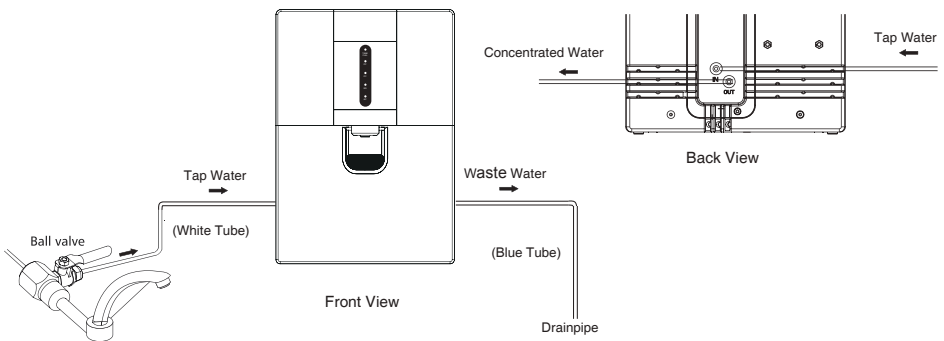

**\* Note:**

*This system is not intended for the treatment of contaminated water, nor is the system intended to convert waste water into microbiologically safe drinking water. Do not use with water that is microbiologically unsafe or of unknown quality without adequate disinfection.*

# Product Overview

## Front View

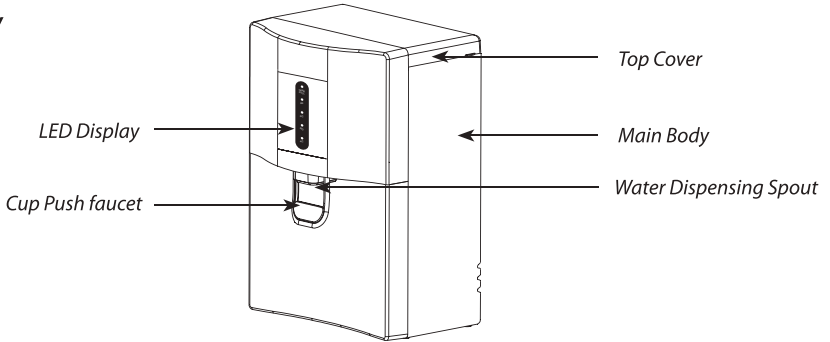

## Back View

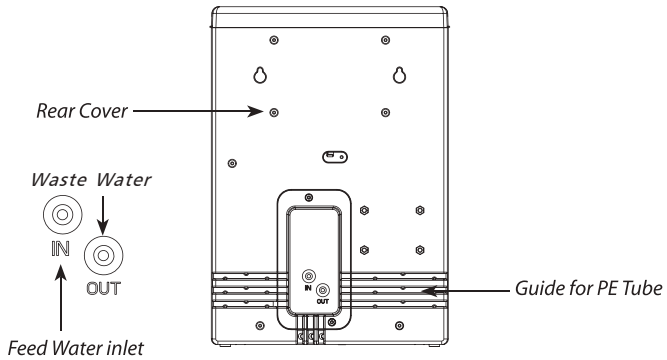

# Function of Indicators

## Tank Full Indicator

The indicator flash represents water purifying. The indicator keep bright represents the water tank is full. The indicator not bright represents the tap water is weak.

## Filter life indicator for 4 different filters

The indicators keep bright represent that the filters are in the service life. Not bright represent the filters out of service life, and needs to be replaced as soon as possible.

1. PP denotes: Sediment filter
2. PC denotes: Pre carbon filter
3. RO denotes: Reverse Osmosis filter
4. AC denotes: After/Post carbon filter

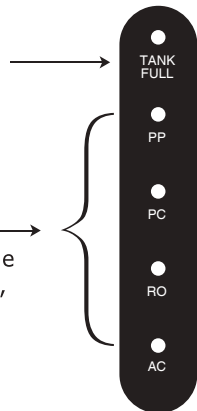

# Rinse The Activated Carbon Filters

---

1. Unscrew the two screws at the bottom.

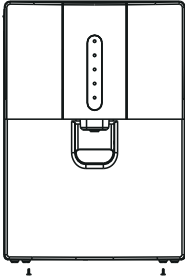

2. Press the lower front housing icon position, push down, and open the lower front housing.

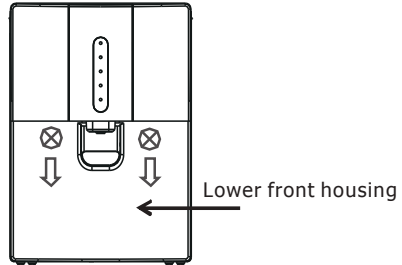

3. Rinse PC and AC filter for 15 minutes

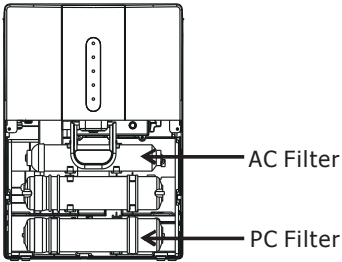

4. Replace the lower front housing and screw.

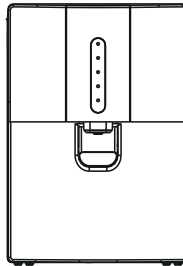

# Replace The Filters

---

1. Remove the lower front housing, and replace the expired filter

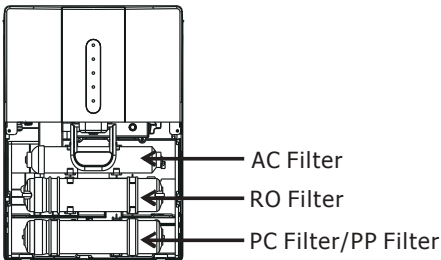

## Replace The Filters

---

2. Then press the K1 button for 3S of the reset board (There are two small holes on the right side of faucet , can press K1 or K2 keys with a PIN that diameter less than 2mm), the unit enter the filter reset state, press K1 key, you can cycle select the filter, the corresponding indicator light flashes on the display panel, at this time, press K2 for 3s,can reset the selected filter's life, and fall into the next filter select state. No key operation for 10S, then the filter reset state finished.

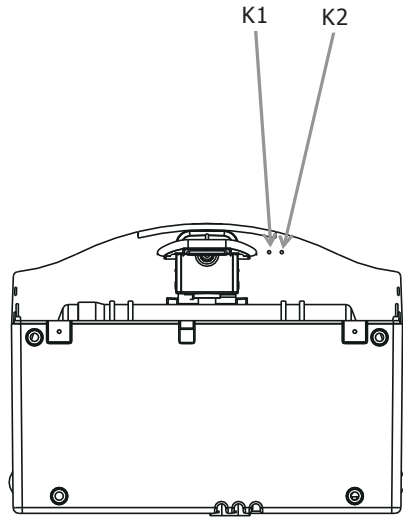
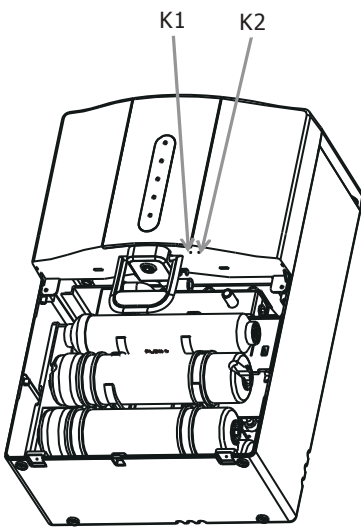



# Key Features

---



## Food Grade Plastic Tank

Water purifier with option of Food Grade Plastic Tank, keep purifier water clean and health, safer to drink.

### Convenience to user

Pure water storage of 8L. There is both option of putting product on wall as well as on cabinet.

### Dual Protection Water Tank Cover

Inner water tank cover is designed with airtight sealing ring to assure invasion free from dust and insects. Outside tank cover gives further protection to the inner water tank cover.

### Multistage filter

Multistage RO purification helps in purification of water purifier.

# Safety Precautions

---

## Installing Electrical Connections

Ensure the earth connection in your electrical supply is proper before connecting the power cord. The socket should be standard and independent: 3 pin type of 220-240V AC, 50/60Hz.

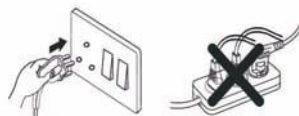

Connect the power plug to the wall outlet.

### Caution:

- Do not use extension box since it may not be properly earthed.
- The appliances must be earthed. Danube doesn't hold any responsibility for damage caused by the mentioned failure. You are therefore advised to check that your household supply has efficient earthing.
- Do not use manual stabilizer.

## Installation of Machine:

Do not place the machine on a slanting, uneven or unstable surface. Place the machine on a solid leveled surface to avoid excessive vibration and noise during operation.

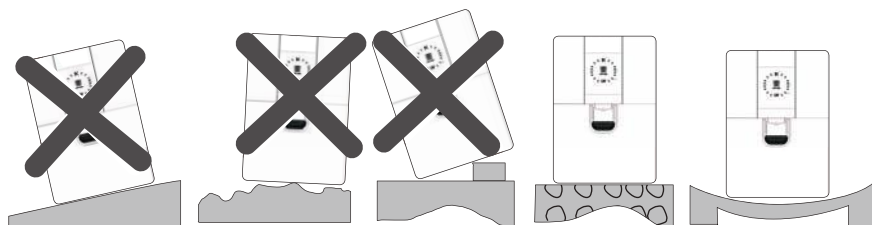

If the supply cord is damaged, it must be replaced by the manufacturer, its service agent or similarly qualified persons in order to avoid a hazard.

### Note:

Installation shall be done by Authorized Service person.

Parts removed during installation like screws, valve should be properly disposed.

# Safety Precautions



## Electrical Safety

Even though these products are designed keeping highest safety standards in mind, there are rule which need to be followed while using these products.

Power plug must be used with a grounded 220-240V outlet.

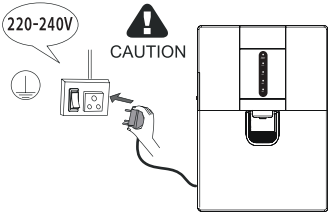

Do not move the product when product is running.

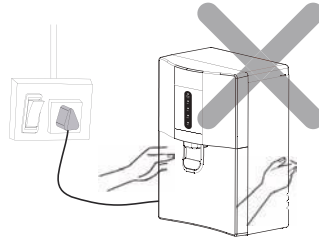

Do not pull out or touch power plug with wet hands to avoid electrical shock.

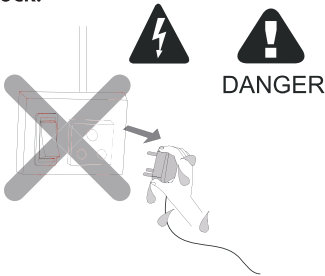

Product should be installed only by Danube Authorized Service Person.



Install the product away from direct sunlight.

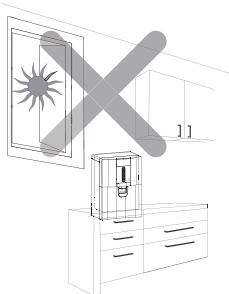

Do not connect nor modify the cord randomly during installation.



# Safety Precautions

---

Do not connect hot water to the product.

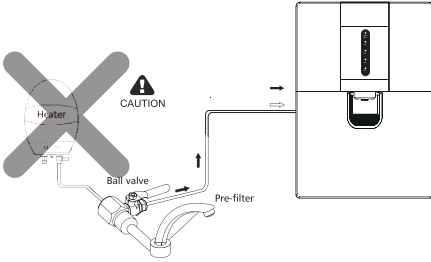

Connect the product to the power supply only with the plug that is provided with the purifier.

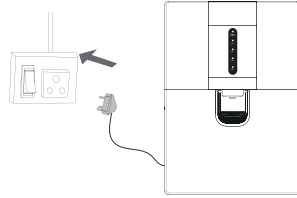

Do not use the purifier if the power cord is damaged or you notice strange noise, burning smell, or smoke.

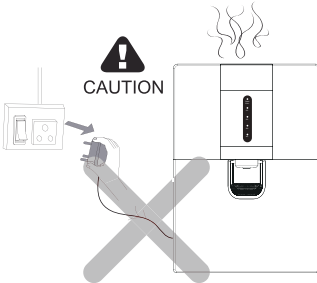

Switch off the power, unplug the power cord immediately and call Customer care centre.



Technical support

Do not open the purifier for cleaning the filters or for any part replacements.

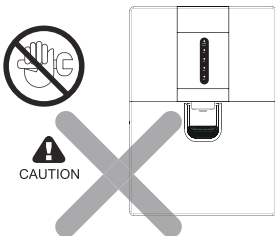

Do not install water purifier where it could freeze. Freezing damage is not covered by the warranty.

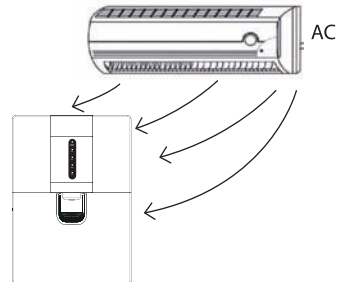

# Safety Precautions

## When it is used

Do not put heavy objects on the product.

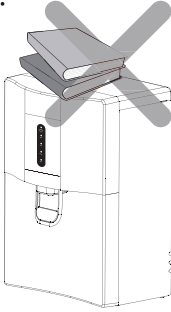

Do not put foreign objects or hand inside the purifier. (Caution is needed, especially for children).

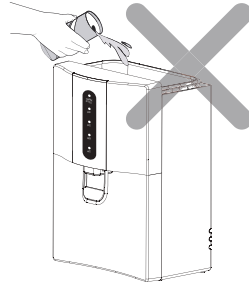

Do not drink the water from the reject water tube.

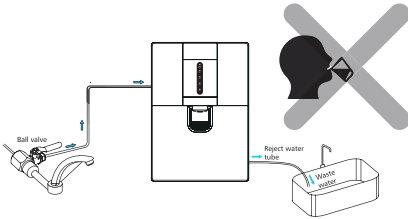

Drink the purified water as soon as possible so that always fresh water flows in.

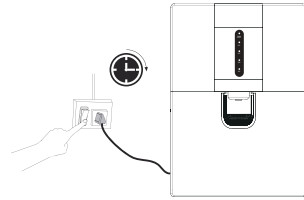

After the installation, make sure the hose's joint does not leak.

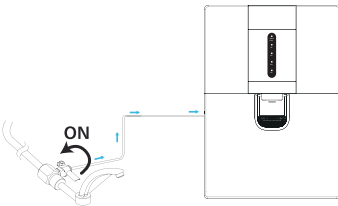

Make sure you use a new hose and parts for installation.

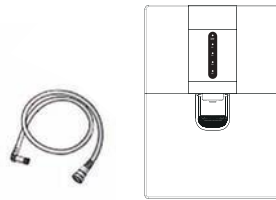

### **Important Note:**

It is recommended not to switch off the water purifier and/or turn off the water supply to the product when it is not been used for more than 24 hours. The purifier has an in-built cleaning mechanism which cleans the RO membrane at regular intervals every 24 hours by flushing. This feature protects the RO membrane and ensures life.

# How to maintain your product

---

Replace filters regularly according to the replacement period.

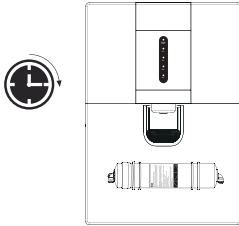

Use standard filters only.

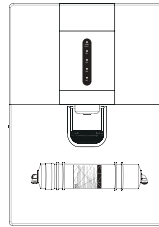

While cleaning the product, do not spray water directly nor clean with benzene, thinner, alcohol, etc.

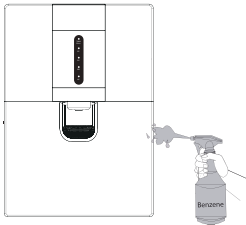

Clean after the power plug is pulled out.

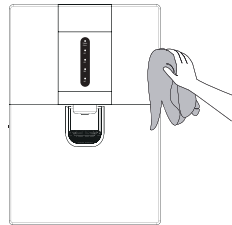

The back and sides of the product need more than 10 cm spaces apart from the wall for smooth airflow.

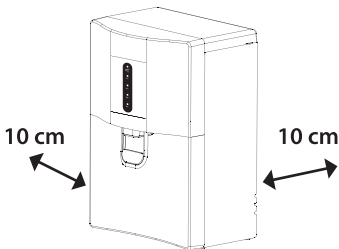

*(Only when the purifier is placed on top of the table)*

Do not tilt the product more than 45 degree when moving.

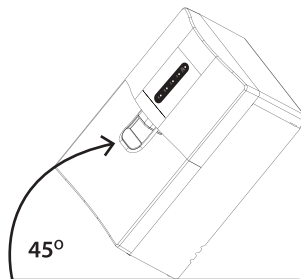

# Troubleshooting

Your RO Water Purifier may not function at its desired capability if used incorrectly. This may not necessarily mean that the product is faulty. For instances like these, please follow the steps given below to troubleshoot the problem without the help from a certified technician. If the problem still persists, please call Customer Care Center immediately.

PROBLEMS	CHECK UP	SOLUTION
Change in water taste	Has the purified water been stored in the tank for long time.	Drain the stored water from the storage tank through faucet.
	Filters / Membrane may require replacement.	Call customer care centre for replacement.
	Did the raw water quality change?	Call customer care centre.
	Check if there is no water flow through reject line.	Switch off the water purifier and call customer care centre.
Decreased flow of purified water	Check whether the tap / ball valve is closed.	Open the tap / ball valve
	Filter / Membrane may be clogged or damaged.	Call customer care centre for replacement.
Less / No reject water	Check if the reject water tube is bent.	Clear the bent in the reject water tube.
	Check if the reject water tube is blocked.	switch off the water purifier and call customer care centre.
No Pure water	Check whether there is water supply in the tap.	If not, take the help of a plumber to set it right.
	Check whether tap / ball valve is closed.	Open the tap / ball valve.
	Check if filter change light is ON.	Call Customer Care centre for replacement of filters.
	None of the above.	Call Customer care centre.
Water not dispensing when water dispense button is pressed.	Check whether power supply is switched ON.	If power supply is ON and still no water dispense, call Customer Care Centre.

# Water Flow Diagram

**Water flow diagram**

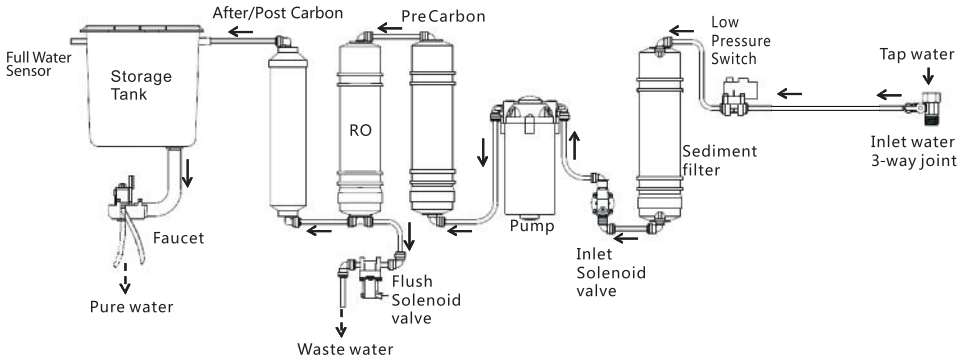

# Electric Diagram

**Water flow diagram**

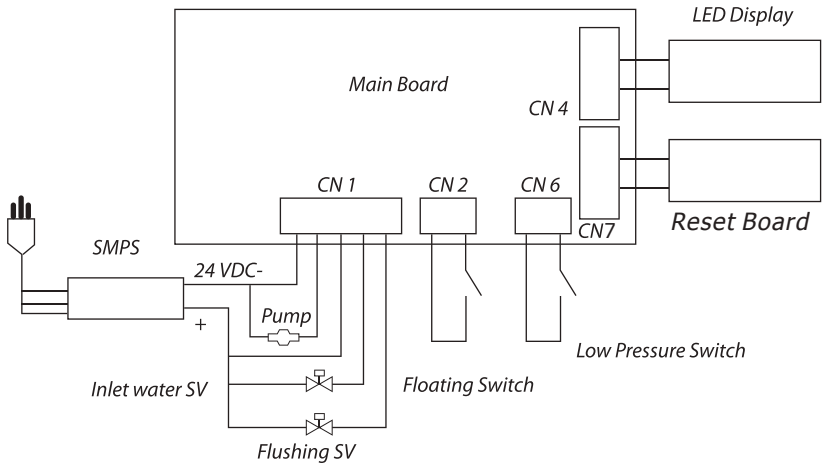



# Technical Specifications

## Water Purifier

Item Name	RO Water Purifier	
Model Names	JN1742T-RO	
Tank Material	Food Grade material tank	
Net Weight	7.5kg	
Gross Weight	9.1kg	
Product Dimension (WXDXH)	340x255x485 mm	
Purification Method	Reverse Osmosis	
Power Supply	220-240V AC 50/60Hz	
Power Consumption	20W	
Extraction Structure	Electronic Extraction Structure	
Function Of Control Part	Power Display, Tank full Display & Service Alert Display	
Main Function	RO Purification Function with 4 stage Purification	
RO Membrane	50 GPD	
Volume Of Tank	Purified Water	8 L
Filter Material	Sediment Filter	PP
	Pre-Carbon Filter	Activated Carbon
	Membrane Filter (RO)	Polysulfone + Polyamides
	After/Post-Carbon Filter	Activated Carbon
Pump Type	Diaphragm Pump, 24 V DC, 1.08 Amps, Open Hose > 1.6 L/min	
Effective Purifying Capacity of RO	6000 L	
Installation Water Pressure	0.1 ~ 0.4 MPa	
Temperature Of Environment	4 ~ 38 °C	
TDS Reduction	90% < TDS Redution	
RO Recovery Rating	> 20% Recovery rate within filter life time	

Recommended input feed water quality for the optimum performance of your product

RECOMMENDED FEED WATER QUALITY	
Parameter	Limits
Total Dissolved Solids TDS	Up to 2000 ppm
Total hardness	Up to 500 ppm
Turbidity	Up to 5 NTU
Iron	0.3 ppm (max.)
Feed water pressure	0.1 ~ 0.4 MPa
Feed water temperature	4 ~ 38 °C

### Notice

The amount of purified water depends on water pressure and water temperature.

Tank capacity is the capacity from the tank size and might be different from the extracted amount.

The product is subject to change without advanced notice.

# Recommended Filter change frequency

---

## Water flow diagram

### **Pre-filter change**

The Pre-filter cartridge needs to be replaced approximately after 3,000 liters\* of purified water.

### **Sediment and Pre Carbon filter**

The Sediment and Pre Carbon filter need to be replaced approximately after 3,000 liters\* of purified water.

### **Activated After/Post Carbon**

Activated After/Post Carbon need to be replaced at approximately 6,000 liters\* of purified water.

### **RO Membrane change**

As per the warranty, the RO membrane needs to be replaced at approximately 6,000 liters\* purified water or approximately 12,000 liters\* purified water depending on the quality of the feed water.

*\*Under standard test condition.*

*Filter life may vary according to TDS of the input water supply.*

# 1 YEAR LIMITED WARRANTY

---

This is the only express warranty for the product and in lieu of any other warranty or condition.

This product is warranted to be free from defects in material and workmanship for a period of one year from the date of original purchase. During this period, your exclusive remedy is repair or replacement of this product or any component found to be defective, at our option; however, you are responsible for all costs associated with returning the product to us and our returning the product or component under this warranty to you. If the product or component is no longer available, we will replace with a similar one equal or greater value.

This warranty does not cover wear from normal use, and operation doesn't conform with the instruction manual, or damages to the product resulting from accident, alteration, abuse, or misuse. This warranty extends only to the original consumer purchaser, or gift recipient. Keep the original sales receipt, as proof of purchase is required to make a warranty claim. This warranty is void if product is used for other than single-family household use or subjected to any voltage and waveform other than as specified on the label.

We exclude all claims for special, incidental, and consequential damages by breach of express or implied warranty. All liability is limited to amount of the purchase price. Every implied warranty, including any statutory warranty or condition of merchantability or fitness for particular purpose, is disclaimed except to the extent prohibited by law, in which case such warranty or condition is limited to the duration of this written warranty.

This warranty gives you specific legal rights. You may have other legal rights that vary depending on where you live. Some states or provinces do not allow limitations on implied warranties or special, incidental consequential damages, so the foregoing limitations may not apply to you.

