

Installation and User Manual

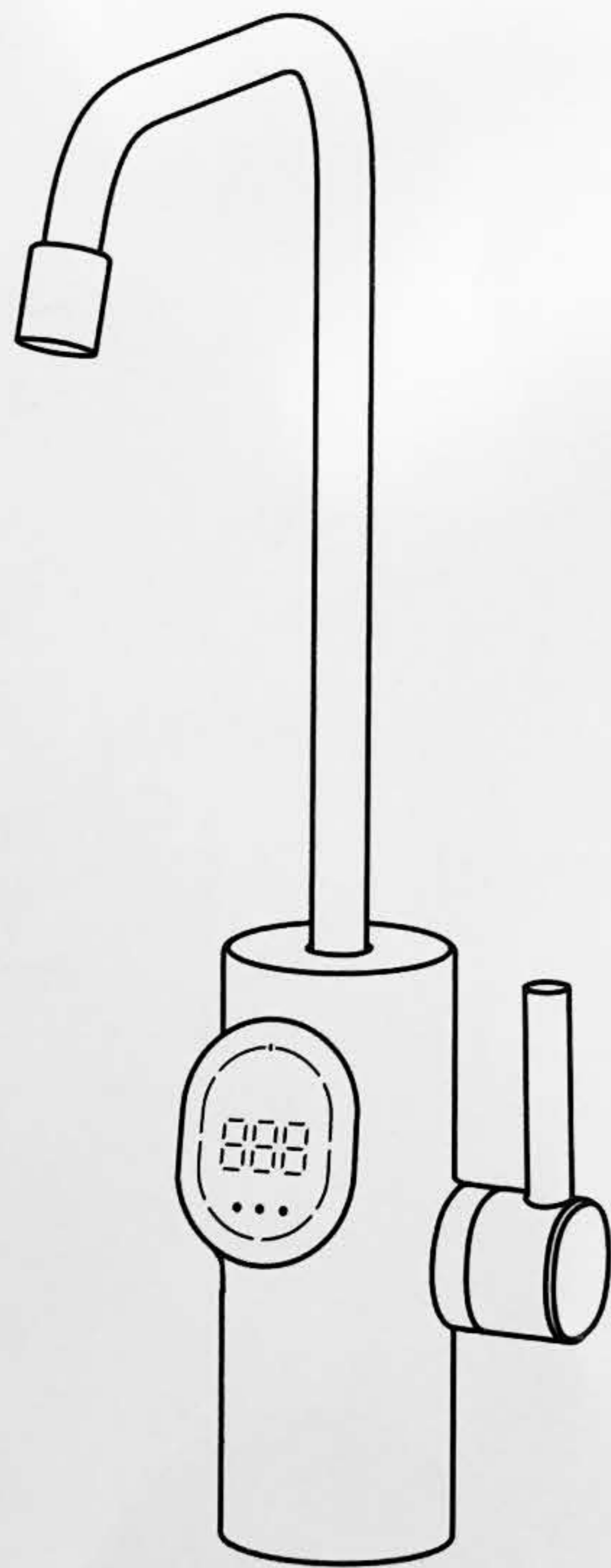

Faucet Display

1. The system is powered on: All indicators flash 5 times (Figure 1).
2. The faucet is turned off: When the RO system is powered on, the screen will show the filter's status. If there is no operation for 1 minute, the screen will switch to standby mode (Figure 2).

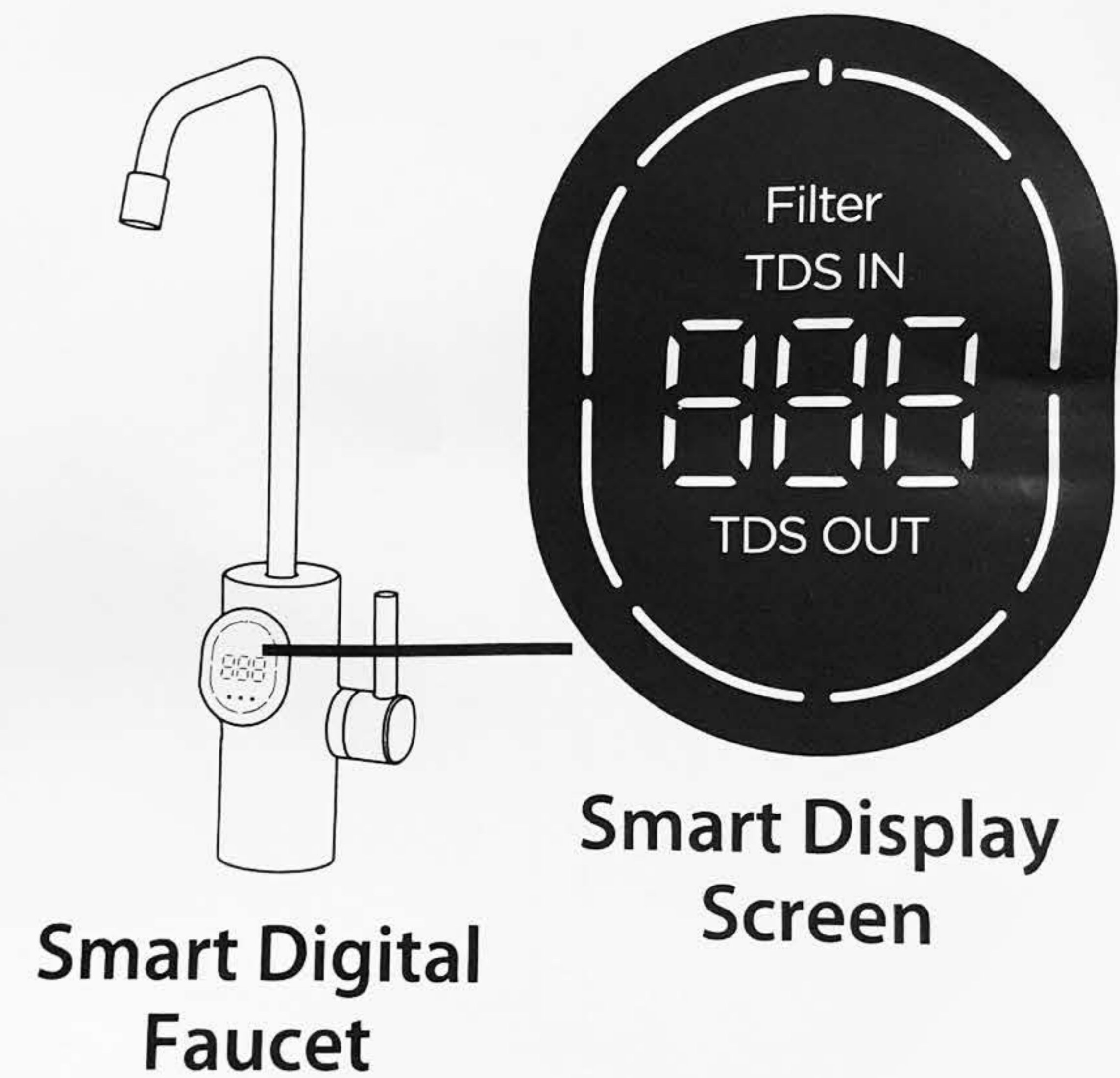
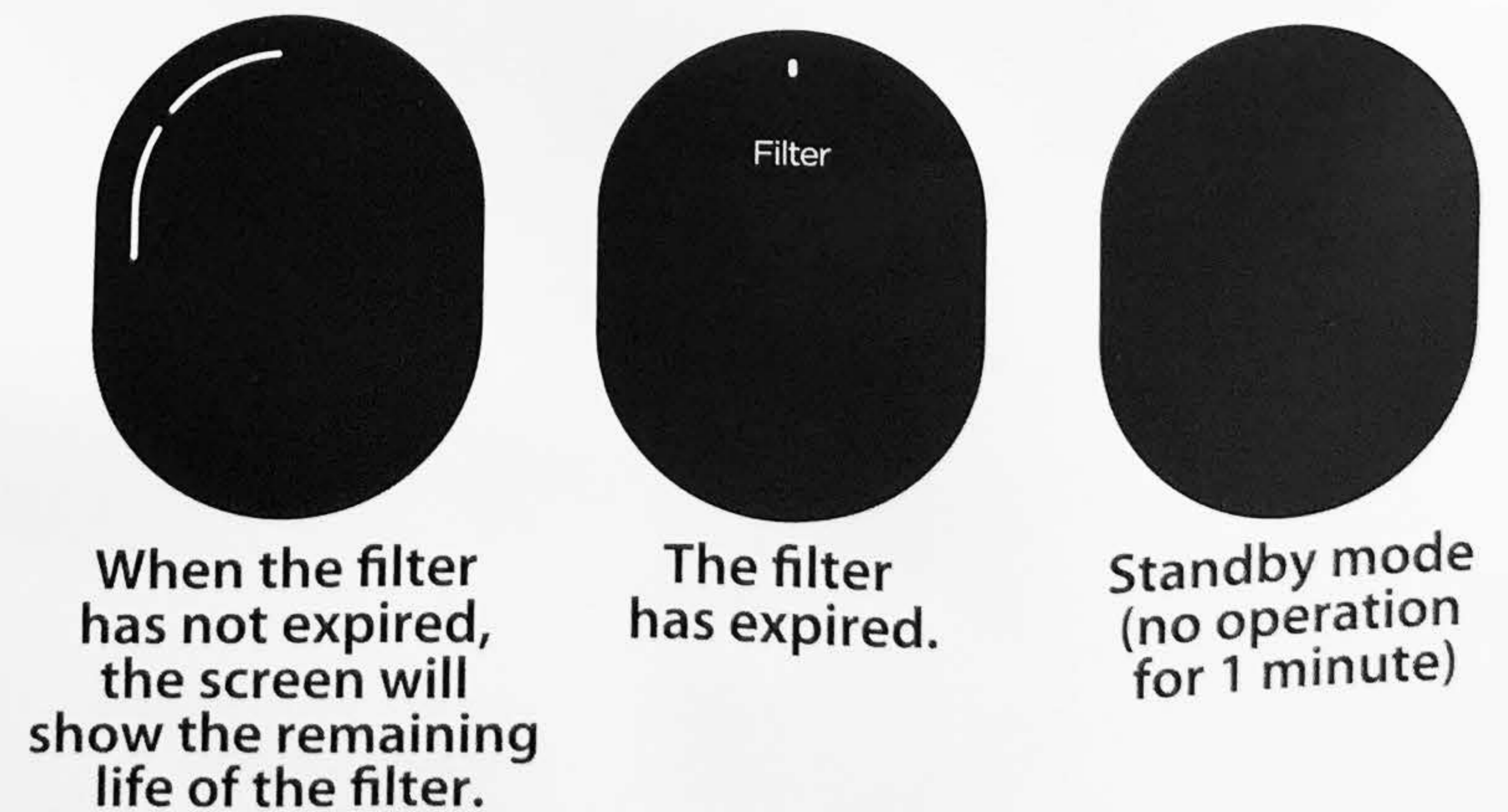

Figure 1



When the filter has not expired, the screen will show the remaining life of the filter.

The filter has expired.

Standby mode (no operation for 1 minute)

Figure 2

3. Filter life reminder (when the faucet is turned on)

- If the filter has not expired, every segment of the ring light will be on. Then, they will be off one by one, and the remaining segments indicate the life of the filter.

Note: When there are two segments of the ring light on the screen, the life of the filter remains about 4%-15% (40-150 gallons), which may vary based on your water conditions. It is recommended that you prepare a replacement filter in advance.

- If the filter has expired, the ring light will be off. Also, the filter replacement indicator will turn red and the screen will display "Filter" after flashing 3 times (Figure 3).

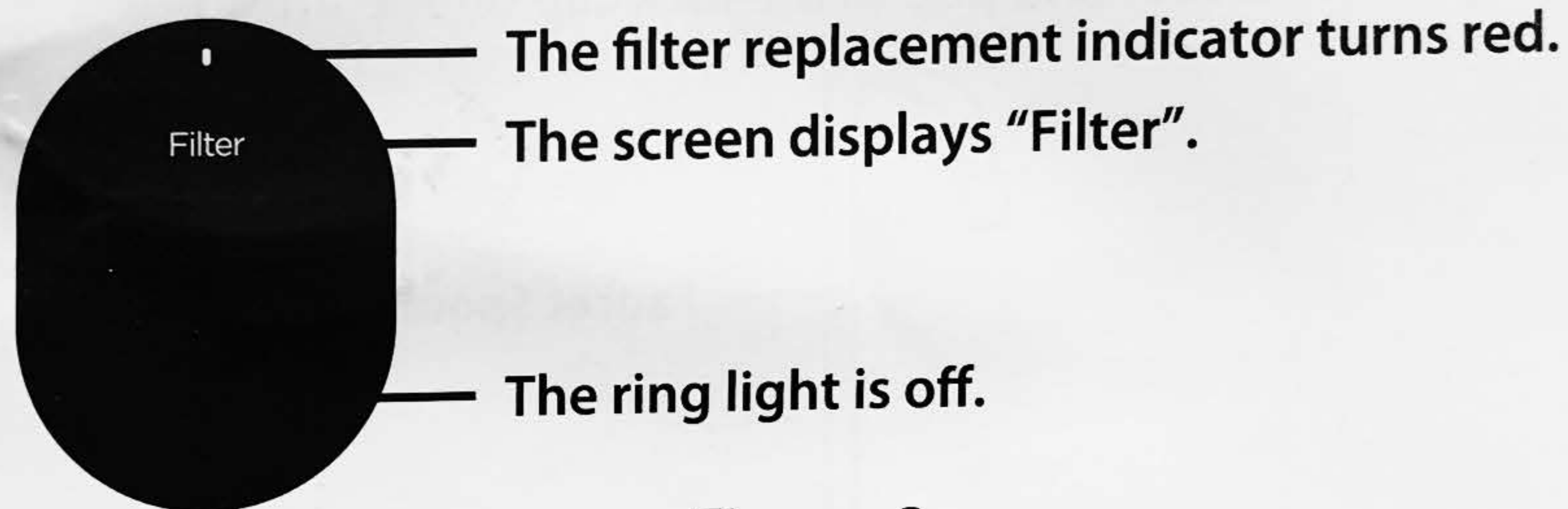

Figure 3

4. Malfunction display:

E9: If the faucet is powered on and does not receive the correct data for 5 seconds, the screen will display "E9" and then switch to standby mode after 1 minute.

Note: Check the power cord of the faucet to see whether it is plugged in. If not, plug it in. Check on whether the power cord is damaged. If so, please contact Waterdrop customer service.

E6: When the system continuously works for over 40 minutes, it will enter timeout protection mode. The screen will display "E6".

Note: Press the power button for 3 seconds. The filter indicator light will turn off. Then press the power button for 3 seconds to power on the system. It will automatically flush for 25 seconds. If you turn on the faucet during flushing, the outlet water flow will be slow, which is normal.

EA: When the TDS display is abnormal, the screen will display "EA".

Note: You will need to unplug the power and plug it in again. If the problem has not been resolved, please contact Waterdrop customer service.

Install the Faucet

Note: If there is no hole in your kitchen sink or countertop, you have to drill one (1") or use the hole from the soap dispenser.

1. Insert the faucet stem and power cord into mounting washer 1.
2. Insert the faucet stem and power cord into the hole on the countertop. Fix mounting washer 1 on the countertop.
3. Under the sink, put mounting washer 2 and 3 on the faucet stem. Slip on the nut and tighten it.
4. Insert one end of the blue 1/4" PE tubing into the quick-connect fitting on the faucet and pop in the lock clip on the fitting.

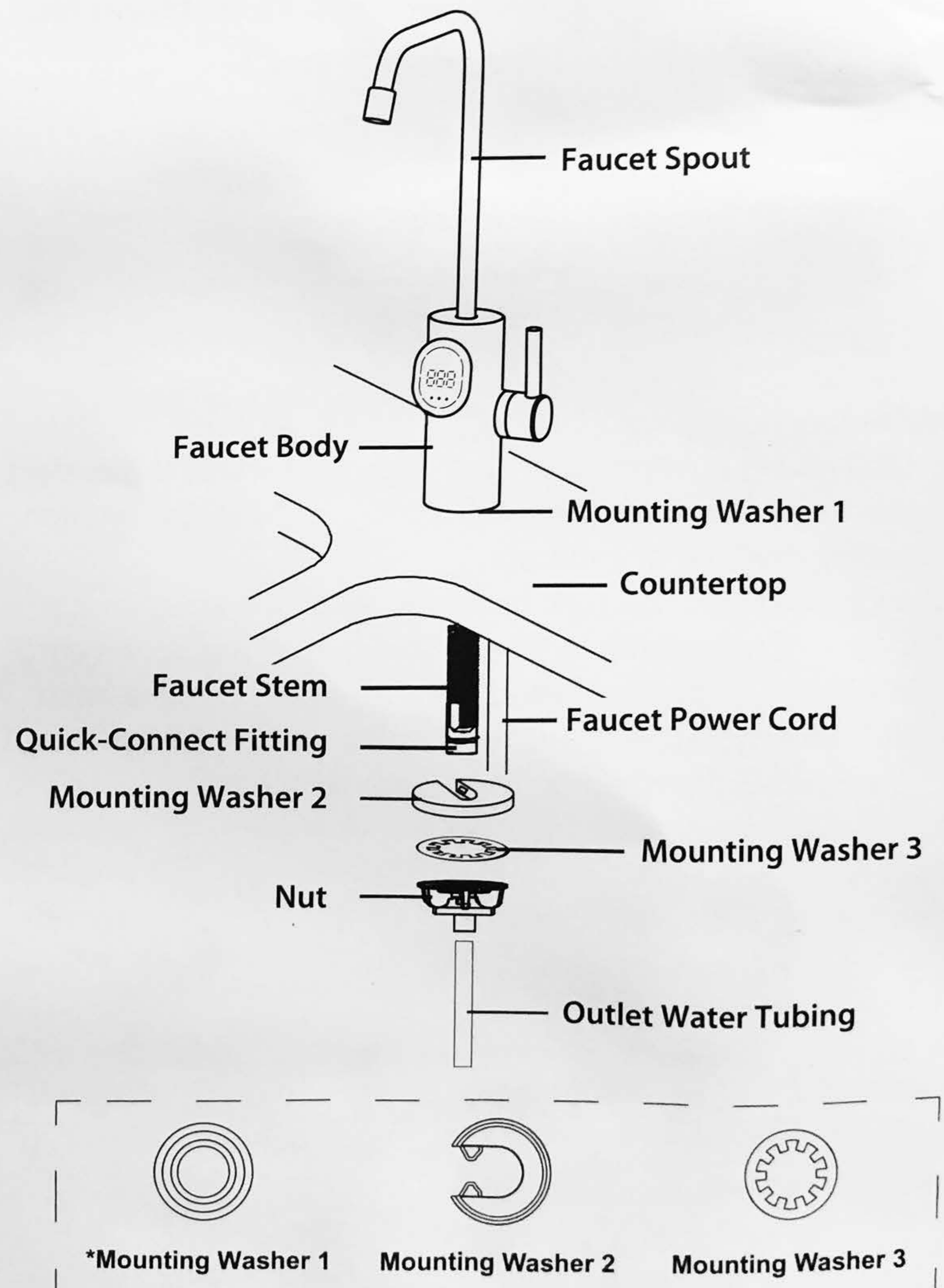

***NOTE:** Please use the black mounting washer 1 that has the groove. You won't need the other black mounting washer.