



EN

Midea

SHOWCASE

USER MANUAL

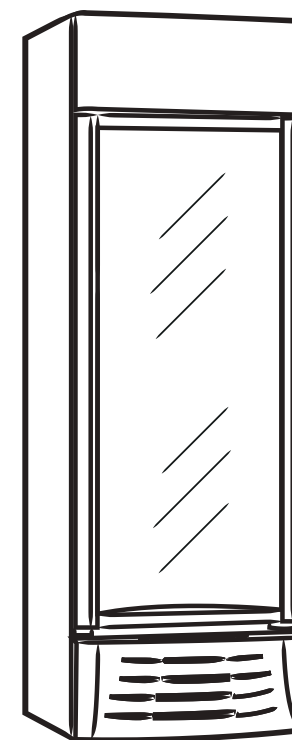

Midea

Make yourself at home



Warning:
Before using this product, please read this manual carefully and keep it for future reference. The design and specifications are subject to change without prior notice for product improvement. Consult with your dealer or manufacturer for details.

version:003-8-2021

**MODEL: MDRZ302FZ
MDRZ432FZ
SERIES**

www.midea.com

CONTENTS

1 Safety warnings	
1.1 Warning	1-2
1.2 Meaning of safety warning symbols	3
1.3 Electricity related warnings	3
1.4 Related warnings for use	4
1.5 Warnings related to placing items	5
1.6 Warnings for energy	5
1.7 Warnings related to disposal	5
2 Proper use of commercial showcase	
2.1 Names of components	6
2.2 Temperature Control	7
2.3 Changing the Light	7
2.4 Placement	7
2.5 Start to use	7
2.6 Adjust the support foot	8
2.7 Open door dimensions	8
2.8 Energy saving tips	8
3 Maintenance of commercial showcase	
3.1 Cleaning	9
3.2 Stop using	9
3.3 Maintenance frequency	9
4 Trouble shooting	10

1 Safety warnings

1.1 Warning



Warning: risk of fire / flammable materials

THIS appliance is intended to be used in household and similar applications such as staff kitchen areas in shops, offices and other working environments; farm houses and by clients in hotels, motels and other residential type environments; bed and breakfast type environments; catering and similar non-retail applications.

IF the supply cord is damaged, it must be replaced by the manufacturer, its service agent or similarly qualified persons in order to avoid a hazard.

DO not store explosive substances such as aerosol cans with a flammable propellant in this appliance.

THE appliance has to be unplugged after use and before carrying out user maintenance on the appliance.

WARNING: Keep ventilation openings, in the appliance enclosure or in the built-in structure, clear of obstruction.

WARNING: Do not use mechanical devices or other means to accelerate the defrosting process, other than those recommended by the manufacturer.

WARNING: Do not damage the refrigerant circuit.

WARNING: Do not use electrical appliances inside the food storage compartments of the appliance, unless they are of the type recommended by the manufacturer.

WARNING: Please abandon the refrigerator according to local regulators for its use of flammable blowing gas and refrigerant.

WARNING: When positioning the appliance, ensure the supply cord is not trapped or damaged.

WARNING: Do not locate multiple portable socket-outlets or portable power supplies at the rear of the appliance.

DO not use extension cords or ungrounded (two prong) adapters.

DANGER: Risk of child entrapment. Before you throw away your old refrigerator or freezer:

–Take off the doors.

–Leave the shelves in place so that children may not easily climb inside.

THE refrigerator must be disconnected from the source of electrical supply before attempting the installation of accessory.

REFRIGERANT

and cyclopentane foaming material used for the appliance are flammable. Therefore, when the appliance is scrapped, it shall be kept away from any fire source and be recovered by a special recovering company with corresponding qualification other than be disposed by combustion, so as to prevent damage to the environment or any other harm.

FOR EN standard: This appliance can be used by children aged from 8 years and above and persons with reduced physical sensory or mental capabilities or lack of experience and knowledge if they have been given supervision or instruction concerning use of the appliance in a safe way and understand the hazards involved. Children shall not play with the appliance. Cleaning and user maintenance shall not be made by children without supervision.

FOR IEC standard: This appliance is not intended for use by persons (including children) with reduced physical, sensory or mental capabilities, or lack of experience and knowledge, unless they have been given supervision or instruction concerning use of the appliance by a person responsible for their safety.)



CHILDREN should be supervised to ensure that they do not play with the appliance.

TO avoid contamination of food , please respect the following instructions:

- Opening the door for long periods can cause a significant increase of the temperature in the compartments of the appliance.
- Clean regularly surfaces that can come in contact with food and accessible drainage systems.
- Clean water tanks if they have not been used for 48 h; flush the water system connected to a water supply if water has not been drawn for 5 days. (note 1)
- Store raw meat and fish in suitable containers in the refrigerator, so that it is not in contact with or drip onto other food.
- Two-star **(**)** frozen-food compartments are suitable for storing pre-frozen food, storing or making ice-cream and making ice cubes. (note 2)
- One **(*)**-, two **(**)**-and three-star **(***)** compartments are not suitable for the freezing of fresh food. (note 3)
- If the refrigerating appliance is left empty for long periods, switch off, defrost, clean, dry, and leave the door open to prevent mould developing within the appliance.

Note 1,2,3: Please confirm whether it is applicable according to your product compartment type.

1.2 Meaning of safety warning symbols

	The symbols indicate prohibited matters, and those behaviors are forbidden. Non-compliance with the instructions may result in product damages or endanger the personal safety of users.
	The symbols indicate matters that must be followed, and those behaviors must be strictly executed in line with the operation requirements. Non-compliance with the instructions may result in product damages or endanger the personal safety of users.
	The symbols indicate matters to pay attention to, and these behaviors shall be specially noted. Due precautions are needed or minor or moderate injuries or damages of the product will be caused.

This manual contains lots of important safety information which shall be observed by the users.

1.3 Electricity related warnings

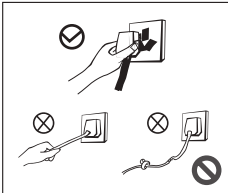

- Do not pull the power cord when pulling the power plug of the commercial showcase. Please firmly grasp the plug and pull out it from the socket directly.
- Do not damage the power cord under any condition so as to ensure safety use, do not use when the power cord is damaged or the plug is worn.
- Worn or damaged power cord shall be replaced in manufacturer-authorized maintenance stations.

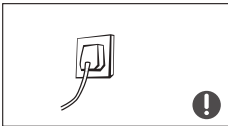

- The power plug should be firmly contacted with the socket or else fires might be caused. Please ensure that the grounding electrode of the power socket is equipped with a reliable grounding line.



- Please turn off the valve of the leaking gas and then open the doors and windows in case of leakage of gas and other flammable gases. Do not unplug the commercial showcase and other electrical appliances considering that spark may cause a fire.

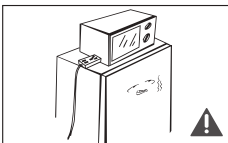

- To ensure safety, it is not recommended that to place regulators, rice cookers, microwave ovens and other appliances on the top of the commercial showcase, those recommended by the manufacturer are not included. Do not use electrical appliances in the food pan.

1.4 Related warnings for use

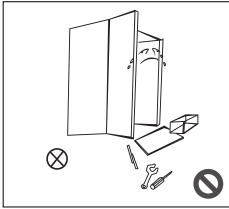

- Do not arbitrarily disassemble or reconstruct the commercial showcase, nor damage the refrigerant circuit; maintenance of the appliance must be conducted by a specialist.
- Damaged power cord must be replaced by the manufacturer, its maintenance department or related professionals in order to avoid danger.

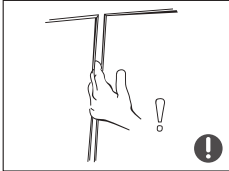

- The gaps between commercial showcase doors and between doors and commercial showcase body are small, be noted not to put your hand in these areas to prevent from squeezing the finger. Please be gentle when open the commercial showcase door to avoid falling articles.

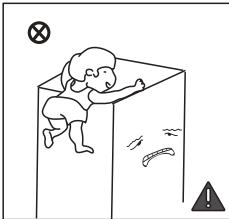

- Do not allow children to enter or climb the commercial showcase to prevent that children are sealed in the commercial showcase or children are injured by the falling commercial showcase.
- Do not spray or wash the commercial showcase; do not put the commercial showcase in moist places easy to be splashed with water so as not to affect the electrical insulation properties of the commercial showcase.

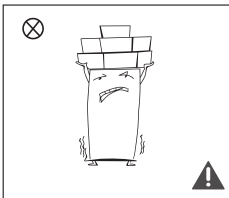

- Do not place heavy objects on the top of the commercial showcase considering that objects may fall when open the door, and accidental injuries might be caused.
- Please pull out the plug in case of power failure or cleaning. Do not connect the commercial showcase to power supply within five minutes to prevent damages to the compressor due to successive starts.

1.5 Warnings related to placing items

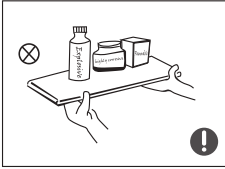

- Do not put flammable, explosive, volatile and highly corrosive items in the commercial showcase to prevent damages to the product or fire accidents.
- Do not place flammable items near the commercial showcase to avoid fires.

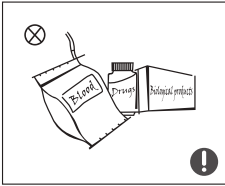



- This product is commercial showcase and shall be only suitable for the storage of commercial foods and drinks. According to national standards, commercial showcase shall not be used for other purposes, such as storage of blood, drugs or biological products.
- In storage of drinks, keep some spacing between them for sake of cold air circulation. Seal the drinks before placing them in the showcase to prevent water dissipation and risk of odor. Adopt suitable packaging material for drinks, the material shall be toxic free, smell free, air tight and water proof. The drinks shall be cleaned and wiped dry before being placed in the refrigerated cabinet for storage. In storage of drinks, make sure to follow the storage period indicated by the producer (indicate storage date on the package to prevent past-due).

1.6 Warnings for energy

- The commercial showcase shall be placed in room dry and ventilated. The commercial showcase can not be put under direct sunlight or next to heat source (such as radiator, stove, etc.), and a suitable insulation board shall be applied if necessary.
- Try to shorten opening time of commercial showcase's door.
- Put beverages into commercial showcase after it has cooled down.

1.7 Warnings related to disposal

 The commercial showcase's refrigerant and cyclopentane foam materials are combustible materials and discarded commercial showcases should be isolated from fire sources and can not be burned. Please transfer the commercial showcase to qualified professional recycling companies for processing to avoid damages to the environment or other hazards.

 Please remove the door of the commercial showcase and shelves which shall be properly placed, to avoid accidents of children entering and playing in the commercial showcase.



Correct Disposal of this product:

This marking indicates that this product should not be disposed with other household wastes. To prevent possible harm to the environment or human health from uncontrolled waste disposal, recycle it responsibly to promote the sustainable reuse of material resources. To return your used device, please use the return and collection systems or contact the retailer where the product was purchased. They can take this product for environmental safe recycling.

2 Proper use of commercial showcase

2.1 Names of components

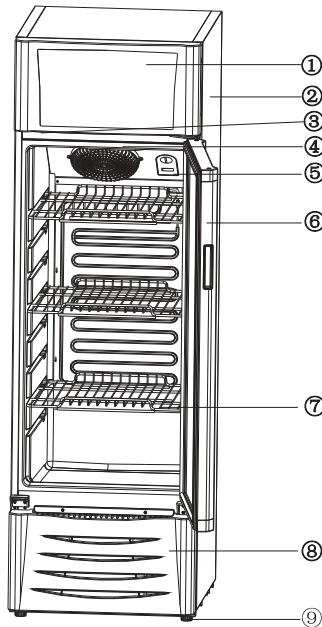

(The picture above is only for reference. The actual configuration will depend on the physical product or statement by the distributor)

- ①Light Box ②Cabinet ③Lamp Switch ④Internal Lamp ⑤Temperature Control Panel
⑥Door ⑦Shelf ⑧Compressor Room ⑨Adjustable Foot

Product features

- Performance is reliable; the famous brand and high efficient compressor is adopted, featuring excellent performance and high reliability.
- The top dismountable lamp box is adopted, what can be used for decoration and advertisement.
- The double layer hollow glass door is used; it has internal lamp and internal display can be totally in view.
- The storage rack is flexible for regulation based on physical objects or container size; storage is convenient.
- The compressor room is designed with drainage tray; the heat of the compressor evaporates the water inside the tray.
- The e-friendly refrigerant and cyclopentane foaming agent are used.

2.2 Temperature Control

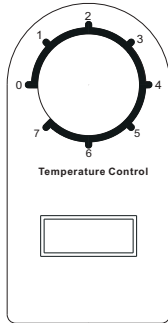

- The storage temperature of the commercial show case can be adjusted by temperature controller what is on the air duct panel in the commercial show case.
- The number on the controller indicates temperature level but not specific temperature.
- The temperature controller is used to adjust temperature from 10 °C to 1°C; the user may adjust the temperature according to actual requirements. the larger the number, the lower the temperature in the case will be; the smaller the number, the higher the temperature in the case will be. " 0 " means stop running.

(The picture above is only for reference. The actual configuration will depend on the physical product or statement by the distributor)

2.3 Changing the Light

Any replacement or maintenance of the LED lamps is intended to be made by the manufacturer, its service agent or similar qualified person.

2.4 Placement

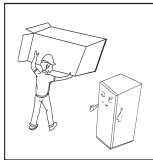

- Before using the commercial showcase, remove all packaging materials including bottom cushions and foam pads and tapes inside the commercial showcase, tear off the protective film on the door and the commercial showcase body.

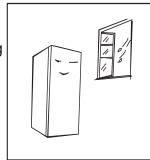

- The commercial showcase should be placed in a well-ventilated indoor place; the ground shall be flat, and sturdy .

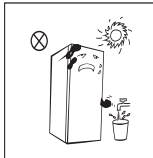

- Keep away from heat and avoid direct sunlight. Do not place the commercial showcase in moist or watery places to prevent rust or reduction of insulating effect.

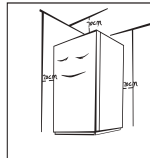

- The top space of the commercial showcase shall be greater than 70cm, and the distances from both sides and backside shall be more than 20cm to facilitate heat dissipation.

2.5 Start to use

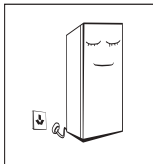

- The commercial showcase shall stay for 2 hours before connecting power when it is firstly started.
- The commercial showcase shall run 2 to 3 hours before loading fresh or frozen foods; the commercial showcase shall run for more than 4 hours in summer in advance considering that the ambient temperature is high.

2.6 Adjust the support foot

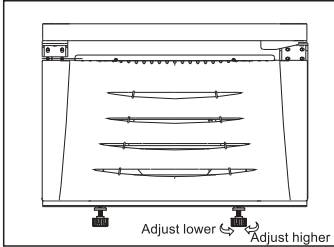

- Keep the product on the flat ground; then adjust the support foot to contact the ground to ensure product stability.

(The picture above is only for reference. The actual configuration will depend on the physical product or statement by the distributor)

2.7 Open door dimensions

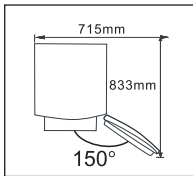

- Please leave enough space to ensure feasible opening .
- Dimensions shown are for reference only.

2.8 Energy saving tips

- The appliance should be located in the coolest area of the room, away from heat producing appliances or heating ducts, and out of the direct sunlight.
- Let hot foods cool to room temperature before placing in the appliance. Overloading the appliance forces the compressor to run longer. Foods that freeze too slowly may lose quality, or spoil.
- Be sure to wrap foods properly, and wipe containers dry before placing them in the appliance. This cuts down on frost build-up inside the appliance.
- Appliance storage bin should not be lined with aluminum foil, wax paper, or paper toweling. Liners interfere with cold air circulation, making the appliance less efficient.
- Organize and label food to reduce door openings and extended searches. Remove as many items as needed at one time, and close the door as soon as possible.

3 Maintenance of commercial showcase

3.1 Cleaning

- Dusts behind the commercial showcase and on the ground shall be timely cleaned to improve the cooling effect and energy saving.
- Check the door gasket regularly to make sure there are no debris. Clean the door gasket with a soft cloth dampened with soapy water or diluted detergent.
- The interior of the commercial showcase should be cleaned regularly to avoid odor.
- Please turn off the power before cleaning interior, remove all foods, drinks, shelves, drawers, etc.
- Use a soft cloth or sponge to clean the inside of the commercial showcase, with two tablespoons of baking soda and a quart of warm water. Then rinse with water and wipe clean. After cleaning, open the door and let it dry naturally before turning on the power.
- For areas that are difficult to clean in the commercial showcase (such as narrow sandwiches, gaps or corners), it is recommended to wipe them regularly with a soft rag, soft brush, etc. and when necessary, combined with some auxiliary tools (such as thin sticks) to ensure no contaminants or bacterial accumulation in these areas.
- Do not use soap, detergent, scrub powder, spray cleaner, etc., as these may cause odors in the interior of the commercial showcase or contaminated food.
- Clean the bottle frame, shelves and drawers with a soft cloth dampened with soapy water or diluted detergent. Dry with a soft cloth or dry naturally.
- Wipe the outer surface of the commercial showcase with a soft cloth dampened with soapy water, detergent, etc., and then wipe dry.
- Do not use hard brushes, clean steel balls, wire brushes, abrasives (such as toothpastes), organic solvents (such as alcohol, acetone, banana oil, etc.), boiling water, acid or alkaline items, which may damage the commercial showcase surface and interior. Boiling water and organic solvents such as benzene may deform or damage plastic parts.
- Do not rinse directly with water or other liquids during cleaning to avoid short circuits or affect electrical insulation after immersion.



 Please unplug the commercial showcase for defrost and cleaning.

3.2 Stop using

Power failure: Foods can be preserved for a couple of hours even in summer in case of power failure; it is recommended to reduce the frequency of opening door and do not put fresh foods into the commercial showcase.

Long-time nonuse: Please unplug the commercial showcase if it is left unused for a long time for cleaning. Keep the door open to avoid the bad odor.

Moving: When it needs to move the showcase, do not turn upside or vibrate the commercial showcase, the carrying angle can not be greater than 45°.

 Continuous operation is recommended when the commercial showcase is started. Please do not stop the commercial showcase under normal circumstances so as not to affect the commercial showcase's service life.

3.3 Maintenance frequency

Suggest a cleaning service once a month.

4 Trouble shooting

The following simple issues can be handled by the user. Please call the after-sale service department if the issues are not settled.

Inoperation	Whether the commercial showcase is plugged and connected to power; Low voltage; Whether temperature control knob is in the work area; Failure power or tripping circuit.
Odor	Odorous foods should closely wrapped; Whether foods are rotten; Whether the interior shall be cleaned.
Long-term operation of compressor	It is normal that commercial showcase operates for longer time in summer when the ambient temperature is higher; Do not put too much food in the commercial showcase at one time; Do not put foods until they are cooled; Frequent opening of commercial showcase door; Thick frost layer (defrost is needed).
Illuminating light does not shine	Whether the commercial showcase is connected to power, whether the light is damaged.
The commercial showcase door can not be properly closed	The commercial showcase door is stuck by food packages; Too much food; Unbalanced commercial showcase.
Loud noises	Whether the floor is flat, whether the placement of commercial showcase is stable; Whether the commercial showcase parts are properly placed.
Transient difficulty in door opening	After refrigeration, there will be pressure difference between the inside and outside of the commercial showcase to result in transient difficulty in door opening. This is a normal physical phenomenon.
Commercial showcase enclosure heat Condensation	The commercial showcase enclosure may emit heat during operation specially in summer, this is caused by the radiation of the condenser, and it is a normal phenomenon. Condensation: condensation phenomenon will be detected on the exterior surface and door seals of the commercial showcase when the ambient humidity is high, this is a normal phenomenon, and the condensation can be wiped away with a dry towel.
Airflow sound Buzz Clatter	Refrigerant circulating in the refrigerant lines will produce eruption of sound and grunts which is normal does not affect the cooling effect. Buzz will be generated by running compressor specially when starting up or shutting down. The solenoid valve or electric switch valve will clatter which is a normal phenomenon and does not affect the operation.

Test room climate class	Dry bulb temperature °C	Relative humidity %	Dew point °C	Water vapour mass in dry air g/kg
0	20	50	9.3	7.3
1	16	80	12.6	9.1
2	22	65	15.2	10.8
3	25	60	16.7	12.0
4	30	55	20.0	14.8
5	40	40	23.9	18.8
6	27	70	21.1	15.8
7	35	75	23.9	27.3
8	23.9	55	14.3	10.2

NOTE The water vapour mass in dry air is one of the main points influencing the performance and the energy consumption of the cabinets. See also Annex D to compare lab and store conditions.

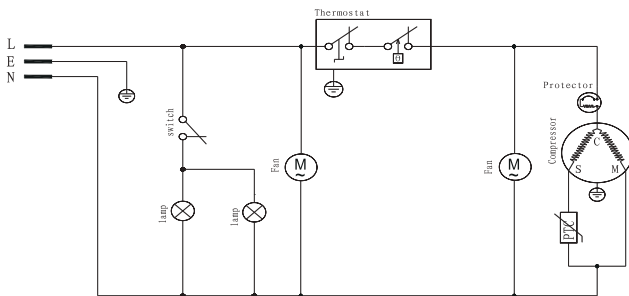

(The actual rating plate on appliance shall prevail in case of any discrepancy between the two versions)