

Cumbia

Making 200-400-600-1000

Coffee maker



Instruction manual

cecotec

INDEX

| | |
|---|----|
| 1. Safety instructions | 10 |
| 2. Before use | 11 |
| 3. Operation | 11 |
| 4. Cleaning and maintenance | 12 |
| 5. Technical specifications | 12 |
| 6. Disposal of electrical appliances | 12 |
| 7. Technical support service and warranty | 13 |

1. SAFETY INSTRUCTIONS

Read these instructions thoroughly before using the appliance. Keep this instruction manual for future reference or new users.

- Do not overheat the appliance and do not set the flame too high to avoid it from coming up the coffee machine walls. This could damage the product's handle.
- Do not store espresso coffee inside the coffee machine.
- Do not use the product if all parts and components are not included and assembled.
- The temperature of accessible surfaces may be high while in use and could cause burns. Do not touch hot surfaces while in use or immediately after. Use protection to avoid burns.
- Keep the coffee machine away from children while it is being operated and while it contains hot substances.
- Do not use extracts or substances other than coffee.
- Do not press coffee down.
- This device is designed to be used with water only.
- Do not use the coffee maker without water.
- Allows the device to cool down before

opening it.

- During use, hold the device by the handle to avoid burns.

Note: The coffee machine will stain on the inside due to coffee and water minerals, and on the outside due to direct exposure to heat. This is a normal process that will take place over time.

2. BEFORE USE

- Take the product out of the box and remove all labels.
- Make sure the product is in good conditions and that there are no parts missing.
- Wash the product with warm soapy water to remove any dirt or oil.
- Dry it thoroughly before using it.

3. FUNCIONAMIENTO

NOTE: The coffee maker is suitable for induction hobs (except for the 3-cup model).

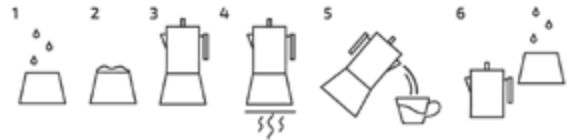

1. After cleaning the coffee machine, fill the base with water up to the safety valve.
2. Place the funnel in the base of the coffee machine. Fill the funnel with finely-ground espresso coffee.
3. Place the top part of the coffee machine on the base and close tightly.
4. Set the stove to low or low-medium heat. When using a gas-flame stove, make sure the product's handle is not exposed

directly to the flame.

5. After a few minutes, water will start boiling and coffee will start percolating into the top part of the coffee machine.
6. Pour your coffee carefully
7. Once the coffee machine has cooled down, unscrew the top part and clean it thoroughly.

Note: Avoid the coffee maker from coming into contact with salty or acid substances.

4. CLEANING AND MAINTENANCE

- Do not pour cold water into the coffee machine while it is hot.
- Use specific cleaning agents for metallic surfaces to clean the product's surface.
- Wash it with water and soap after each use.
- Dry it thoroughly before storing it to avoid stains.
- Do not use abrasive or chemical products to clean the device.
- The coffee maker is dishwasher safe (with the exception of the Shiny model).

5. TECHNICAL SPECIFICATIONS

Product: Moking 200, Moking 400, Moking 600, Moking 1000

Product reference: 01620, 01621, 01622, 01623

6. DISPOSAL OF OLD ELECTRICAL APPLIANCES



The European directive 2012/19/EU on Waste Electrical and Electronic Equipment (WEEE), specifies that old household electrical appliances must not be disposed of with the normal unsorted municipal waste. Old appliances must be collected separately, in order to optimize the recovery and recycling of the materials they contain, and reduce the impact on human health and the environment.

The crossed out "wheeled bin" symbol on the product reminds you of your obligation to dispose of the appliance correctly. If the product has a built-in battery or uses batteries, they should be removed from the appliance and disposed of appropriately.

Consumers must contact their local authorities or retailer for information concerning the correct disposal of old appliances and/or their batteries.

7. TECHNICAL SUPPORT SERVICE AND WARRANTY

This product is under warranty for 2 years from the date of purchase, as long as the proof of purchase is submitted, the product is in perfect physical condition, and it has been given proper use, as explained in this instruction manual.

The warranty will not cover the following situations:

- The product has been used for purposes other than those intended for it, misused, beaten, exposed to moisture, immersed in liquid or corrosive substances, as well as any other fault attributable to the customer.
- The product has been disassembled, modified, or repaired by persons, not authorised by the official Technical Support Service of Cecotec.
- Faults deriving from the normal wear and tear of its parts, due to use.

The warranty service covers every manufacturing defects of your appliance for 2 years, based on current legislation, except consumable parts. In the event of misuse, the warranty will not apply.

If at any moment you detect any problem with your product or have any doubt, do not hesitate to contact Cecotec Technical Support Service at **+34 96 321 07 28**.

cecotec

Grupo Cecotec Innovaciones S.L.
C/de la Pinadeta s/n, 46930
Quart de Poblet, Valencia, Spain

www.cecotec.es

EA01191104