

Cumbia

COFFEE 66 HEAT

Cafetera de goteo / Drip coffee Machine / Кавоварка крапельна/Кофеварка капельная



cecotec

Manual de instrucciones
Instruction manual
Інструкція з експлуатації
Руководство по
эксплуатации

INDEX

1. Parts and components	34
2. Before use	34
3. Operation	34
4. Cleaning and maintenance	35
5. Tips	35
6. Technical specifications	36
7. Disposal of old electrical appliances	36
8. Technical support and warranty	36

SAFETY INSTRUCTIONS

Read these instructions thoroughly before using the appliance. Keep this instruction manual for future reference or new users. All safety instructions should be closely followed when using the appliance. Do not use the appliance for other than intended use.

The temperature of accessible surfaces may be high while in use and could cause burns. Do not touch hot surfaces while in use or immediately after.



Do not immerse the cord, plug, or any non-removable part of the appliance in water or any other liquid, nor expose the electrical connections to water. Make sure your hands are dry before handling the plug or switching on the appliance.

Turn off and unplug the appliance from the mains supply when not in use and before cleaning it. Pull from the plug, not the cord, to disconnect it from the outlet.

Check the power cord regularly for visible damage. If the cord is damaged, it must be replaced by the official Technical Support Service of Cecotec in order to avoid any type of danger.

Do not use any accessory that has not been recommended by Cecotec, as they might cause injuries or damage.

Do not twist, bend, strain, or damage the power cord in any way. Protect it from sharp edges and heat sources. Do not let it touch hot surfaces. Do not let the cord hang over the edge of the working surface or countertop.

This product is designed only for household use. It is not suitable for commercial or industrial use. Do not use outdoors. Do not use outdoors, near a gas or electric hob, in heated ovens or near open flames.

Do not move the appliance when it is on or when it contains hot liquids.

Before connecting or disconnecting the cord from the power supply, make sure all the buttons and controllers are off.

Do not remove the appliance's bottom cover in order to avoid risk of fire or electric shock. Do not try to repair the device by yourself. Contact the official Technical Support Service of Cecotec for advice.

Use bottled water for best results. Do not use warm water or other liquids, these may cause product damage.

Do not open the filter basket or lift or remove the tank cover during operation to avoid risk of scalding.

The appliance is not intended to be used by children under the age of 8. It can be used by children over the age of 8, as long as they are given continuous supervision.

This appliance can be used by children aged 8 and above, and persons with reduced physical, sensory or mental capabilities or lack of experience and knowledge, as long as they have been given supervision or instruction concerning the use of the appliance in a safe way and understand the hazards involved. Supervise children, they shall not play with the appliance. Close supervision is necessary when the appliance is being used by or near children.

Note: A short power-supply cord is provided to reduce the risks of becoming entangled in or tripping over a longer cord. Extension cords are available and may be used if care is exercised in their use.

Glass jar's safety instructions

The glass jar is designed to be used only with this product. Do not use it in any other drip-type coffee maker or in a microwave oven.

Do not stir inside the jar with a spoon or other utensils.

Do not use a cracked glass jar or a jar having a loose or weakened handle. If the glass is cracked, do not drink from it.

Never use ice cubes inside the jar or place it inside the refrigerator

Never drink directly from the jar.

Do not tilt or overturn the jar to avoid liquids from flowing out.

When carrying the jar, always use the handle.

Do not leave the glass jar empty on the warming plate to avoid it from cracking.

WARNING: This product has undergone a quality control previous to its commercialisation with the aim of ensuring its correct operating. After the quality control testing, the appliance is cleaned thoroughly, therefore, although it is unlikely to occur, there could be rests of water or coffee drops inside it.

ІНСТРУКЦІЯ З ТЕХНІКИ БЕЗПЕКИ

Уважно прочитайте цю інструкцію перед використанням пристрою. Збережіть цю інструкцію для використання в майбутньому або для нових користувачів.

При використанні пристрою необхідно строго дотримуватися всіх інструкцій з техніки безпеки. Не використовуйте прилад не за призначенням.

Температура доступних поверхонь може бути високою під час використання і може викликати опіки. Не торкайтеся до гарячих поверхонь під час або ж відразу після використання.



Не занурюйте шнур, вилку або будь-яку незнімну частину приладу в воду або будь-яку іншу рідину, а також не піддавайте впливу води електричні з'єднання пристрою. Переконайтеся, що ваші руки сухі, перш ніж брати в руки електровилки або включати прилад.

Вимикайте і відключайте пристрій від електромережі, коли він не використовується і перед його очисткою. Тягніть за вилку, а не за кабель для від'єднання пристрою від розетки. Регулярно перевіряйте шнур живлення на наявність видимих пошкоджень. Якщо шнур пошкоджений, його необхідно замінити в уповноваженому центрі Cecotec. Не використовуйте будь-які аксесуари, що не були рекомендовані компанією Cecotec, оскільки вони можуть стати причиною травм або пошкоджень.

Не перекручуйте, не згинайте, не напружуйте і не пошкоджуйте шнур живлення будь-яким чином. Бережіть його від гострих країв і джерел тепла. Не дозволяйте йому торкатися гарячих поверхонь. Не дозволяйте шнуру звисати з краю робочої поверхні або стільниці.

1. PARTS AND COMPONENTS

Fig.1

1. Top cover
2. Filter
3. Funnel
4. Heating plate
5. Power button
6. Jar lid
7. Jar
8. Jar handle

2. BEFORE USE

Take the product out of the box and remove all packaging materials.

Make sure all parts and components are included and in good conditions. If any visible signs of damage are observed, contact the Technical Support Service immediately.

Place the appliance on a flat, stable surface.

Make sure the device is turned off and plug it to a power supply.

Pour water into the tank up to the Max. mark, dispense water several times without coffee and empty the remaining water.

Clean all the detachable parts of the machine with lukewarm water.

3. OPERATION

Open the top cover and fill the water tank with water. The water level should not exceed the Max. level marked inside the tank.

Place the funnel inside the water tank and make sure it is properly assembled.

Then, introduce the filter.

Add coffee powder to the filter and close the cover.

Note: A normal cup of coffee requires 1 ground coffee spoon. Try this quantity and then adjust it to your taste.

Place the jar on the heating plate.

Plug the power cord into the outlet.

Press the power button for the machine to start operating, the red indicator will light up.

Note:

The machine will brew coffee with all the water in the tank. 40 minutes after it has finished, it will automatically turn off.

The brewing process can be stopped at any moment by pressing the power button. The light indicator will turn off at the same time.

The amount of coffee obtained will be less than the water poured, as some of the water will remain absorbed by the coffee grounds.

Warning: Once the machine has been stopped, wait 2 minutes until all water drips have been dispensed before removing the jar. Remove the jar holding it by the handle. Be careful not to burn yourself!

4. CLEANING AND MAINTENANCE

Turn the appliance off, unplug it from the power supply and allow it to cool down before cleaning or repairing it.

Clean all the detachable parts of the machine with lukewarm water and soap after each use.

Use a soft, damp cloth to clean the device's surface.

Do not use abrasive cleaners or scouring pads as they could cause damage to the product's surface.

On the cover's inside part, water droplets may build up due to condensation during operation. Dry and clean this area with a soft, dry cloth after every use.

Descaling

Calc build-up frequently occurs in drip coffee makers. This build-up is normal and is caused by minerals commonly found in drinking water. Periodically, your coffee maker will need cleaning to remove scale or mineral deposits that may form.

Fill the tank with water (4/5) and descaling product or vinegar (1/5) to the MAX mark.

Place the jar on the heating plate. Make sure it is properly placed by aligning the jar's centre with the brewing outlet.

Press the power button once, the light indicator will turn on red. After a few seconds, water will be automatically dispensed.

Once the machine has dispensed about 1 cup of water, turn the machine off.

Allow the solution to take effect for 15 minutes and repeat steps 3-5 again.

Turn the appliance on by pressing the power button and allow the water tank to empty.

Operate the appliance with water at least 3 times to rinse it.

5. TIPS

Keep the coffee maker always clean. In order to obtain high-quality coffee with good flavour, the coffee maker must be clean.

Recommendation: It is recommended to use bottled water when using the appliance.

Store ground coffee in a cool, dry place. After opening a package of ground coffee, reseal it tightly and store it in a refrigerator to maintain its freshness.

For a full-bodied flavour coffee, use whole coffee beans and grind them just before use.

Do not reuse ground coffee.

Do not reheat coffee. Coffee reaches its best fragrance and flavour just after being freshly brewed.

Some coffee oil or fat could build up due to ground coffee extraction. This could happen frequently when using strongly roasted coffee.

6. TECHNICAL SPECIFICATIONS

Model: Coffee 66 Heat

Product reference: 01554

950W, 220-240V~, 50/60Hz

Made in China | Designed in Spain

7. DISPOSAL OF OLD ELECTRICAL APPLIANCES



The European directive 2012/19/EU on Waste Electrical and Electronic Equipment (WEEE), specifies that old household electrical appliances must not be disposed of with the normal unsorted municipal waste. Old appliances must be collected separately, in order to optimize the recovery and recycling of the materials they contain, and reduce the impact on human health and the environment.

The crossed out "wheeled bin" symbol on the product reminds you of your obligation to dispose of the appliance correctly.

Consumers must contact their local authorities or retailer for information concerning the correct disposal of old appliances and/or their batteries.

8. TECHNICAL SUPPORT AND WARRANTY

This product is under warranty for 2 years from the date of purchase, as long as the proof of purchase is submitted, the product is in perfect physical condition, and it has been given proper use, as explained in this instruction manual.

The warranty will not cover the following situations:

The product has been used for purposes other than those intended for it, misused, beaten, exposed to moisture, immersed in liquid or corrosive substances, as well as any other fault attributable to the customer.

The product has been disassembled, modified, or repaired by persons, not authorised by the official Technical Support Service of Cecotec.

Faults deriving from the normal wear and tear of its parts, due to use.

The warranty service covers every manufacturing defects of your appliance for 2 years, based

on current legislation, except consumable parts. In the event of misuse, the warranty will not apply.

If at any moment you detect any problem with your product or have any doubt, do not hesitate to contact Cecotec Technical Support Service at +34 963 210 728.

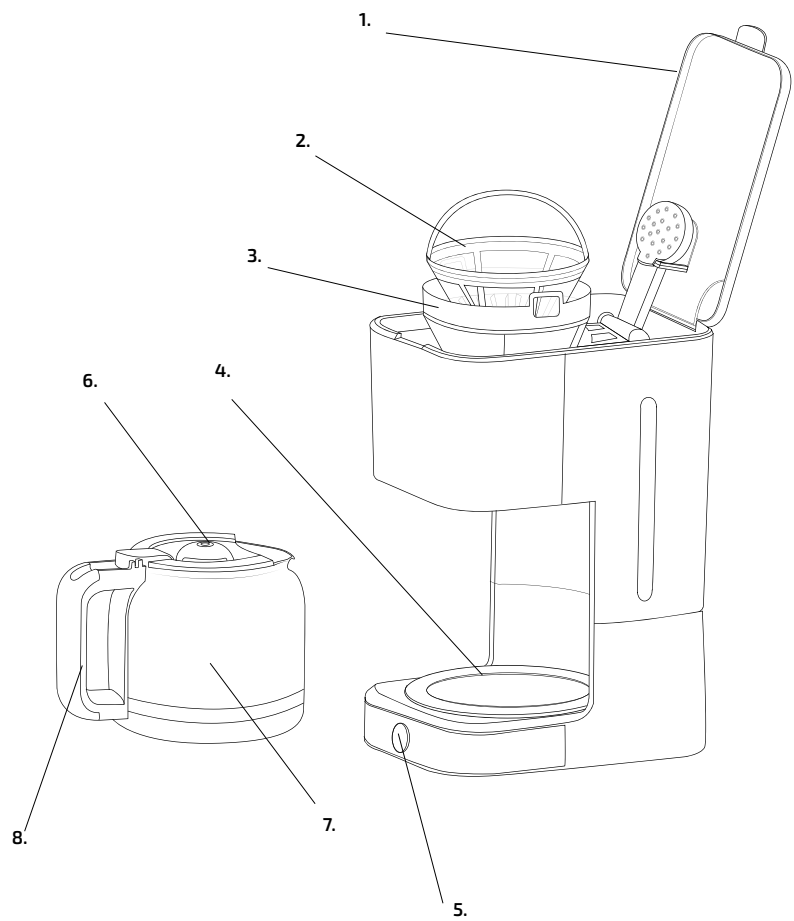

Рис. 1

www.cecotec.es

Grupo Cecotec Innovaciones S.L.
C/ de la Pinadeta s/n, 46930
Quart de Poblet, Valencia (Spain)
YV02200225