

Midea

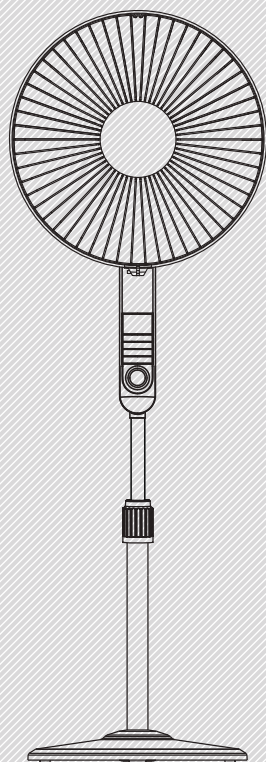

دليل المستخدم

مروحة عمودية 16"

موديل : FS40-15FR



يرجي قراءة و حفظ دليل المستخدم

ملاحظة: الصور الموجودة في الدليل تستعمل كمرجع فقط.

Made in China

Midea

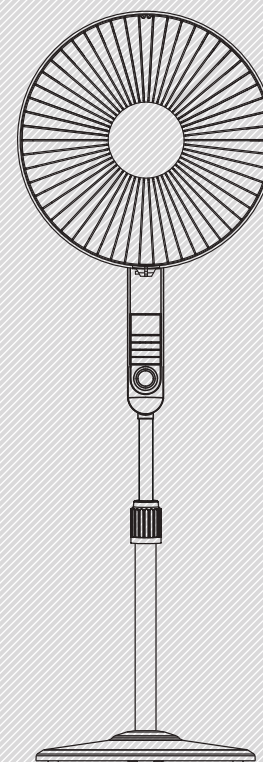

OWNER'S MANUAL

16" Stand Fan

MODEL:FS40-15FR



READ AND SAVE THESE INSTRUCTIONS

Attention: Pictures in the IM are for reference only.

Made in China

CAUTION

Read Rules for Safe Operation and Instructions Carefully.

WARNING

1. If the supply cord is damaged, it must be replaced by manufacturer or its service agent or a similarly qualified person in order to avoid a hazard.
2. Indoor use only.
3. To protect against the risk of electrical shock, do not immerse the unit, cord or plug in water or other liquid.
4. This appliance is not intended for use by persons (including children) with reduced physical, sensory or mental capabilities, or lack of experience and knowledge, unless they have been given supervision or instruction concerning use of the appliance by a person responsible for their safety.
Young children should be supervised to ensure that they do not play with the appliance.
5. When the appliance is not in use and before cleaning, unplug the appliance from the outlet.
6. When the fan was assembled, the rotor blade guard shall not be taken off anymore.
7.  Correct Disposal of this product
This marking indicates that this product should not be disposed with other household wastes throughout the EU. To prevent possible harm to the environment or human health from uncontrolled waste disposal, recycle it responsibly to promote the sustainable reuse of material resources. To return your used device, please use the return and collection systems or contact the retailer where the product was purchased. They can take this product for environmental safe recycling.

RULES FOR SAFE OPERATION

1. Never insert fingers, pencils, or any other object through the grille when fan is running.
2. Disconnect fan when moving from one location to another.
3. Be sure fan is on a stable surface when operating to avoid overturning.
4. DO NOT use fan in window, rain may create electrical hazard.
5. Household use only.

INSTALLATION INSTRUCTIONS

■ Name of components

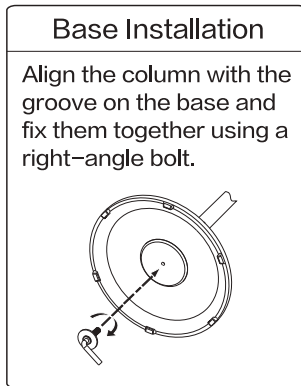

Considerate Hint:
Remove ①② parts from the component before performing installation.

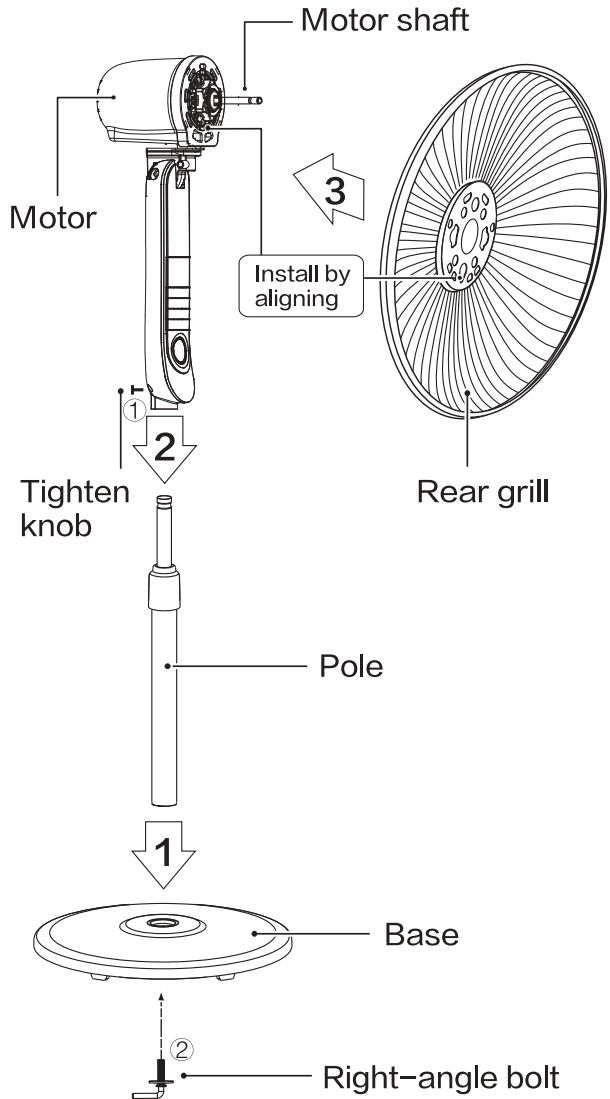

Front and Rear Guard Installation

Align Catch of the Front Guard with the illustrated position of the Rear Guard.

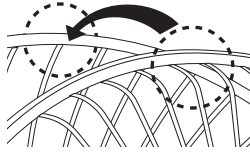

Press Guards sequentially with both hands.

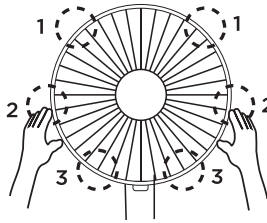

Self-Catch Installation.

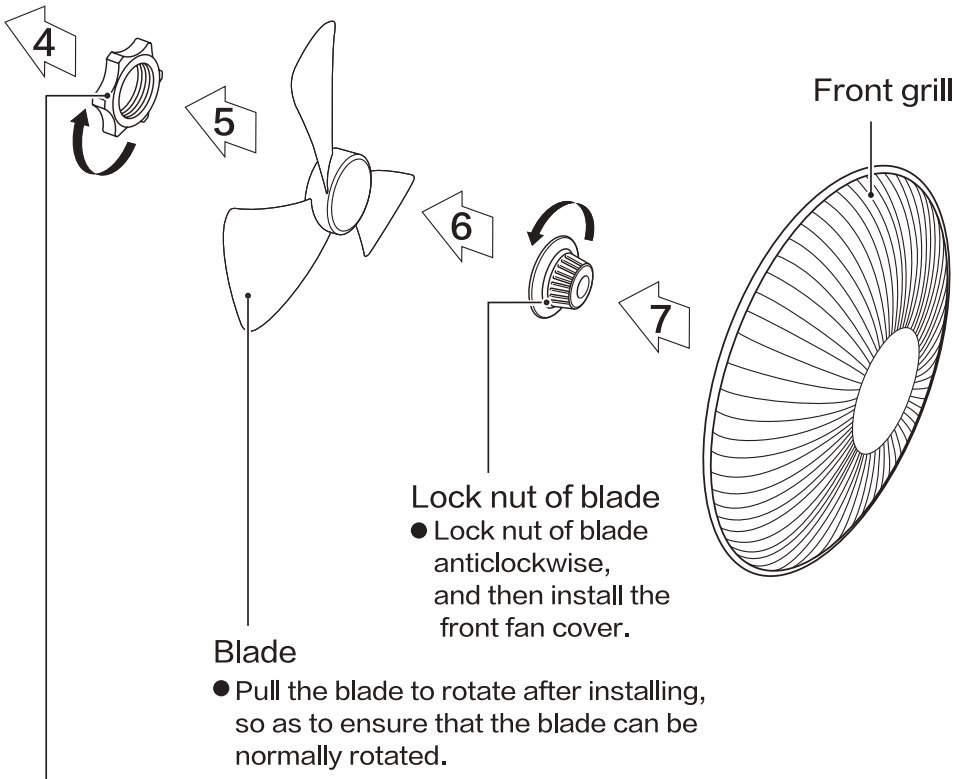
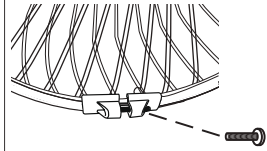

Lock nut of grill

- Screw the lock nut of grill clockwise, and in the meantime, fix the rear grill.

INSTRUCTIONS FOR USE

■ Instructions for key of remote controller

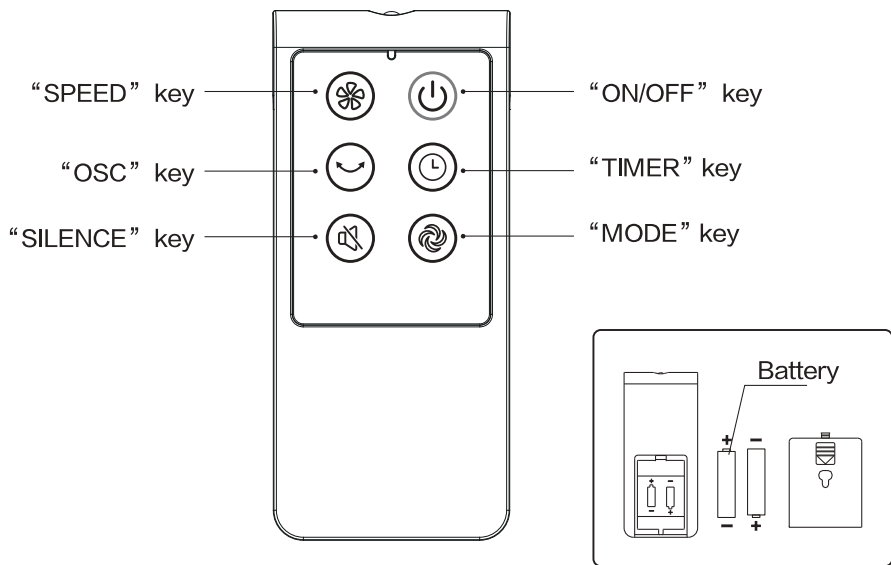

Considerate Hint:
Effective Range of Remote Control: within 5 m distance and 30-degree deflection in front of Product.

■ Instructions for display of body

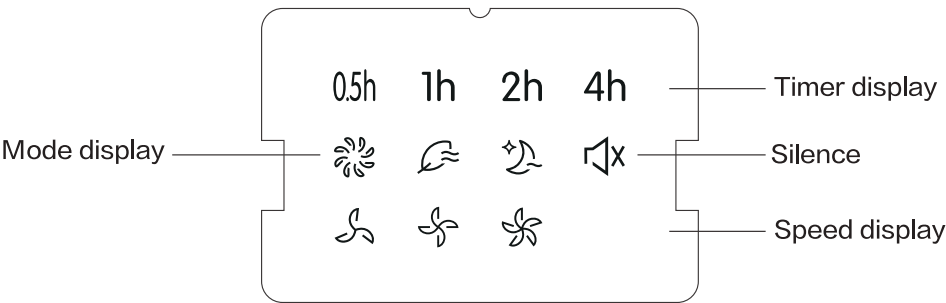

INSTRUCTIONS FOR USE

■ Instructions for operation of body

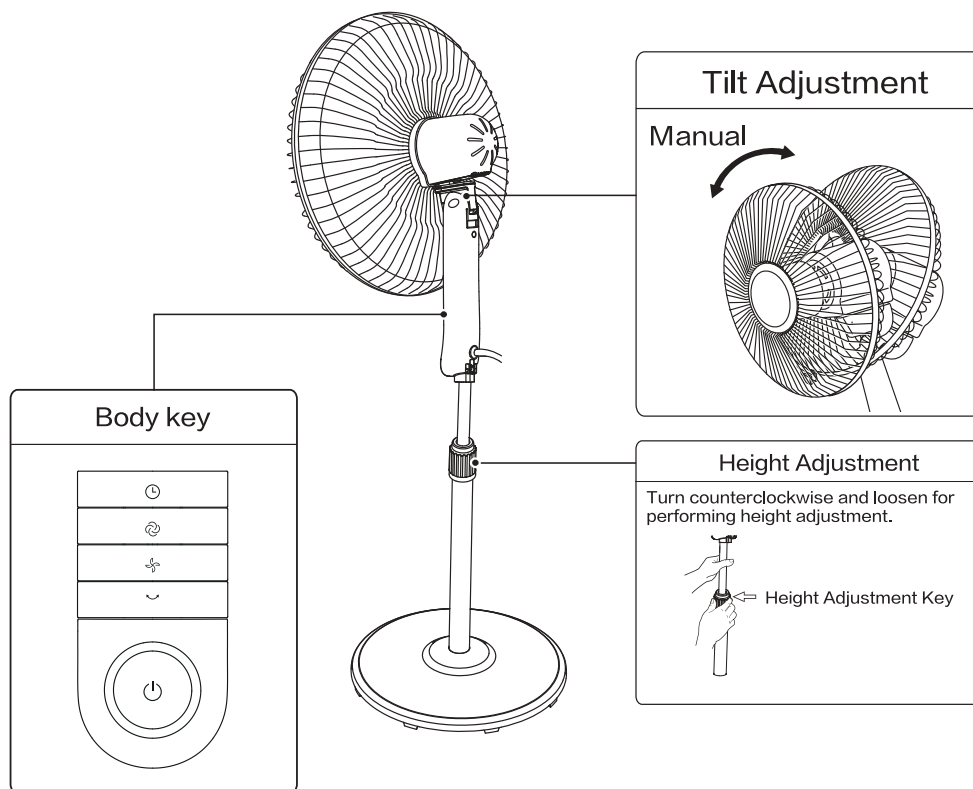

MAINTENANCE INSTRUCTION

The fan requires little maintenance. Do not try to fix it by yourself. Refer it to qualified service personnel if service is needed.

1. Before cleaning and assembling, fan must be unplugged.
2. To ensure adequate air circulation to the motor, keep vents at the rear of the motor free of dust. Do not disassemble the fan to remove dust.
3. Please wipe the exterior parts with a soft cloth soaking a mild detergent.
4. Do not use any abrasive detergent or solvents to avoid scratching the surface.
Do not use any of the following as a cleaner: gasoline, thinner.
5. Do not allow water or any other liquid into the motor housing or interior parts.

CLEANING

1. Be sure to unplug from the electrical supply source before cleaning.
2. Plastic parts should be cleaned with a soft cloth moisten with mild soap.
Thoroughly remove soap film with dry cloth.