

The diagram above is just for reference. Please take the appearance of the actual product as the standard.

WATER PURIFIER

Instruction Manual

Model: MRO1686B-50G

Before installing and operating your water purifier, please read the instruction manual carefully and keep it for future reference.

1. PRECAUTION

1-1. Intruction

This section records the important content of security concerns to avoid the damage to the consumers and even cause property loss. Please read the text based on fully understanding of the marks and icon, and observe all the security concerns.

⚠ Warning: the water purifier might be damaged seriously or causes the death of user when the operation is incorrect, and it may cause electrical hazards or fire hazards.



If the flexible wire is damaged, to avoid hazard, it must be replaced by professional from after-sale service of manufacturer. To avoid fold and power cord damage. Replaced by professional from after-sale service of manufacturer. To avoid fold and power cord damage.



Store the unit far away from strong sunlight which is easy to age the components. Avoid to store or expose the unit under 0°C environment.



The best working pressure of the unit is 0.1-0.4Mpa, please install the supercharging device and relief device when the actual pressure is lower or higher than the best one.



Plug out the unit immediately and cut off the water resource, contact the local service or call the National service hotline.



The unit shall be installed or removed by professional. It's easy to damage the inner parts or cause electric shock hazard if the unit is disassembled by the consumers themselves. It's easy to cause unit damage if it's removed with wrong.

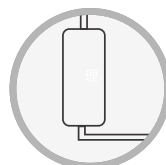

When the inlet water quality (dust and residual chlorine) cant meet the tap water standard, one pretreatment device should be installed before the unit. tap water standard, one pretreatment device should be installed before the unit.

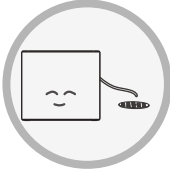

Install the unit as close as possible to the floor drain

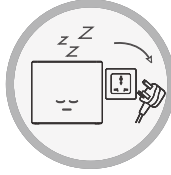

Please turn off the power and 3-way ball valve if the unit will be long-term unused. Dispense water for 3 to 5 mins and then reuse it.

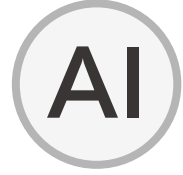

The unit equipped with full-auto water producing system, it starts to producing water or flush automatically when the unit is not used for a long time. This phenomenon is normal

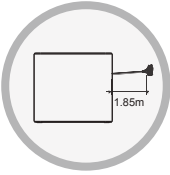

There should be one 110-240V power outlet for the unit within the scope of 1.85m, And make sure power outlet and adapter locate in the interior to prevent humid weather.



Please don't turn off the power or plug out the power cord frequently.



It's normal that there will be slight noise and vibration when the unit is producing water.



The flow rate will be reduced when the environmental temp gets lower. This is the inherent feature of RO membrane.



The unit may catch fire or be damaged, and cause circuit failure when it is installed close to strong magnetic device.



The place with too much dust and humidity may cause circuit damage.

⚠ Security notice: the operator may get injured when the operation is wrong.



Don't place heavy object on the unit.

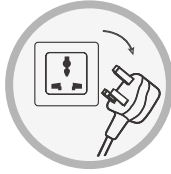

Plug out the unit and turn off the 3-way ball valve when there's no water or the pipes are in maintenance. Open the other faucets and drain the dust, and then 3-way ball valve when the water supply recovers, or the dust may block the filter.



Please don't let the children operate, touch, climb and get close to the unit. Children and intellectual disabilities should operate it with guardian.



Don't use boosting transformer to connect the plug.



Don't pull power cord directly to prevent fracture.



Please make sure the plug is clean and never plug in and out the plug with wet hand.



Store the unit far away from flammable and volatile substance.



Store the unit far away from heat source and open flames.

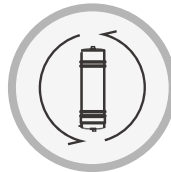

Clean the unit and change the filter regularly.

1-2.Packing list

Packing box	Water Purifier(1set)	Power adapter(1pc)	Faucet(1pc)
	1/4" PE pipe(5m)	User manual(1pc)	Quick Fitting(1pc)
Materials bag	Water storage tank(1pc)		

2.YOUR DIRECT DRINKING WATER PURIFIER

2-1.Part name of water purifier

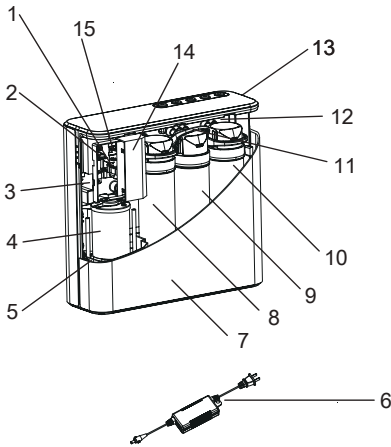

- 1.wash valve
- 2.inlet valve
- 3.electric appliance box
- 4.pump
5. cover plate of pump
- 6.power adapter
- 7.front panel
- 8.RO filter
- 9.PAC filter
10. post carbon filter
- 11.holder for filter
- 12.water flow system
- 13.back panel
- 14.electric appliance box's cover
- 15.hign pressure switch

Note: Please use the product in a place with temperature of 4-38°C and relative humidity less than 90%.

*** To enhance product performance, product parts may be changed without notice. The object shall prevail.**

2-2. Water processing graph

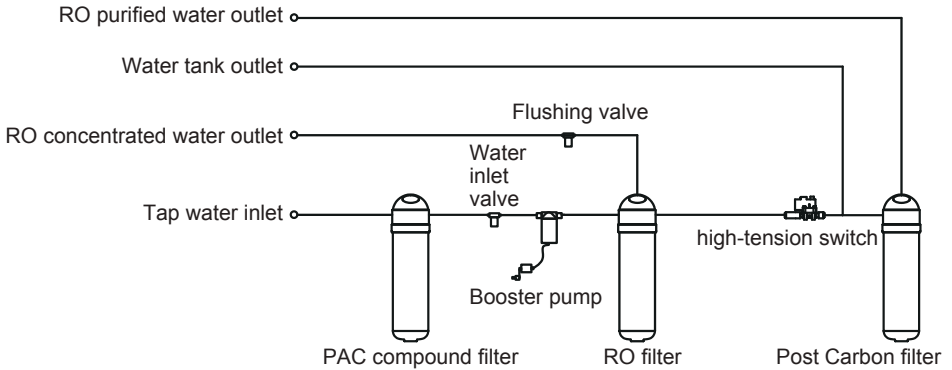

2-3. Electrical schematic

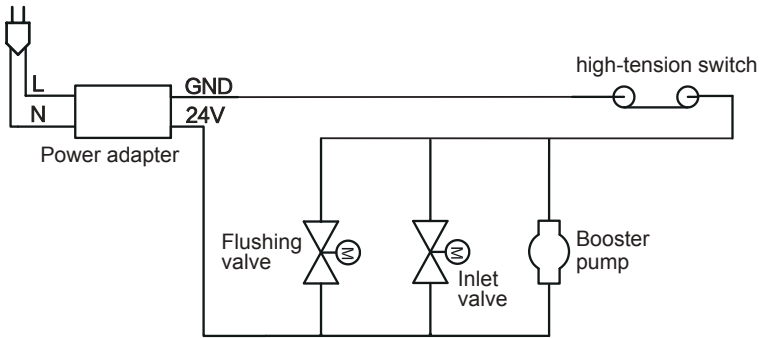

2-4. How to use

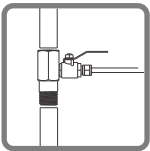

Connect the water resource and open the water inlet valve, connect to the tap water.

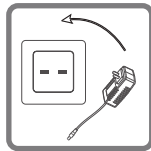

Starting up: Plug in the unit.



Water dispensing: Close the water tank valve and open the faucet for the first usage or after the postposition carbon filter is replaced, there will be a little bit black water which is normal. Keep the unit running for 5-10mins until the water is clear and without odor. Open the water tank valve and producing water normally.

Remark: the unit will flush automatically producing water every time

3. USE GUIDE AND MAINTENANCE

3-1. Trouble shooting

Issues	Reason	Trouble shooting
No flow or low flow	1. Filter blocks 2. The filter lifetime is expired.	Plug out the unit and close the water resource, please contact local distribution and service office.
Producing water exceeds 8 hs. No halt	1. The control part is damaged 2. No water in the line.	1. Plug out the unit and close the water resource, please contact local distribution and service office. 2. check the tap water.

3-2. Clean and maintenance

- To ensure the water quality, The unit will be maintained by the professional regularly and the filter material will be changed at the same time.
- Please don't use soap, detergent, diluent, petrol and alcohol, it may cause crack, scratches and color change.
- Please don't clean the unit with splashing water on it directly.

3-3. Fixing guide

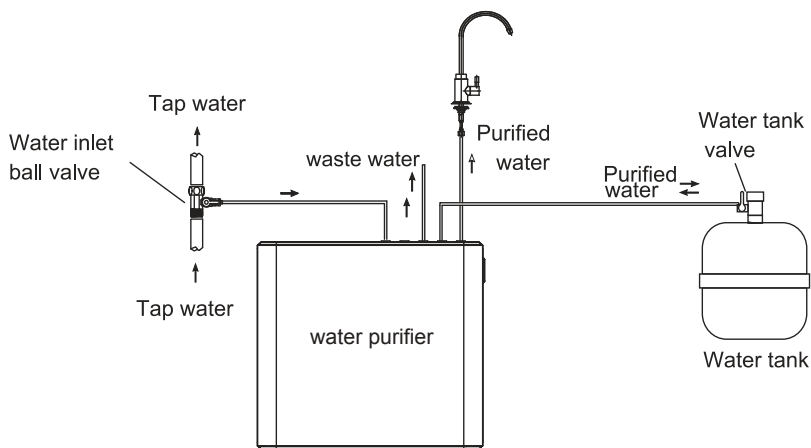

Remarks: The unit should always be standing(the top cover should always turn upwards), the unit cant be placed horizontally or tilt to one direction

3-4. Filter introduce

Model	Function
PAC compound filter	Filter the dust, rust , suspended matter, residual chlorine and odor effectively.
RO filter	The theoretical filter precision can reach 0.0001-0.001 micron which can filter the organicmatter (trichloromethane, carbon tetrachloride), heavy metal (AS,lead and cadmium).
Post Carbon filter	Improve the water taste and absorb the abnormal color and odor in the water.

Special tips:

- 1.The filter maintenance period is not the same as quality guarantee period, the original water should meet the national standard and based on the normal domestic filter maintenance period.
- 2.The filter maintenance period is estimated which varies from places, water quality, usage amount and seasons. The filter should be replaced regularly.

3-5. Filter change guide

1. When the filter lifetime is expired and the filter should be changed in time. Close the inlet ball valve, turn o ffthe power and close the tank ball valve.

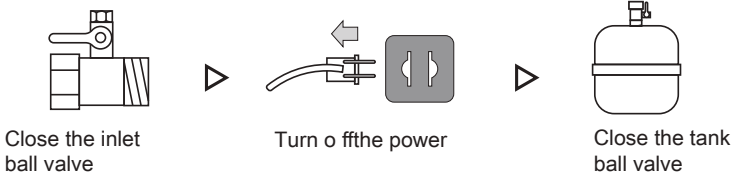

- 2.Take out the filter by the filter handle, inset the bottom part of filter into the groove and push forward until it clicks the filter receptacle well.

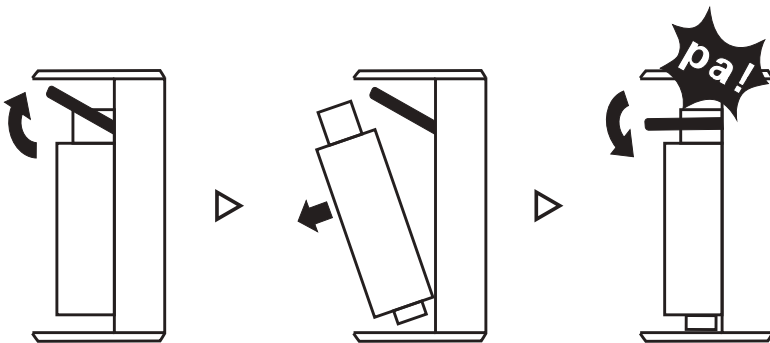

3. When the filter replacement is finished. follow the “HOW TO USE”step to operate.

4. TECHNICAL PARAMETERS

4-1. Basic parameter

MODEL	MRO1686B-50G
rate voltage	110-240V~
rate power	30W
clean water flow rate	0.13L/min
inlet pressuer	30 - 60 PSI
pressure before RO filter	60- 115 PSI
require of the inlet water	tap water TDS≤350ppm
total clean water	2000L
Inlet water pressure	0.1-0.4MPa
applicable water temperature	5-38°C

The product is subject to change without notice.
Please keep this manual properly.

**Foshan Midea Chunggho Water purification
Equipment Co., Ltd**

No.68 GuangLe Road, BEIJIAO, SHUNDE, FOSHAN,
GUANGDONG, R.P.CHINA