



MULTI-SPRAYER SYSTEMS™

The World's Greatest Sprayers



IDEAL FOR:

- Carpet & upholstery pre and after sprays
- Ceiling cleaning
- Janitorial sprays
- Carpet restoration applications
- Automotive detailing
- Wallpaper removal
- Car cleaning

ALSO SPRAYS:

Disinfectants, deodorizers, traffic lane cleaners, spotting agents, insecticides, garden agents & fertilizers, cleans ducts, ovens & siding

SC MODELS OWNERS MANUAL WITH CART

3.5 HOURS CORDLESS SPRAYER — CHARGES IN OUTLET

SC1

SC2

FOR PARTS & SERVICE CALL

MULTI-SPRAYER.COM

Thank you for purchasing the world's greatest sprayer.

The Multi-Sprayer SC Series unit will replace your pump-up sprayers. The SC Multi-Sprayer is a tough, compact and versatile cordless sprayer, equipped with a SOLVENT COMPATIBLE VITON PUMP.

The "SC" was designed to be easily transported to the job taking up limited space. After spraying, the "SC" can be charged in a wall outlet that will allow continuous running time of 3-1/2 hours.

Model SC1 and SC2 Multi-Sprayer

CHARGING BATTERY

1. Switch must be set to "0" Off — top of switch pushed down.
2. Read enclosed Schumacher Charger instructions.
3. Red Wire and battery post are positive (+). Black wire and battery post are negative (-).

DO NOT RUN BATTERY ALL THE WAY DOWN. CHARGER MAY NOT BE ABLE TO RECHARGE A DEAD BATTERY. FREQUENT CHARGING IS BEST. CHARGING OVERNIGHT AFTER USE IS A GOOD IDEA. IF BATTERY WILL NOT TAKE A CHARGE, USE 6 TO 10 AMP HOUR CHARGER FOR 5 MINUTES TO "BOOST" BATTERY.

The charger is a "Smart Charger" and will not overcharge the battery if left plugged in. It is good to plug the charger in each night. Never leave the SC less than fully charged when not used for long periods. Max run time per charge is 3.5 hours when battery is new. Lead acid batteries always like to be fully charged for longest life.

GETTING STARTED

Slant your 2 gallon container of solution into the multi-sprayer cap to the right. Connect the male/female cap quick connect system, and then push the container into the multi-sprayer. To remove container, push the silver tab on the female quick connect tip out of container and remove.

Turn on switch and squeeze trigger to spray.

IF YOU HAVE MODEL SC2

PRIMING

1. Remove the 2 foot carpet wand or the upholstery tip, at the quick connect.
2. Squeeze the trigger, allowing the liquid to advance to near the trigger.
3. Re-connect the 2 foot carpet wand or upholstery tip and begin spraying. The check valve/strainers inhibit flow when starting but stop drips after spraying.

MAINTENANCE

At the end of the work period, a mild detergent solution followed by fresh water should be sprayed to clean the pump and hose.

When switching between water based and solvent solutions, a warm water flush after water base and a cold water flush after solvents is best for flushing the system.

The case cleans easily with a mild detergent and retains its luster with application of a plastic/vinyl product.

WARRANTY

Your multi-sprayer SC units carry a one year parts and labor warranty. The date of manufacture is stamped on the serial plate. Keep your receipt for exact date of ownership for warranty purposes.

FREEZING CAN DAMAGE THE MULTI-SPRAYER AND IS NOT COVERED BY THE WARRANTY.

Consult the chemical guide available from your distributor or manufacturer for chemical compatibility. Chemical damage to the pump is not covered by the warranty.

SAFETY PROCEDURES

RISK OF EXPLOSION — DO NOT SPRAY COMBUSTIBLE FLUIDS

PLUG INTO 115-120 VOLT 50/60 CYCLE GROUNDED 3-PRONG RECEPTACLE

MULTI-SPRAYER PARTS

KEY	PART#	DESCRIPTION
5*	BST-1YSS	SS Female Coupler, 1/8"
6	6590	Brass/Viton Trigger
7	H14-2MUSBR	Compression and Strain Relief
8	FW-10	Urethane Coiled Spray Hose 10" 1/4 ID
9	SNP-2	Hose Clamp (Need 2)
11	N4MEB6	Elbow, Nylon (Need 2)
12	AQ12	12Volt, 50 psi Motor & Pump
14*	216P-4-2	Brass Reducing Nipple, 1/4" / 1/8"
15	11375	Rubber Hose Grommet
NS	11532	Rubber Shoulder Grommet
16	6.5SS	Base Plate Retaining Rods (2 Needed)
17	160011E	Electric On/Off Switch
18	UR33	Urethane Suction Hose, 33", 1/4 ID
19	13862-50	Suction Hose Strainer, 50 mesh
21	B252	Battery, 12 Volt, 9 Amp Hour
22	2G	2 Gallon Solution Container
23	F17004LG	Female Jug QC
24	M22004LG	Male Jug QC, Cap and 90 Degree Barb
25	UR12.5	Urethane Dip Tube, 12.5" 1/4 ID
26	2000-277-43	2 Wheel Cart
NS	MINF10	10 Amp Mini Fuse, burns out if pump is bad
NS	Battery Bolts	Vertical Bolts, 2 @ 4.75" & 2 @ 4.25" (Back)
NS	1.5 Amp - 12V	Charger Mounted on Back

*#5 and #14 on SC2 model only

PUMP PARTS

AQ12	12 Volt Pump Parts
LHA	Lower Head Assembly, Triangular Diaphragm/CAM
VHA	Valve Assembly, 3 Inlet and 2 Outlet Valves
UHA-12	Black Poly Pump Head

- If pump leaks from small triangle on black pump head, replace UHA
- If pump runs but does not pump, replace VHA and LHA
- When reassembling pump, tighten screws very firmly

MULTI-SPRAYER DIAGRAM

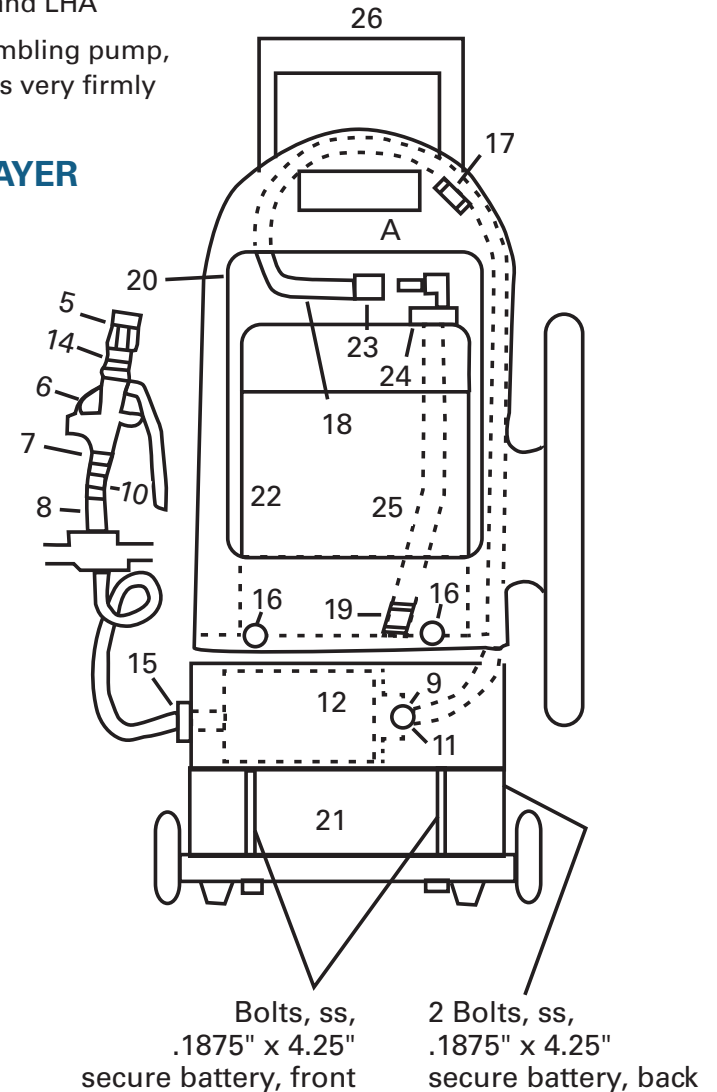

SC1 WAND

KEY	PART#	DESCRIPTION
1	H1/8DT-SS8004	Female Thread Stainless Steel V-Jet Nozzle
2	SS20	Threaded Stainless Steel Wand Tube
3	AB 110CA	Brass Hex Nipple, 1/4 Male 1/8 Female

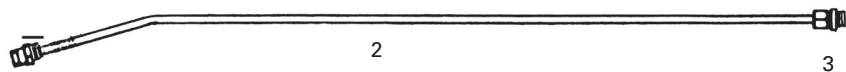

8004WAND — Complete M1 Wand, Parts 1, 2, 3

SC2 WAC WAND

KEY	PART#	DESCRIPTION
1A	TPU8004SS	Stainless Steel t-Jet Nozzle
2	CP1325	Brass Nozzle Cap
2A	CP1335	Brass Male Body
24	4193-A-10-50SS	Strainer W/Check Valve (inside 2A)
3	SS20	Stainless Steel Wand Tube
25	BST-N1SS	Stainless Steel Male Coupler

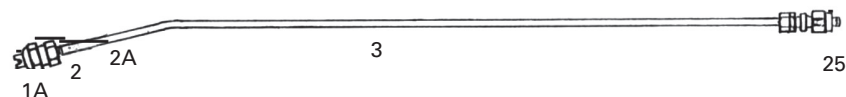

WAC — Complete SC2 Carpet Wand

SC2 WACS WAND

KEY	PART#	DESCRIPTION
2	CP1325	Brass Nozzle Cap
1B	TPU50015	Brass T-Jet Nozzle
26	4193-A-20-50SS	Strainer W/Check Valve
2B	CP1336	Brass Male Bod
27	BST-N1	Brass Male Coupler

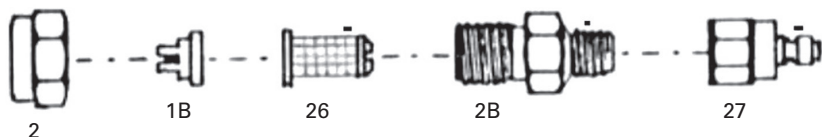

WACS (Exploded) — Complete SC2 Upholstery Wand

TO REMOVE PUMP

1. Remove the threaded rods, "A" by taking the nut off the end of each rod and slide the threaded rods out.
2. The pump is attached with steel bolts to the blue base plate. Hook the edge of the blue base plate "B" near the battery with a bent tool and pull up the base plate with pump attached. Do not remove bolts, the pump will fall into the bottom of the sprayer.

TO CHANGE BATTERY

1. Remove the wire leads from the back of the battery.
2. Hold the threaded 3/16" stainless steel bolt on the front side of the battery with a vice grip and remove the stainless steel nut on the bottom.
3. Slide the bolt up through the front nylon bar of the tray on which the battery sits. **(DO NOT SLIDE THE BOLT ALL THE WAY UP INTO THE MULTI-SPRAYER HOUSING — IF YOU DO, YOU WILL HAVE TO REMOVE THE PUMP TO REPLACE AFTER YOU PUT IN A NEW BATTERY)**. Temporarily put the nut back on the bolt so when you slide the the bolt up, it cannot go through the hole into the housing.
4. Hold the threaded 3/16" stainless steel bolts on each side of the back of the battery with a vice grip and just loosen the nut about 4 – 5 turns.
5. The battery should now just slide out the front.
6. Replace with new battery.
7. Slide the front bolt down through the bar and tighten nut just a little more than snug. (Hold stainless steel bolt with vice grip).
8. Tighten side bolt nuts just a little more than snug.

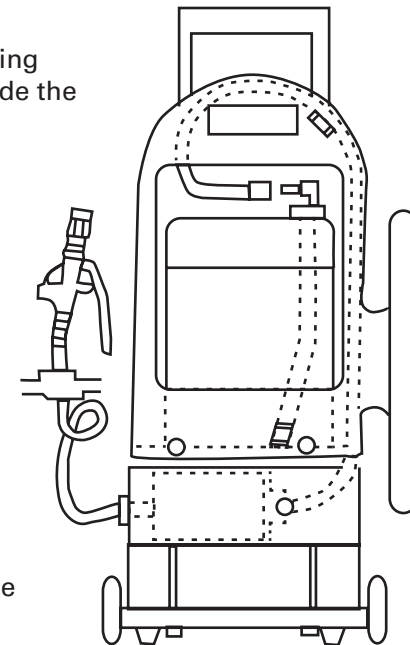

APPROXIMATE RATE OF SPRAY

FROM T-JETS & V-JETS USING 50 PSI PUMP:

TIP SIZE	GAL per MIN	TIP SIZE	GAL per MIN
XX050	.055	XX04	.44
XX01	.11	XX05	.55
XX015	.16	XX06	.66
XX02	.22	XX08	.88
XX03	.33	XX10	1.10

TROUBLE SHOOTING

MOTOR OPERATES, BUT NO SPRAY:

- Male and/or female QC on jug failure
- If you have SC2 model, see “Getting Started” instructions on page 3 and on back of sprayer
- Restricted intake or discharge line. Clogged suction strainer, kinked suction or spray hose, clogged spray tip, broken or clogged trigger
- Air leak in suction hose
- Broken or worn pump parts; valve chamber, or diaphragm

MOTOR FAILS TO RUN:

- Switch defective or loose wiring connection
- Defective motor
- Frozen cam bearing

LOW FLOW AND PRESSURE:

- Partially clogged lines, strainers, tip or trigger
- Worn pump cam bearing (also excessive noise)
- Broken or worn pump parts; valve chamber or diaphragm
- Insufficient voltage

LEAKING:

- Hole in hose, cracked pump housing
- Loose or broken hose barb at pump inlet or outlet
- Loose or broken hose clamp at pump inlet or outlet

MULTI-SPRAYER SYSTEMS, INC.