



User Manual

WORKZONE®

10366

45W STAPLE / NAIL GUN



Product
Info



+ VIDEO



Read all safety warnings and all instructions thoroughly before operating this product.
Ensure you keep your manual in a safe place for future reference.

IM ed2; 07/2019

<https://help.tools/>

QR codes take you where you want to go quicky and easily

Whether you require product information, spare parts or accessories, details on warranties or aftersales service, or if you want to watch a product demonstration video, our QR codes will take you there in no time at all.

What is a QR code?

A QR-code (QR=Quick Response) is a type of matrix that can be read with a smartphone camera and that contains a link to a website or contact details, for example.

Advantage: You are not required to manually enter a website address or contact details.

How it works

To scan the QR code, all you need is a smartphone with QR codes reader software and an Internet connection*. This type of software can be downloaded for free from your smartphone's app store.

Try it out now

Just scan the QR code with your smartphone and find out more about the Aldi product you have purchased*.



* Depending on your tariff you may be charged for the connection.

Contents

Pack contents / parts	04
Application	04
Contents of carton	04
Description of symbols	05
General safety warnings	06
Component list	11
Assembly	12
Operation	13
Maintenance	13
Warranty	14
What your 3 year warranty means	14
Service Support	14
Environmental protection	15
FAQ/Troubleshooting	15
Technical Specifications	16

Pack contents / parts

Application

First time users or inexperienced operators must pay particular attention to the operation of the 45W Staple / Nail Gun, including details of starting, stopping and the correct use of the 45W Staple / Nail Gun on page 13. Maintenance instructions are also detailed on page 13.

Intended use of 45W Staple / Nail Gun

NOTE: This product is for private domestic DIY use only. It is not suitable for commercial or trade use.

This 45W Staple / Nail Gun is used for tacking fabrics, leather, card board, foils, insulation material and other light weight materials to soft structural surfaces, such as wood or wood-like materials. The 45W Staple / Nail Gun is not suitable for fastening wall or ceiling panelling.

The 45W Staple / Nail Gun is to be used only for its prescribed purpose. Any other use is deemed to be a case of misuse.

Contents of carton

- 1 x 45W Staple / Nail Gun
- 400 x Staples (Г 10 mm)
- 100 x Nails (T 15 mm)
- 1 x Instruction Manual
- 1 x Warranty Card & Certificate

- Remove all packing materials
- Ensure all parts on the contents list are present
- Check the appliance, and all accessories for transportation damages

Description of symbols

The rating plate on your 45W Staple / Nail Gun may show symbols. These represent important information about the product or instructions on its use.



To reduce the risk of injury, user must read instruction manual



Wear ear protection
Wear eye protection
Wear breathing protection



Conforms to relevant standards for electrical safety and electromagnetic compatibility.



Double insulation



36 Month Warranty Period.

General safety warnings

General Power Tool Safety Warnings



WARNING Read all safety warnings and all instructions.

Failure to follow the warnings and instructions may result in electric shock, fire and/or serious injury.

Save all warnings and instructions for future reference.

The term “power tool” in the warnings refers to your mains-operated (corded) power tool or battery-operated (cordless) power tool.

1) Work area safety

- a) **Keep work area clean and well lit.** Cluttered or dark areas invite accidents.
- b) **Do not operate power tools in explosive atmospheres, such as in the presence of flammable liquids, gases or dust.** Power tools create sparks which may ignite the dust or fumes.
- c) **Keep children and bystanders away while operating a power tool.** Distractions can cause you to lose control.

2) Electrical safety

- a) **Power tool plugs must match the outlet. Never modify the plug in any way. Do not use any adapter plugs with earthed (grounded) power tools.** Unmodified plugs and matching outlets will reduce risk of electric shock.
- b) **Avoid body contact with earthed or grounded surfaces, such as pipes, radiators, ranges and refrigerators.** There is an increased risk of electric shock if your body is earthed or grounded.
- c) **Do not expose power tools to rain or wet conditions.** Water entering a power tool will increase the risk of electric shock.
- d) **Do not abuse the cord. Never use the cord for carrying, pulling or unplugging the power tool. Keep cord away from**

General safety warnings

heat, oil, sharp edges or moving parts. Damaged or entangled cords increase the risk of electric shock.

- e) **When operating a power tool outdoors, use an extension cord suitable for outdoor use.** Use of a cord suitable for outdoor use reduces the risk of electric shock.
- f) **If operating a power tool in a damp location is unavoidable, use a residual current device (RCD) protected supply.** Use of an RCD reduces the risk of electric shock.

3) Personal safety

- a) **Stay alert, watch what you are doing and use common sense when operating a power tool. Do not use a power tool while you are tired or under the influence of drugs, alcohol or medication.** A moment of inattention while operating power tools may result in serious personal injury.
- b) **Use personal protective equipment.** Always wear eye protection. Protective equipment such as dust mask, non-skid safety shoes, hard hat, or hearing protection used for appropriate conditions will reduce personal injuries.
- c) **Prevent unintentional starting. Ensure the switch is in the off-position before connecting to power source and/or battery pack, picking up or carrying the tool.** Carrying power tools with your finger on the switch or energising power tools that have the switch on invites accidents.
- d) **Remove any adjusting key or wrench before turning the power tool on.** A wrench or a key left attached to a rotating part of the power tool may result in personal injury.
- e) **Do not overreach. Keep proper footing and balance at all times.** This enables better control of the power tool in unexpected situations.

General safety warnings

- f) **Dress properly. Do not wear loose clothing or jewellery.** Keep your hair, clothing and gloves away from moving parts. **Loose clothes, jewellery or long hair can be caught in moving parts.**
 - g) **If devices are provided for the connection of dust extraction and collection facilities, ensure these are connected and properly used.** Use of these devices can reduce dust-related hazards.
- 4) **Power tool use and care**
- a) **Do not force the power tool. Use the correct power tool for your application.** The correct power tool will do the job better and safer at the rate for which it was designed.
 - b) **Do not use the power tool if the switch does not turn it on and off.** Any power tool that cannot be controlled with the switch is dangerous and must be repaired.
 - c) **Disconnect the plug from the power source and/or the battery pack from the power tool before making any adjustments, changing accessories, or storing power tools.** Such preventive safety measures reduce the risk of starting the power tool accidentally.
 - d) **Store idle power tools out of the reach of children and do not allow persons unfamiliar with the power tool or these instructions to operate the power tool.** Power tools are dangerous in the hands of untrained users.
 - e) **Maintain power tools. Check for misalignment or binding of moving parts, breakage of parts and any other condition that may affect the power tool's operation. If damaged, have the power tool repaired before use.** Many accidents are caused by poorly maintained power tools.
 - f) **Keep cutting tools sharp and clean.** Properly maintained cutting

General safety warnings

tools with sharp cutting edges are less likely to bind and are easier to control.

- g) Use the power tool, accessories and tool bits etc. in accordance with these instructions, taking into account the working conditions and the work to be performed.** Use of the power tool for operations different from those intended could result in a hazardous situation.

5) Service

- a) Have your power tool serviced by a qualified repair person using only identical replacement parts.** This will ensure that the safety of the power tool is maintained.

Tacker safety warnings

- 1. Always assume that the tool contains fasteners.** Careless handling of the tacker can result in unexpected firing of fasteners and personal injury.
- 2. Do not point the tool towards yourself or anyone nearby.** Unexpected triggering will discharge the fastener causing an injury.
- 3. Do not actuate the tool unless the tool is placed firmly against the workpiece.** If the tool is not in contact with the workpiece, the fastener may be deflected away from your target.
- 4. Disconnect the tool from the power source when the fastener jams in the tool.** While removing a jammed fastener, the tacker may be accidentally activated if it is plugged in.
- 5. Use caution while removing a jammed fastener.** The mechanism may be under compression and the fastener may be forcefully discharged while attempting to free a jammed condition.
- 6. Do not use this tacker for fastening electrical cables.** It is

General safety warnings

not designed for electric cable installation and may damage the insulation of electric cables thereby causing electric shock or fire hazards.

Component list

- 1. Safety switch
- 2. Trigger
- 3. Lever for loading magazine
- 4. Staple observation window
- 5. Nail / staple head
- 6. On/off switch
- 7. Magazine
- 8. State nail guage
- 9. Staples (Г 10 mm)
- 10. Nails (T 15 mm)





WARNING! Please read and understand this instruction manual before use and keep it for your future reference. Your power tool should only be passed on together with this instruction manual.

Assembly



Warning: Switch off the machine and unplug before inserting nails (10) and staples (9) .

To load nails (10) and staples (9) (See Fig A1-A4)

- 1) Turn the staple / nail gun upside down to access the magazine (7).
- 2) Press the lever for loading magazine (3) and pull out the state nail guage (8) toward the rear.
- 3) Insert the staples (9) or nails (10) strip into magazine (7) with nails (10) or staples (9) pointing upwards (maximum capacity 50 staples (9) or 50 nails (10))

NOTE: Nails (10) are to be inserted on either side of the magazine.

- 4) Insert the magazine (7) again until it engages.

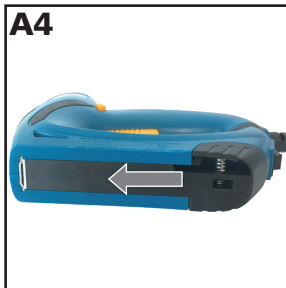
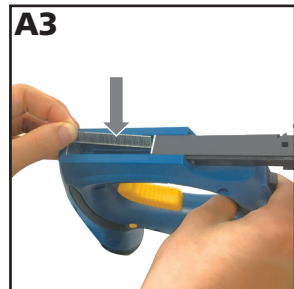
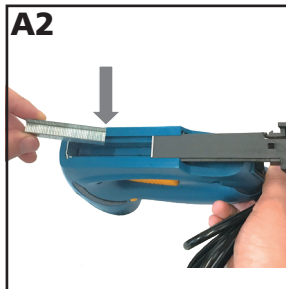
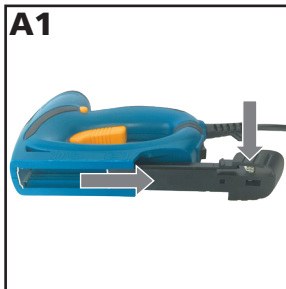

Operation

1. On/off switch (6) (see fig. B)

Plug the power cord into the mains power supply and turn the switch on. To **start** the machine, press down the On/Off switch (6) on the position marked "I".

To **switch off** the machine, press down the On/Off switch (6) on the position marked "O".

 **Warning: Switch off the machine and disconnect it from the power source immediately when not in use.**

2. To operate the staple gun (see fig. C)

- 1) Firmly press the nail/staple head (5) against the workpiece until there is no gap between the nail/staple head (5) and the workpiece.
- 2) Only push the safety switch (1) to the marked "on" place.
- 3) Briefly press the trigger (2) and then release again.

Note: Remove all nails (10) / staples (9) from the magazine after each use.

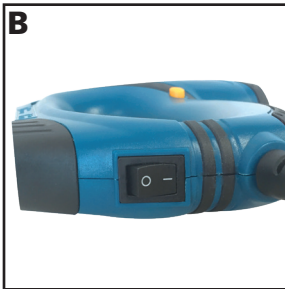

Maintenance

 **WARNING: Remove the plug from the mains power socket before carrying out any adjustment, servicing or maintenance.**

There are no user serviceable parts in your power tool. Never use water or chemical cleaners to clean your power tool. Wipe clean with a dry cloth. Always store your power tool in a dry place. Keep all working

controls free of dust. If the supply cord is damaged, it must be replaced by the manufacturer, its service agent or similarly qualified persons in order to avoid a hazard.

Warranty

Your new WORKZONE® 45W Staple / Nail Gun will more than satisfy your expectations.

It has been manufactured under stringent WORKZONE® Quality Standards to meet superior performance criteria.

You will find your new 45W Staple / Nail Gun easy and safe to operate, and, with proper care, it will give you many years of dependable service.

CAUTION. Carefully read through this entire instruction manual before using your new WORKZONE® 45W Staple / Nail Gun. Take special care to heed the Cautions and Warnings.

Your WORKZONE® 45W Staple / Nail Gun has many features that will make your job faster and easier. Safety, performance, and dependability have been given top priority in the development of this 45W Staple / Nail Gun, making it easy to maintain and operate.

Use only WORKZONE® replacement parts for your product. Non-conforming parts or modifications made to parts will void your warranty.

What your 3 year warranty means

Great care has gone into the manufacture of this product and it should therefore provide you with years of good service when used properly. In the event of product failure within its intended use over the course of as quickly as possible once it has been brought to our attention. In the unlikely event of such an occurrence, or if you require any information about the product please contact us via our after sales support services, details of which can be found in this manual and on the product itself. After Sales Support TEL: 1300 889 028

Service Support

If you have any issues with the operation of your product, please call our Customer Service Hotline on 1300 889 028 for advice, or email us at info.aldi@positecgroup.com

Environmental protection



Recycle unwanted materials instead of disposing of them as waste. All tools, hoses and packaging should be sorted, taken to the local recycling centre and disposed of in an environmentally safe way.

FAQ/Troubleshooting

Fault	Cause	Remedy
1. Product does not start	1.1 Not connected to power supply	1.1 Connect to power supply
	1.2 Product not switched on.	1.2 Press down the "I" on the on/off switch (6).
	1.3 Power cord or plug is defective	1.3 Contact customer service
	1.4 Other electrical defect to the product	1.4 Contact customer service
2. Product does not reach full power	2.1 Extension cord not suitable for operation with the product	2.1 Use a proper extension cord
	2.2 Power source has too low voltage	2.2 Connect to another power source
3. Nails (10) / staples (9) jam in tool	3.1 Wrong size nails(10) / staples (9)	3.1 Use only recommended nails (10) / staples (9) sizes
	3.2 Driver channel worn	3.2 Replace nail / staple
	3.3 Bent nails (10) / staples (9)	3.3 Discontinue using these nails (10) / staples (9)
	3.4 Loose magazine/nose screws	3.4 Tighten all screws
	3.5 Broken/chipped driver	3.5 Replace nail / staple

For further inquiries or issues associated with your tool, call our Customer Service Hotline on 1300 889 028 or email us at info.aldi@positecgroup.com

Technical Specifications

Rated voltage	220-240V~50Hz
Rated power input	45 W
Firing rate	30 nails / staples per min
Staple capacity	6-14 mm
Nail capacity	15 mm
Max Nail/staple Capacity	50 pcs
Protection class	□ /II
Machine weight	0.475 kg
Product Dimensions	215*50*157 mm

This Staple Gun complies with the following Standards :

Safety:

EN 60745-1
EN 60745-2-16
AS/NZS 60745.1
AS/NZS 60745.2.16

EMC:

EN 55014-1
EN 55014-2
EN 61000-3-2
EN 61000-3-3

This page is blank



ALDI guarantees that our exclusive brand products are developed to our stringent quality specifications. If you are not entirely satisfied with this product, please return it to your nearest ALDI store, within 60 days from the date of purchase, for a full refund or replacement, or take advantage of our after sales support by calling the supplier's Customer Service Hotline.



Made in China

Workzone® is a registered trademark of ALDI Stores

DISTRIBUTED BY:

ALDI STORES

1 SARGENTS ROAD

MINCHINBURY NSW 2770

www.aldi.com.au

AFTER SALES SUPPORT



1300 889 028 (toll free)

e-mail: info.aldi@positecgroup.com

MODEL No.: PCT161 • 07/2019

10366

3
YEARS
WARRANTY