



# User Manual

## WORKZONE®

10275

150W Bench Grinder



Product  
Info



+ VIDEO

<https://help.tools/>

Read all safety warnings and all instructions thoroughly before operating this product.

Ensure you keep your manual in a safe place for future reference.

IM ed 4; 07/2019



MODEL No.: DG75A PRODUCT No.: 10275  
Original Instructions

# Welcome

Congratulations in choosing to buy a Workzone® 150W Bench Grinder.

All products bought to you by Workzone® are manufactured to the highest standards of performance and safety and, as part of our philosophy of customer service and satisfaction, are backed by our comprehensive 3 Year Warranty. We hope you will enjoy your purchase for many years to come.

When you open your packaging, first remove all items and check there are no parts damaged or missing. If you find anything wrong, do not operate the product until the parts have been replaced or the fault has been rectified. Failure to do so could result in serious personal injury.

## QR codes take you where you want to go quickly and easily

Whether you require product information, spare parts or accessories, details on warranties or aftersales service, or if you want to watch a product demonstration video, our QR codes will take you there in no time at all.

### What is a QR code?

A QR-code (QR=Quick Response) is a type of matrix that can be read with a smartphone camera and that contains a link to a website or contact details, for example.

Advantage: You are not required to manually enter a website address or contact details.

### How it works

To scan the QR code, all you need is a smartphone with QR codes reader software and an Internet connection\*. This type of software can be downloaded for free from your smartphone's app store.

### Try it out now

Just scan the QR code with your smartphone and find out more about the Aldi product you have purchased\*.



\* Depending on your tariff you may be charged for the connection.



# Contents

<b>Application / Pack contents / parts</b> .....	<b>2</b>
<b>Description of symbols</b> .....	<b>3</b>
<b>General power tool safety warnings</b> .....	<b>4</b>
<b>Parts List</b> .....	<b>8</b>
<b>Assembly</b> .....	<b>10</b>
<b>Operation</b> .....	<b>15</b>
<b>Maintenance &amp; Cleaning</b> .....	<b>17</b>
<b>Warranty</b> .....	<b>18</b>
<b>Environmental protection</b> .....	<b>18</b>
<b>Accessories and After Sales Parts</b> .....	<b>19</b>
<b>FAQ/Troubleshooting</b> .....	<b>19</b>
<b>Technical Specifications</b> .....	<b>20</b>

e.

## Application / Pack contents / parts

First time users or inexperienced operators pay particular attention to the operation of the 150W Bench Grinder, including details of starting and stopping and correct use of the 150W Bench Grinder on pages 17-18, as well as the maintenance instructions on page 19.

### Intended use of 150W Bench Grinder

**NOTE:** This product is for private domestic DIY use only. It is not suitable for commercial or trade use.

This 150W Bench Grinder is used for milling, polishing, cleaning, grinding and cutting various materials. It is suitable for the grinding of hard materials such as hard metals, cast iron, HSS, ceramics and glass as well as soft materials such as copper, aluminium and plastics. It can also be used for tough materials such as unhardened steel, welds, hardened steel and titanium. The appliance is not intended for commercial use. Any other use of or modification to the appliance is deemed to be improper and carries the risk of serious personal injury. The manufacturer accepts no responsibility for damage(s) attributable to misuse.

### Contents of carton

2 x Eye shields	1 x Flexible Shaft attachment
1 x Grinding wheel / 1 x Polishing wheel (fitted)	1 x Spanner
2 x Spark deflectors	2 x Mounting screws for Eye shields
2 x Tool rests	4 x Mounting screw for Spark deflectors
2 x Tool rest adjustment screws	1 x Instruction manual
	1 x Warranty Card

- Remove all packing materials
- Ensure all parts on the contents list are present
- Check the appliance, and all accessories for transportation damages.

**WARNING!** Please read and understand this instruction manual before use and keep it for your future reference. Your power tool should only be passed on together with this instruction manual.

## Description of symbols

The instruction manual, rating plate, or on the product itself, may show these symbols. These represent important information about the product or instructions on its use.



Conforms to relevant standards for electrical safety and electromagnetic compatibility.



To reduce the risk of injury, user must read instruction manual.



36 Month Warranty Period.



Wear ear protection.  
Wear eye protection.  
Wear breathing protection.



This bench grinder is double insulated. There are two independent barriers of insulation to protect you from the possibility of electric shock.



Warning.



Disconnect the product from mains power before undertaking any maintenance tasks.



DO NOT touch the grinder or polishing discs while in use.

# General power tool safety warnings



**WARNING! Read all safety warnings, instructions, illustrations and specifications provided with this power tool.**

Failure to follow all instructions listed below may result in electric shock, fire and/or serious injury.

## Save all warnings and instructions for future reference.

The term “power tool” in the warnings refers to your mains-operated (corded) power tool or battery-operated (cordless) power tool.

### 1. Work area safety

- a. **Keep work area clean and well lit.** Cluttered or dark areas invite accidents. Rags, cloths, cord, string and similar items should never be left around the work area.
- b. **Do not operate power tools in explosive environments, such as in the presence of flammable liquids, gases, or dust.** Power tools create sparks, which may ignite the dust or fumes.
- c. **Keep children and bystanders away while operating a power tool.** Distractions can cause the operator to lose control.

### 2. Electrical safety

- a. **Power tool plugs must match the outlet. Never modify the plug in any way.** Do not use any adapter plugs with earthed (grounded) power tools. Unmodified plugs and matching outlets will reduce risk of electric shock.
- b. **Avoid body contact with earthed or grounded surfaces such as pipes, radiators, ranges and refrigerators.** There is increased risk of electric shock if your body is earthed or grounded.
- c. **Do not expose power tools to rain or wet conditions.** Water entering a power tool will increase the risk of electric shock.
- d. **Do not abuse the cord.** Never use the cord for carrying, pulling or unplugging the power tool. Keep cord away from heat, oil, sharp edges or moving parts. Replace damaged cords immediately.



Damaged or entangled cords increase the risk of electric shock.

- e. **When operating a power tool outdoors, use an extension cord suitable for outdoor use.** Use of a cord suitable for outdoor reduces the risk of electric shock.
- f. **If operating a power tool in a damp location is unavoidable, use a residual current device (RCD) protected supply.** Use of an RCD reduces the risk of electric shock.

### 3. Personal safety

- a. **Stay alert, watch what you are doing and use common sense when operating a power tool. Do not use a power tool while you are tired or under the influence of drugs, alcohol or medication.** A moment of inattention while operating power tools may result in serious personal injury.
- b. **Use personal protective equipment. Always wear eye protection.** Protective equipment such as dust mask, non-skid safety shoes, hard hat, or hearing protection used for appropriate conditions will reduce personal injuries.
- c. **Prevent unintentional starting. Ensure the switch is in the “off” position before connecting to power source and/or battery pack, picking up or carrying the tool.** Carrying power tools with your finger on the switch or energising power tools that have the switch on invites accidents.
- d. **Remove any adjusting key or wrench before turning the power tool on.** A wrench or key left attached to a rotating part of the power tool may result in personal injury.
- e. **Do not overreach. Keep proper footing and balance at all times.** This enables better control of the power tool in unexpected situations.
- f. **Dress properly. Do not wear loose clothing or jewellery. Keep your hair, clothing and gloves away from moving parts.** Loose clothes, jewellery or long hair can be caught in moving parts.
- g. **If devices are provided for the connection of dust extraction and collection facilities, ensure these are connected and properly used.** Use of dust collection can reduce dust-related hazards.
- h. **Do not let familiarity gained from frequent use of tools allow you to become complacent and ignore tool safety principles.** A careless action can cause severe injury in a fraction of a second.





## General power tool safety warnings

### 4. Power tool use and care

- a. **Do not force the power tools. Use the correct power tool for your application.** The correct power tool will do the job better and safer at the rate for which it was designed.
- b. **Do not use the power tool if the switch does not turn it on and off.** Any power tool that cannot be controlled with the switch is dangerous and must be repaired.
- c. **Disconnect the plug from the power source and/or the battery pack, if detachable, from the power tool before making any adjustments, changing accessories, or storing power tools.** Such preventive safety measures reduce the risk of starting the power tool accidentally.
- d. **Store idle power tools out of the reach of children and do not allow persons unfamiliar with the power tool or these instructions to operate the power tool.** Power tools are dangerous in the hands of untrained users.
- e. **Maintain power tools and accessories. Check for misalignment or binding of moving parts, breakage of parts and any other condition that may affect the power tool's operation. If damaged, have the power tool repaired before use.**

Many accidents are caused by poorly maintained power tools.
- f. **Keep cutting tools sharp and clean.** Properly maintained cutting tools with sharp cutting edges are less likely to bind and are easier to control.
- g. **Use the power tool, accessories and tool bits etc. in accordance with these instructions, taking into account the working conditions and the work to be performed.** Use of the power tool for operations different from those intended could result in a hazardous situation.
- h. **Keep handles and grasping surfaces dry, clean and free from oil and grease.** Slippery handles and grasping surfaces do not allow for safe handling and control of the tool in unexpected situations.





## 5. Service

- a. **Have your power tool serviced by a qualified repair person using only identical replacement parts.** This will ensure that the safety of the power tool is maintained.

### **Bench grinder safety warnings**

- a. **Do not use a damaged accessory. Before each use, inspect the accessory such as abrasive wheels for chips and cracks. After inspecting and installing an accessory, position yourself and bystanders away from the plane of the rotating accessory and run the power tool at maximum no-load speed for one minute.** Damaged accessories will normally break apart during this test time.
- b. **The rated speed of the accessory must be at least equal to the maximum speed marked on the power tool.** Accessories running faster than their rated speed can break and fly apart.
- c. **Never grind on the sides of a grinding wheel.** Grinding on the side can cause the wheel to break and fly apart.

## 6. Important information – Product care

Care **MUST** be taken to ensure both the safety and life of the pack is maintained. Ensure you have read all of the safety notes in the previous pages before using the 150W Bench Grinder.



AUS

150W Bench Grinder

## Parts List

1. Eye shield
2. Polishing wheel
3. Locking nut
4. Connecting thread
5. Flexible Shaft
6. Black collar
7. Collet chuck mount
8. Variable Speed control
9. ON/OFF switch
10. Tool rest adjustment screws
11. Tool rest
12. Grinding wheel
13. Spark deflector



8

e-mail: [info.aldi@positecgroup.com](mailto:info.aldi@positecgroup.com)  
MODEL No.: DG75A • 07/2019 • 10275

AFTER SALES SUPPORT

 **AUS** 1300 889 028  
(toll free)





AUS

### 150W Bench Grinder

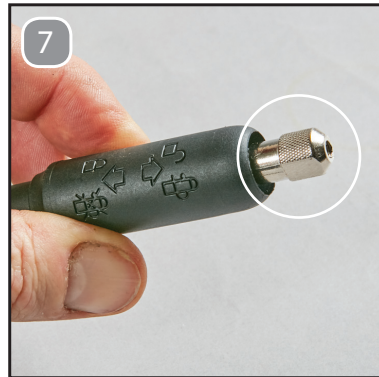
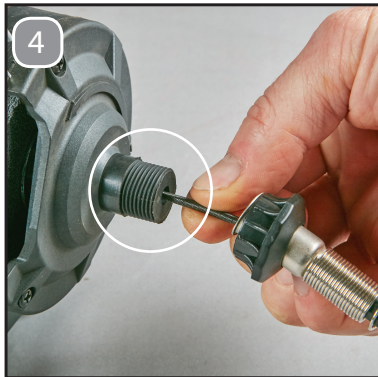
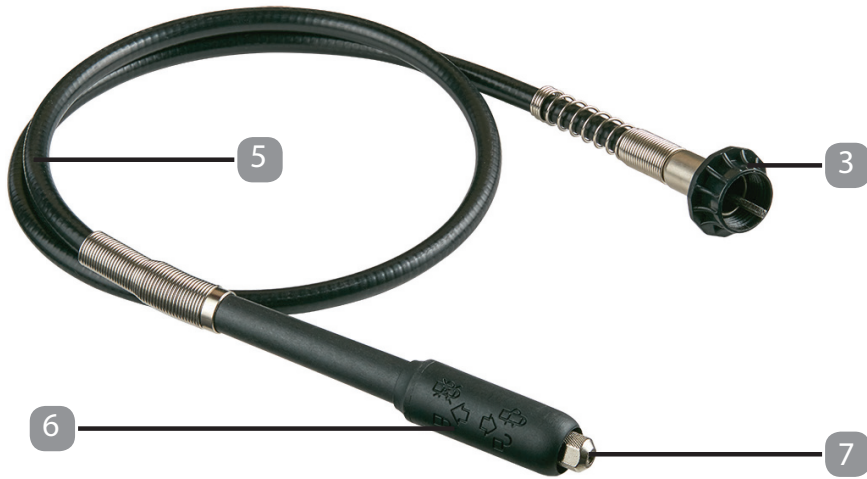

AFTER SALES SUPPORT

 AUS 1300 889 028  
(toll free)

9

e-mail: [info.aldi@positecgroup.com](mailto:info.aldi@positecgroup.com)  
MODEL No.: DG75A • 07/2019 • 10275





AUS

150W Bench Grinder

## 7. Assembly



**NOTE:** Before using the tool, read the instruction book carefully.

**NOTE:** Please note that you must always fit the following before use:

- tool rests (11)
- spark deflectors (13)
- eye shields (1)

As required for the grinding wheel (12) or polishing wheel (2)



**WARNING!** Ensure the grinder is not plugged in and is switched off during assembly process.

### 7.1 Fitting the Tool rests

Fit the tool rests (11) onto the grinder using the supplied tool rest adjustment screws (10) (See Fig. A)

With the nut on the outside, and the tool rest adjustment screws (10) + washer + spring washer on the inside, secure the tool rest (11) into position. (See Fig. A)

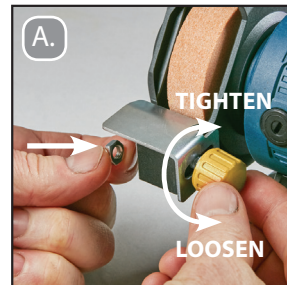

Secure the tool rest onto both sides of the bench grinder

### 7.2 Adjusting the Tool rests

Adjust the tool rests (11) using the tool rest adjustment screws (10). Ensure that the space between the grinding wheel (12) or the polishing wheel (2) and the tool rest (11) is as low as possible.

Ensure that the tool rests (11) do not come into contact with the grinding (12) or the polishing wheels (2).

Adjust the distance repeatedly as the grinding wheel (12) or polishing wheel (2) wears down.





AUS

150W Bench Grinder

### 7.3 Fitting the spark deflectors (13)

Fit the spark deflectors (13) with the aid of the fixing bolts for the sparks deflectors (13), nuts, washers and spring washers to the top of the grinder (See Fig. B).

Tighten the nuts using a pair of pliers or a wrench (not supplied). Tighten the fixing bolts for the spark deflectors (13) using a phillips head screw driver.

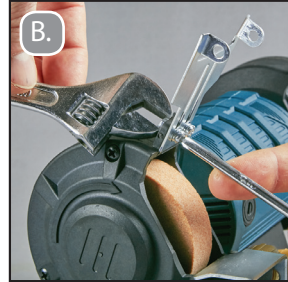

Fit the sparks deflectors (13) so that the distance between the grinding wheel (12) or polishing wheel (2) and the spark deflector (13) is as small as possible. The gap should not be greater than 2mm. Ensure that the spark deflectors (13) do not come into contact with the grinding wheel (12) or the polishing wheel (2). Adjust the distance repeated as the grinding wheel (12) or polishing wheel (2) wears down.

### 7.4 Fitting the Eye shields (1)

Attach the eye shields (1) to the fixtures provided on the spark deflectors (13) using the mounting screws for the eye shields (1), nuts, washers and spring washers (See Fig. C)

Tighten the nuts using a pair of pliers or a wrench. Tighten the fixing bolts for the eye shields (1) using a phillips head screwdriver.



### 7.5 Changing the grinding / polishing wheels



**WARNING! RISK OF INJURY!**

**Always remove the power plug from the wall socket before carrying out any work on the grinder.**

**WARNING! The grinding wheel (12) or polishing wheel (2) used may not be any larger than the prescribed diameter.**

**Replace the grinding wheel (12) or polishing wheel (2) when the outer diameter is less than 50mm.**

**Note that you will require tools which are not included in delivery for the assembly.**

AFTER SALES SUPPORT

11

 **AUS** 1300 889 028  
(toll free)

MODEL No.: DG75A • 07/2019 • 10275





AUS

150W Bench Grinder

## Changing the grinding wheel

Using a screwdriver, unscrew the fixing screws from the side protective cover. Remove the protective cover. (See Fig. D1, D2, D3)

Loosen the nut by rotating in a clockwise direction. Take out the nut, washer, and the old grinding wheel. (See Fig. D4)

Replace with the new grinding wheel, washer and nut. Fix firmly by rotating the nut in an anticlockwise direction. (See Fig. D5) . Replace the protective cover and tighten the screws (See Fig. D6).

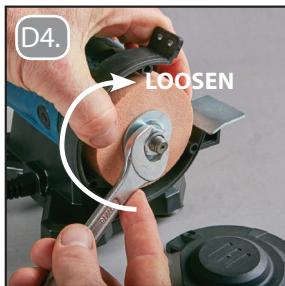
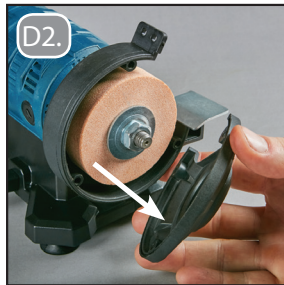
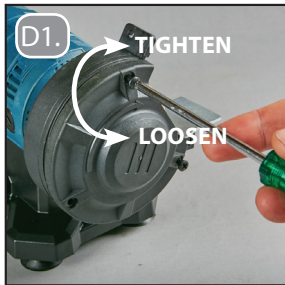



AUS

150W Bench Grinder

## Changing the polishing wheel

Use a screwdriver to unscrew the fixing screws from the side protective cover. Remove the protective covers on both sides. (See Fig. E1, E2)

Remove the latch (See Fig. E4). Remove the cover. (See Fig. E3, E4)

Loosen the nut by rotating in an anticlockwise direction. Take out the nut, washer, and the old /polishing wheel (See Fig. E5).

Replace with the new polishing wheel, washer and nut. Secure firmly by rotating the nut in a clockwise direction. (See Fig. E6). Replace the protective cover and tighten the screws. (See Fig. E7).

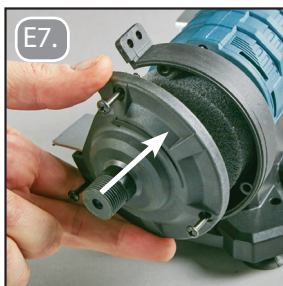
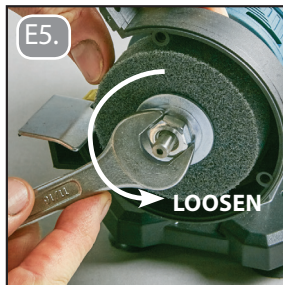
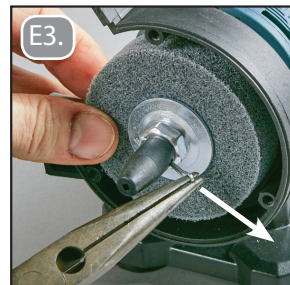
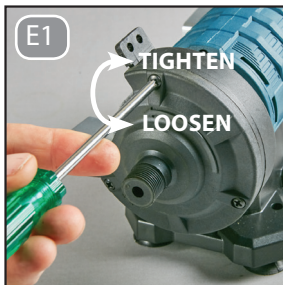

### WARNING: RISK OF INJURY!

Never use the grinding wheel (12) or polishing wheel (2) without the protective cover fitted.

### CAUTION! PROPERTY DAMAGE!

Refit the protective cover and fix it in place by tightening the fixing screws.

AFTER SALES SUPPORT

 AUS 1300 889 028  
(toll free)

13

MODEL No.: DG75A • 07/2019 • 10275





AUS

150W Bench Grinder

## 7.6 Fitting the flexible shaft



**WARNING! RISK OF INJURY!**

**Always remove the power plug from the wall socket before carrying out any work on the grinder.**

Screw the flexible shaft (5) onto the connecting thread (4) of the grinder. To do this, push the axle core of the flexible shaft into the square hole on the connecting thread (4). (See Fig.F1) Turn the locking nut (3) anticlockwise to tighten. (See Fig. F2)



**WARNING! RISK OF INJURY! Make sure that the eyes shields (1) are folded down to the tool rest (11). This can prevent unintentional contact with the grinding wheel (12) or polishing wheel (2).**

**After use, remove the flexible shaft (5) from the grinder. Otherwise, the flexible shaft (5) could start vibrating in an uncontrolled manner and cause an injury when you switch the appliance on.**

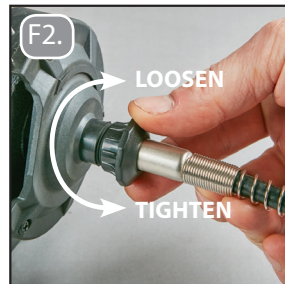
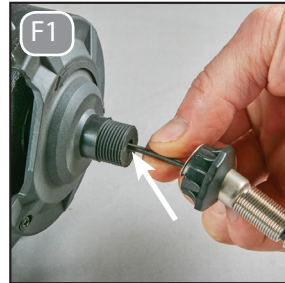

## 7.7 Fitting tools onto the Flexible shaft

Push the black collar all the way back onto the flexible shaft to lock the spindle. Note that the collet chuck mount is loosened in an anticlockwise direction. Hold the black collar in this position. (See Fig. G1)

Fit the tool (not supplied) and screw the collet chuck mount back into place. Release the black collar. (See Fig. G2)

**NOTE:** The flexible shaft attachment is designed for use with 3.2mm accessories only. Use bits of the correct shank diameter suitable for the speed of the tool.

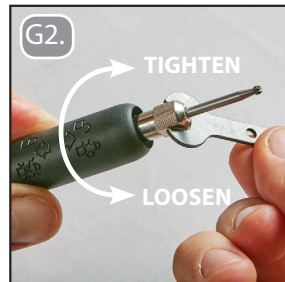





150W Bench Grinder

## 8. Operation

### 8.1 Working procedures

**NOTE:** This bench grinder must be used with a residual current device with rated residual current of 30mA or less. Use of an RCD reduces the risk of electric shock.

**Ensure that the appliance is always stable and secure. For extra safety, you can secure the appliance in a suitable location. There are two drill holes in the housing foot that can be used for attachment to a secure and level surface. Feed a suitable fixing material that is appropriate for the surface (not supplied) through the 2 drill holes. Fix the appliance to the surface using the fixing material.**

**Ensure that the grinding wheel and polishing wheels are not blocked.**

**Ensure that the eye shields (1), spark deflectors (13) and tool rests (11) are properly fitted and adjusted!**

**A light grinding pressure is sufficient:**

Work using a light grinding pressure: a constant and correct speed will ensure the best grinding performance.

**Grinding:**

Bear in mind that the workpiece heats up during grinding. Therefore, cool the workpiece in a water bath. Dry it thoroughly before you resume working.

### 8.2 Switching on and off

**Note:** Before first use, allow the grinding wheel (12) and polishing wheel (2) to run without a load at top speed for about 5 minutes. When doing so, stay out of the hazard area in front of and next to the openings in the grinding wheel (12) or the polishing wheel (2).



**WARNING! RISK OF INJURY!**

**Ensure the lowest possible distance (gap) between the grinding wheel (12) or the polishing wheel (2) and the tool rests (11).**

AFTER SALES SUPPORT

15

  1300 889 028

(toll free)

MODEL No.: DG75A • 07/2019 • 10275





AUS

## 150W Bench Grinder

### **If the grinder suddenly brakes completely or jams, it must be switched off immediately.**

Set the eye shields (1) so that they provide the greatest possible protection during use.

- To start the tool, press in the on/off switch to position "I".
- To stop the tool, press in the on/off switch to "O". (See Fig. H)

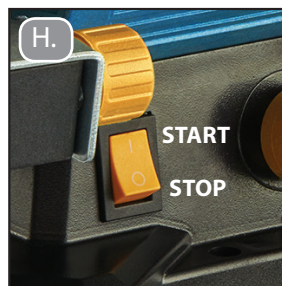

### **8.3 Variable Speed control (8)**

Set a speed suitable for the work using the variable speed control (8). (See Fig. I)

Rotate the variable speed control (8) clockwise to increase the speed.

Rotate the variable speed control (8) anticlockwise to decrease the speed.

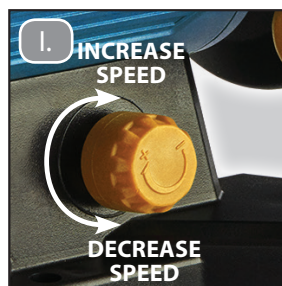

### **8.4 Grinding**

Place the workpiece on the tool rest (11). Guide the workpiece slowly towards the grinding wheel (12) at the required angle until the workpiece and the grinding wheel (12) come into contact with each other.

Move the workpiece evenly backwards and forwards in order to achieve optimal results. This also ensure that the grinding wheel (12) is worn down more evenly.

**Note:** The direction of rotation of the tool is per Fig. J.

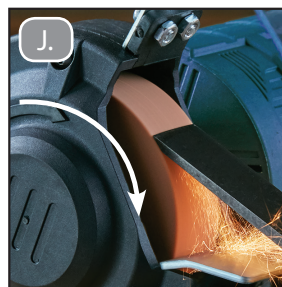

### **Notes on working with materials/tools/speed range.**

Never use the appliance for other purposes and only use original parts/accessories. Using attachments or accessory tools other than those recommended in the operating instructions can lead to a risk of injury.





AUS

## 150W Bench Grinder

Determine the rotational speed range for working on zinc, zinc alloys, aluminium and copper by trying it out on test pieces.

Use a low rotational speed for work on plastics and materials with a low melting point.

Use a high rotational speed for working on wood.

Carry out cleaning, polishing and buffing work in the medium speed range.

**If you exert too much pressure, the fitted tool can break and/or the workpiece could be damaged. You will achieve optimum working results by moving the tool over the workpiece at a steady speed and while exerting light pressure.**

## 9. Maintenance and cleaning



**WARNING! RISK OF INJURY!** Always pull out the plug before adjustment, maintenance or repairing the appliance.

**NOTE:** Always clean the grinder immediately after finishing work. Use a dry cloth to clean the housing.

Under no circumstances should you use fuel, detergents, solvents or abrasive cleaners.

Ensure ventilation openings are always free.

Remove any adhering grinding dust with a brush.

### Storage

Store the grinder in a dry and dust-free location.

Store the brushes somewhere dry and not in the vicinity of aggressive media.

The grinding wheels must be stored in a dry location and should not be stacked.

Store the accessories so they are protected from damage.

Store out of the reach of children.

AFTER SALES SUPPORT

17

 **AUS** 1300 889 028  
(toll free)

MODEL No.: DG75A • 07/2019 • 10275





AUS

150W Bench Grinder

## 10. Warranty

Your new WORKZONE® 150W Bench Grinder will more than satisfy your expectations.

It has been manufactured under stringent WORKZONE® Quality Standards to meet superior performance criteria.

You will find your new 150W Bench Grinder easy and safe to operate, and, with proper care, it will give you many years of dependable service.

**CAUTION.** Carefully read through this entire instruction manual before using your new WORKZONE® 150W Bench Grinder. Take special care to heed the Cautions and Warnings.

Your WORKZONE® 150W Bench Grinder has many features that will make your job faster and easier. Safety, performance, and dependability have been given top priority in the development of this 150W Bench Grinder, making it easy to maintain and operate.

Use only WORKZONE® replacement parts for your product. Non-conforming parts or modifications made to parts will void your warranty.

## 11. Environmental protection



Recycle unwanted materials instead of disposing of them as waste.

All tools, hoses and packaging should be sorted, taken to the local recycling centre and disposed of in an environmentally safe way.

### What your 3 year warranty means

Great care has gone into the manufacture of this product and it should therefore provide you with years of good service when used properly.

In the event of product failure within its intended use over the course of as quickly as possible once it has been brought to our attention. In the unlikely event of such an occurrence, or if you require any information about the product please contact us via our after sales support services, details of which can be found in this manual and on the product itself.

After Sales Support TEL: 1300 889 028





150W Bench Grinder

## Service Support

If you have any issues with the operation of your product, please call us on 1300 889 028 for advice, or email us at [info.aldi@positecgroup.com](mailto:info.aldi@positecgroup.com)

## 12. Accessories and After Sales Parts

For after sales parts visit <https://help.tools/> or calling our customer service hotline on: 1300 889 028

## 13. FAQ/ Troubleshooting

Symptom	Possible Cause	Remedy
The main axis shakes	Motor damage	Contact customer service.
On/Off Switch does not work	On/Off switch is defective.	Change the On/Off switch
Low working efficiency of grinding wheel / polishing wheel	Grinding wheel /polishing wheel are worn or broken	Change the grinding wheel / polishing wheel
The protective accessories are damaged and deformed	The protective accessories may have worn beyond their user life	Change the protective accessories
Carbon brush do not work	Carbon brush wear	Change the carbon brushes

For further inquiries or issues associated with your tool, call our Customer Service on 1300 889 028 or email us at [info.aldi@positecgroup.com](mailto:info.aldi@positecgroup.com)





150W Bench Grinder

## 14. Technical Specification

Voltage:	230-240V~50Hz
Rated power:	S1 120W; S2 15min 150W
No load speed:	1000~9900/min
Wheel size 1:	75 x 20 x 10mm
Wheel size 2:	75 x 20 x 10mm
Weight:	2.01kg
Diameter of wheels:	Ø75mm
Chuck size:	Ø3.2mm

### **This 150W Bench Grinder complies with the following Standards:**

Safety:	IEC 62841-1 IEC 62841-3-4 AS/NZS 62841.1 AS/NZS 62841.3.4
EMC:	EN 55014-1 EN 55014-2 EN 61000-3-2 EN 61000-3-3







150W Bench Grinder

This page is blank



AFTER SALES SUPPORT

21

  1300 889 028  
(toll free)

MODEL No.: DG75A • 07/2019 • 10275





ALDI guarantees that our exclusive brand products are developed to our stringent quality specifications. If you are not entirely satisfied with this product, please return it to your nearest ALDI store, within 60 days from the date of purchase, for a full refund or replacement, or take advantage of our after sales support by calling the supplier's Customer Service Hotline.



**Made in China**

WORKZONE® is a registered trademark of ALDI Stores

DISTRIBUTED BY:

ALDI STORES

1 SARGENTS ROAD

MINCHINBURY NSW 2770

[www.aldi.com.au](http://www.aldi.com.au)

**AFTER SALES SUPPORT**



1300 889 028 (toll free)

e-mail: [info.aldi@positcgroup.com](mailto:info.aldi@positcgroup.com)

MODEL: DG75A • 07/2019 • 10275

**3**

YEAR WARRANTY