



User Manual

FERREX[®]

708345

650W PAINT SPRAYER



Product
Info



<https://help.tools/>

Read all safety warnings and all instructions thoroughly before operating this product.

Ensure you keep your manual in a safe place for future reference.

Original instructions

IM ed 6; 03/2022

QR codes take you where you want to go quickly and easily

Whether you require product information, spare parts or accessories, details on warranties or aftersales service, or if you want to watch a product demonstration video, our QR codes will take you there in no time at all.

What is a QR code?

A QR-code (QR=Quick Response) is a type of matrix that can be read with a smartphone camera and that contains a link to a website or contact details, for example.

Advantage: You are not required to manually enter a website address or contact details.

How it works

To scan the QR code, all you need is a smartphone with QR codes reader software and an Internet connection*. This type of software can be downloaded for free from your smartphone's app store.

Try it out now

Just scan the QR code with your smartphone and find out more about the Aldi product you have purchased*.



* Depending on your tariff you may be charged for the connection.



FERREX[®]

650W Paint Sprayer

Warranty details

REGISTER YOUR PURCHASE AT www.aldi.com.au/en/about-aldi/product-registration/ TO KEEP UP-TO-DATE WITH IMPORTANT PRODUCT INFORMATION.

The product is guaranteed to be free from defects in workmanship and parts for a period of 36 months from the date of purchase. Defects that occur within this warranty period, under normal use and care, will be repaired, replaced or refunded at our discretion. The benefits conferred by this warranty are in addition to all rights and remedies in respect of the product that the consumer has under the Competition and Consumer Act 2010 and similar state and territory laws.

Our goods come with guarantees that cannot be excluded under the Australian Consumer Law. You are entitled to a replacement or refund for a major failure and for compensation for any other reasonably foreseeable loss or damage. You are also entitled to have the goods repaired or replaced if the goods fail to be of acceptable quality and the failure does not amount to a major failure.

AFTER SALES SUPPORT

 **1300 889 028**
(toll free)

e-mail: info.aldi@positcgroup.com
MODEL No.: PRG650G • 03/2022 • 708345



Contents

Pack contents /parts	2
Description of symbols	3
General safety instructions	4
Additional safety instructions for your paint sprayer	6
Parts list	7
Assembly	9
Operation	11
On/off switch	11
Take the paint sprayer out of the paint sprayer holder	11
Trigger	11
Assemble the shoulder strap	11
Adjustment of the paint sprayer	12
Adjustment of the rate of flow	12
Spray technology	13
Work stoppages	13
Maintenance	14
Troubleshooting	15
Warranty	16
Environmental protection	16
What your 3 year warranty means	16
Service Support	18
Technical specifications	18
Accessories and after sales parts	19

Pack contents / parts

Congratulations on the purchase of your FERREX® 650W Paint Sprayer. When you open your packaging, first remove all items and check there are no parts damaged or missing. If you find anything wrong, do not operate the product until the parts have been replaced or the fault has been rectified. Failure to do so could result in serious personal injury.

Intended use of the 650W Paint Sprayer

NOTE: This product is for private domestic DIY use only.

It is not suitable for commercial, industrial or trade use.

Use the 650W Paint Sprayer only for intended applications including spraying non-flammable and non-hazardous paints and varnishes.

The Paint Sprayer should not be used for spraying of flammable liquids. Do not use the Paint Sprayer for food, pharmacy or other purposes that are not mentioned in the manual.

This user manual contains important information on how to use the 650W Paint Sprayer. Read this user manual carefully, in particular the safety instructions, before using the product. Failure to follow this user manual may lead to severe injuries or product damage.

Keep this user manual for further reference.

IMPORTANT INFORMATION.

NOTE: First time users or inexperienced operators pay particular attention to the operation of the 650W Paint Sprayer, including details of starting and stopping and correct use of the 650W Paint Sprayer on pages 11-13, as well as the maintenance instructions on page 14-16.

Contents of carton

1 x 650W Paint Sprayer

1 x 1.8m High flex hose

1 x Viscosity Cup/ Filler

1 x Nozzle Cleaning Needle

1 x Shoulder Strap

1 x 800ml Paint Pot

1 x Instruction Manual

1 x Warranty Card

Description of symbols

The instruction manual or rating plate on your product may show symbols. These represent important information about the product or instructions on its use.



Read the instructions



Warning



Wear hearing protection.
Wear eye protection.
Wear breathing protection.



Warning: Do not direct the jet at persons, animals and electrical equipment.



Double insulation



Conforms to relevant standards for electrical safety and electromagnetic compatibility.



36 Months Warranty Period.



The box is recyclable at the kerbside.

General safety instructions



WARNING: Read all safety warnings, instructions, illustrations and specifications provided with this power tool. *Failure to follow the warnings and instructions may result in electric shock, fire and/or serious injury.*

Save all warnings and instructions for future reference.

The term “power tool” in the warnings refers to your mains-operated (corded) power tool or battery-operated (cordless) power tool.

1) Work area safety

- a) **Keep work area clean and well lit.** *Cluttered or dark areas invite accidents.*
- b) **Do not operate power tools in explosive atmospheres, such as in the presence of flammable liquids, gases or dust.** *Power tools create sparks which may ignite the dust or fumes.*
- c) **Keep children and bystanders away while operating a power tool.** *Distractions can cause you to lose control.*

2) Electrical safety

- a) **Power tool plugs must match the outlet. Never modify the plug in any way. Do not use any adapter plugs with earthed (grounded) power tools.** *Unmodified plugs and matching outlets will reduce risk of electric shock.*
- b) **Avoid body contact with earthed or grounded surfaces, such as pipes, radiators, ranges and refrigerators.** *There is an increased risk of electric shock if your body is earthed or grounded.*
- c) **Do not expose power tools to rain or wet conditions.** *Water entering a power tool will increase the risk of electric shock.*
- d) **Do not abuse the cord. Never use the cord for carrying, pulling or unplugging the power tool. Keep cord away from heat, oil, sharp edges or moving parts.** *Damaged or entangled cords increase the risk of electric shock.*
- e) **When operating a power tool outdoors, use an extension cord suitable for outdoor use.** *Use of a cord suitable for outdoor use reduces the risk of electric shock.*
- f) **If operating a power tool in a damp location is unavoidable, use a residual current device (RCD) protected supply.** *Use of an RCD reduces the risk of electric shock.*

3) Personal safety

- a) **Stay alert, watch what you are doing and use common sense when operating a power tool. Do not use a power tool while you are tired or under the influence of drugs, alcohol or medication.** *A moment of inattention while operating power tools may result in serious personal injury.*
- b) **Use personal protective equipment. Always wear eye protection.** *Protective equipment such as dust mask, non-skid safety shoes, hard hat, or hearing protection used for appropriate conditions will reduce personal injuries.*
- c) **Prevent unintentional starting. Ensure the switch is in the off-position before connecting to power source and/or battery pack, picking up or carrying the tool.** *Carrying power tools with your finger on the switch or energising power tools that have the switch on invites accidents.*
- d) **Remove any adjusting key or wrench before turning the power tool on.** *A wrench or a key left attached to a rotating part of the power tool may result in personal injury.*
- e) **Do not overreach. Keep proper footing and balance at all times.** *This enables better control of the power tool in unexpected situations.*
- f) **Dress properly. Do not wear loose clothing or jewellery. Keep your hair, clothing and gloves away from moving parts.** *Loose clothes, jewellery or long hair can be caught in moving parts.*
- g) **If devices are provided for the connection of dust extraction and collection facilities, ensure these are connected and properly used.** *Use of these devices can reduce dust-related hazards.*
- h) **Do not let familiarity gained from frequent use of tools allow you to become complacent and ignore tool safety principles.** *A careless action can cause severe injury within a fraction of a second.*

4) Power tool use and care

- a) **Do not force the power tool. Use the correct power tool for your application.** *The correct power tool will do the job better and safer at the rate for which it was designed.*
- b) **Do not use the power tool if the switch does not turn it on and off.** *Any power tool that cannot be controlled with the switch is dangerous and must be repaired.*
- c) **Disconnect the plug from the power source and/or the battery pack from the power tool before making any adjustments, changing accessories, or storing power tools.** *Such preventive safety measures reduce the risk of starting the power tool accidentally.*
- d) **Store idle power tools out of the reach of children and do not allow persons unfamiliar with the power tool or these instructions to operate the power tool.** *Power tools are dangerous in the hands of untrained users.*
- e) **Maintain power tools. Check for misalignment or binding of moving**

- parts, breakage of parts and any other condition that may affect the power tool's operation. If damaged, have the power tool repaired before use.** *Many accidents are caused by poorly maintained power tools.*
- f) Keep cutting tools sharp and clean.** *Properly maintained cutting tools with sharp cutting edges are less likely to bind and are easier to control.*
 - g) Use the power tool, accessories and tool bits etc. in accordance with these instructions, taking into account the working conditions and the work to be performed.** *Use of the power tool for operations different from those intended could result in a hazardous situation.*
 - h) Keep handles and grasping surfaces dry, clean and free from oil and grease.** *Slippery handles and grasping surfaces do not allow for safe handling and control of the tool in unexpected situations.*
- 5) Service**
- a) Have your power tool serviced by a qualified repair person using only identical replacement parts.** *This will ensure that the safety of the power tool is maintained.*
- 6) Recommendation**
- a) Recommendation that the tool always be used with a residual current device having a rated residual current of 30 mA or less.

Additional safety instructions for your paint sprayer

1. Beware of high pressure at the nozzle and toxic sprays, it can cause severe skin damage. Never allow any part of the body to come in contact with the spray.
2. Recommendation that the tool always be supplied via a residual current device with a rated residual current of 30mA or less.
3. Do not use guns for spraying flammable materials.
4. Do not clean guns with flammable solvents.
5. Warning! Be aware of any hazard presented by the material being sprayed and consult the markings on the Paint pot or the information supplied by the manufacturer of the material to be sprayed.
6. Do not spray any material where the hazard is not known.
7. Use appropriate personal protective equipment, such as dust mask, protective clothing.

Parts list

1. Trigger
2. Flow rate adjustment dial
3. Paint sprayer
4. 1.8m High flex hose
5. On / Off switch
6. Paint sprayer holder
7. Paint pot
8. Cup collar
9. Air cap
10. Nozzle
11. Cap collar
12. Viscosity cup
13. Shoulder strap
14. Nozzle cleaning needle
15. Power cord
16. Shoulder strap connection points
17. Paint draw tube

650 W Paint Sprayer



AFTER SALES SUPPORT

☎ AU 1300 889 028
(toll free)

e-mail: info.aldi@positecgroup.com
MODEL No.: PRG650G • 03/2022 • 708345

Assembly



WARNING: Ensure the product is disconnected from the mains power supply before attempting any assembly.

1. Suitable coating materials

Solvent-based and water-based paints, finishes, primers, two-component paints, varnishes, automotive topcoats, stains and wood preservatives.

2. Unsuitable coating materials

Wall colors (dispersion), etc., alkali and acidic paints.

3. Preparedness the coating material

Measuring the viscosity using the viscosity cup(12). (See Fig. A)

- 1) Stir the coating material well before starting to measure.
- 2) Fill the viscosity cup (12) with coating material (100 cm³).
- 3) Lift viscosity cup (12) and measure the time in seconds, until the coating material finishes dripping.
- 4) These are called run-DIN-seconds (DIN-s).

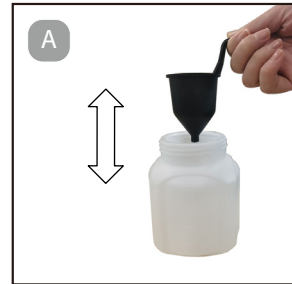

Coating material viscosity DIN-s

Solvent-based paints	15-50
Primers	25-50
Pickling	undiluted
2 Combination paints	20-50
Varnishes	15-40
Waterborne paints	20-40
Automotive topcoats	20-40
Wood protection center I	undiluted

4. Connect the 1.8m high flex hose to the tool

1) Insert the 1.8m high flex hose (4) end to the guide at side of device firmly. Then turn the 1.8m High flex hose (4) counterclockwise until it clicks into place. (See Fig. B1)

2) Insert the other end of the 1.8m high flex hose (4) to the spray gun connector side firmly. Then turn the 1.8m high flex hose (4) counterclockwise until it clicks into place. (See Fig. B2)

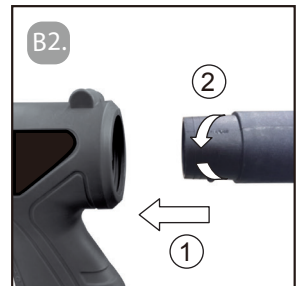
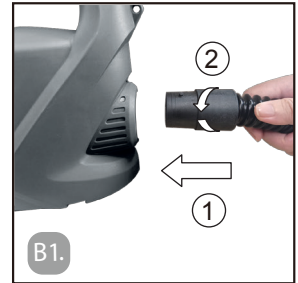

5. Assembly of the paint draw tube

1) Unscrew the paint pot (7) of the paint sprayer (3).

2) Assemble the paint draw tube (17) correctly depending on your requirement to increase the paint uptake in the paint pot (7) as much as possible.



Spraying with underlying objects

- rotate the paint draw tube (17) forward. (See Fig. C1)

Note: Don't tilt it at a large angle.

Spray job with overhead objects

- rotate the paint draw tube (17) backwards. (See Fig. C2)

Note: Don't tilt it at a large angle.



3) Place a protective sheet or something similar under the paint pot (7) . Pour the prepared coating material into the paint pot (7).

4) Screw the paint pot (7) back into the paint sprayer, and tighten it.

Operation

WARNING: Ensure that the paint sprayer is always facing away from the operator when in use.

Note: It is recommended that the tool always be used via a residual current device with a rated residual current of 30mA or less.

1. On/off switch

To start the paint sprayer, press the protective cover over the on/off switch (5) indicated by the mark "0".

To stop the paint sprayer, press the protective cover over the on / off switch (5) indicated by the mark "I". (See Fig. D)

2. Taking the paint sprayer out of the paint sprayer holder

This paint sprayer is equipped with a 1.8m high flex hose (4). The paint sprayer (3) can be taken out of the sprayer holder (6) to make work more convenient. (See Fig. E)

3. Trigger

Depress the trigger (1) to begin spraying. (See Fig. F)

4. Assembling the shoulder strap

There are two shoulder strap connection points (16) on the paint sprayer holder (6). Connect one of the clips on the shoulder strap (13) to each point. (See Fig. G)



5. Adjustment of the paint sprayer



WARNING: Never change the setting of the air cap (9) when pulling the trigger (1).



WARNING: Ensure the product is disconnected from the mains power supply before attempting any assembly.

Selection spray patterns

1) Unscrew the cap collar (11).

2) Setting the position of air cap (9) to the desired requirement:

The Horizontal position (a) of air cap (9) = the spraying shape is vertical: for vertical surface. (See Fig. H1)

The vertical position (b) of air cap (9) = the spraying shape is horizontal: for horizontal surface. (See Fig. H2)

The oblique position (c) of air cap (9) = the spraying shape is circular: for corners, edges and others. (See Fig. H3)

3) Screw the Cap collar and tighten it.

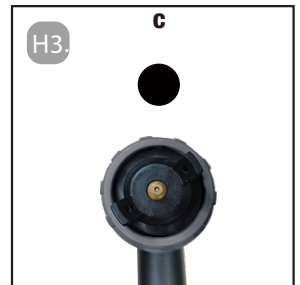
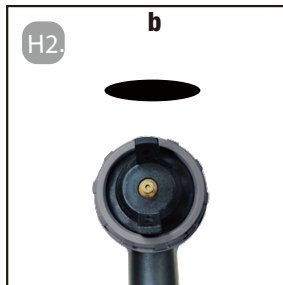
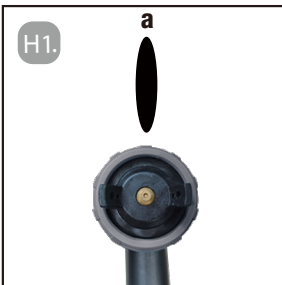

6. Flow rate adjustment

The flow volume of the material is adjusted by turning the flow rate adjustment dial (2). (See Fig. I)

" + " Rotate anticlockwise: reduce the rate of flow

" - " Rotate clockwise : increase the rate of flow

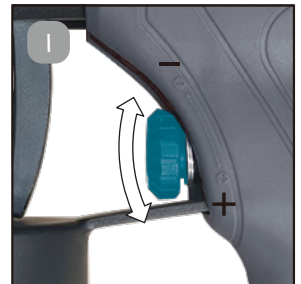

7. Spray technology

- 1) The intended surface should be smooth and clean. And the surface must be pretreated and dust-free.
- 2) Surfaces not to be sprayed should be covered with tape and newspaper.
- 3) It is important to perform a test on cardboard or a similar surface spray sample to find the right paint sprayer setting for your required paint job.

Correct directional length

Hold the paint sprayer at straight distance of about 5 -15 cm from the object being sprayed. (See Fig. J1)

Incorrect

Do not spray as showing in Fig. J2. This will cause overspray and make the surface spray uneven.

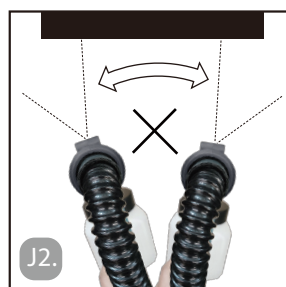
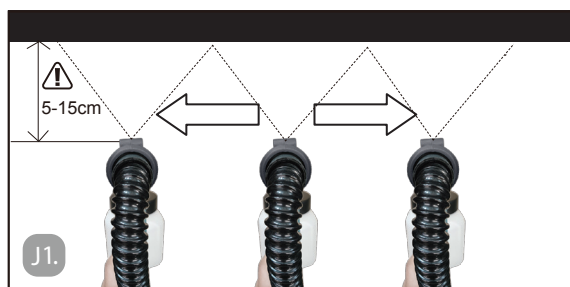

Note: It is necessary to clean the nozzle (10) and air cap (9), to avoid buildup. Both parts can be cleaned with solvents or water. (See Fig. J3) Clean both parts after each use.

8. Work stoppages

- 1) Switch off the paint sprayer by pressing on the "O" on the on / off switch (5).
- 2) Return the paint sprayer (3) to the paint sprayer holder (6).

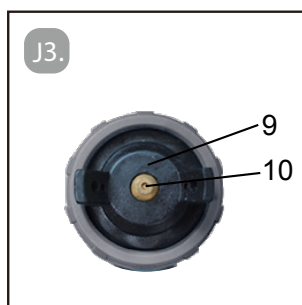

Maintenance

Remove the plug from the socket before carrying out any adjustment, servicing or maintenance.

If the supply cord is damaged, a special cord or assembly available from the manufacturer or its service agent must replace it.

Always remember to disconnect the plug from the socket before cleaning the paint sprayer (3) or paint pot (7), it is essential that the paint sprayer (3) is cleaned thoroughly after every use.

Failure to clean it will almost certainly result in blockages and it may not operate when you next come to use it.

- 1) Switch off the paint sprayer. Press the trigger (1), so that the coating material in the paint sprayer passes back into the paint pot (7).
- 2) Unscrew the paint pot (7). Empty the remaining coating material.
- 3) Clean paint pot (7) and paint draw tube with a brush.
- 4) Screw the paint pot (7). Always keep paint pot (7) seal free of paint residue and check for damage.
- 5) Clean paint sprayer (3) and paint pot (7) exterior with a cloth soaked in solvent and water.

Note: Never clean the nozzle (10) or 1.8m high flex hose (4) in the paint sprayer (3) with sharp metal objects.

6) Warranty is void if the paint sprayer has not been cleaned and maintained after each use.

Troubleshooting

Problem	Cause	Remedy
No coating material come out from nozzle (10)	Nozzle (10) clogged	Clean
	Paint draw tube (17) clogged	Clean
	Small holes on the paint draw tube (17) pipe clogged	Clean
	Flow setting is at min level	Rotate the flow rate adjustment dial (2) clockwise
	Paint draw tube (17) loose	Tighten the paint draw tube (17)
	Paint pot (7) loose	Tighten the paint pot (7)
	The viscosity is too high	Dilute accordingly
Dripping coating material at nozzle (10)	Nozzle (10) loose	Tighten nozzle (10)
	Worn nozzle	Replace
	Coating material accumulated at air cap (9) and nozzle (10)	Use the nozzle cleaning needle (14) to clear the nozzle (10) and the cap collar (11).
Spray too thick	The viscosity is too high	Dilution
	Flow setting is at max level	Rotate the flow rate adjustment dial (2) anticlockwise
	Too little pressure in the paint pot (7)	Tighten the paint pot (7)

650 W Paint Sprayer

Spray unstable	Too little coating material in paint pot (7)	Add more coating material
Drips in spray	Flow setting is at max level	Rotate the flow rate adjustment dial (2) anticlockwise

For further inquiries or issues associated with your 650W Paint Sprayer, call our Customer Service on 1300 889 028 or email us at info.aldi@positecgroup.com

Warranty

Your new FERREX® 650W Paint Sprayer will more than satisfy your expectations. It has been manufactured under stringent FERREX®. Quality standards to meet superior performance criteria.

You will find your new 650W Paint Sprayer easy and safe to operate, and, with proper care, it will give you many years of dependable service.

CAUTION. Carefully read through this entire instruction manual before using your new FERREX® 650W Paint Sprayer.

Take special care to heed the Cautions and Warnings.

Your FERREX® 650W Paint Sprayer has many features that will make your job faster and easier. Safety, performance, and dependability have been given top priority in the development of this FERREX® 650W Paint Sprayer, making it easy to maintain and operate.

Use only FERREX® replacement parts for your product.

Non-conforming parts or modifications made to parts will void your warranty.

Environmental protection



Recycle unwanted materials instead of disposing of them as waste. All tools, hoses and packaging should be sorted, taken to the local recycling centre and disposed of in an environmentally safe way.

What your 3 year warranty means

Great care has gone into the manufacture of this product and it should therefore provide you with years of good service when used properly. In the event of product failure within its intended use over the course of

650 W Paint Sprayer

the first 3 year after the date of purchase, we will remedy the problem as quickly as possible once it has been brought to our attention. In the unlikely event of such an occurrence, or if you require any information about the product please contact us via our after sales support services, details of which can be found in this manual and on the product itself. After Sales Support TEL: 1300 889 028 or email: info.aldi@positecgroup.com

Service support

If you have any issues with the operation of your product, please call us 1300 889 028 for advice, or email us at info.aldi@positecgroup.com

Technical specifications

Rated voltage	220-240V~50/60Hz
Power consumption	650W
Max air volume flow	600ml/min
Max viscosity	100DIN s'
1.8m High flex hose length	1.8m
Tank capacity	800ml
Spraying pressure	0.1-0.2bar
Product dimensions	395*125*315 mm
Protection degree	□ / II
Machine weight	1.82 kg

This 650W Paint Sprayer complies with the following standards:

Safety:	AS/NZS 62841.1
EMC:	AS CISPR 14.1

Accessories and after sales parts

Accessories and after sales parts are available for purchase by visiting <https://help.tools/> or calling our customer service hotline on: 1300 889 028



1. Viscosity Cup:
PRG650G-VC



2. Shoulder Strap:
PRG650G-SS



3. Nozzle Cleaning
Needle:
PRG650G-NCN



4. Nozzle Assembly:
PRG650G-NA



5. Paint Pot:
PRG650G-PP



6. High Flex Hose:
PRG650G-HFH



7. Paint Sprayer
Head:
PRG650G-PSH

This is a blank page



ALDI guarantees that our exclusive brand products are developed to our stringent quality specifications. If you are not entirely satisfied with this product, please return it to your nearest ALDI store, within 60 days from the date of purchase, for a full refund or replacement, or take advantage of our after sales support by calling the supplier's Customer Service Hotline.



Made in China

FERREX® is a registered trademark of ALDI Stores

DISTRIBUTED BY:

ALDI STORES

1 SARGENTS ROAD

MINCHINBURY NSW 2770

www.aldi.com.au

AFTER SALES SUPPORT



1300 889 028 (toll free)

e-mail: info.aldi@positcgroup.com

MODEL: PRG650G • 03/2022 • 708345

3

YEAR WARRANTY