



# User Manual



## 50752 1200W LAWN EDGER



Read all safety warnings and all instructions thoroughly before operating this product.

Ensure you keep your manual in a safe place for future reference.

IM ed2; 08/2017

Product Info

A square QR code is located in the center of the Product Info box.

+ VIDEO

[www.powertoolsupport.com](http://www.powertoolsupport.com)

## QR codes take you where you want to go quickly and easily

Whether you require product information, spare parts or accessories, details on warranties or aftersales service, or if you want to watch a product demonstration video, our QR codes will take you there in no time at all.

### What is a QR code?

A QR-code (QR=Quick Response) is a type of matrix that can be read with a smartphone camera and that contains a link to a website or contact details, for example.

Advantage: You are not required to manually enter a website address or contact details.

### How it works

To scan the QR code, all you need is a smartphone with QR codes reader software and an Internet connection\*. This type of software can be downloaded for free from your smartphone's app store.

### Try it out now

Just scan the QR code with your smartphone and find out more about the Aldi product you have purchased\*.



\* Depending on your tariff you may be charged for the connection.

For Know How Videos, click on the "Product Assistance" tab, then the "How To Product Videos" link.

## Contents

<b>Pack Contents / Parts</b>	<b>2</b>
<b>Contents of Carton</b>	<b>2</b>
<b>Intended use of the 1200W Lawn Edger</b>	<b>2</b>
<b>Description of Symbols</b>	<b>3</b>
<b>Safe Operating Practises</b>	<b>4</b>
<b>General Safety Warnings</b>	<b>6</b>
<b>Additional Safety Rules for Lawn Edgers</b>	<b>9</b>
<b>Parts List</b>	<b>10</b>
<b>Assembling the Upper and Lower Shaft</b>	<b>12</b>
<b>Assembling the Auxiliary Handle</b>	<b>14</b>
<b>Setting the Edge Guide</b>	<b>15</b>
<b>Setting the Cutting Depth</b>	<b>16</b>
<b>Cord Routing / Cord Restraint</b>	<b>17</b>
<b>Operation of the Lawn Edger</b>	<b>18</b>
<b>Edging</b>	<b>18</b>
<b>Edging Tips</b>	<b>18</b>
<b>Landscaping</b>	<b>19</b>
<b>Trenching</b>	<b>19</b>
<b>Cleaning Chamber Guard</b>	<b>19</b>
<b>Maintenance</b>	<b>20</b>
<b>Safety / Deterioration Check</b>	<b>20</b>
<b>Changing the Blade</b>	<b>21</b>
<b>Cleaning and Maintenance</b>	<b>22</b>
<b>Warranty</b>	<b>22</b>
<b>What your 3 Year Warranty means</b>	<b>23</b>
<b>Service Support</b>	<b>23</b>
<b>Accessories</b>	<b>23</b>
<b>Troubleshooting</b>	<b>24</b>
<b>Recycling</b>	<b>25</b>
<b>Technical Specifications</b>	<b>25</b>

## Pack contents / parts

Congratulations on the purchase of your Gardenline® 1200W Lawn Edger. When you open your packaging, first remove all items and check there are no parts damaged or missing. If you find anything wrong, do not operate the product until the parts have been replaced or the fault has been rectified. Failure to do so could result in serious personal injury.

### Intended use of the 1200W Lawn Edger

**NOTE:** This product is for private domestic DIY use only. It is not suitable for commercial or trade use.

This Lawn Edger is ideal for traditional hard surface edging along driveways, sidewalks as well as landscaping tasks around the lawn. By raising the edge guide, the edger can be used in the garden for such tasks as shaping borders, around trees and flowerbeds.

**NOTE:** First time users or inexperienced operators pay particular attention to the operation of the Edger, including details of starting and stopping and correct use of the Edger on pages 16-19, as well as the maintenance instructions on pages 19-21.

### Contents of carton

- 1 x Lawn Edger
- 1 x Blade Spanner
- 1 x Auxiliary Handle Assembly (includes handle, locking knob, & bolt)
- 1 x Upper Shaft Locking Knob (with short screw)
- 1 x Lower Shaft Locking Knob (with long screw)
- 1 x Instruction Manual
- 1 x Warranty Card & details
- 1 x Quick Start Guide

## Description of symbols

The instruction manual or rating plate on your product may show symbols. These represent important information about the product or instructions on its use.



Conforms to relevant standards for electrical safety and electromagnetic compatibility.



This edger is double insulated. There are two independent barriers of insulation to protect you from the possibility of electric shock.



Wear hearing protection, eye protection and breathing protection.



Wear safety footwear.



Wear safety gloves.



Warning.



Read these instructions for use carefully.



Use at a distance of at least 15m from other people.



Thrown objects and rotating line can cause severe injury. Do not operate the unit without the safety guard in place. Keep away from rotating cutter.



Rotating cutting blade.



Direction of edger blade rotation.



Disconnect the mains plug if the cord is damaged or entangled.



Sharp blade, do not touch.



Do not put in water.

## Safe operating practices

### IMPORTANT: READ CAREFULLY BEFORE USE

#### KEEP FOR FUTURE REFERENCE



**WARNING.** When using the machine the safety rules must be followed. For your own safety and bystanders please read these instructions before operating the machine. Please keep the instructions safe for later use.

#### SAVE THESE INSTRUCTIONS

This appliance is not intended for use by persons (including children) with reduced physical, sensory or mental capabilities, or lack of experience and knowledge, unless they have been given supervision or instruction concerning use of the appliance by a person responsible for their safety. Children should be supervised to ensure that they do not play with the appliance.

If the supply cord is damaged, it must be replaced by the manufacturer, its service agent or similarly qualified persons in order to avoid a hazard.

### Safe operating practices

#### Training

- Read the instructions carefully. Be familiar with the controls and the proper use of the machine.
- Never allow people unfamiliar with these instructions or children to use the machine. Local regulations can restrict the age of the operator.
- Keep in mind that the operator or user is responsible for accidents or hazards occurring to other people or their property.

#### Preparation

- Before use, check the supply and extension cord for signs of damage or aging. If the cord becomes damaged during use, disconnect the cord from the supply immediately. **DO NOT TOUCH THE CORD BEFORE DISCONNECTING THE SUPPLY.** Do not use the appliance if the cord is damaged or worn.

- Never operate the machine while people, especially children, or pets are nearby.
- Wear eye protection and covered shoes at all times while operating the machine.

#### Operation

- Keep supply and extension cords away from the blade / cutting parts.
- Use the machine only in daylight or good artificial light.
- Never operate the machine with damaged guards or shields or without guards or shields in place.
- Switch on the motor only when the hands and feet are away from the blade / cutting parts.
- Always disconnect the machine from the power supply: Whenever leaving the machine unattended and before clearing a blockage, before checking, cleaning or working on the machine, after striking a foreign object and whenever the machine starts vibrating abnormally.
- Take care against injury to feet and hands from the cutting means.
- Always ensure that the ventilation openings are kept clear of debris.

#### Maintenance and storage

- Disconnect the machine from the power supply before carrying out maintenance or cleaning work.
- Use only the manufacturer's recommended replacement parts and accessories.
- Inspect and maintain the machine regularly. Have the machine repaired only by an authorized repairer.
- When not in use store the machine out of the reach of children.

#### Recommendation

- The appliance should be supplied via a residual current device (RCD) with a tripping current of not more than 30 mA.

## General safety warnings



**WARNING! Read all safety warnings and all instructions.** Failure to follow the warnings and instructions may result in electric shock, fire and/or serious injury.

The word **power tool** used in the following warnings and throughout this manual refers to both electrical power tools and also petrol driven power tools.

This unit may not be used by people (including children) with reduced physical, sensory or mental capacities, with a lack of experience and without the appropriate knowledge, unless they are supervised by someone who is responsible for their safety or have been instructed by such a person with regard to how the unit is to be operated. Children should be supervised to ensure that they do not play with the device.

**Save all warnings and instructions for future reference**

### 1. Work area safety

- a. **Keep work area clean and well lit.** Cluttered or dark areas invite accidents. Rags, cloths, cord, string and similar items should never be left around the work area.
- b. **Do not operate power tools in explosive environments, such as in the presence of flammable liquids, gases, or dust.** Power tools create sparks, which may ignite the dust or fumes.
- c. **Keep children and bystanders away while operating a power tool.** Distractions can cause the operator to lose control.

### 2. Electrical safety

- a. **Power tool plugs must match the outlet. Never modify the plug in any way.** Do not use any adapter plugs with grounded power tools. Unmodified plugs and matching outlets will reduce risk of electric shock.
- b. **Avoid body contact with grounded surfaces such as pipes, radiators, ranges and refrigerators.** There is increased risk of electric shock if your body is grounded.
- c. **Do not expose power tools to rain or wet conditions.** Water entering a power tool will increase the risk of electric shock.

- d. **Do not abuse the cord.** Never use the cord for carrying, pulling or unplugging the power tool. Keep cord away from heat, oil, sharp edges or moving parts. Replace damaged cords immediately. Damaged or entangled cords increase the risk of electric shock.
- e. **When operating a power tool outdoors, use an extension cord suitable for outdoor use.** Use of a cord suitable for outdoor reduces the risk of electric shock.
- f. **To reduce the risk of electric shock, the manufacturer recommends the use of a residual current of 30mA or less at all times.**

### 3. Personal safety

- a. **Stay alert, watch what you are doing and use common sense when operating a power tool.** Do not use a power tool while you are tired or under the influence of drugs, alcohol or medication. A moment of inattention while operating power tools may result in serious personal injury.
- b. **Use personal protective equipment. Always wear eye protection.** Protective equipment such as dust mask, non-skid safety shoes, hard hat, or hearing protection will reduce personal injuries.
- c. **Prevent unintentional starting.** Ensure the switch is in the "off" position before connecting to power source and/or battery pack, picking up or carrying the tool. Carrying power tools with your finger on the switch or energising power tools that have the switch on invites accidents.
- d. **Remove any adjusting key or wrench before turning the power tool on.** A wrench or key left attached to a rotating part of the power tool may result in personal injury.
- e. **Do not overreach.** Keep proper footing and balance at all times. This enables better control of the power tool in unexpected situations.
- f. **Dress properly. Do not wear loose clothing or jewellery.** Keep your hair, clothing and gloves away from moving parts. Loose clothes, jewellery or long hair can be caught in moving parts.
- g. **If devices are provided for the connection of dust extraction and collection facilities, ensure these are connected and properly used.** Use of dust collection can reduce dust-related hazards.

## General safety warnings

### 4. Power tool use and care

- a. **Do not force the power tools.** Use the correct power tool for your application. The correct power tool will do the job better and safer at the rate for which it was designed.
- b. **Do not use the power tool if the switch does not turn it “on” and “off”.** Any power tool that cannot be controlled with the switch is dangerous and must be repaired.
- c. **Disconnect the plug from the power source and/or the battery pack from the power tool before making any adjustments, changing accessories, or storing power tools.** Such preventive safety measures reduce the risk of starting the power tool accidentally.
- d. **Store idle power tools out of the reach of children and do not allow persons unfamiliar with the power tool or these instructions to operate the power tool.** Power tools are dangerous in the hands of untrained users.
- e. **Maintain power tools with care.** Check for misalignment or binding of moving parts, breakage of parts and any other condition that may affect the power tool's operation. If damaged, have the power tool repaired before use. Many accidents are caused by poorly maintained power tools.
- f. **Keep cutting tools sharp and clean.** Properly maintained cutting tools with sharp cutting edges are less likely to bind and are easier to control.
- g. **Use the power tool, accessories and tool bits etc. in accordance with these instructions, taking into account the working conditions and the work to be performed.** Use of the power tool for operations different from those intended could result in a hazardous situation.
- h. **This appliance is not intended for use by persons (including children) with reduced physical, sensory or mental capabilities, or lack of experience and knowledge,** unless they have been given supervision or instruction concerning use of the appliance by a person responsible for their safety.

- i) Children should be supervised to ensure that they do not play with the appliance.

### 5. Service

- a. Have your power tool serviced by a qualified repair person using only identical replacement parts. This will ensure that the safety of the power tool is maintained.

### Additional Safety Rules for Lawn Edgers.

- Remove loose bracelets or similar jewellery from your wrist whenever operating edgers or similar equipment.
- Before switching on always ensure that the blade and guard function correctly and that they are free of any damage. A cracked blade or guard must be replaced before operating the tool.
- Do not use edger in the rain, or trim edges when they are wet.
- The edger is a major appliance and should not be operated with other major appliances on the same household circuit.
- Keep extension cord clear of operator, unit and any obstacles at all times. Do not expose the cord to heat, oil, water, or sharp edges.
- Switch off and remove the plug from the 'socket-outlet' if the flexible cord becomes entangled or before adjusting or cleaning the edger.
- When making any adjustments to the tool always wait for the blade to come to a complete stop and unplug the tool.
- Never attempt to unclog the blade chamber by tapping the tool on the ground, this can damage the unit.
- Keep hands clear of edge guide and blade when cleaning as these wear to a very sharp point during edging.
- Before landscaping or trenching, inspect and ensure there are no exposed or buried cables or pipes or other objects that may create a hazard or interfere with operating the edger.
- Set depth to only that required for the job, do not overload. If tool slows, pull back slightly and wait until blade returns to normal speed.
- Never hang the edger by the power cord.
- Only use extension cords intended for outdoor use.



- Wear goggles
- Wear earmuffs
- Wear a breathing mask

**Parts List**

1. Handle
2. Trigger switch
3. Safety lock button
4. Cord restraint hook
5. Auxilliary handle
6. Auxilliary handle locking knob
7. Upper shaft
8. Upper shaft locking knob
9. Lower shaft
10. Lower shaft port
11. Lower shaft locking knob
12. Edge guide lever
13. Motor housing
14. Blade guard
15. Guard lock knob
16. 190mm serrated blade
17. Blade lock nut
18. Outer blade flange
19. Inner blade flange
20. Rear wheel (not shown)
21. Height adjustment knob
22. Guide wheel
23. Edge guide
24. Blade spanner

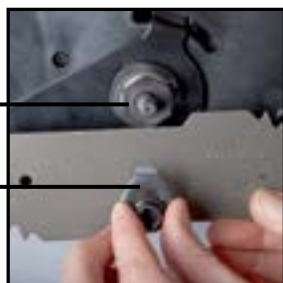
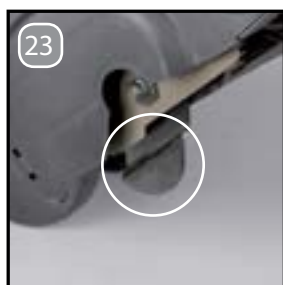

## Assembly Of Edger

The edger must be fully assembled in the correct order before use.

**Note:** Before assembling please discard the protective packaging.

Remove the components from the plastic bag containing the shaft components and assembly screws and locking knobs contained (1 x Upper Shaft Locking Knob with short screw & 1 x Lower Shaft Locking Knob with long screw).

To ensure correct operation the lower shaft (9) must be assembled into the lower shaft port (10) first.

**IMPORTANT:** Do not connect upper shaft until directed.

### Assembling the Lower Shaft into the Lower Shaft Port

1. Insert the lower shaft (9) into the edger lower shaft port (10) at the back of the edger (A2). Ensure the cabling remains inside the tube.
2. Align the holes and insert the longer supplied screw through the shaft. (Fig B)
3. Use the lower shaft locking knob to secure the lower shaft into position. Secure until finger tight. (Fig C)

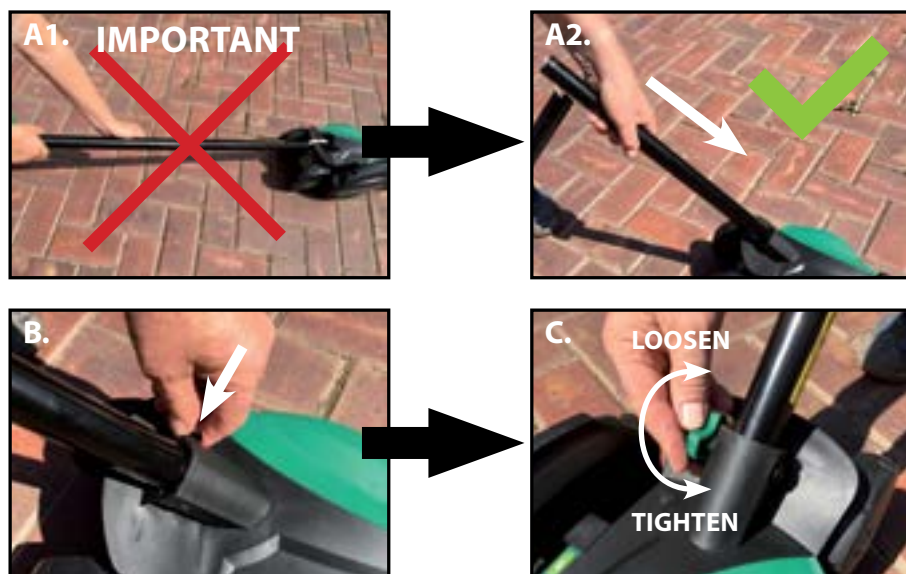

## Connecting Upper Shaft to Lower Shaft

1. Slide the upper shaft (7) over the lower shaft (9) whilst aligning the holes. (Fig D1/D2)
2. Insert the shorter supplied screw through the holes (Fig E), and then use the upper shaft locking knob (8) to hold into position by securing finger tight. (Fig F)

The edger also has stickers advising what order to connect the components:

**Note:** If you have inadvertently assembled the upper shaft (7) and lower shaft (9) before assembling the lower shaft (9) into the lower shaft port (10), the product will not assemble. To resolve this simply pull apart the upper (7) and lower shafts (9) and follow the previous procedure detailed to correctly assemble.

**IMPORTANT:** At all times ensure the inner cable is comfortably inside the product connections. Try to avoid pulling or pushing aggressively.

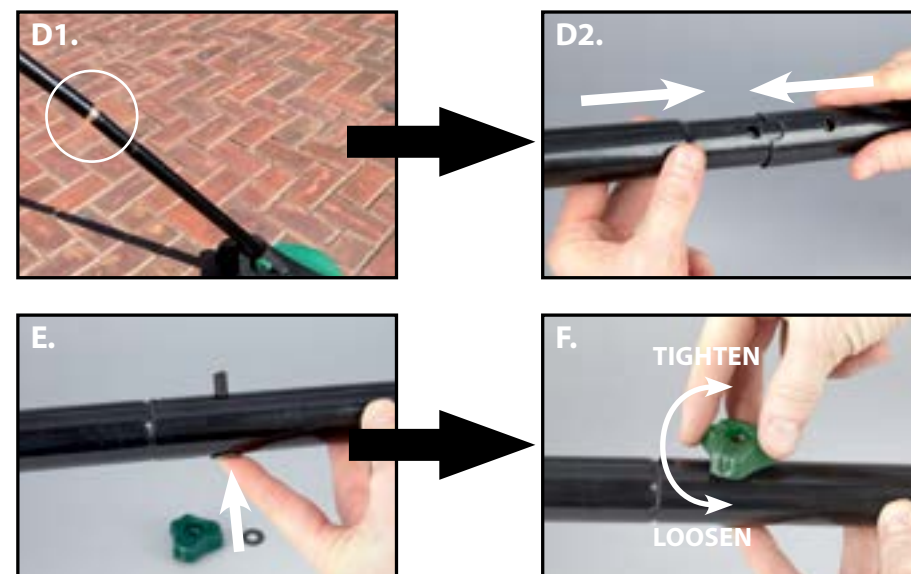
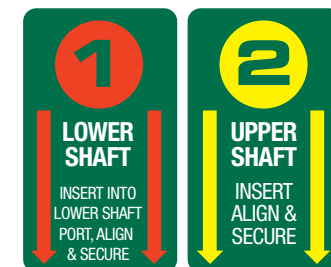



## Assembling the Auxiliary Handle

1. Remove the auxiliary handle locking knob (6) and bolt from the auxiliary handle (5).
2. Fit the auxiliary handle (5) onto the upper handle and rotate to choose the position most suitable to the operator. (Fig G)
3. Insert the bolt through the handle (Fig H), and then tighten by applying the washer and the auxiliary handle locking knob (6) over the bolt that has fed through the opposite side. Secure until finger tight.

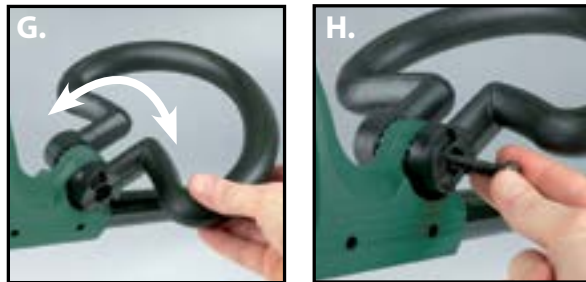

## Setting the Edge Guide

The edge guide (23) is used when edging is required against a solid material like a paved surface. It is important to ensure the edge guide is used in these conditions as the edge guide will assist in preventing the blade from making direct contact with the paved surface.

1. Position the edger so that the front wheel is approximately 15cm up from the ground and resting on the back wheels. (Fig I)
2. To set the edge guide (23) in the down position, move the edge guide lever (12) out away from the blade guard (14) where it rests in the notch. Move it towards the back wheels and push into the notch to lock it into the down position. (Fig J)
3. To set the edge guide (23) in the up position, move the edge guide lever (12) out away from the blade guard (14) from where it rests in the notch. Move it towards the front wheel and push into the notch to lock it into the up position. (Fig K)



DOWN

UP

## Setting the Cutting Depth

The cutting depth of the edger can be altered to one of 3 settings to a Max of 38mm. (25mm, 31mm, 38mm)

1. To adjust the cutting depth, loosen the height adjustment knob (21) approx 5–6 full turns, but do not remove it from the screw. (Fig L)
2. Push the height adjustment knob (21) fully towards the body of the edger whilst at the same time pushing the guide wheel (22) arm in the same direction towards the blade guard (14). (Fig M)
3. Raise or lower the arm to the desired cutting depth by aligning the notch on the radial arm with one of the 3 cutting depth holes (Fig N), and then pull the height adjusting knob (21) outwards to secure the the chosen cutting depth. (Fig O)
4. Tighten the knob until all of the slack is taken out of the assembly. Check to ensure the guide wheel arm has located into one of the pre allocated cutting depth positions and the head of the bolt securing the front wheel arm is sitting flat on the surface of the wheel arm.

Firmly tighten the height adjustment knob (21). (Fig O)

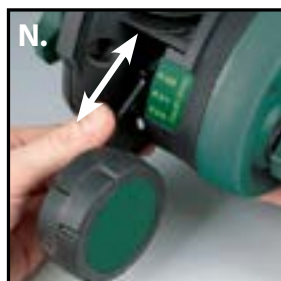
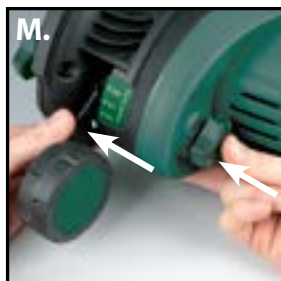

## Cord routing

Always make sure that you route the cord away from the work area to prevent it from coming near the blade of the edger. Lay your cable route before starting work.

Start your edger at the point nearest to the electrical socket, and then move away whilst working. This will mean that the cord will be pulled through the area that has already been cut, thereby keeping it out of danger of being cut through by the blade.



## Cord Restraint

This edger is fitted with a cord restraint to prevent the power cable from both being disconnected and also to prevent excessive strain on the connecting plugs during use.

It is recommended the cord restraint is used as follows:

1. Approx 300mm from the end of the extension cable, form a tight loop in the extension cable, and feed the loop through the hole above the cord restraint hook (4).
2. Secure the loop over the cord restraint hook (4) to prevent the cable pulling back through the hole. (Fig P)

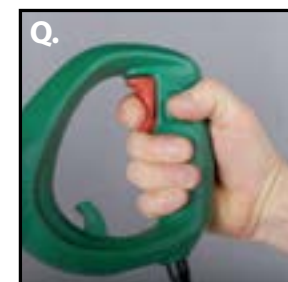

## Operation of the Lawn Edger

### Switching On and Off

This lawn edger is fitted with a lock off button to prevent accidental operation.

1. To start the edger, push in the side safety lock button (3) and then depress the trigger switch (2) fully. (Fig Q)
2. To stop the edger, release the trigger switch (2).

**NOTE:** Take care when turning the edger "On" that the cutter is in a safe position to operate.



## Edging

1. Set the cut depth at 25mm and set edge guide lever (12) to the down position.
2. The guard incorporates a raised rib section which acts as a blade cut indicator. This rib will assist in guiding the operator where the blade will cut. (Fig S). During operation the operator can sight down the rib of the guard to where the edge is to be cut.



3. Before starting the edger, line up the edger so the edge guide (23) rests against the edge of the paved surface. Both rear wheels should be on the paved surface when edging.



**NOTE:** When there is heavy overgrowth of grass over the paved surface it may drag on the guard. An initial cut may be required with the edger on the grass side. This will require lifting up the edge guide (23) and may require reducing the depth of cut.

4. To avoid kickback of the edger, tilt the handle down so the blade is above the ground. (Fig T)
5. Turn the edger on and allow the blade to spin without moving the edger.
6. Slowly raise the handle to lower the blade, finding the edge of the paved surface and start edging. Then move forward slowly along the edge of the paved surface, keeping the edge guide (23) pressed lightly against the pavement edge.

### Edging Tips:

- For the first edging each season, it is best to move forward slowly as grass is thickest then. Subsequent edging will be completed more rapidly.
- If the edger slows down, back it up slightly until the blade returns to normal speed.
- During edging some sparks may be generated from hitting stones: this is normal. Do not attempt to edge when the grass or soil is wet or moist; both for electrical safety and to prevent clogging of the blade chamber.

## Landscaping / Trenching

Before landscaping or trenching, inspect and ensure there are no exposed or buried cables or pipes or other objects that may create a hazard or interfere with operating the edger. Lift the edge guide (23) for all trenching. Set the depth to only that required for the job. Do not overload. If the edger slows, pull back slightly and wait until the blade returns to normal speed.

### Cleaning the Guard Chamber

**WARNING:** Ensure the edger is switched off and is disconnected from mains power before undertaking this task.

After each use the blade guard chamber should be cleared of dirt and grass build-up, to maintain cutting efficiency.

1. Undo the guard lock knob (15) and open the blade guard (14). (Fig U/V)
2. Use a stick or screw driver to clean all debris build up in the guard chamber. (Fig W)
3. When the debris are removed, close the blade guard (14) and ensure the guard lock knob (15) is tightened.

**NOTE:** Edging of heavily overgrown edges and damp soils can create greater build-up of difficult to remove waste. It may be necessary to remove the bulk of this material using a long thin implement (ie. screwdriver).

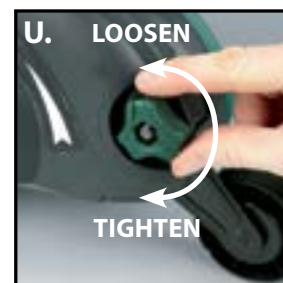

## Maintenance

**NOTE:** This product is not suitable for repair or maintenance work by the unskilled person. The following detail explains how the blade is changed, how the product is cleaned, and basic maintenance / safety checks. All other maintenance work must be carried out by service agents who are experienced with both the mechanical and electrical aspects of this product.

### Safety / Deterioration Check

Any of the following faults found should be investigated and repaired by a qualified service agent or a similarly qualified person in order to avoid hazard:

- Prior to each use or during the cleaning operation check the following with the 240V ac mains power DISCONNECTED from the product.
- Check the guard is firmly mounted and the swing door locates, closes and locks correctly.
- Check the guard is not cracked or fractured.

The following checks should be made with the 240V ac mains supply connected:

- BE AWARE and take precautions as the blade will rotate under some of the checks. Tests should be made on soft ground with the blade clear of the ground.
- Gently depress the trigger switch (2) without the safety lock button (3) being depressed. The product should not start. (Do Not use the product if the unit starts without the safety lock button (3) not pressed).
- Press the safety lock button (3) and the trigger switch (2) to start the edger. Release the trigger switch (2). The unit MUST stop. If the unit fails to stop, remove the plug from the 240V ac mains supply. (DO NOT use the product in this condition).
- On start up, the motor and the blade rotation should be an even growling noise. If there is a grinding, or squealing noise, or uneven speed, turn off the edger, disconnect and have the unit serviced by a qualified service agent or a similarly qualified person in order to avoid hazard.

The following faults, if found, can be corrected by the owner of the edger, unless the fault requires disassembly, which must be performed by a qualified service agent or a similarly qualified person in order to avoid hazard.

- Check the wheels freely turn without binding.
- Check the height adjustment is fully located and firmly clamped by the height adjustment knob (21).
- Check there is no build up of grass around the spindle.
- Check the blade size and cutting edge of the blade. Replace the blade if necessary per the instructions to follow.

## Changing the Blade

 **WARNING:** Ensure the edger is switched off and is disconnected from mains power before undertaking this task.

1. Loosen and remove the guard lock knob (15) and open the blade guard (14). (Fig U/V)
2. Place the supplied blade spanner (24) over the outer blade flange (18) to hold it in position, and then use a 14mm spanner (not included) to remove the blade lock nut (17) in an anti-clockwise direction. (Fig X)
3. Remove the blade lock nut (17), outer blade flange (18) and the 190mm serrated blade (16), and ensure the spindle and inner flange (19) are clean of any dirt, etc. (Fig Y)
4. Fit the new 190mm serrated blade (16) then the outer blade flange (18), then the blade lock nut (17). Using the supplied blade spanner (24) to hold the outer blade flange in position, tighten the blade lock nut (17) using a 14mm spanner in a clockwise direction. (Fig X)
5. When the 190mm serrated blade (16) is secure, rotate it by hand to ensure the blade is not making contact with any components of the edger. (Fig Z)
6. Close the blade guard (14), and finger tighten the guard lock knob (15). (Fig U)

**NOTE:** Blade wear is expected whenever you use your edger. Blades wear quite quickly when edging along concrete paths. This does not affect the efficiency of the edger and is expected due to the aggressive abrasion of concrete on steel.

Blades should be replaced when they become worn and no longer edge the grass cleanly.

Replacement blades are available for purchase from our website [www.extrabattery.com.au](http://www.extrabattery.com.au) or by calling 1800 909 909.



## Cleaning and Maintenance



**WARNING:** Use only mild soap and a damp cloth to clean the edger. Never allow any liquid to get inside the edger, never immerse any part of the tool into a liquid.

### Preventing Corrosion

Fertilizers and other garden chemicals contain agents that greatly accelerate the corrosion of metals. If you use the edger in areas where fertilizers or chemicals have been used, the edger should be cleaned immediately afterwards. Wipe all exposed parts with a damp cloth. You may lubricate only metal parts with a light petroleum based oil. When cleaning, never immerse in water or squirt it with a hose.

### General inspection

Regularly check that all the fixing screws are tight. They may vibrate loose over time.

### Repairs

If the supply cord is damaged or worn it must be replaced by an authorised service agent or a similarly qualified person in order to avoid hazard.

A listing of our service agents can be found at [www.powertoolsupport.com](http://www.powertoolsupport.com), then click on the "Service Agent" link.

### Warranty

Your new Gardenline® 1200W Lawn Edger will more than satisfy your expectations. It has been manufactured under stringent Gardenline® Quality Standards to meet superior performance criteria.

You will find your new 1200W Lawn Edger easy and safe to operate, and, with proper care, it will give you many years of dependable service.

**CAUTION.** Carefully read through this entire instruction manual before using your new Gardenline® 1200W Lawn Edger.

Take special care to heed the Cautions and Warnings.

Your Gardenline® 1200W Lawn Edger has many features that will make your job faster and easier. Safety, performance, and dependability have been given top priority in the development of this 1200W Lawn Edger, making it easy to maintain and operate.

## What your 3 year warranty means

Great care has gone into the manufacture of this product and it should therefore provide you with years of good service when used properly.

In the event of product failure within its intended use over the course of the first 3 years after the date of purchase, we will remedy the problem as quickly as possible once it has been brought to our attention. In the unlikely event of such an occurrence, or if you require any information about the product please contact us via our after sales support services, details of which can be found in this manual and on the product itself. After Sales Support TEL: 1800 909 909

### Service Support

If you have any issues with the operation of your product, please take it with a copy of your receipt to one of our National Service Agents for repair. A listing of our Service Agents is included with your product, however, you can also find our most updated listing by visiting [powertoolsupport.com](http://powertoolsupport.com), and clicking on the Service Agent link. Alternately call us on our Customer Support line, 1800 909 909, for advice or support.

### Accessories and After Sales Parts

Should you find the following accessories are worn or past their user life, replacements can be purchased online via our website [www.extrabattery.com.au](http://www.extrabattery.com.au)

1. Replacement 190mm Serrated Blade (50752-BL)



If you have any queries regarding these accessories, please call us on our Customer Support Line - 1800 909 909.

## Troubleshooting

Problem	Possible Cause	Solution
Motor fails to start when trigger switch (2) is depressed.	<ul style="list-style-type: none"> <li>• Safety Lock button (3) has not been depressed first.</li> <li>• No Power to the edger.</li> <li>• Internal motor failure or wiring failure.</li> </ul>	<ul style="list-style-type: none"> <li>• Press safety lock button (3) first and then depress the trigger switch (2).</li> <li>• Check the extension cable is plugged into the power source and turned ON.</li> <li>• Check the extension cable is fully inserted and secured to the plug of the edger.</li> <li>• DO NOT USE. Fully disconnect the edger and have the edger serviced by an authorised service centre before further use.</li> </ul>
Extension cable keeps disconnecting from the edger during use.	<ul style="list-style-type: none"> <li>• Extension cord not secured to the edger.</li> </ul>	<ul style="list-style-type: none"> <li>• Secure the extension cable to the edger using the cord restraint hook (4) as detailed on page 16.</li> </ul>
Bad Quality cut from the 190mm serrated blade (16).	<ul style="list-style-type: none"> <li>• 190mm serrated blade (16) is worn.</li> <li>• 190mm serrated blade (16) performance is effected by debris.</li> <li>• 190mm serrated blade (16) is loose.</li> </ul>	<ul style="list-style-type: none"> <li>• Replace with a new 190mm serrated blade (16).</li> <li>• Clean the blade guard chamber but also clear any debris from the ground if possible.</li> <li>• Re tighten the blade lock nut (17).</li> </ul>
Edger wheels not moving forward or backward.	<ul style="list-style-type: none"> <li>• Build up of grass or a lodged small stone.</li> </ul>	<ul style="list-style-type: none"> <li>• Ensure plug is disconnected, and clear grass or any obstruction around the wheels.</li> </ul>
Abnormal noise, ie grinding or squealing during operation.	<ul style="list-style-type: none"> <li>• Build up of dirt, grass or debris in the blade guard (14).</li> <li>• 190mm serrated blade (16) hitting the edge of a hard object. ie Path</li> <li>• Motor or gear box failure.</li> </ul>	<ul style="list-style-type: none"> <li>• Stop and disconnect edger. Open side blade guard (14) and clear any obstruction.</li> <li>• Move away slightly from the rough edge of the concrete or decrease the depth of cut</li> <li>• Stop using the edger and have the edger serviced by an authorised service centre before further use.</li> </ul>
Motor varying in speed	<ul style="list-style-type: none"> <li>• Motor Overloaded.</li> <li>• Motor Failure.</li> </ul>	<ul style="list-style-type: none"> <li>• Reduce the walking speed during the cutting operation.</li> <li>• Reduce the depth of cut.</li> <li>• Turn off the edger, disconnect and have the motor serviced before next use.</li> </ul>
Excessive vibration during use.	<ul style="list-style-type: none"> <li>• Broken 190mm serrated blade (16).</li> <li>• Soil mixed with stone or similar hard objects.</li> <li>• Problem not found.</li> </ul>	<ul style="list-style-type: none"> <li>• Replace with a new 190mm serrated blade.</li> <li>• Suggested to clear hard objects from the soil.</li> <li>• Turn off the edger, disconnect and have the edger serviced before next use.</li> </ul>

For other issues not covered in this chart, please call Customer Service on 1800 909 909.

## Recycling

### Environmental protection

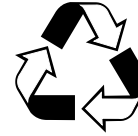

Recycle unwanted materials instead of disposing of them as waste. All tools, hoses and packaging should be sorted, taken to the local recycling centre and disposed of in an environmentally safe way.

### Technical Specifications:

Voltage:	230-240V ~ 50Hz
Input power:	1200 W
No load speed:	4,700 RPM
Depth of cut:	25 mm, 31 mm, 38 mm
Size of blade:	190 mm
Bore size:	13 mm
Weight:	6.5kg
Product Dimensions:	120cm x 26cm x 105cm (LxWxH)

Noise label rating 75dBA (taken at 7.5 metres).

You must wear ear protection at all times.



Conforms to relevant standards for electrical safety and electromagnetic compatibility. Approval Number: GMA-103141-EA-001



This edger is double insulated. There are two independent barriers of insulation to protect you from the possibility of electric shock.

This product complies with AS/NZS 60335.1 :2011+A1:2012 and AS/NZS 60335.2.91:2008 + A1:2009 and is approved under the Australian Electrical Approval GMA 103141-EA – 001

For Electromagnetic Compliance the product complies with EN55014-1:2006/+A1:2009 EN55014-2:1997/+A1:2001+A2:2008



This is a blank page



This is a blank page



ALDI guarantees that our exclusive brand products are developed to our stringent quality specifications. If you are not entirely satisfied with this product, please return it to your nearest ALDI store, within 60 days from the date of purchase, for a full refund or replacement, or take advantage of our after sales support by calling the supplier's Customer Service Hotline.



### **Made in China**

Gardenline® is a registered trademark of ALDI Stores

DISTRIBUTED BY:

ALDI STORES

1 SARGENTS ROAD

MINCHINBURY NSW 2770

[www.aldi.com.au](http://www.aldi.com.au)

#### **AFTER SALES SUPPORT**



 1800 909 909 (toll free)

e-mail: [help@powertoolsupport.com](mailto:help@powertoolsupport.com)

MODEL: 50752 • 08/2017 • 50752

# **3**

**YEAR WARRANTY**