

REV	ECN	DESCRIPTION	BY	APV	DATE
M	-	ADDED #680 TO NOTE 3 WS1816	SKY	JB	12/30/2015
N	2559	REMOVE LOCTITE DRIES FROM NOTE 3. UPDATE TORQUE TOLERANCE.	JS	CA	8/1/2016
P	2782	REPLACE PART 8936 WITH Q8-6511. UPDATE SHEET FORMAT.	RD	CA	3/21/2017

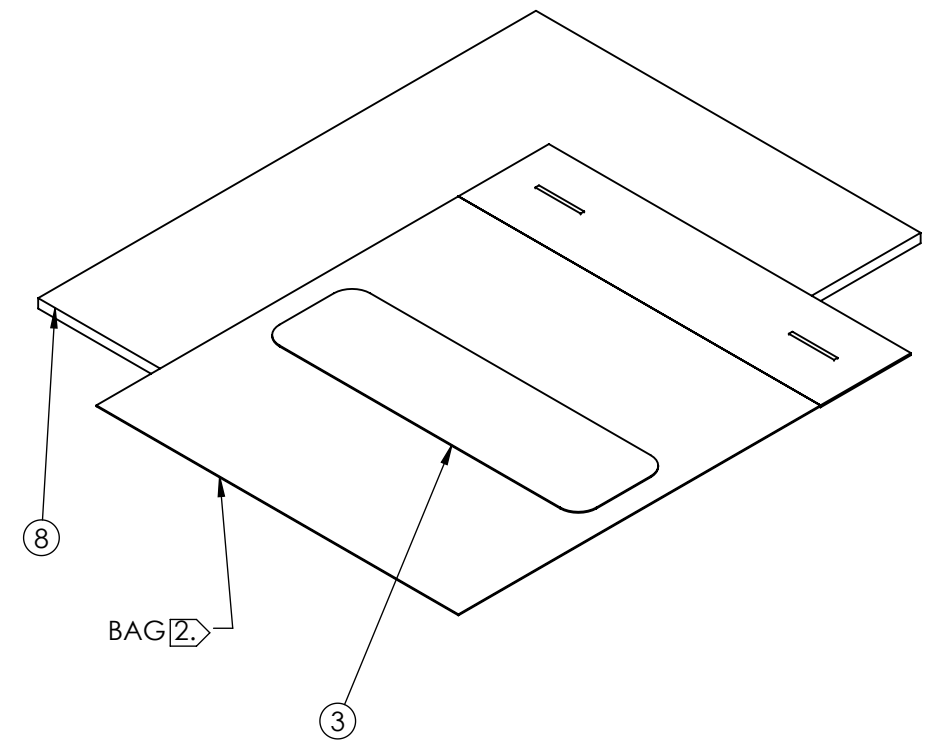
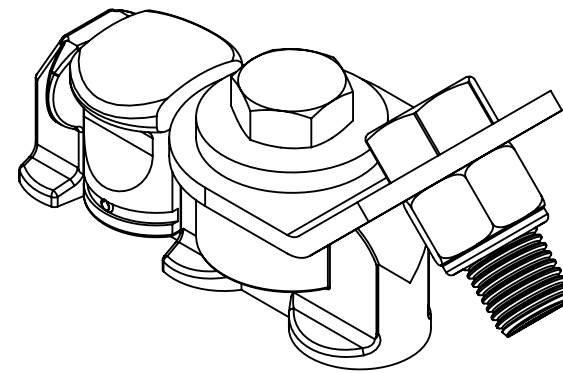
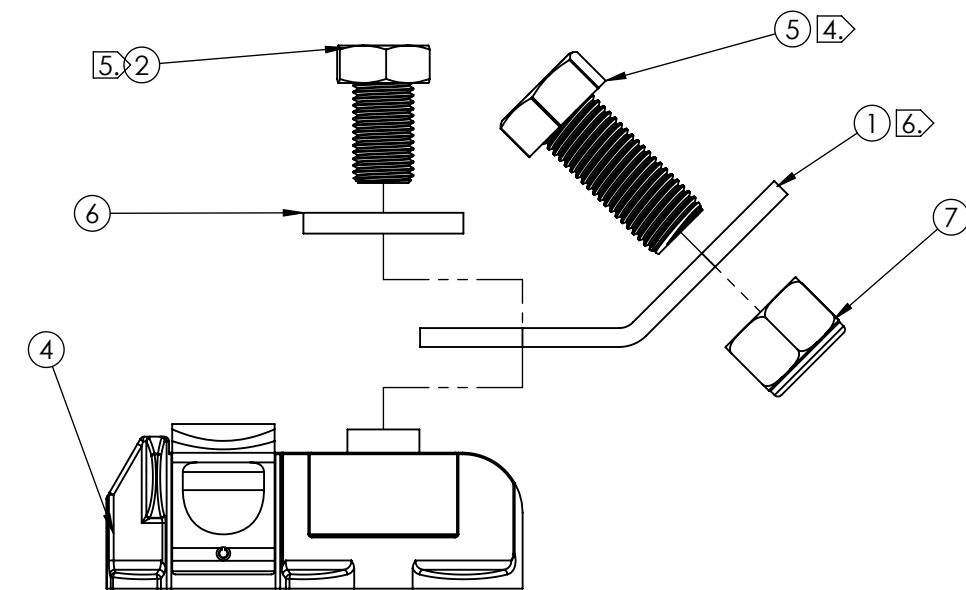

UNLESS OTHERWISE SPECIFIED:

1. WEBBING DIMENSIONS ARE FULLY EXTENDED.
2. USE APPROPRIATE SIZE BAG.
3. USE APPROPRIATE PACKAGING TO PROVIDE PROTECTION.
4. INSERT BOLT THRU ASSY, TIGHTEN NUT FINGER TIGHT ONLY.
5. APPLY #680 LOCTITE TO BOLT, TORQUE TO  $15 \pm 5$  FT-LBS. BRACKET SHOULD ROTATE FREELY.
6. TEST PROCEDURE:
  1. TEST SHALL BE CONDUCTED USING MED DUTY TRACK, FE750-1, WITH (3) 5/16 FLAT HEAD SCREWS 2" APART.
  2. TEST (3) PIECES AT 45° PULL ANGLE IN LINE WITH TRACK CENTERLINE, MINIMUM LOAD 6,000 POUNDS.
  3. TEST (3) PIECES AT 45° PULL ANGLE AND 90° FROM TRACK CENTERLINE, MINIMUM LOAD 6,000 POUNDS.

ITEM	PART NUMBER	DESCRIPTION	QTY
1	8738	SWIVEL BRACKET	1
2	8786	3/8-24 X 5/8"L, BOLT	1
3	8916	LABEL, 1 X 3.5	1
4	32506	3 LUG "L" TRACK FITTING	1
5	FE8439-1	7/16-20 X 1" L BOLT	1
6	FE8503-1	WASHER	1
7	Q8-6511	NUT HEX NYL 7/16-20 GR8 ST TC	1
8	SIP012	INSTALL. & OPER. INSTRUCTIONS	1

DIMENSIONS ARE DUAL AND REFERENCED UNLESS OTHERWISE SPECIFIED	THE USE, DUPLICATION, DISTRIBUTION, OR DISCLOSURE OF THIS DATA (IN WHOLE OR IN PART) FOR PURPOSES OF MANUFACTURING OR PROCUREMENT WITHOUT WRITTEN PERMISSION OF "Q'STRAIT"/"SURELOK" IS EXPRESSLY PROHIBITED.		<b>SURE-LOK</b>
	[IMPERIAL] METRIC	ASME Y14.5-2009 SCALE: 1:2 SIZE: B THIRD ANGLE PROJECTION	
		DRAWING NUMBER: <b>FE200777</b>	REVISION: <b>P</b>
		PRINTED COPY UNCONTROLLED	1 OF 1