

## COMPARISON OF SERIES - 1251 - 1240 - 1241

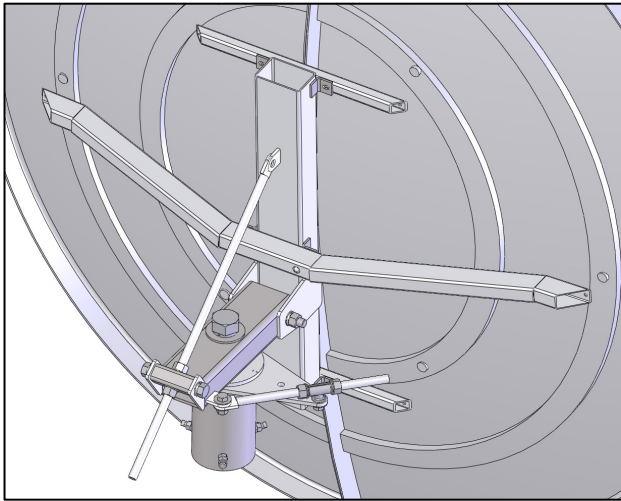

**Series 1251**

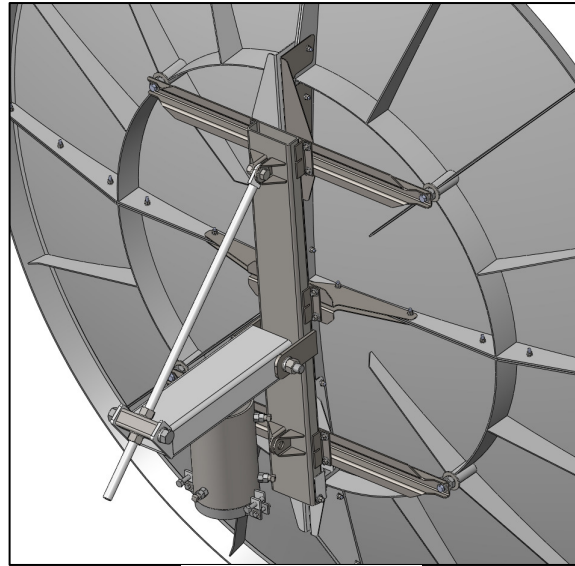

**Series 1240**

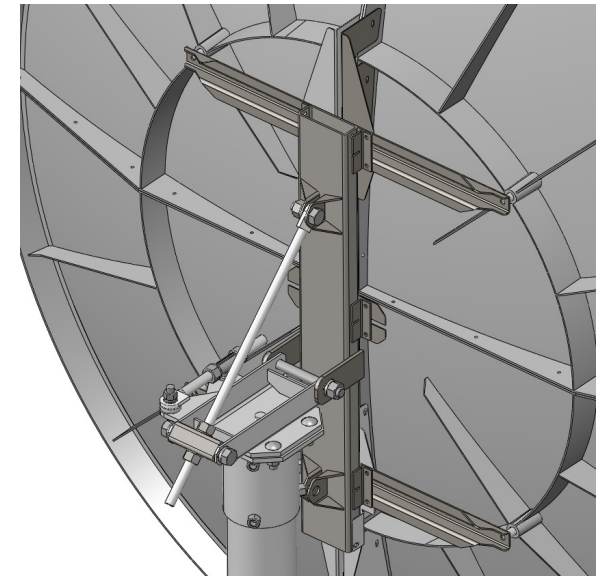

**Series 1241**

### **Mechanical Characteristics**

<b>Characteristic</b>	<b>Series 1251</b>	<b>Series 1240</b>	<b>Series 1241</b>
<b>Reflector Segments</b>	2 PC	4 PC	4 PC
<b>Mast Pipe Size</b>	6" SCH 40 (6.62" O.D.) 170mm O.D.	6" SCH 40 (6.62" O.D.) 170mm O.D.	6" SCH 40 (6.62" O.D.) 170mm O.D.
<b>Elevation Adjust Range</b>	5° to 90° Continuous Fine	5° to 90° Continuous Fine	5° to 90° Continuous Fine
<b>Azimuth Adjust Range</b>	360° Continuous, ±45° Fine	360° Continuous, ±5° Fine	360° Continuous, ±10° Fine
<b>Mount Type</b>	Elevation Over Azimuth	Elevation Over Azimuth	Elevation Over Azimuth
<b>Wind Loading:</b>			
Operational	45 mph (80 Km/h)	50 mph (80 Km/h)	50 mph (80 Km/h)
Functional Survival	125 mph (201 Km/h)	125 mph (201 Km/h)	125 mph (201 Km/h)
Breakaway Survival	N/A	150 mph (240 Km/h)	150 mph (240 Km/h)
<b>Finish</b>	Galvanized	Galvanized	Galvanized
<b>Feed Stabilizer Available</b>	Yes	Yes	Yes
<b>Max. Feed Support Wt</b>			
Ku-Band	20 lbs. (6.8 kgs.)	12 lbs. (9.1 kgs.)	12 lbs. (9.1 kgs.)
C-Band	30 lbs. (11.4 kgs.)	20 lbs. (13.6 kgs.)	20 lbs. (13.6 kgs.)