

# MODEL:E1201V32-1

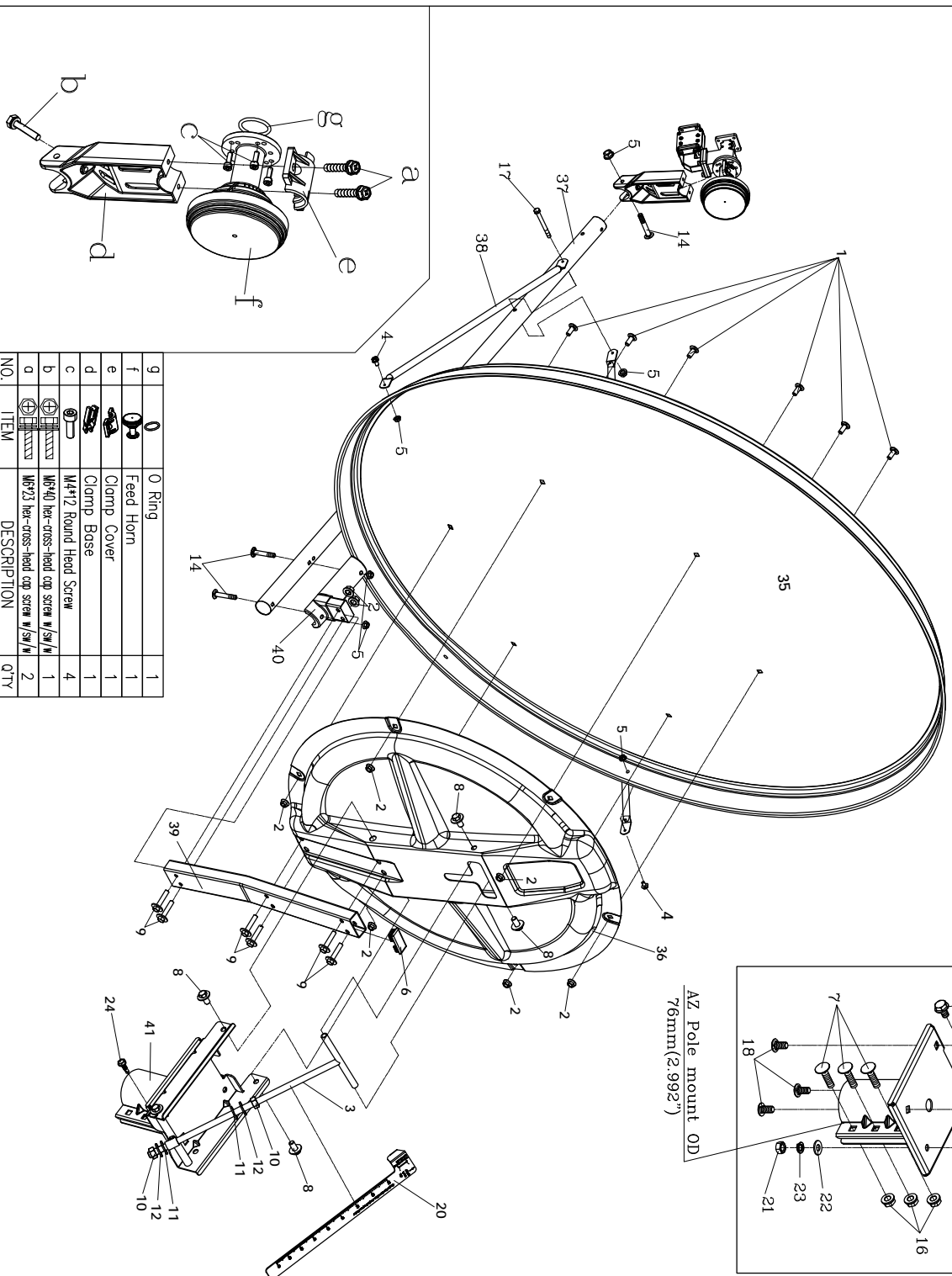

|     |      |                                       |     |
|-----|------|---------------------------------------|-----|
| 9   |      | O Ring                                | 1   |
| f   |      | Feed Horn                             | 1   |
| e   |      | Clamp Cover                           | 1   |
| d   |      | Round Base                            | 1   |
| c   |      | M4*12 Round Head Screw                | 4   |
| b   |      | M8*40 hex-cross-head cap screw w/sw/w | 1   |
| a   |      | M6*23 hex-cross-head cap screw w/sw/w | 2   |
| NO. | ITEM | DESCRIPTION                           | QTY |

| Grade                       | Recommend torque |             |          |
|-----------------------------|------------------|-------------|----------|
|                             | N.m              | Kgf.cm      | N.m      |
| M6                          | 4.8-6            | 48.9-61.2   | 8.6-10.5 |
| M8                          | 11.7-14.5        | 119.3-147.9 | 21-26    |
| Remark: 1N.m = 10.197Kgf.cm |                  |             |          |

|     |      |                                 |     |
|-----|------|---------------------------------|-----|
| 41  |      | AZ&Pole Clamp Assy              | 1   |
| 40  |      | LNB ARM Adapter                 | 1   |
| 39  |      | Support Arm                     | 1   |
| 38  |      | Feedhorn(LNB) Supporting Rods   | 2   |
| 37  |      | Boom arm                        | 1   |
| 36  |      | Back Structure Rim              | 1   |
| 35  |      | Reflector                       | 1   |
| 24  |      | #10*3/4 METAL TEK SCREW         | 2   |
| 23  |      | M10 spring Washer               | 1   |
| 22  |      | M10 Washer                      | 3   |
| 21  |      | M10 hex nut                     | 2   |
| 20  |      | Elevation angle cord board      | 1   |
| 19  |      | M10*60 hex-head flange screw    | 1   |
| 18  |      | M10*20 round-head screw         | 3   |
| 17  |      | M6*45 hex-head cap screw        | 1   |
| 16  |      | M10 flange nut                  | 6   |
| 15  |      | M10 SHAFt                       | 1   |
| 14  |      | M6*50 round-head screw          | 3   |
| 13  |      | EL Adjust Divot                 | 1   |
| 12  |      | M16 spring Washer               | 2   |
| 11  |      | M16 Washer                      | 2   |
| 10  |      | M16 hex nut                     | 2   |
| 9   |      | M8*40 hex-head cap screw w/sw/w | 6   |
| 8   |      | M10*20 hex-head cap screw w/w   | 6   |
| 7   |      | M10*40 round-head screw         | 3   |
| 6   |      | Cover                           | 1   |
| 5   |      | M6 flange nut                   | 6   |
| 4   |      | M6*16 hex-head cap screw w/sw/w | 2   |
| 3   |      | Adjusting screw M16             | 1   |
| 2   |      | M8 flange nut                   | 8   |
| 1   |      | M8*20 round-head screw          | 6   |
| NO. | ITEM | DESCRIPTION                     | QTY |

# Finding Elevation Degree

1. with single-use cardboard in the box

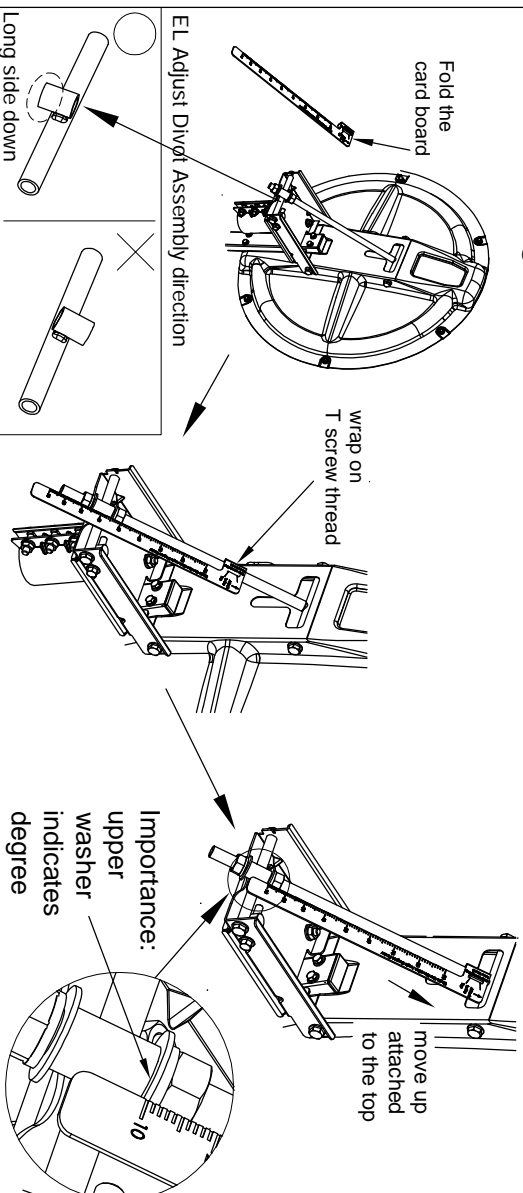

2. using inclinometer

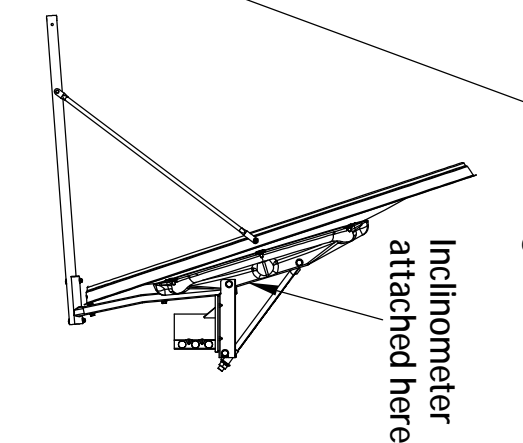

| WHEN                 | ACTUAL                |
|----------------------|-----------------------|
| Inclinometer reading | VSAT elevation degree |
| 78                   | 5                     |
| 83                   | 10                    |
| 88                   | 15                    |
| 90                   | 17                    |
| 87                   | 20                    |
| 82                   | 25                    |
| 77                   | 30                    |
| 72                   | 35                    |
| 67                   | 40                    |
| 62                   | 45                    |
| 57                   | 50                    |
| 52                   | 55                    |
| 47                   | 60                    |
| 42                   | 65                    |
| 37                   | 70                    |
| 32                   | 75                    |
| 27                   | 80                    |
| 22                   | 85                    |
| 17                   | 90                    |

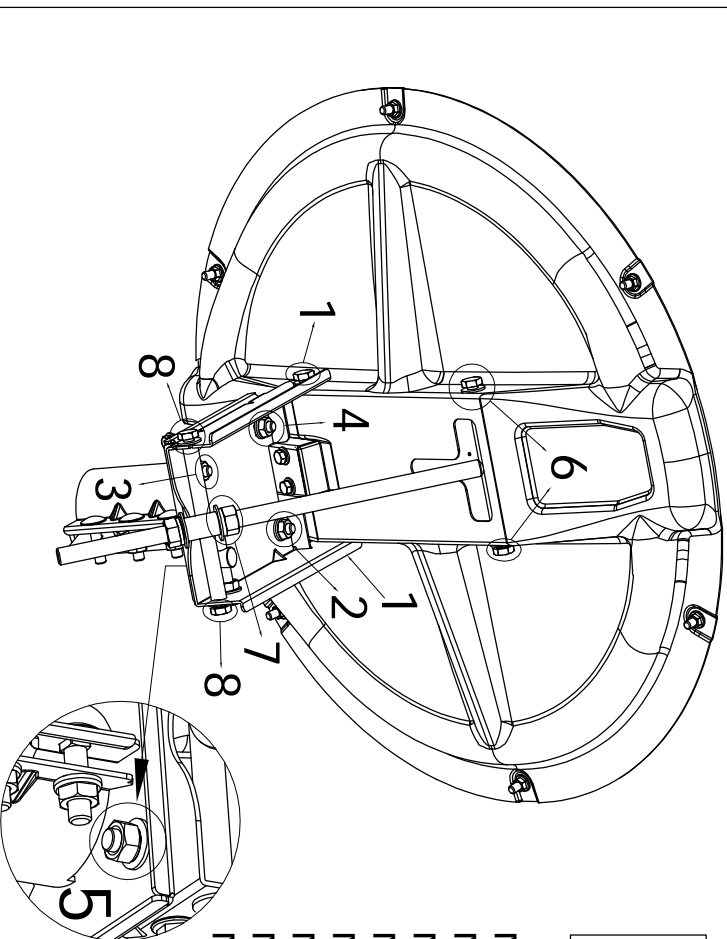

**A MUST-FOLLOW screw tightening sequence after alignment:**  
 ( to reduce variation of alignment during final tightening)

- No. 1: M10\*20 hex-head cap screw (elevation axis)
- No. 2: M10 flange nut (upper right on azimuth deck)
- No. 3: M10 flange nut (lower left on azimuth deck)
- No. 4: M10 flange nut (upper left on azimuth deck)
- No. 5: M10 hex nut (the fine tune below azimuth deck)
- No. 6: M10\*20 hex-head cap screw w/w (upper elevation axis on adjusting screw)
- No. 7: M16 hex nut (on adjusting screw M16)
- No. 8: M10\*20 hex-head cap screw w/w (to tighten and hold EL adjust divot)