



C-Band (INSAT) Receive Reject Filter Model 18323

This transmit filter provides deep rejection of the receive band with minimal effect on the transmit band.

- *Ideal for INSAT and other Region-Specific Transmit Applications*
- *Alternate Flange Configurations are Available Upon Request*

Specifications:

Passband: 6.725 - 7.025 GHz
(C-INSAT Transmit Band)

Insertion Loss: 0.10 dB Approx

VSWR: 1.22:1 Max

Power Rating: 100 Watts

Reject Band: 4.5 - 4.8 GHz
(C-INSAT Receive Band)

Rejection: 80 dB Min

Flanges: CPR137/CPR137G

Dimensions: 5.00" x 2.69" x 1.94"
(127mm x 68mm x 49mm)

Finish: Gloss White Lacquer

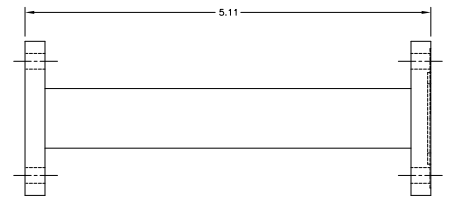
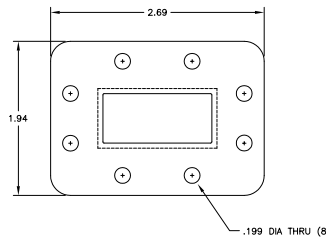

MICROWAVE FILTER CO., INC.
6743 KINNE STREET, E. SYRACUSE, NY 13057
E-Mail: mfcsales@microwavefilter.com

800-448-1666 • 315-438-4700
Web: www.microwavefilter.com