



Sun Ming Enterprises Limited

#150-6211 Westminster Hwy.

Richmond, B.C. V7C 4V4 Canada

Tel: (604) 233-0360

E-mail: info@sunming.ca

www.sunming.ca

COMMERCIAL ELECTRIC RICE WARMER
Instruction Manual

SM-RW100

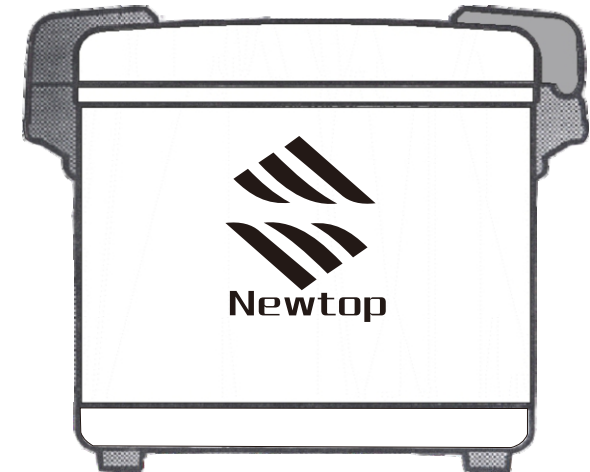

110V,60Hz,110W

100cups/23L

keep warm up to 12 hours

HEAVY DUTY STAINLESS STEEL BODY
NON-STICK INNER POT
EASY ONE-TOUCH OPERATION
KEEPS FOOD WARM & FRESH

Keep warm only, Not for rice cooking

IMPORTANT SAFEGUARDS

When using electrical appliances, basic safety precautions should always be followed including the following:

- 1 In most cities, the fire, electric, and safety inspections and permits are required under the local codes for the proper installation of the appliance.
- 2 To protect against electrical hazards, do not immerse cord, plug and the warmer in water or other liquid.
- 3 Do not touch hot surface. Use handle or knob. Do not attempt to move or carry the warmer when it has content.
- 4 Do not operate any appliance with a damaged cord or plug, or after the appliance malfunctions, or has been damaged in any manner. Return appliance to the nearest authorized service facility for examination, repair or adjustment.
- 5 The use of accessory attachments not recommended by the appliance manufacturer may cause hazards.
- 6 Do not let cord hang over edge of table or counter or touch hot surface.
- 7 Do not place on or near a hot gas or electrical heating or cooking appliances in use.
- 8 Do not use outdoors.

HOW TO CLEAN

1. This product is limited to household or similar application:
2. the appliance is not to be used by persons (including children) with reduced physical, sensory or mental capabilities, or lack of experience and knowledge, unless they have been given supervision or instruction
3. children being supervised not to play with the appliance
4. details on how to clean the surfaces in contact with food
 - a warning of potential injury from misuse
 - b statement that the heating element surface is subject to residual heat after use
5. Do not clean the power cord and the main body in or with water to avoid product failure and danger due to water into the electric appliance.
6. In addition, instructions are also available in an alternative format such as visit our website
7. If the supply cord is damaged, it must be replaced by the manufacturer, its service agent or similarly qualified persons in order to avoid a hazard.

SAVE THESE INSTRUCTIONS

- 1 To prevent electrical shock hazards. Do not immerse the warmer. Except the inner pot, into water nor into any other liquid.
- 2 Remove the inner pot dip them into lukewarm water. When cleaning the heating pot, use a moist cloth and wipe dry.
- 3 Clean the inner pot and inner lid at least once a day.

HEALTH PROTECTIVE PRECAUTIONS

IF THE RICE SMELLS BAD. The cause could be one of the following reasons:

- 1 Fresh. Hot rice is added over and on top of the pre-warmec-ncne in the warmer for more than recommended time.
- 2 Cold or cooled rice is re-heated in the warmer.
- 3 The lid is not closed firmly and properly.
- 4 The electric power supply is intermittent.
- 5 The contents is kept in the warmer beyond the recommended time-12hours.
- 6 A spatula or spoon or foreign material is left in the warmer while it is in use.
- 7 The inner pot is not clean when it is filled with the cooked rice.
- 8 Possible mechanical malfunction, causing extraordinary low temperature.
- 9 THE RICE WILL SHOW A YELLOWISH COLOR, IF;
The rice is kept in the warmer over 12 hours.
- 10 There is a mechanical malfunction, causing extra-ordinary high temperature.

IN EITHER CASE, DO NOT SERVE THE SPOILED FOOD TO ANY BODY, Empty, clear, and dry the inner pot lid thoroughly before you use it again.

5

MAJOR PARTS NAMES

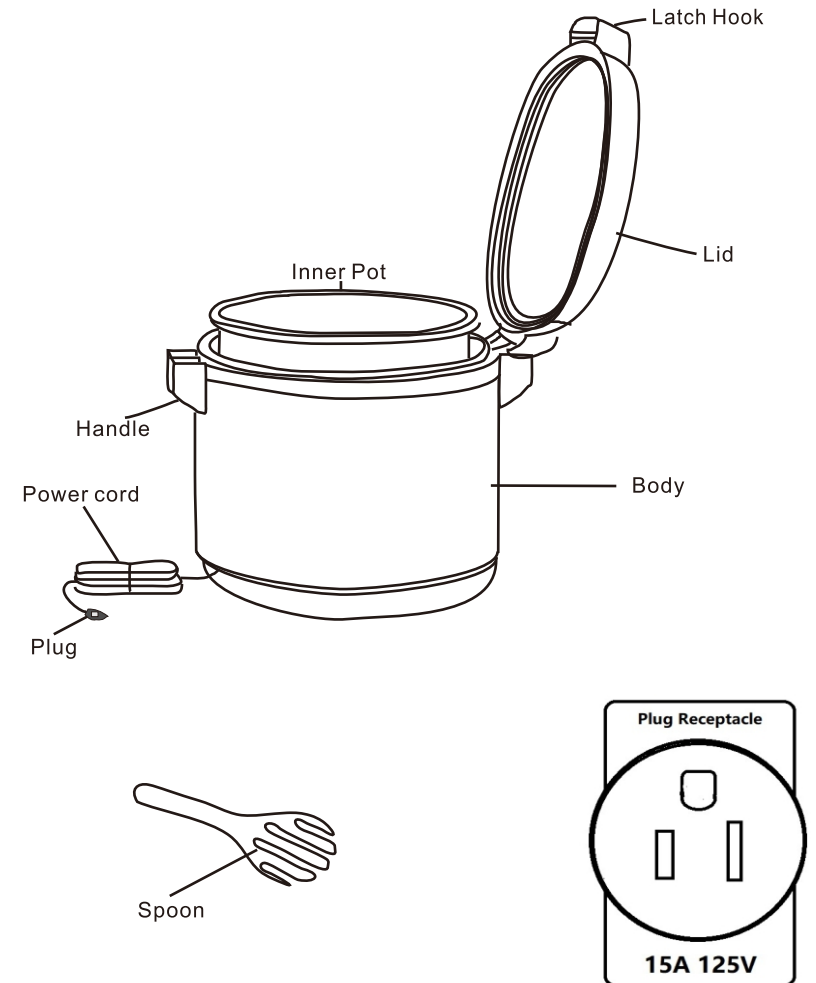

2

HOW TO USE

- 1** Wipe the inner pot and the lid clean and dry.



- 2** Place the pot in the warmer, and cover the lid properly.



- 3** Plug in and pre-heat the warmer for 30 minutes before use. Use the wall outlet only for electric power supply.

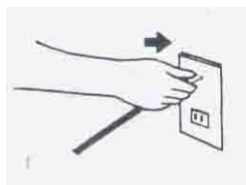
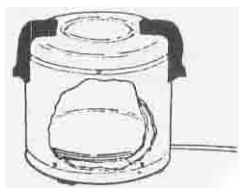

- 4** When the warmer is thoroughly warmed, put cooked rice in the pan.

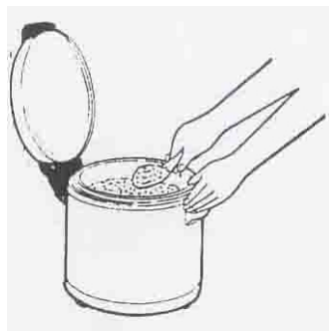

3

- 5** The warmer can keep its contents warm only if the rice that is put into the pan is really hot.

Cold rice

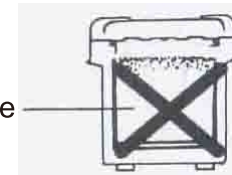

- 6** It is not recommended to keep the contents in the warmer for more than 12 hours.

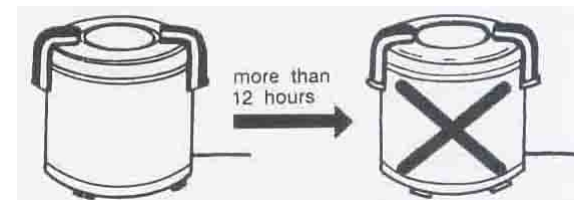

- 7** It is not designed to re-heat cold rice. Do not attempt to use the warmer for re-heating cooked cold rice, soup, water, and other liquid.



- 8** Do not unplug the cord while the warmer is in use.

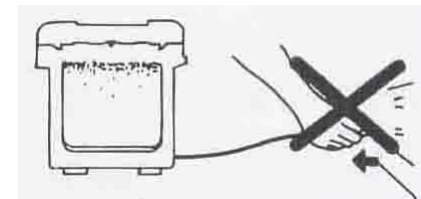

4