

SM-R36-4B-12G

(36" Range-4 Burner and 12" Griddle with Standard Oven)

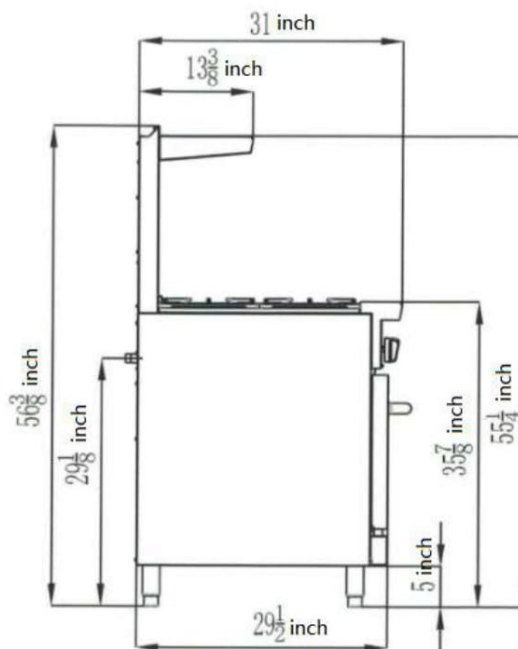

Standard Features

- ◆ Durable stainless steel structure, corrosion-resistant and easy to clean
- ◆ Simple and reasonable structure, easy to manipulate and maintain
- ◆ Heavy duty burners, with a stable flame, standby pilots
- ◆ Heavy duty cast iron grates for a strong bearing performance
- ◆ Highly efficient stainless steel burner, standby pilots
- ◆ Thick grill, with excellent heat storage performance and even heating
- ◆ Self-reset high temperature limiting device
- ◆ Enamel inner bore, inner layer net, sanitary cleaning, high temperature resistant
- ◆ Removable door for easy cleaning
- ◆ Adjustable stainless steel legs

Specifications

Model No.	Gas type	Intake-tube Pressure (in.W.C)	Ignition Way	Burner name	Nozzle No.	Per BTU B.T.U./h	Burners QTY (pcs)	Total BTU B.T.U./h	Oven QTY	Oven size	Griddle working area	Hot plates working area	Valve Types	Temp. Control	Net Weight	Exterior Size
SM-R36-4B-12G	NG	5	Manually	Hot plates	NG45	25,000	4	148,000	1	26 1/2*26*14 Inch 673*660*356mm	12*20 5/8	4 Pcs	Pilot light	Only The Oven	437 LBS 198 KGS	36*32-5/8*56-3/8
				Griddle	U-SHAPE	NG42	27,000				0	Inch				11 4/5*11 4/5
					I-SHAPE	NG45	21,000				1	301*525				Inch
				Oven	NG39	27,000	1				mm	300*300mm				

Nozzle size: NG45=2.1mm(0.083inch), NG42=2.3mm(0.09inch), NG39=2.5mm(0.098inch)

Pressure regulator use 4"-10"



Conforms to ANSI STD Z83.11b-2009 (2011) Certified to CSA STD 1.8b-2009(2011)
Conforms to NSF/ANSI STD. 4