

# SM-R36-12G-4B

## (36" Range-12" Griddle and 4 Burner with Standard Oven)

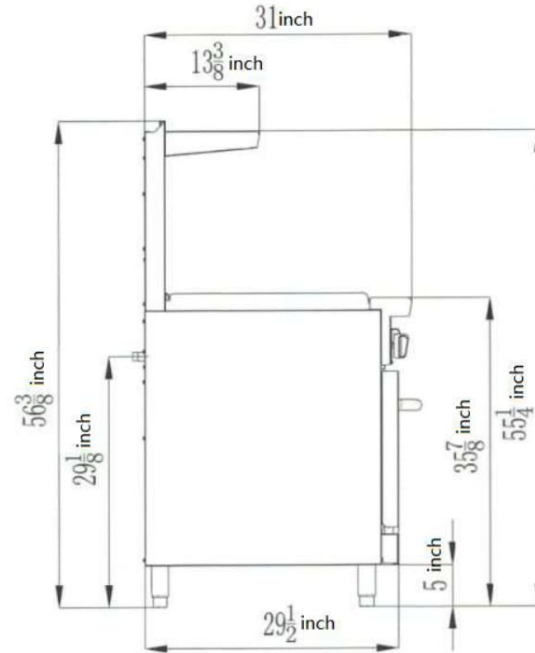

### Standard Features

- ◆ Durable stainless steel structure, corrosion-resistant and easy to clean
- ◆ Simple and reasonable structure, easy to manipulate and maintain
- ◆ Heavy duty burners, with a stable flame, standby pilots
- ◆ Heavy duty cast iron grates for a strong bearing performance
- ◆ Highly efficient stainless steel burner, standby pilots
- ◆ Thick grill, with excellent heat storage performance and even heating
- ◆ Self-reset high temperature limiting device
- ◆ Enamel inner bore, inner layer net, sanitary cleaning, high temperature resistant
- ◆ Removable door for easy cleaning
- ◆ Adjustable stainless steel legs



### Specifications

Model No.	Gas type	Intake-tube Pressure (in.W.C)	Ignition Way	Burner name	Nozzle No.	Per BTU B.T.U./h	Burners QTY (pcs)	Total BTU B.T.U./h	Oven QTY	Oven size	Griddle working area	Hot plates working area	Valve Types	Temp. Control	Net Weight	Exterior Size	
SM-R36-12G-4B	NG	5	Manually	Hot plates	NG45	25,000	4	148,000	1	26 1/2*26*14	12*20 5/8	4 Pcs	Pilot light	Only The Oven	437 LBS 198 KGS	36*32-5/8*56-3/8	
				Griddle	U-SHAPE	NG42	27,000			0	Inch	Inch				11 4/5*11 4/5	mm
					I-SHAPE	NG45	21,000			1	673*660*356	301*525				Inch	
				Oven	NG39	27,000	1			mm	mm	300*300mm				mm	

**Nozzle size: NG45=2.1mm(0.083inch), NG42=2.3mm(0.09inch), NG39=2.5mm(0.098inch)**

**Pressure regulator use 4"-10"**



Conforms to ANSI STD Z83.11b-2009 (2011) Certified to CSA STD 1.8b-2009(2011)  
Conforms to NSF/ANSI STD. 4