

SM-R24

(24" Range - 4 Burner with Standard Oven)

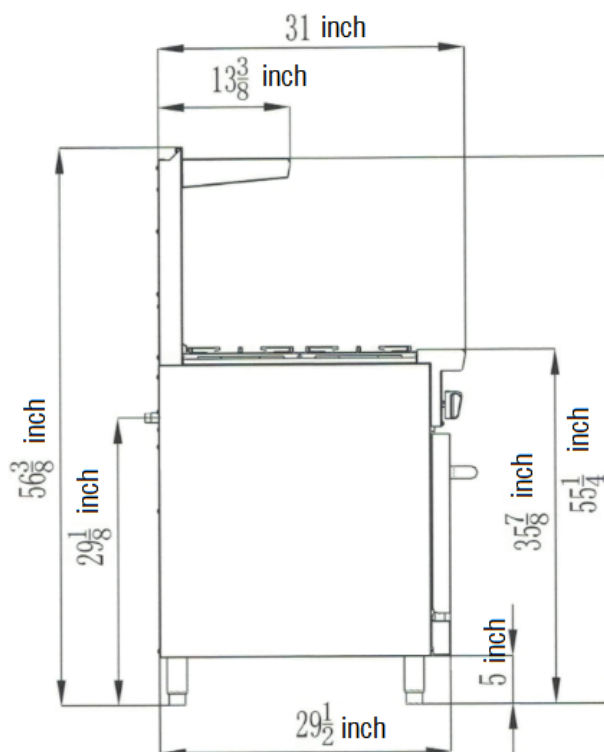

Standard Features

- ◆ Durable stainless steel structure, corrosion-resistant and easy to clean
- ◆ Simple and reasonable structure, easy to manipulate and maintain
- ◆ Heavy duty burners, with a stable flame, standby pilots
- ◆ Heavy duty cast iron grates for a strong bearing performance
- ◆ Self-reset high temperature limiting device
- ◆ Enamel inner bore, inner layer net, sanitary cleaning, high temperature resistant
- ◆ Removable door for easy cleaning
- ◆ Adjustable stainless steel legs



Specifications

Model No.	Gas type	Intake-tube Pressure (in.W.C)	Ignition Way	Burner name	Nozzle No.	Per BTU B.T.U./h	Burners QTY (pes)	Total BTU B.T.U./h	Oven QTY	Oven size	Griddle working area	Hot plates working area	Valve Types	Temp. Control	Net Weight	Exterior Size	
SM-R24	NG	5	Manually	Hot plates	NG45	25,000	4	124,000	1	20*26*14 Inch 508*660*356mm	None	4 Pcs 11 4/5*11 4/5 Inch 300*300mm	Pilot light	Only The Oven	302 LBS 137 KGS	24*32-5/8*56-3/8	
				Griddle	U-SHAPE	NG42	27,000									0	Inch
					I-SHAPE	NG45	21,000									0	610*790*1433
				Oven	NG44	24,000	1									mm	

Nozzle size: NG45=2.1mm(0.083inch), NG42=2.3mm(0.09inch), NG44=2.2mm(0.087inch)

Pressure regulator use 4"-10"



Conforms to ANSI STD Z83.11b-2009 (2011) Certified to CSA STD 1.8b-2009(2011)
Conforms to NSF/ANSI STD.4

SM-R24-G

(24" Range - with Griddle and Standard Oven)

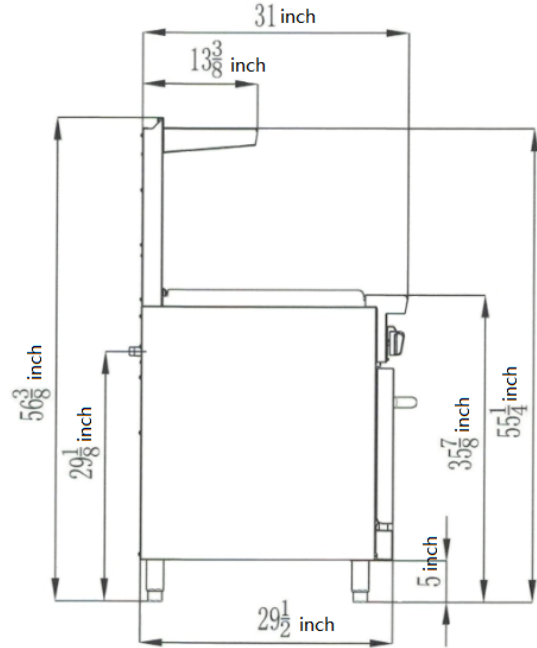

Standard Features

- ◆ Durable stainless steel structure, corrosion-resistant and easy to clean
- ◆ Simple and reasonable structure, easy to manipulate and maintain
- ◆ Highly efficient stainless steel burner, standby pilots
- ◆ Thick grill, with excellent heat storage performance and even heating
- ◆ Self-reset high temperature limiting device
- ◆ Enamel inner bore, inner layer net, sanitary cleaning, high temperature resistant
- ◆ Removable door for easy cleaning
- ◆ Adjustable stainless steel legs



Specifications

Model No.	Gas type	Intake-tube Pressure (in. W.C)	Ignition Way	Burner name	Nozzle No.	Per BTU B.T.U./h	Burners QTY (pcs)	Total BTU B.T.U./h	Oven QTY	Oven size	Griddle working area	Hot plates working area	Valve Types	Temp. Control	Net Weight	Exterior Size	
SM-R24-G	NG	5	Manually	Hot plates	NG45	25,000	0	72,000	1	20*26*14	24*20 5/8	None	Pilot light	Only The Oven	362 LBS 164 KGS	24*32-5/8*56-3/8 Inch 610*790*1433 mm	
				Griddle	U-SHAPE	NG42	27,000			1	Inch						Inch
					I-SHAPE	NG45	21,000			1	508*660*356						606*525
				Oven	NG44	24,000	1			mm	mm						

Nozzle size: NG45=2.1mm(0.083inch), NG42=2.3mm(0.09inch), NG44=2.2mm(0.087inch)

Pressure regulator use 4"-10"



Conforms to ANSI STD Z83.11b-2009 (2011) Certified to CSA STD 1.8b-2009(2011)
Conforms to NSF/ANSI STD. 4

SM-R36

(36" Range - 6 Burner with Standard Oven)

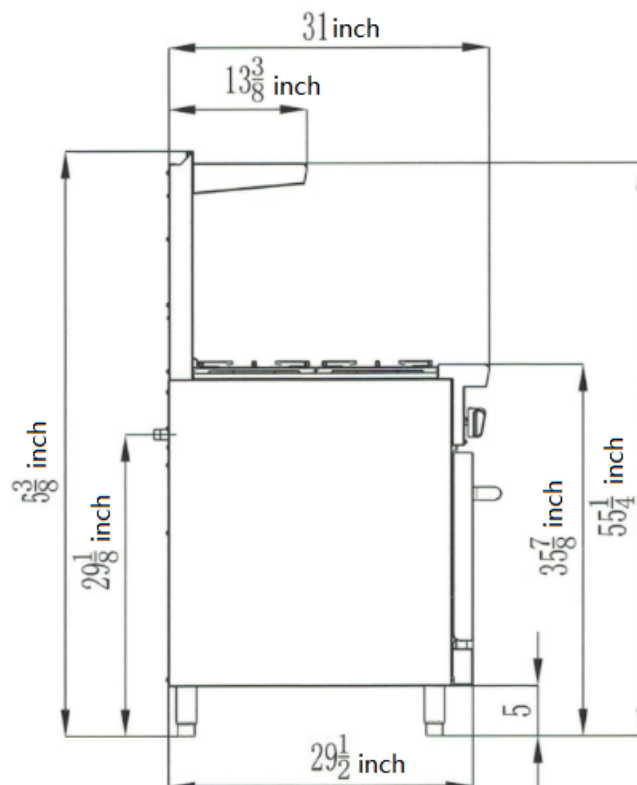

Standard Features

- ◆ Durable stainless steel structure, corrosion-resistant and easy to clean
- ◆ Simple and reasonable structure, easy to manipulate and maintain
- ◆ Heavy duty burners, with a stable flame, standby pilots
- ◆ Heavy duty cast iron grates for a strong bearing performance
- ◆ Self-reset high temperature limiting device
- ◆ Enamel inner bore, inner layer net, sanitary cleaning, high temperature resistant
- ◆ Removable door for easy cleaning
- ◆ Adjustable stainless steel legs



Specifications

Model No.	Gas type	Intake-tube Pressure (in. W.C)	Ignition Way	Burner name	Nozzle No.	Per BTU B.T.U./h	Burners QTY (pcs)	Total BTU B.T.U./h	Oven QTY	Oven size	Griddle working area	Hot plates working area	Valve Types	Temp. Control	Net Weight	Exterior Size	
SM-R36	NG	5	Manually	Hot plates	NG45	25,000	6	177,000	1	26 1/2*26*14 Inch 673*660*356mm	None	6 Pcs 11 4/5*11 4/5 Inch 300*300mm	Pilot light	Only The Oven	406 LBS 184 KGS	36*32-5/8*56-3/8 Inch 914*790*1433 mm	
				Griddle	U-SHAPE	NG42	27,000										0
					I-SHAPE	NG45	21,000										0
				Oven	NG39	27,000	1										

Nozzle size: NG45=2.1mm(0.083inch), NG42=2.3mm(0.09inch), NG39=2.5mm(0.098inch)

Pressure regulator use 4"-10"



Conforms to ANSI STD Z83.11b-2009 (2011) Certified to CSA STD 1.8b-2009(2011)
Conforms to NSF/ANSI STD. 4

SM-R36-4B-12G

(36" Range-4 Burner and 12" Griddle with Standard Oven)

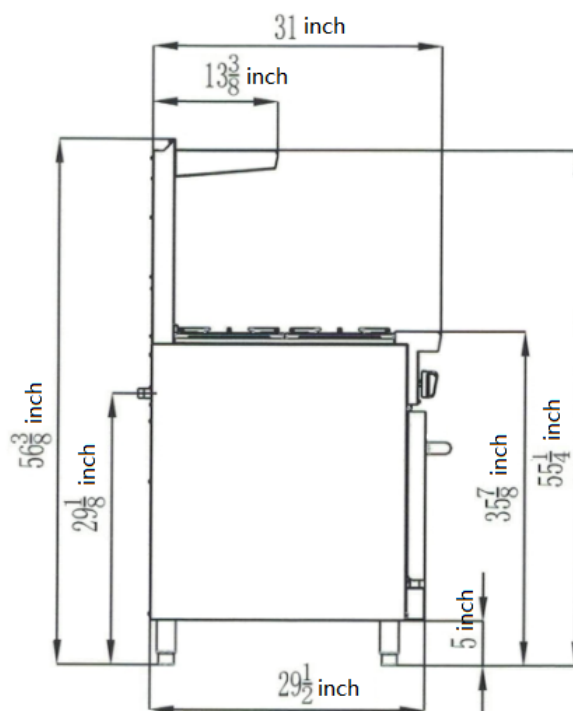

Standard Features

- ◆ Durable stainless steel structure, corrosion-resistant and easy to clean
- ◆ Simple and reasonable structure, easy to manipulate and maintain
- ◆ Heavy duty burners, with a stable flame, standby pilots
- ◆ Heavy duty cast iron grates for a strong bearing performance
- ◆ Highly efficient stainless steel burner, standby pilots
- ◆ Thick grill, with excellent heat storage performance and even heating
- ◆ Self-reset high temperature limiting device
- ◆ Enamel inner bore, inner layer net, sanitary cleaning, high temperature resistant
- ◆ Removable door for easy cleaning
- ◆ Adjustable stainless steel legs



Specifications

Model No.	Gas type	Intake-tube Pressure (in. W.C)	Ignition Way	Burner name	Nozzle No.	Per BTU B.T.U./h	Burners QTY (pcs)	Total BTU B.T.U./h	Oven QTY	Oven size	Griddle working area	Hot plates working area	Valve Types	Temp. Control	Net Weight	Exterior Size	
SM-R36-4B-12G	NG	5	Manually	Hot plates	NG45	25,000	4	148,000	1	26 1/2*26*14 Inch 673*660*356mm	12*20 5/8 Inch	4 Pcs	Pilot light	Only The Oven	437 LBS 198 KGS	36*32-5/8*56-3/8 Inch 914*790*1433 mm	
				Griddle	U-SHAPE	NG42	27,000				0	301*525 mm					11 4/5*11 4/5 Inch
					I-SHAPE	NG45	21,000				1						
				Oven	NG39	27,000	1				300*300mm						

Nozzle size: NG45=2.1mm(0.083inch), NG42=2.3mm(0.09inch), NG39=2.5mm(0.098inch)

Pressure regulator use 4"-10"



Conforms to ANSI STD Z83.11b-2009 (2011) Certified to CSA STD 1.8b-2009(2011)
Conforms to NSF/ANSI STD. 4

SM-R36-12G-4B

(36" Range-12" Griddle and 4 Burner with Standard Oven)

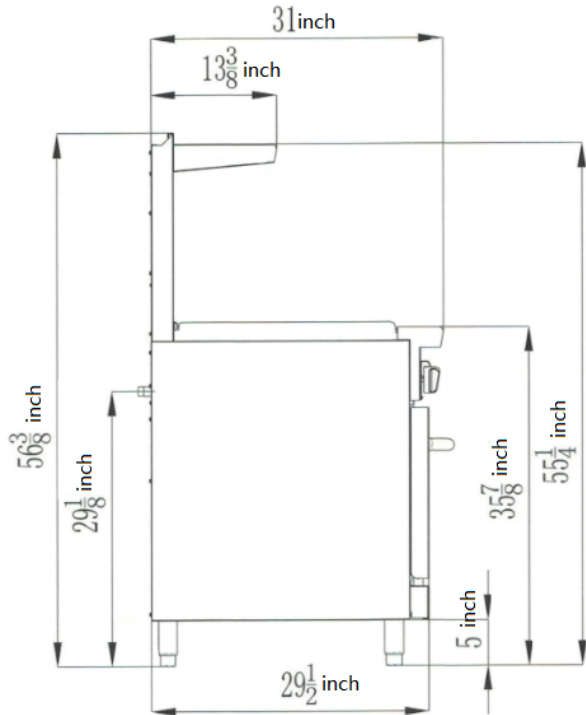

Standard Features

- ◆ Durable stainless steel structure, corrosion-resistant and easy to clean
- ◆ Simple and reasonable structure, easy to manipulate and maintain
- ◆ Heavy duty burners, with a stable flame, standby pilots
- ◆ Heavy duty cast iron grates for a strong bearing performance
- ◆ Highly efficient stainless steel burner, standby pilots
- ◆ Thick grill, with excellent heat storage performance and even heating
- ◆ Self-reset high temperature limiting device
- ◆ Enamel inner bore, inner layer net, sanitary cleaning, high temperature resistant
- ◆ Removable door for easy cleaning
- ◆ Adjustable stainless steel legs



Specifications

Model No.	Gas type	Intake-tube Pressure (in. W.C)	Ignition Way	Burner name	Nozzle No.	Per BTU B.T.U./h	Burners QTY (pcs)	Total BTU B.T.U./h	Oven QTY	Oven size	Griddle working area	Hot plates working area	Valve Types	Temp. Control	Net Weight	Exterior Size	
SM-R36-12G-4B	NG	5	Manually	Hot plates	NG45	25,000	4	148,000	1	26 1/2*26*14 Inch	12*20 5/8 Inch	4 Pcs 11 4/5*11 4/5 Inch	Pilot light	Only The Oven	437 LBS 198 KGS	36*32-5/8*56-3/8 Inch 914*790*1433 mm	
				Griddle	U-SHAPE	NG42	27,000										0
					I-SHAPE	NG45	21,000										1
				Oven	NG39	27,000	1										673*660*356 mm

Nozzle size: NG45=2.1mm(0.083inch), NG42=2.3mm(0.09inch), NG39=2.5mm(0.098inch)

Pressure regulator use 4"-10"



Conforms to ANSI STD Z83.11b-2009 (2011) Certified to CSA STD 1.8b-2009(2011) Conforms to NSF/ANSI STD. 4

SM-R36-2B-24G

(36" Range - 2 Burner and 24" Griddle with Standard Oven)

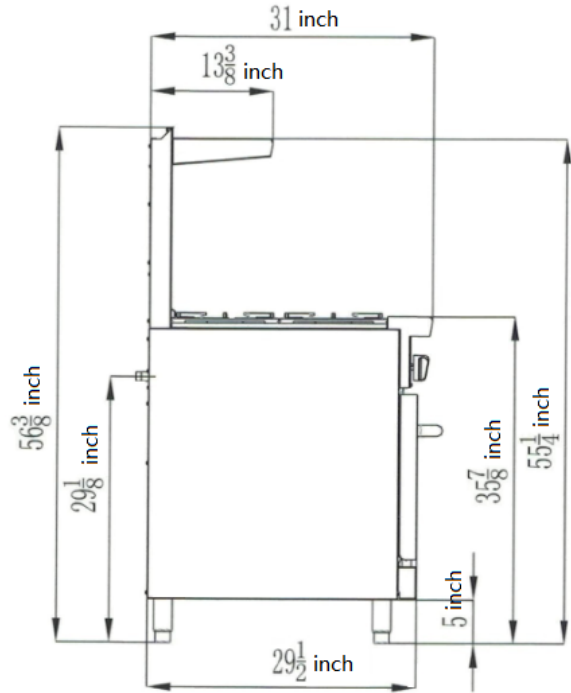

Standard Features

- ◆ Durable stainless steel structure, corrosion-resistant and easy to clean
- ◆ Simple and reasonable structure, easy to manipulate and maintain
- ◆ Heavy duty burners, with a stable flame, standby pilots
- ◆ Heavy duty cast iron grates for a strong bearing performance
- ◆ Highly efficient stainless steel burner, standby pilots
- ◆ Thick grill, with excellent heat storage performance and even heating
- ◆ Self-reset high temperature limiting device
- ◆ Enamel inner bore, inner layer net, sanitary cleaning, high temperature resistant
- ◆ Removable door for easy cleaning
- ◆ Adjustable stainless steel legs



Specifications

Model No.	Gas type	Intake-tube Pressure (in. W.C)	Ignition Way	Burner name	Nozzle No.	Per BTU B.T.U./h	Burners QTY (pcs)	Total BTU B.T.U./h	Oven QTY	Oven size	Griddle working area	Hot plates working area	Valve Types	Temp. Control	Net Weight	Exterior Size	
SM-R36-2B-24G	NG	5	Manually	Hot plates	NG45	25,000	2	125,000	1	26 1/2*26*14 Inch 673*660*356 mm	24*20 5/8 Inch 606*525 mm	2 Pcs 11 4/5*11 4/5 Inch 300*300mm	Pilot light	Only The Oven	463 LBS 210 KGS	36*32-5/8*56-3/8 Inch 914*790*1433 mm	
				Griddle	U-SHAPE	NG42	27,000										1
					I-SHAPE	NG45	21,000										1
				Oven	NG39	27,000	1										

Nozzle size: NG45=2.1mm(0.083inch), NG42=2.3mm(0.09inch), NG39=2.5mm(0.098inch)

Pressure regulator use 4"-10"



Conforms to ANSI STD Z83.11b-2009 (2011) Certified to CSA STD 1.8b-2009(2011)
Conforms to NSF/ANSI STD. 4

SM-R36-24G-2B

(36" Range -24" Griddle and 2 Burner with Standard Oven)

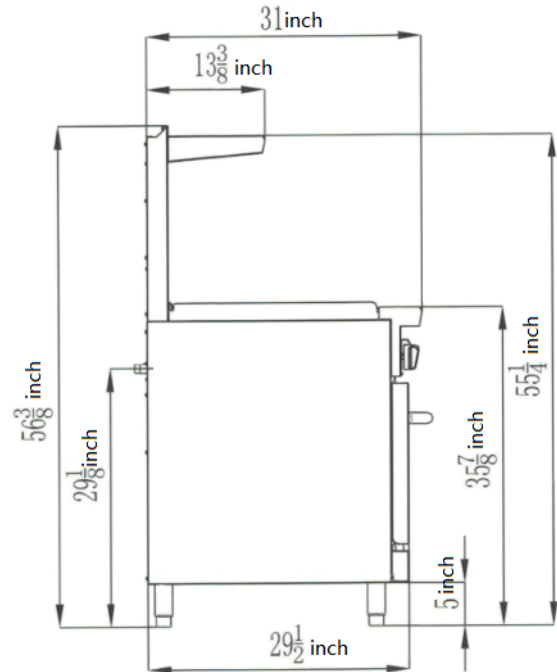

Standard Features

- ◆ Durable stainless steel structure, corrosion-resistant and easy to clean
- ◆ Simple and reasonable structure, easy to manipulate and maintain
- ◆ Heavy duty burners, with a stable flame, standby pilots
- ◆ Heavy duty cast iron grates for a strong bearing performance
- ◆ Highly efficient stainless steel burner, standby pilots
- ◆ Thick grill, with excellent heat storage performance and even heating
- ◆ Self-reset high temperature limiting device
- ◆ Enamel inner bore, inner layer net, sanitary cleaning, high temperature resistant
- ◆ Removable door for easy cleaning
- ◆ Adjustable stainless steel legs



Specifications

Model No.	Gas type	Intake-tube Pressure (in. W.C)	Ignition Way	Burner name	Nozzle No.	Per BTU B.T.U./h	Burners QTY (pcs)	Total BTU B.T.U./h	Oven QTY	Oven size	Griddle working area	Hot plates working area	Valve Types	Temp. Control	Net Weight	Exterior Size	
SM-R36-24G-2B	NG	5	Manually	Hot plates	NG45	25,000	2	125,000	1	26 1/2*26*14	24*20 5/8	2 Pcs	Pilot light	Only The Oven	463 LBS 210 KGS	36*32-5/8*56-3/8 Inch 914*790*1433 mm	
				Griddle	U-SHAPE	NG42	27,000			1	Inch	Inch					11 4/5*11 4/5
					I-SHAPE	NG45	21,000			1	673*660*356	606*525					Inch
				Oven	NG39	27,000	1			mm	mm	300*300mm					

Nozzle size: NG45=2.1mm(0.083inch), NG42=2.3mm(0.09inch), NG39=2.5mm(0.098inch)

Pressure regulator use 4"-10"



Conforms to ANSI STD Z83.11b-2009 (2011) Certified to CSA STD 1.8b-2009(2011)
Conforms to NSF/ANSI STD. 4

SM-R36-G

(36" Range with Griddle and Standard Oven)

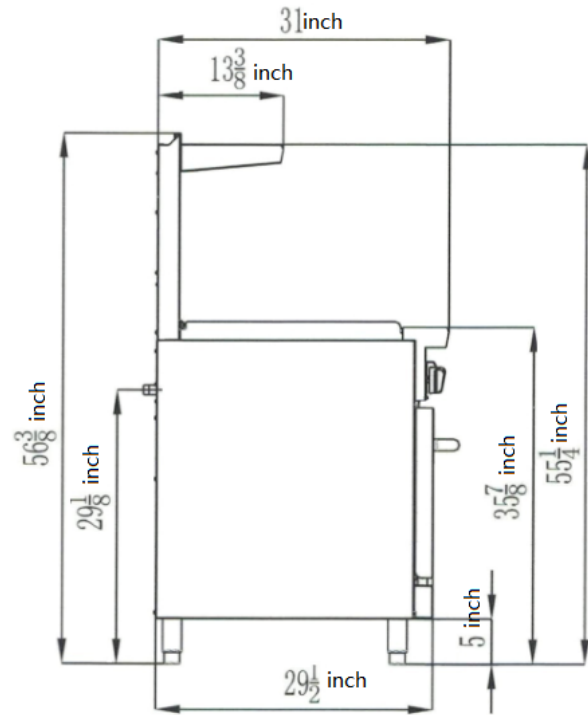

Standard Features

- ◆ Durable stainless steel structure, corrosion-resistant and easy to clean
- ◆ Simple and reasonable structure, easy to manipulate and maintain
- ◆ Highly efficient stainless steel burner, standby pilots
- ◆ Thick grill, with excellent heat storage performance and even heating
- ◆ Self-reset high temperature limiting device
- ◆ Enamel inner bore, inner layer net, sanitary cleaning, high temperature resistant
- ◆ Removable door for easy cleaning
- ◆ Adjustable stainless steel legs



Specifications

Model No.	Gas type	Intake-tube Pressure (in. W.C)	Ignition Way	Burner name	Nozzle No.	Per BTU B.T.U./h	Burners QTY (pcs)	Total BTU B.T.U./h	Oven QTY	Oven size	Griddle working area	Hot plates working area	Valve Types	Temp. Control	Net Weight	Exterior Size	
SM-R36-G	NG	5	Manually	Hot plates	NG45	25,000	0	102,000	1	26 1/2*26*14 Inch	36*20 5/8 Inch	None	Pilot light	Only The Oven	487 LBS 221 KGS	36*32-5/8*56 Inch 914*790*1433 mm	
				Griddle	U-SHAPE	NG42	27,000										2
					I-SHAPE	NG45	21,000										1
				Oven	NG39	27,000	1										









Nozzle size: NG45=2.1mm(0.083inch), NG42=2.3mm(0.09inch), NG39=2.5mm(0.098inch)

Pressure regulator use 4"-10"



Conforms to ANSI STD Z83.11b-2009 (2011) Certified to CSA STD 1.8b-2009(2011)
Conforms to NSF/ANSI STD.4

Reference

	<p>SM-R24 24" Range 4 Burner with Standard Oven (Natural Gas) 天燃氣四頭煲仔爐連焗爐</p>
	<p>SM-R24-G 24" Range with Griddle and Standard Oven (Natural Gas) 天燃氣 24 寸扒爐連焗爐</p>
	<p>SM-R36 36" Range 6 Burner with Standard Oven (Natural Gas) 天燃氣六頭煲仔爐連焗爐</p>
	<p>SM-R36-4B-12G 36" Range 4 Burner and 12" Griddle with Standard Oven (Natural Gas) 天燃氣四頭煲仔爐連 12 寸右扒爐連焗爐</p>
	<p>SM-R36-12G-4B 36" Range 12" Griddle and 4 Burner with Standard Oven (Natural Gas) 天燃氣四頭煲仔爐連 12 寸左扒爐連焗爐</p>
	<p>SM-R36-2B-24G 36" Range 2 Burner and 24" Griddle with Standard Oven (Natural Gas) 天燃氣兩頭煲仔爐連 24 寸右扒爐連焗爐</p>
	<p>SM-R36-24G-2B 36" Range 24" Griddle and 2 Burner with Standard Oven (Natural Gas) 天燃氣兩頭煲仔爐連 24 寸左扒爐連焗爐</p>
	<p>SM-R36-G 36" Range with Griddle and Standard Oven (Natural Gas) 天燃氣 36 寸扒爐連焗爐</p>

