

US PATENT PENDING

SpotOn®

**SOIL MOISTURE
METER**

**QUICK & ACCURATE SOIL MOISTURE,
EC, AND TEMPERATURE READINGS IN
A COMPACT AND DURABLE DESIGN.**



SOIL MOISTURE METER | ITEM #39240

PRODUCT MANUAL

Made In The USA



WWW.INNOQUESTINC.COM/PRODUCT-MANUALS

(BG) За да видите ръководството за продукти на български език, посетете уеб страницата, посочена по-горе.

(HR) Da biste pogledali priručnik za proizvod na hrvatskom, posjetite gore navedenu web stranicu.

(CS) Chcete-li zobrazit příručku k produktu v češtině, navštivte webové stránky uvedené výše.

(DA) For at se produktmanualen på dansk, besøg hjemmesiden ovenfor.

(NL) Om de producthandleiding in het Nederlands te bekijken, bezoek de bovenstaande pagina.

(ET) Eestli tootejuhendi vaatamiseks külastage ülalolevat veebilehte.

(FI) Jos haluat tarkastella tuotekäsikirjaa suomeksi, vieraille edellä mainituilla verkkosivuilla.

(HU) A termék kézikönyv magyar nyelven történő megtekintéséhez látogassa meg a fenti weboldalt.

(IT) Per visualizzare il manuale del prodotto in italiano, visitare la pagina web di cui sopra.

(LV) Lai apskatītu produkta rokasgrāmatu latviešu valodā, apmeklējiet iepriekš minēto tīmekļa vietni.

(LT) Norėdami peržiūrėti gaminio vadovą lietuvių kalba, apsilankykite aukščiau esančiame tinklalapyje.

(NO) For å se produkthåndboken på norsk, besøk nettsiden ovenfor.

(PL) Aby wyświetlić instrukcję obsługi w języku polskim, odwiedź stronę internetową wymienioną powyżej.

(RO) Pentru a vedea manualul de produs în limba română, vizitați pagina web de mai sus.

(RU) Чтобы просмотреть руководство по продукту на русском языке, перейдите на веб-страницу выше.

(SR) Da biste pogledali upustva za proizvod na srpskom, posetite gore navedenu web stranicu.

(SK) Ak chcete zobrazit návod na používanie v slovenčine, navštívte webovú stránku uvedenú vyššie.

(SL) Če si želite ogledati priročnik za izdelek v slovenščini, obiščite spletno stran zgoraj.

(SV) För att se produkthandboken på svenska, besök webbsidan ovan.

**WARNING:**

Use caution when probing into soil to avoid hitting buried electrical wires or other utilities.

Use caution when handling and transporting this meter since its sharp metal tip could cause damage to packaging, containers, or personal.

Always use the included tip cover when transporting the meter.

FEATURES:

- **Continuous readings for quick moisture testing (no button pressing required)**
- **Measures soil moisture, salinity (EC), and soil surface temperature (°F or °C)**
- **Includes both 2.375" and 1.5" probe rods**
- **Rubber mounted rods resist bending in dry or rocky soil**
- **Ultra high frequency (100 MHz) measuring circuit provides accurate moisture measurements in a variety of soil types and salinity levels**

SPECIFICATIONS:

Range:	0.0 - 100.0 % Volumetric Water Content 0.0 - 5.00 mS/cm Electrical Conductivity 16°F(-9°C) - 120°F(49°C) Temperature
Accuracy:	+/- 3% VWC +/- 0.1 mS/cm +/- 1°F(0.6°C)
Repeatability:	Less Than 0.5% Variation
Environmental:	32 - 122°F (0-50°C) Operating Range IP-64 Rated (Rain and Dust Proof)
Battery:	(3) AA/LR6 Alkaline Batteries (included) 300 Hrs Continuous On-time Battery Life Meter Automatically Turns Off After 20 Minutes Of Inactivity
Size & Weight:	Meter: 14"(36cm)W x 2"(5cm)D x 35.8"(91cm)L 2.4lb(1.1kg) As Shipped: 4.5"(11.4cm)W x 4.5"(11.4cm)D x 36.5"(93cm)L 3.3lb(1.5kg)

1 YEAR WARRANTY: This product is warranted to be free from defects in materials or workmanship for one (1) year from the date of purchase.

DEMO VIDEO:



YOUTUBE.COM
SEARCH:
SpotOn Soil Moisture Meter

METER COMPONENTS:

- 1 Cap for Battery Compartment
- 2 Cap for In-Handle Rod Storage
- 3 LCD Display
- 4 Power Button
- 5 Average / Clear Average Button
- 6 Sensor Head
- 7 Retaining Ring
- 8 Soil Surface Temperature Sensor
- 9 WWC & EC Sensor Rods

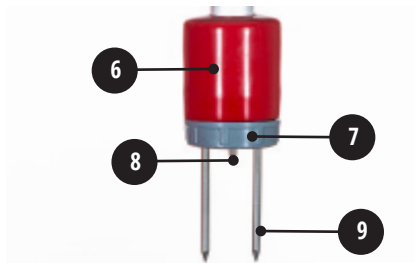
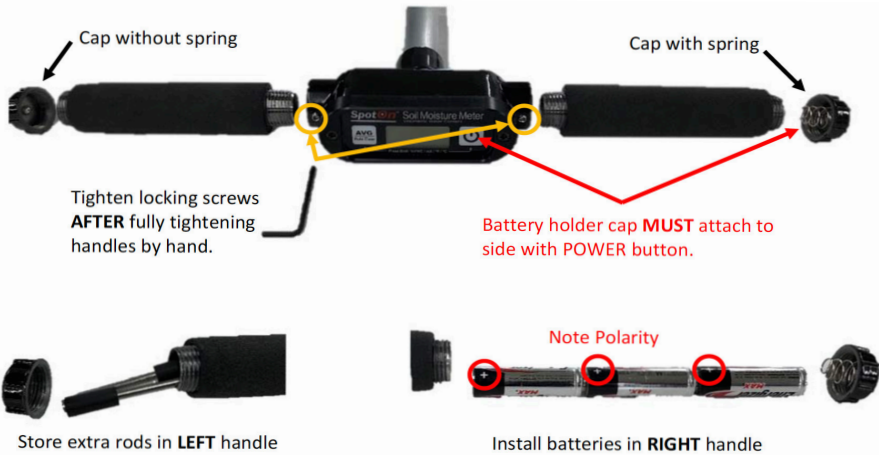

Fig. 1

METER ASSEMBLY:



As pictured above: With the meter facing you, install the handle with Cap for Battery Compartment (1) of Fig. 1 by handle turning clockwise until as tight as possible by hand. Do the same for the handle with Cap for In-Handle Rod Storage (2) of Fig. 1. Once both handles are attached, use a Hex Key Wrench (included) to tighten the locking screws. Store extra rods in LEFT handle. Install (3) AA/LR6 Alkaline Batteries (included) in RIGHT handle.

USE OF PRODUCT:

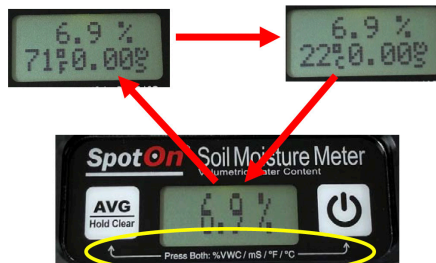

Turn on the meter by pressing POWER button (4) of Fig. 1. The display will first show the Rod Length (2.4" Rods), which are pre-installed in the unit. See *Changing Rods* if using 1.5" Rods. Next the display will show the battery life in %. Lastly, the display will show VWC or VWC + EC + Temp and is ready to take measurements.

Note: To switch the display between VWC only and VWC + EC + Temp (°F or °C), press the POWER and AVG buttons simultaneously. The meter will then continuously take new sensor readings and display updated values every second until turned off.

Average Function

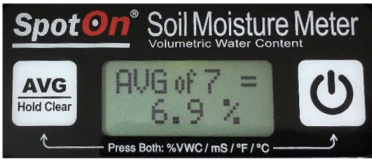

To obtain an average for multiple probeings, insert the rods into the ground and press the AVG button once a stable reading appears on the display. The meter will then display the new average value and the total number of readings included in this average. To redisplay the current average without changing its value hold the meter, with the rods in the air and press the AVG button.

Note: To clear the average, press and hold the AVG button for 4 seconds.

Changing the Batteries



The LCD will show "Replace Battery!" when it's time to change the batteries. On the RIGHT handle, remove the Cap for Battery Compartment (1) of Fig. 1 by turning counterclockwise. Replace with (3) AA/LR6 Alkaline Batteries and tighten the cap. Each time the meter is turned on it will show % battery life left in the batteries.

Note: % battery life will only display correctly for Alkaline Batteries.

Changing the Rods:

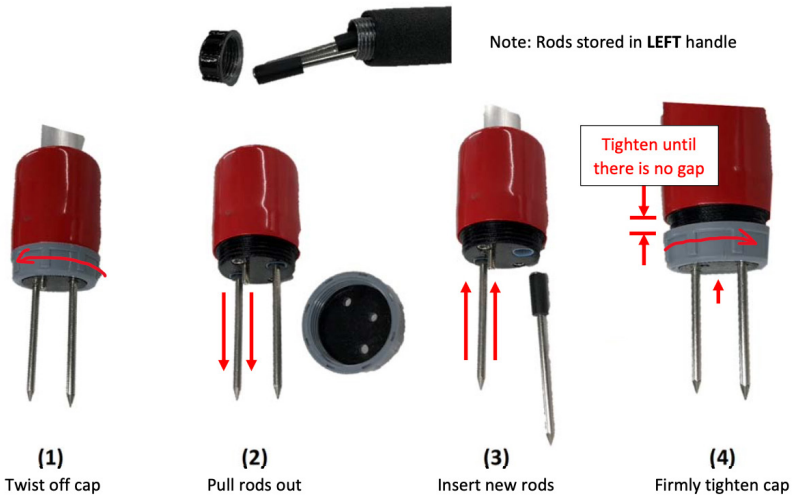

Once installed, adjust display to match new rod length. At Power On, the rod length will show on the display, press AVG button to switch between 2.4" or 1.5" rods.

Note: This adjustment is only possible while the second line of the display shows "AVG to ↑↓".

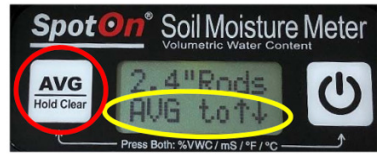

Protective Rod Cover:



WARRANTY, SERVICE, AND RETURNS:

One-Year Warranty

Innoquest, Inc. (“Innoquest”) warrants this product to be free from defects in materials and workmanship under normal use for a period of one (1) year from date of purchase. This warranty extends only to the original purchaser and shall not apply to any product which, in Innoquest’s sole opinion, has been subject to misuse, alteration, abuse, or abnormal conditions of operation or handling. Innoquest’s obligation under this warranty is limited to repair or replacement of the product which is returned to Innoquest. Innoquest accepts no liability for whatever damages may be caused by a malfunctioning product.

Repair & Service Policy

Products returned to Innoquest for repair or service must follow these guidelines: Return of the product for warranty repair or service is the responsibility of the purchaser. Return of the product for non-warranty repair or service, also the purchaser’s responsibility, will carry a charge of \$35 for assessing the product’s repair needs. Further work will not be completed without the purchaser’s approval.

Return Procedure

All returns, regardless of reason, must have a Return Merchandise Authorization (“RMA”) number. The purchaser must call Innoquest at (815) 337-8555 to obtain the RMA number prior to sending any merchandise back. The RMA number must be displayed on the outside of the shipping carton. All shipping charges will be paid by the purchaser. Innoquest is not responsible for any package that is returned without a valid RMA number or for the loss of the package by any shipping company.

Return for Refund Policy

We only accept returns of products purchased directly from Innoquest. Please return all other products to the original place of purchase. A restocking fee (the greater of 15% of the purchase price or \$35) will apply to any returns sent back to Innoquest for a refund. For a refund, the product must be in the original sealed packaging provided by Innoquest. If the unit was opened but is completely functional and returned in good condition as determined by Innoquest, a repackaging fee not to exceed \$25 will be added to the restocking fee. No refund will be given for damaged products.





910 Hobe Road

Woodstock, IL 60098

US 800-637-1623 | **International** +1-815-337-8555

sales@innoquestinc.com

www.innoquestinc.com