

# SLW10 LED PROFILE

SLW10 11 x 44,8mm triple row led profile 0.44" x 1.76"

## FUTURES:

- Y Triple row LED strip profile up to 36,6mm.
- Y Slim design only 11mm high.
- Y Three types snap in high quality UV resistant di users.
- Y High quality anodizing surface.
- Y Direct installation with the surface by the ST2,2mm screws.
- Y Aluminum end caps.

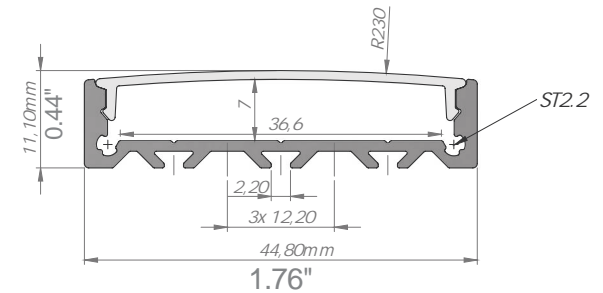

AL-SLW10  
AB-SLW10



AL-SLW10  
AB-SLW10  
EC-SLW10-H1



EC-SLW10-H1  
EndCaps



AL-SLW10

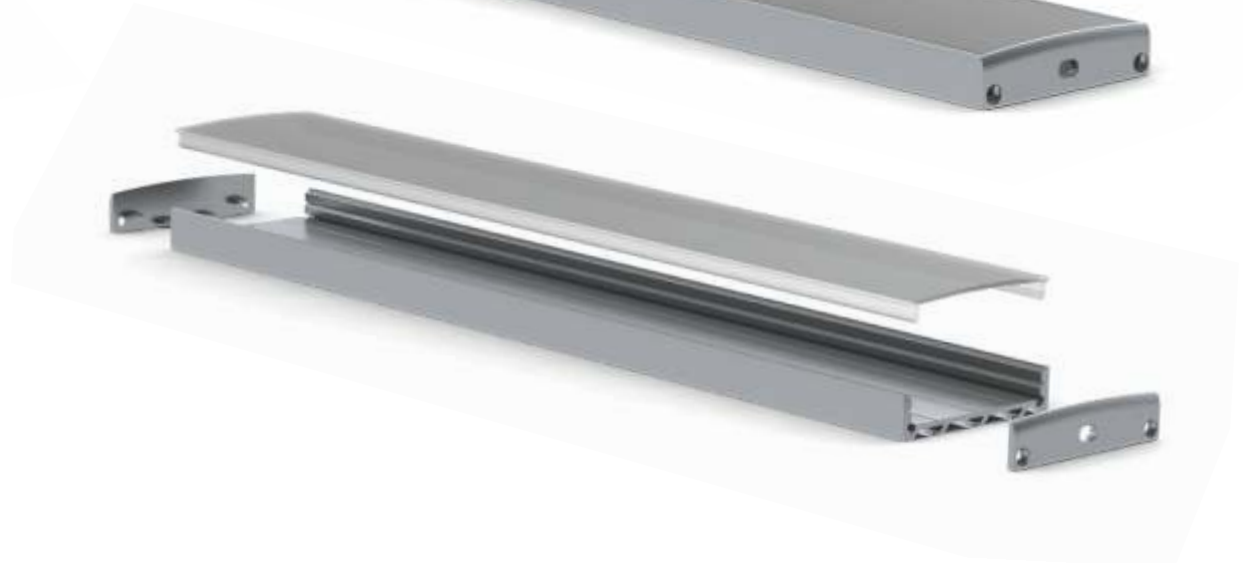

## DESCRIPTION

Super wide aluminum profile with the 36,6mm space for the extra wide LED strips or the triple row of standard 12mm LED stripes. It is a low design with the aluminum body directly screwing to the surface by the ST 2,2x9,5mm self threading screws. Almost flat snap in UV resistant di user is providing quality finish to this LED lamp. The profiles are available with three di erent types of light di users, frosted, 50% frosted and transparent. SLW10 LED profile is also equipped with stylish aluminum end caps screwed onto the profile.



## SLW10 ANALYSES

### Temperature (Solid) [°C]

Temperature ambient:25°C  
Total power:24 W/m(288LEDs)  
LED strip:12-3528(x3)

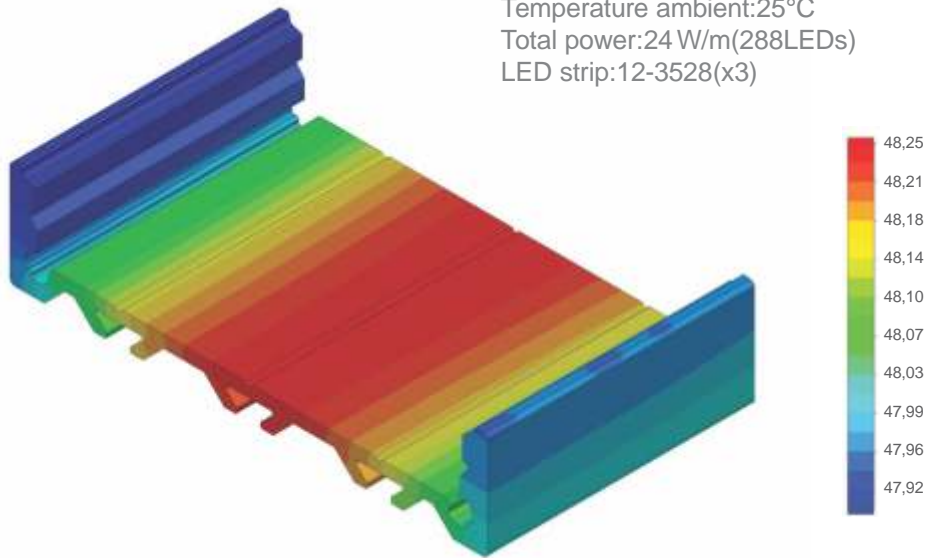

### Polar Candela Distribution Plot Using Missed Rays

