

## V05 Lens 3-LED Korean Chip

Protection Class .....IP68.....  
 Operating Temperature. ....22°~ 158° F  
 Life Rating .....>50,000 hours  
 Fastening .....3M.tape.& mechanical



LED Modules are covered by US Design Patent D861,922 S

- .....Non-Polarized Wires
- .....Reverse Circuit Protection
- .....Wire-Thru Technology

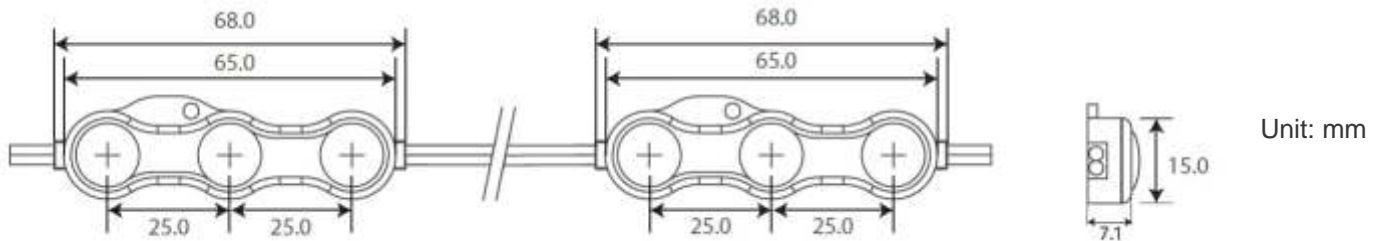

Group	Part Number	Color	Beam Angle	CCT (Kelvin)	Wave length (nm)	Intensity		Current (mA)	Wattage	Wire length (in)	Module/ft
						Lm/W	Lm				
Lens 3-LED 0.72W Korean Chip	Z3V-05-W10-a4-072-K2	White	140°	10000K	NA	88	63	60	0.72	3.1	2
	Z3V-05-W10-a7-072-K2	White	170°	10000K	NA	93	67	60	0.72	3.1	2
	Z3V-05-R-a4-072-K2	Red	140°	NA	630	22	16	60	0.72	3.1	2
	Z3V-05-G-a4-072-K2	Green	140°	NA	520	67	48	60	0.72	3.1	2
	Z3V-05-B-a4-072-K2	Blue	140°	NA	460	14	10	60	0.72	3.1	2
	Z3V-05-Y-a4-072-K2	Yellow	140°	NA	585	24	17	60	0.72	3.1	2

### Power Supply Capacity (with 20% reserved power)

12 VDC Power Supply	0.24W per module	0.48W per module	0.72W per module	1.20W per module	1.44W per module	1.50W per module
60W SMPS	200 Modules	100 Modules	67 Modules	40 Modules	33 Modules	32 Modules
100W SMPS	333 Modules	167 Modules	111 Modules	67 Modules	56 Modules	53 Modules
120W SMPS	400 Modules	200 Modules	133 Modules	80 Modules	67 Modules	64 Modules
150W SMPS	500 Modules	250 Modules	167 Modules	100 Modules	83 Modules	80 Modules

Figure shown with 80% of rated power output. It is not recommended to exceed 80% of power capacity.

\* Parameters tolerance +/- 7%

