

INSTALLATION INSTRUCTIONS

CB17001-XX 17002-XX

Thank you for purchasing CloudyBay™ Lighting Fixtures.



Bath & Vanity Fixture



GENERAL: All electrical connections must be in accordance with local and National Electrical Code (N.E.C.) standards. If you are unfamiliar with proper electrical wiring connections, contact and obtain the services of a qualified electrician. Use UL or IEC approved wire only for input/output connections.

Remove fixture and mounting components from the box, and make sure that no parts are missing, by referencing the illustration in the illustration instructions.

Turn power off before installation, inspection, or removal.
Use all necessary precautions while performing this procedure.

Consult a qualified electrician to ensure correct branch circuit conductor. Min 90°C supply conductors.

Properly ground electrical enclosure. IT IS IMPERATIVE THAT THE OUTLET BOX BE PROPERLY GROUNDED.

DO NOT REVERSE THE HOT AND NEUTRAL CONNECTIONS, OTHERWISE SAFETY WILL BE COMPROMISED.

This Integrated LED Fixture has no lamp/bulb to replace.



TROUBLESHOOTING

- Check that line voltage at fixture is correct.
- Ensure that there is voltage at lamp fixture wires. If there is no voltage, then check all connections.
- Check that fixture is grounded properly.

If fixture does not light:

- Check switch to ensure that there are no defects.
- Check fuse/circuit breaker for trips, then check wiring connections.



CLEANING AND MAINTENANCE:

CAUTION: Ensure fixture temperature is cool enough to touch.
DO NOT clean or perform maintenance while fixture is energized.

- Clean lens and fixture with non-abrasive cleaning solution.



5-Year Limited Warranty

LIMITED WARRANTY: This fixture is warranted to be free from defects in workmanship and material for up to 5-years. Based upon reasonable household usage, when used in accordance with package and included instructions. If this fixture does not last for the time period guaranteed, manufacture will send you a replacement fixture upon receipt of the returned fixture, register receipt, and proof of purchase. To contact us, please email us at info@cloudybaylighting.com to find out how to return the fixture. We are committed to making high quality products. Returning the fixture will help us monitor and further improve product quality. This replacement is the sole remedy available, and LIABILITY FOR INCIDENTAL OR CONSEQUENTIAL DAMAGES IS HEREBY EXPRESSLY EXCLUDED.

PLEASE READ CAREFULLY BEFORE INSTALLING FIXTURE
Save these instructions, as you may need them at a later date.

Figure 1

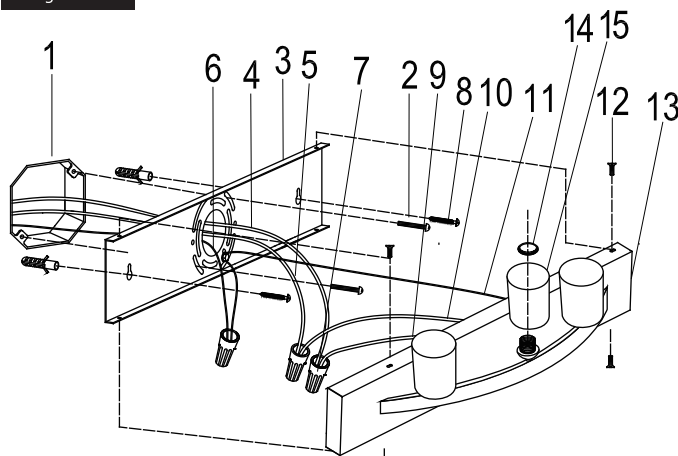

- | | |
|--------------------------|-------------------------|
| 1. OUTLET BOX (EXCLUDED) | 9. WHITE FIXTURE WIRE |
| 2. OUTLET BOX SCREWS | 10. BLACK FIXTURE WIRE |
| 3. MOUNTING WALL PLATE | 11. FIXTURE GROUND WIRE |
| 4. WHITE SUPPLY WIRE | 12. FIXTURE SCREWS |
| 5. BLACK SUPPLY WIRE | 13. FIXTURE BASE |
| 6. HOUSE GROUND WIRE | 14. RETAINING RING |
| 7. WIRE NUTS | 15. GLASS SHADE |
| 8. ANCHOR SCREWS | |

↓ Please follow these steps for installation. ↓

Remove the fixture and the mounting package from the box and make sure that no parts are missing by referencing the illustrations on the installation instructions.

1.]Place the mounting wall plate(3) over the outlet box(1), align the mounting slots of the wall plate with holes of the outlet box as shown. Use a level to ensure the wall plate(3) is straight.

2. Mark the location of the keyhole slots of the wall plate on the wall.
Drill a 1/4" holes at the narrow end of each keyhole slot marking on the wall.
Carefully hammer a wall anchor into each drilled hole.

3. Replace the mounting wall plate(3) over outlet box, align the narrow end of each keyhole slot with its respective wall anchor. Feed the anchor screws (8) through keyhole slots and thread them into the wall anchors until wall plate is flush against the wall. Additionally, fasten the wall plate to thread holes in outlet box using two outlet box screws, as shown.

4. Pull the supply wires (4 & 5) and house ground wire (6) out from the outlet box (1) before attaching wall plate to outlet box. Make electrical connections, connect the black fixture black wire (10) to the black supply wire (5) and the white fixture wire (9) to the white supply wire (4) using wire nut (7). Connect the fixture ground wire (11) to the supply ground wire (6) together using wire nut (7). Wrap all wire connections with electrical tape to ensure secure connection.

5. Place the fixture base (13) over the mounting wall plate (3) and secure it to the wall plate by using four fixture screws (12).

6. Put the GLASS SHADE(15) through thread, then secure with RETAINING RING(14)

7. Installation complete, restore power at the circuit breaker and turn light switch on to activate this fixture.

Care and maintenance – Use dry and clean cloth to wipe the surface of the fixture.

