

**VERA**

fancii

# CONTENTS

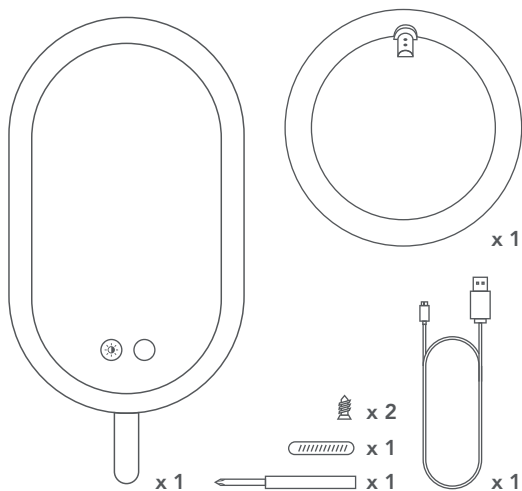

# MIRROR FUNCTIONS

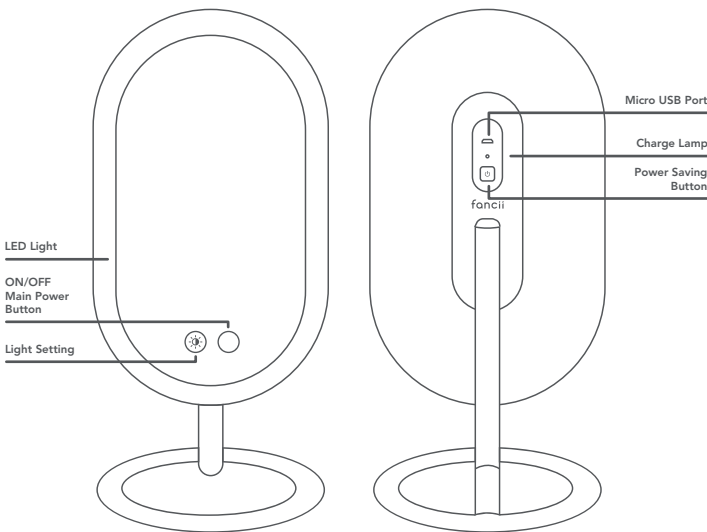

# ASSEMBLY

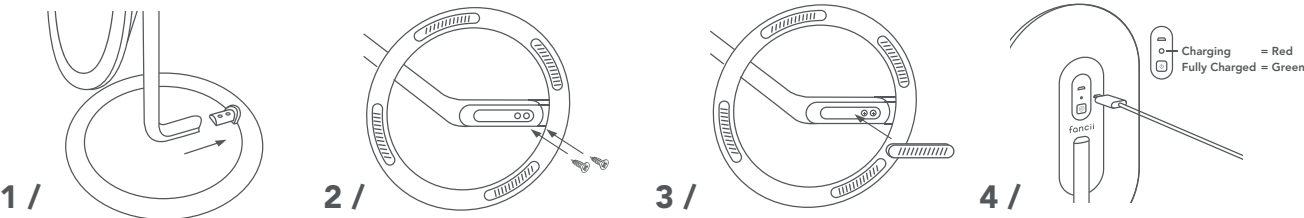

## LIGHT SETTINGS

With a CRI (color rendering index) of 95, Vera is able to emit a much more natural, accurate output of light. Why is this important? It means you'll get a color-corrected reflection of your skin in your mirror and you won't have to worry about BBL (Bad Beauty Lighting™).

Vera has been designed with a built-in timer to automatically shut off the LED lights after 30 minutes. So if you find yourself in a rush, or forget to press the power button, you won't have to worry about your battery charge running down.

### 1 / Soft White

Perfect for creating a makeup look for an evening occasion like a date night.

### 2 / Neutral White

All-round ideal light for daytime makeup as it simulates natural daylight.

### 3 / Natural Daylight

True neutral white (no red or blue hues), use this setting to get photo-ready.

4 / Vera comes with three different LED light options. To cycle through the different light settings tap the **light settings button** on the front of the mirror until you find your desired light temperature. Vera will remember the last setting you used when you power it back on.

5 / To brighten or dim the light, hold your finger down on the **main power button** until you reach your desired brightness.

6 / Push the power saving button on the back of the mirror when not in use to conserve power.

## WARNINGS

1 / Keep this product away from young children and pets.

2 / The mirror is not waterproof. To protect against electrical hazards, do not use it in the bath or shower.

3 / Do not place the mirror in direct sunlight. Reflection of direct sunlight by the mirror could cause a fire.

4 / Use this mirror only for its intended purpose.

5 / This product contains glass and may shatter if dropped. Handle with care.

6 / This product contains a lithium battery and should be recycled or disposed of according to state and local guidelines.

## CHARGING

- 1 / Use the USB cord provided to charge the battery.
- 2 / You will find the Micro USB Port located on the back of the mirror. Attach the USB cable and connect the other end to a reliable power source such as a computer, or USB DC-5V adapter. The battery takes approx 3.5 hours to fully charge.
- 3 / The charging light on the back of Vera will turn red when charging and green when it's fully charged.

## POWERING UP

- 1 / Ensure the battery is fully charged or use the USB cord and plug Vera into a reliable power source (such as a computer or USB adapter).
- 2 / Push the **power saving button** on the back of the mirror.
- 3 / Turn the LED lights on by tapping the **main power button** on the front of the mirror.

## BATTERY DISPOSAL

**Note:** Opening and disassembling the device will void its warranty. The process is not reversible.

This action must only be undertaken when the device is ready to be disposed of.

All batteries should be recycled or disposed of as per state or local guidelines, and should not be thrown away in household waste. To remove the battery, cut open the silicone plastic shell and carefully remove the lithium battery. Wear gloves during this process for your safety. Do not dispose of in a fire as the battery will likely explode and cause injury.

## HERE TO HELP

We pride ourselves on providing premium beauty tools which is why all of our products are backed by a 24-month warranty. If you have any questions or need further assistance, you can send us an email, connect with us on Live Chat or give us a call! Our friendly support team is here to help.

Come find us on



#FanciiAF @FanciiCo

fancii.com



1 • 800 • 285 • 0183



support@fancii.com



Live online chat at:  
fancii.com