

# Luci® Lux

## Instruction manual

*If your light **doesn't have a USB port on the product**, please refer to 'Lux Instruction Manual\_v1'*

MIPOWERD®

# Getting to know Luci

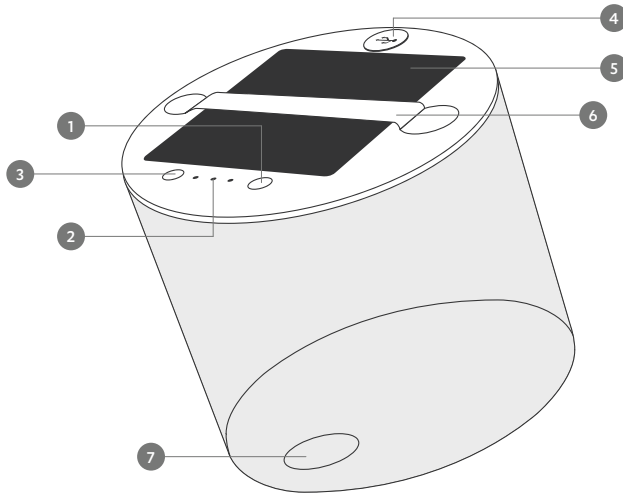

1. Power button
2. Battery level indicator
  - 1 light = 0-10%
  - 2 lights = 11-55%
  - 3 lights = 56-100%
3. Battery level indicator button
4. Built-in USB port
5. Solar panel
6. Fixed base strap
7. 2-way valve

## How to use

### Inflate

- Firmly pinch the 2-way valve and pull away from base. This will do 50% of the inflating.
- Firmly pinch valve and blow into the nozzle until fully inflated. Push in the valve, and you're all set!

### Deflate

- Pull out the valve, firmly pinch valve and simultaneously collapse towards the base.
- Gently twist the light as you deflate for a flatter, more compact shape.
- Close tab on valve when fully deflated.

### Shine

- Press power button to turn unit on.
- 1 click for low mode, 2 clicks for medium, 3 clicks for high, 4 clicks for flashing, 5 clicks to turn off, or hold for 2 seconds at any time to turn off.

## Charging

### Charge via solar

- With solar panel side up, place in direct sunlight for up to 7 hours for a full charge.
- Press battery level indicator button at any time to check battery level. See illustration above for more info.

### Charge via USB-C

- Insert the USB cord provided into the USB-C port on the base panel, then insert the other end into a USB outlet for 3 hours.
- Ensure the cord is firmly in position and check that the Battery Level Indicator lights are flashing - this means it's charging.

*Direct sunlight means that the sun's light is directly hitting the solar panel. Think of it this way; if you were Luci and you were able to directly see the sun, then you would be in direct sunlight!*

# Frequently asked questions

## **It's cloudy, will my light still charge?**

Yes, but it will charge at a slower rate than on a bright, clear day. As your Luci charges via the red and violet frequencies of visible light, the charge times will vary based on the UV index or overcast skies. Generally speaking, the higher the UV index, the faster the charge.

## **Will my light charge under indoor lighting?**

The sun generates significant red and violet frequencies (which charge your Luci), whereas your ordinary indoor lights emit a tiny fraction of that UV. We recommend you go straight to the source and put your Luci directly in the sunlight from a windowsill or, for the best results, outside! Luci is durable and completely waterproof.

## **Do I need batteries?**

Nope. All of our products are solar powered and rechargeable, so no batteries are needed. No more searching the drawer for that second AA!

## **Can I charge your products from my car dashboard?**

We advise against charging on a car dashboard. On a hot summer day, your car dashboard can reach temperatures of up to 160°F (71°C) which exceeds the temperature limit of our products - 122°F (50°C).

## **How much charge does my light retain when not in use?**

Depending on the model, if your light is fully charged and not in use, it should retain the charge for ~3 years. An unused light will only lose ~3% battery per month. We specifically built these lights to be reliable and ready for whenever you need them!

## **Do I need to activate the solar charger?**

No activation needed. Simply place the light in direct sunlight with the solar side up, and the sun's rays will do the rest.

## **Will the LEDs ever need replacing?**

Nope, never. Not unless they are somehow damaged of course. But fear not, we've designed and manufactured our products so that you would have to go out of your way to get in and damage the LEDs.

## **What's the difference between charging the light via USB or the solar panel?**

Speed! Charging via USB is ~6x faster than via solar due to the input power. Whether charging via solar or USB however, the outcome remains the same - a full battery charge. Our advice is to charge via solar for a natural source of power, but if you're in a pinch, charge via USB.

## **Should I charge my light if I don't have immediate plans to use it?**

Yes! Our products can retain a full charge for up to 3 years. We recommend charging your light every 6 months or so, even when you aren't using it. That way, it'll always be ready to go when you need it.

## **Can my light be left outside?**

Yes! In fact, our products love being outside in the open. Luci is durable and completely waterproof. This means you don't need to go running to bring them in when it rains. Luci: 1, laundry: 0.

## **You say that my Luci is durable; how durable are we talking?**

So durable that you can hit it with a stick, kick it, throw it, even stand on it (providing you weigh less than ~150 lbs). Our products are built to last and designed to take anything life throws at it.

## **Do all Inflatable Lanterns have a 2-second quick shut off?**

Yes, all of our Inflatable Lanterns have a 2-second quick shut off. Instead of clicking through the modes until you get to the power off mode, you can simply hold down the power button for 2 seconds and the light will power off.

## **Where can I find the full specs for my light?**

You can find the full specs for each product on their respective product pages at [MPOWERD.com](http://MPOWERD.com).

***We're here for you. For the full list of FAQs and troubleshooting, go to [mpowerd.com/faq](http://mpowerd.com/faq).***

MPOWERD®