

**Autofil™**

# **Stand Cleaning Procedure**

Rev 01

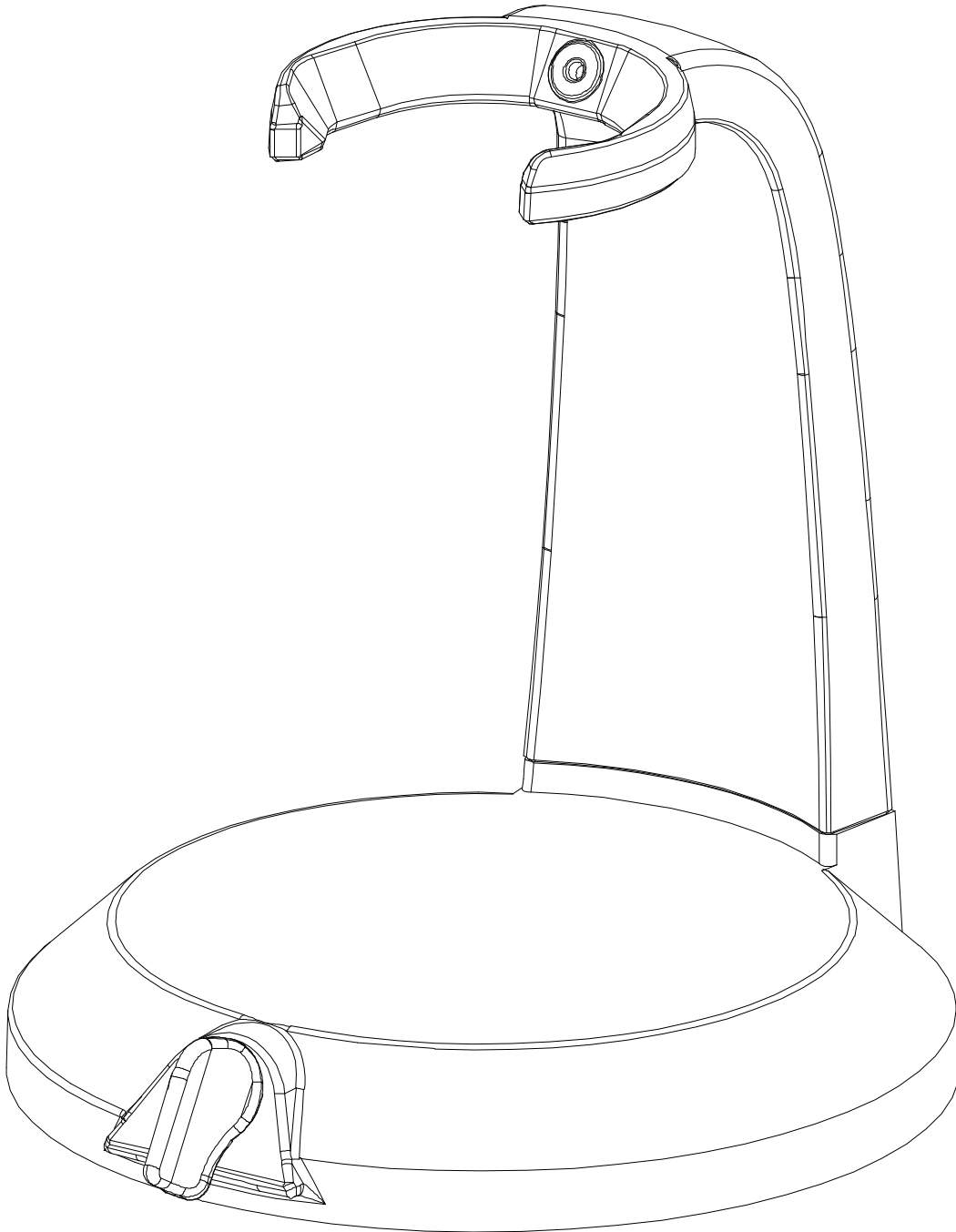

## 1. Introduction:

The Autofil™ filtration system has been designed for use in laboratory environments. The materials of construction are compatible with common disinfectants and sanitizing agents. The smooth contoured design is readily cleaned by spraying or applying a disinfectant and wiping as required.

Under normal operating conditions, fluids should not come in contact with the internal plumbing of the Autofil™ pedestal or cradle ring stand. In the event fluids do come in contact with the internal plumbing, the following procedure can be followed to decontaminate the system.

## 2. Preparing the Sanitizing Agent:

a) The following sanitizing agents can be used:

- Iodophors (follow manufacturers recommended dilution)
- Alcohols (effective dilution is 70-85%)
- Commercially available disinfectants

### NOTE:

Use of hypochlorite (bleach) is not recommended. Prolonged exposure to hypochlorite may cause corrosion to internal stainless steel components. Adequate water rinsing is necessary if hypochlorite solution is used.

b) Prepare 500mL of sanitizing agent in a proper flask or container following manufacturer's recommendation.

## 3. Prepare the pedestal or cradle ring stand for sanitation (refer to illustration below)

a) 1) Inserting a blunt point into the hole and gently remove rubber gasket from the pedestal or cradle ring stand. 2) Insert vacuum tube adaptor into main vacuum port.

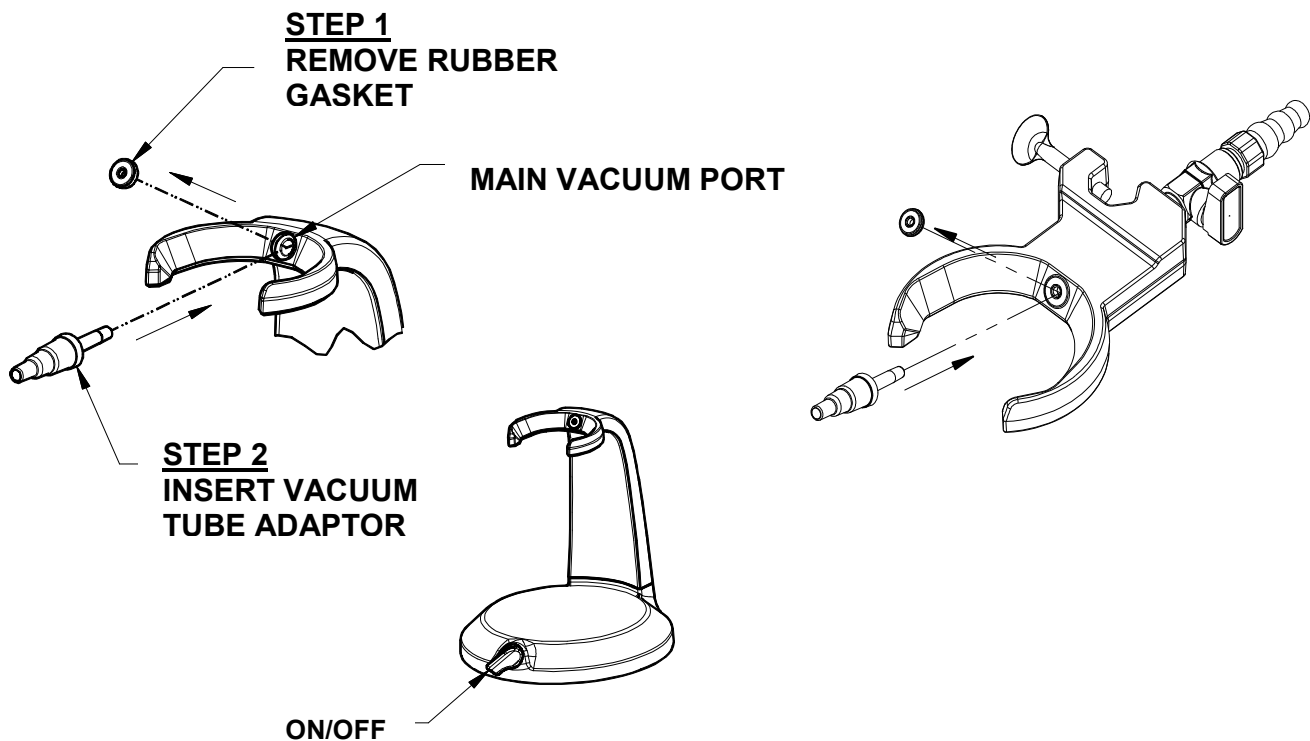

- b) **Assembly vacuum trap for accepting waste solution between vacuum pump and pedestal or cradle ring stand.**

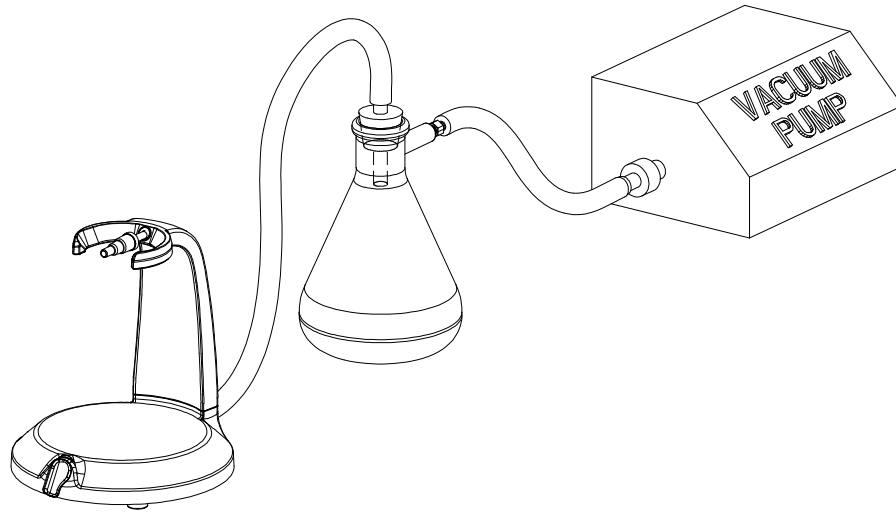

- c) **Attach feed tube to adaptor and place open end into vessel containing sanitizing agent.**

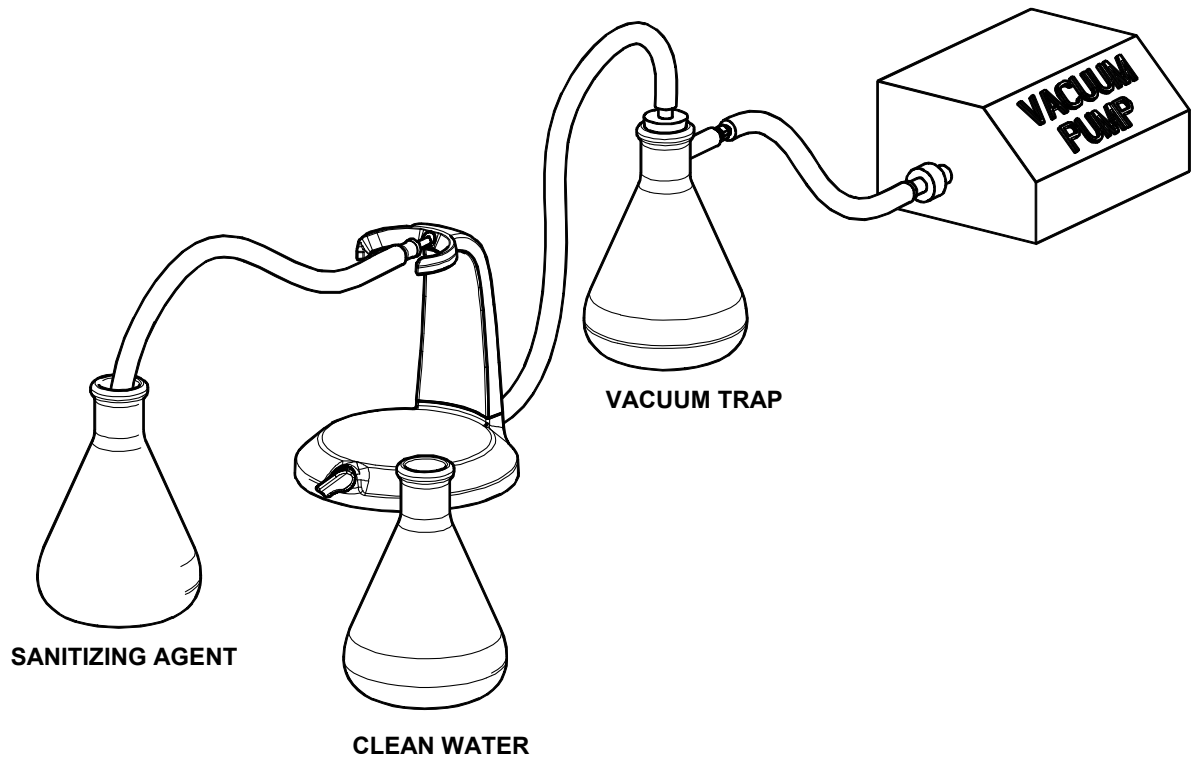

4. Sanitize pedestal or cradle ring stand
- Turn on the vacuum system
  - Draw the 500mL of solution through the pedestal or cradle ring stand and into the vacuum trap.
  - Allow stand to set for 30 minutes prior to rinsing.

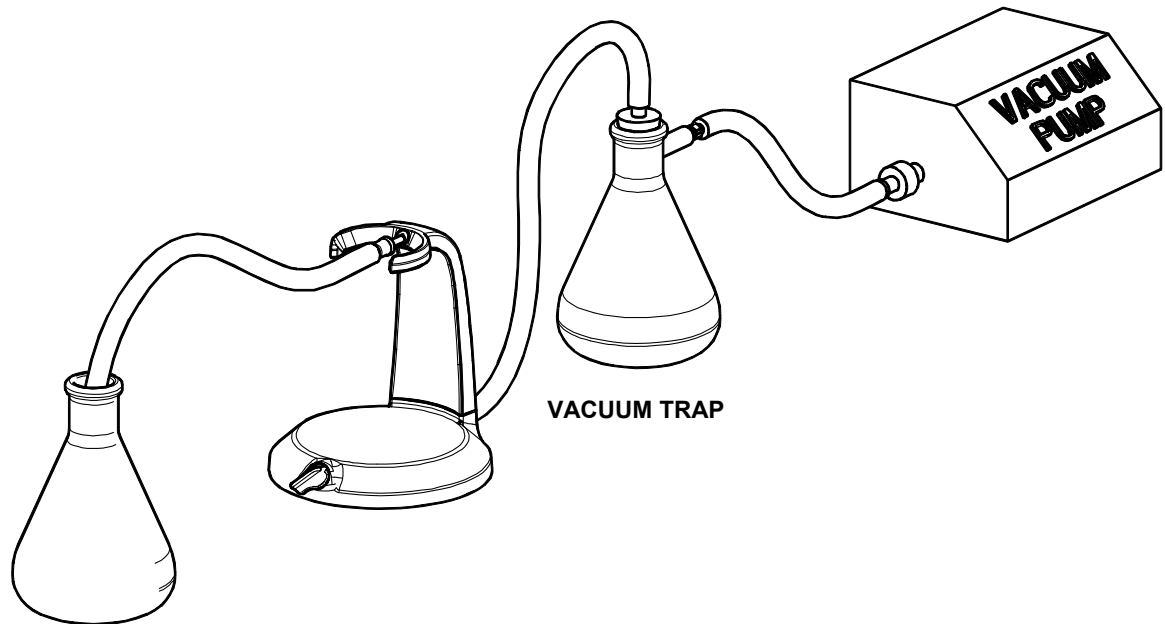

SANITIZING AGENT

- Remove feed tubing from stand and place into clean water container.
- Draw approximately 500mL's of distilled water through the pedestal or cradle ring stand and into vacuum trap to rinse the system

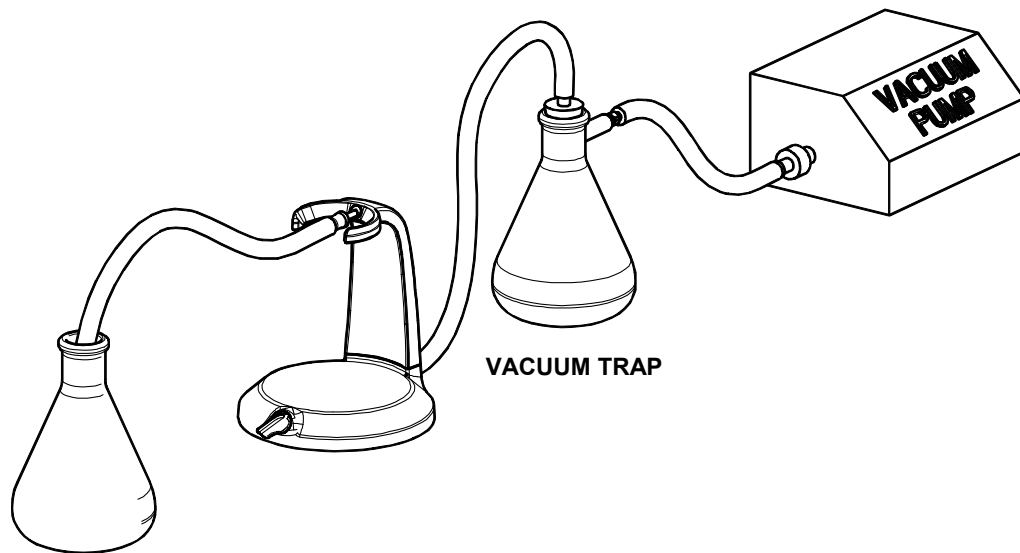

CLEAN WATER