

2022



COMPACT FLOOR SPACE

EASY TO ASSEMBLE

NO MARKS AFTER
DISASSEMBLING

VARIETY OF DIFFERENT
MODELS

LimiKids

FOR YOUR ACTIVE CHILD

- MONKEY BARS ●
- LADDER ●
- CLIMBING NET ●
- CHIN-UP BAR ●
- ROPE ●
- RINGS ●
- TRAPEZE ●
- and much more*

LimiKids

FOR YOUR ACTIVE CHILD



Pegasus



Saturn



Jupiter



Cosmo



Comet



Neptune



Mercury



Olympian



Wall-mounted
Chin-up Bar & Dip-
station

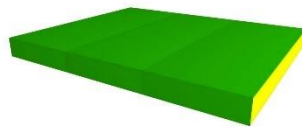

Tri-fold Mat



Bi-fold Mat



Parallel Bars

AND MUCH MORE...

LimiKids

FOR YOUR ACTIVE CHILD

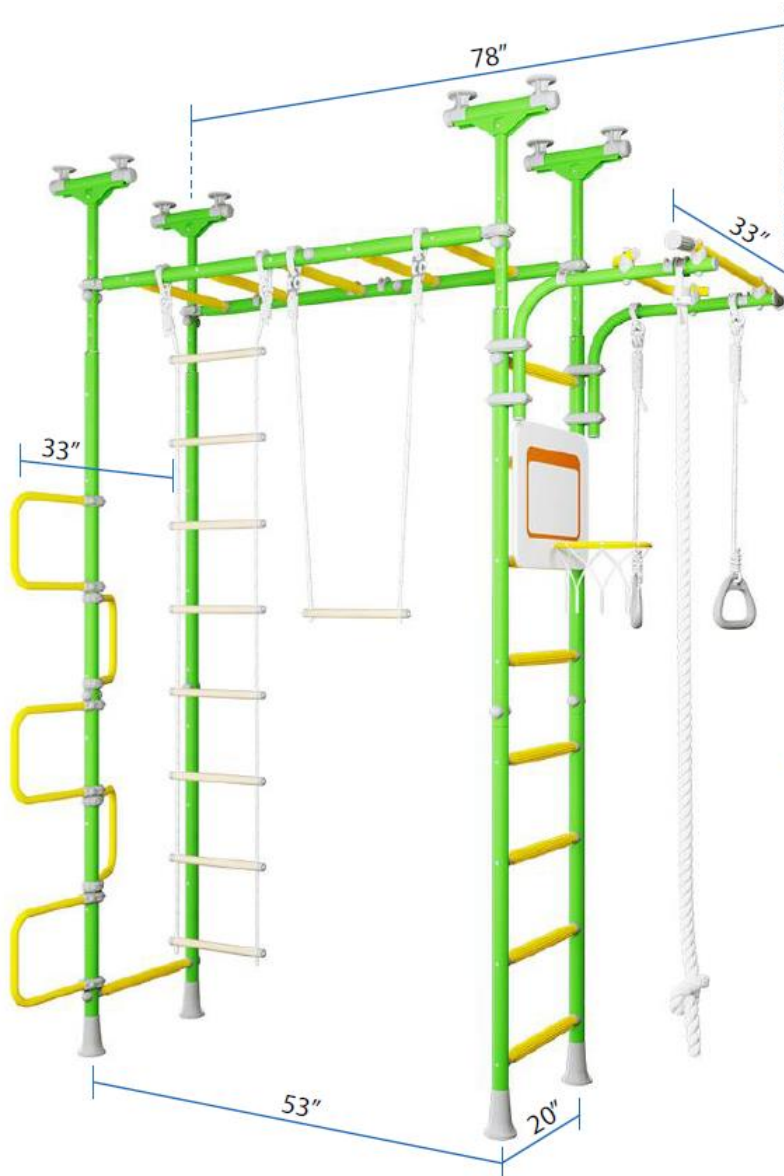

Pegasus	
Type of rung	Metal covered with plastic
Components	<ul style="list-style-type: none"> - Monkey bars - Vertical ladder - Curved ladder - Chin-up bar - Gymnastic rings - Trapeze - Rope ladder - Climbing rope - Basketball ring
Way of mounting	By pressure between floor and ceiling
Ceiling height range	Short Version: 6'9" – 8'9" Regular Version: 7'8" – 9'8"

Approximate floor space:
78" x 34"

Rungs:



Colors of frame:



LimiKids

FOR YOUR ACTIVE CHILD

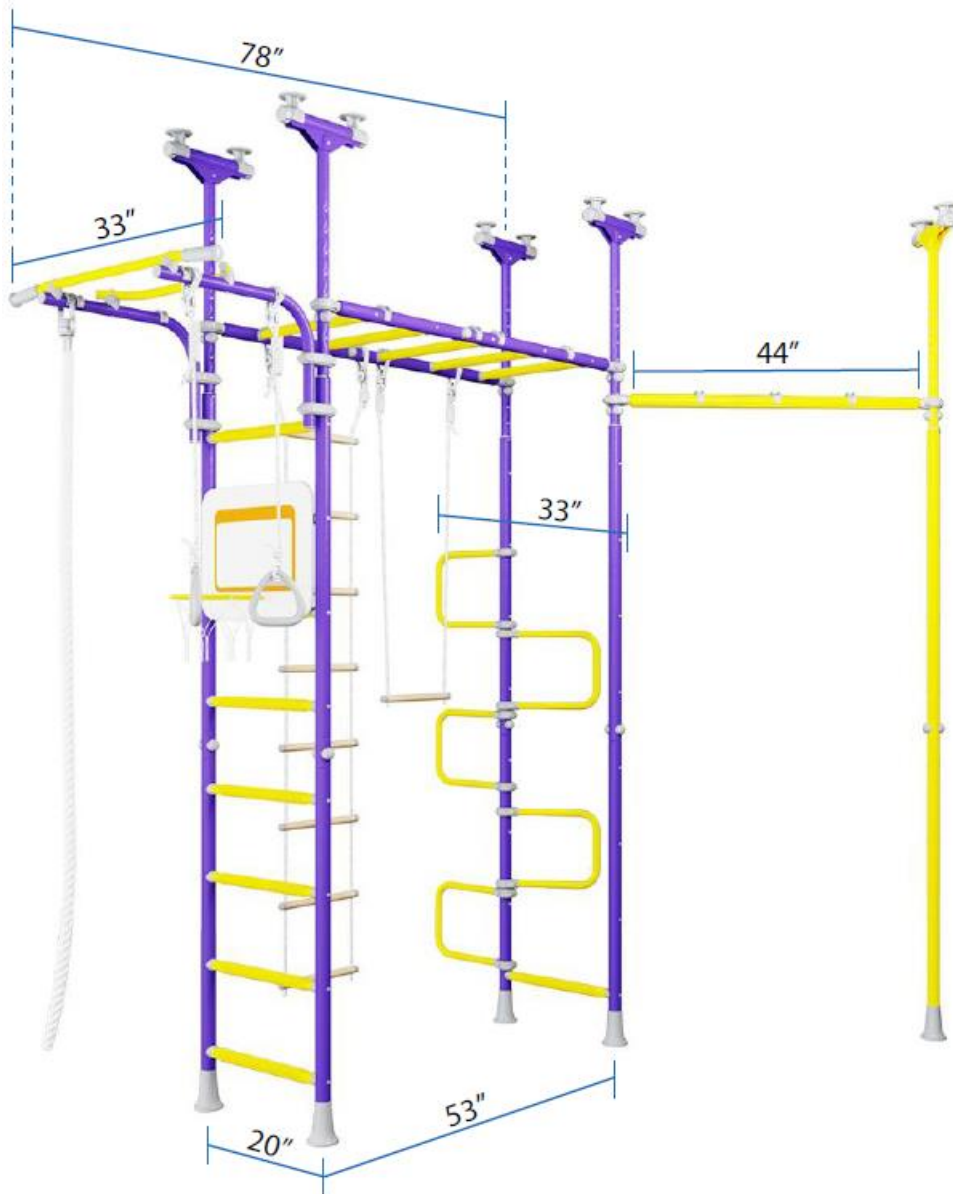

Saturn (Pegasus + Pull-up bar)	
Type of rung	Metal covered with plastic
Components	<ul style="list-style-type: none"> - Monkey bars - Vertical ladder - Curved ladder - Chin-up bar - Gymnastic rings - Trapeze - Rope ladder - Climbing rope - Basketball ring - Additional pull-up bar
Way of mounting	By pressure between floor and ceiling
Ceiling height range	Short Version: 6'9" – 8'9" Regular Version: 7'8" – 9'8"

Approximate floor space:
78" x 76"

Rungs:



Colors of frame:



LimiKids

FOR YOUR ACTIVE CHILD

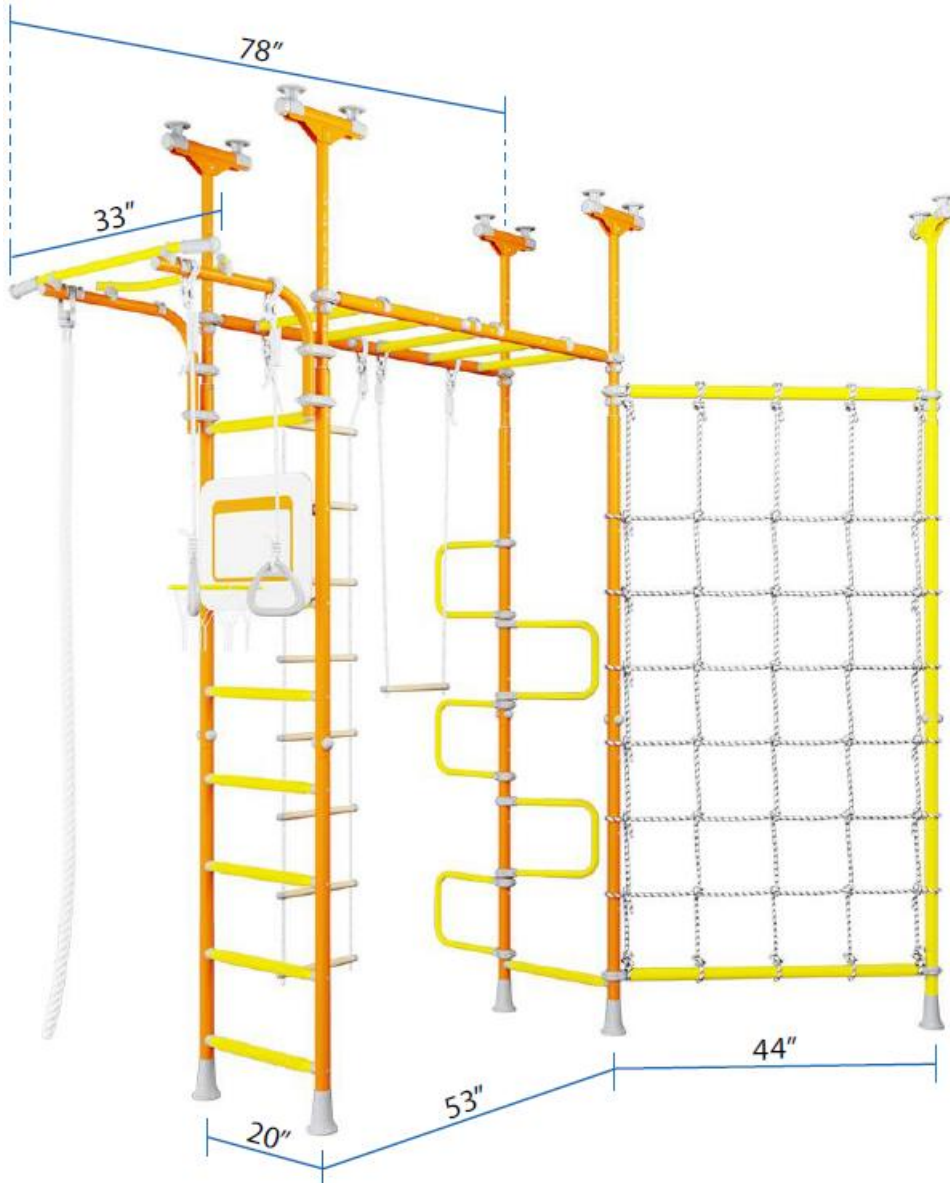

Jupiter (Pegasus + Spider net)	
Type of rung	Metal covered with plastic
Components	<ul style="list-style-type: none"> - Monkey bars - Vertical ladder - Curved ladder - Chin-up bar - Gymnastic rings - Trapeze - Rope ladder - Climbing rope - Basketball ring - Climbing net
Way of mounting	By pressure between floor and ceiling
Ceiling height range	Short Version: 6'9" – 8'9" Regular Version: 7'8" – 9'8"

Approximate floor space:

78" x 76"

Rungs:



Colors of frame:

orange

white

blue

purple

green

LimiKids

FOR YOUR ACTIVE CHILD

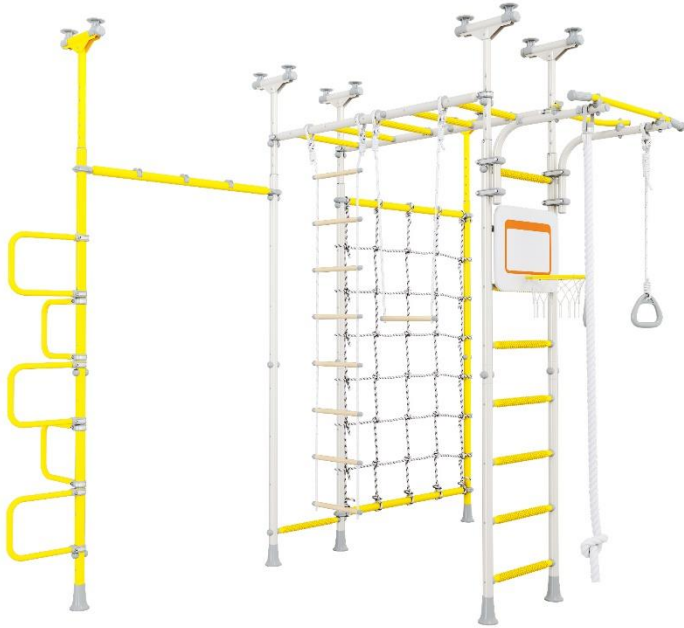

Cosmo (Pegasus + Spider net + Pull-up bar)	
Type of rung	Metal covered with plastic
Components	<ul style="list-style-type: none"> - Monkey bars - Vertical ladder - Curved ladder - Chin-up bar - Gymnastic rings - Trapeze - Rope ladder - Climbing rope - Basketball ring - Climbing net - Pull-up bar
Way of mounting	By pressure between floor and ceiling
Ceiling height range	Short Version: 6'9" – 8'9" Regular Version: 7'8" – 9'8"

Approximate floor space:

78" x 76" or

78" x 120"

Rungs:



** The dimensions depend on how you combine Pegasus with Climbing net and with Additional pull-up bar*

Colors of frame:



LimiKids

FOR YOUR ACTIVE CHILD



Comet	
Type of rung	Metal covered with plastic
Components	<ul style="list-style-type: none"> - Metal ladder - Chin-up bar - Gymnastic rings - Trapeze - Rope ladder - Climbing rope
Way of mounting	By pressure between floor and ceiling
Ceiling height range	Short Version: 6'9" – 8'9" Regular Version: 7'8" – 9'8"

Approximate floor space:

41" x 21"

Rungs:



Colors of frame:

orange

blue

purple

LimiKids

FOR YOUR ACTIVE CHILD

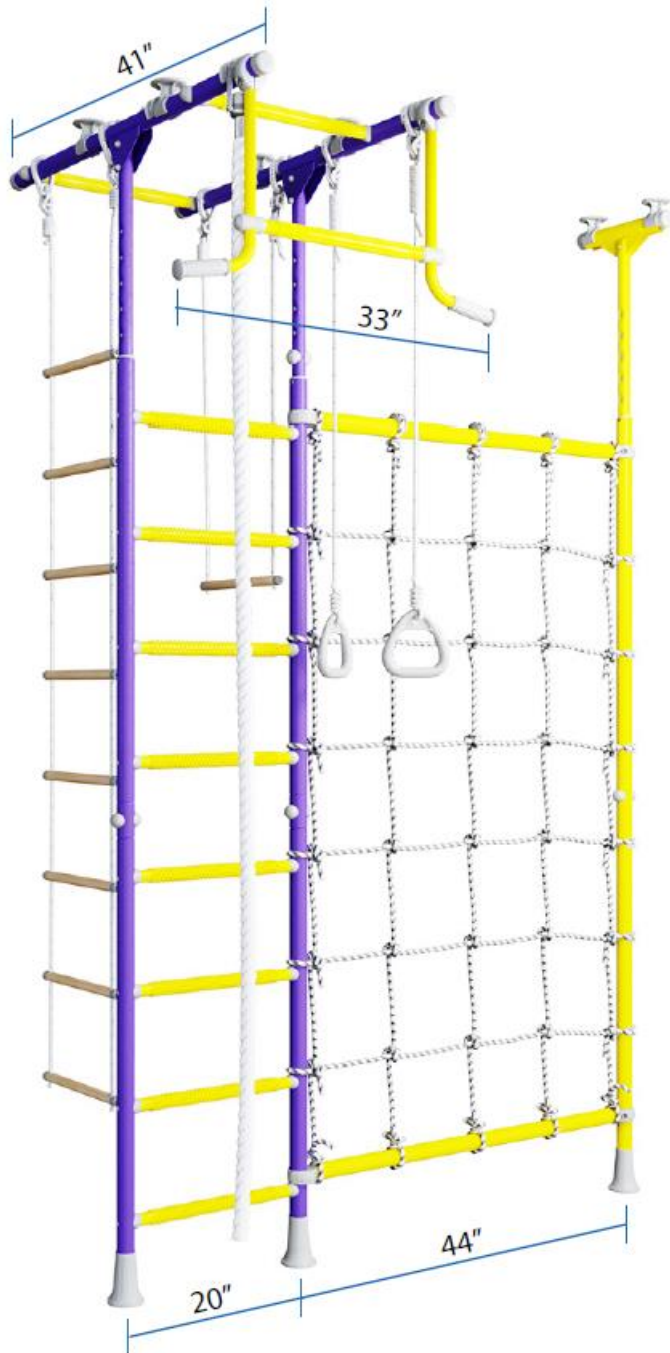

Neptune (Comet + Spider Net)	
Type of rung	Metal covered with plastic
Components	<ul style="list-style-type: none"> - Metal ladder - Chin-up bar - Gymnastic rings - Trapeze - Rope ladder - Climbing rope - Climbing net
Way of mounting	By pressure between floor and ceiling
Ceiling height range	Short Version: 6'9" – 8'9" Regular Version: 7'8" – 9'8"

Approximate floor space:
41" x 64"

Rungs:



Colors of frame:



LimiKids

FOR YOUR ACTIVE CHILD



Mercury (Comet + Pull-up Bar)	
Type of rung	Metal covered with plastic
Components	<ul style="list-style-type: none"> - Metal ladder - Chin-up bar - Gymnastic rings - Trapeze - Rope ladder - Climbing rope - Additional pull-up bar
Way of mounting	By pressure between floor and ceiling
Ceiling height range	Short Version: 6'9" – 8'9" Regular Version: 7'8" – 9'8"

Approximate floor space:

41" x 64"

Rungs:



Colors of frame:

orange

blue

purple

Limikids

FOR YOUR ACTIVE CHILD

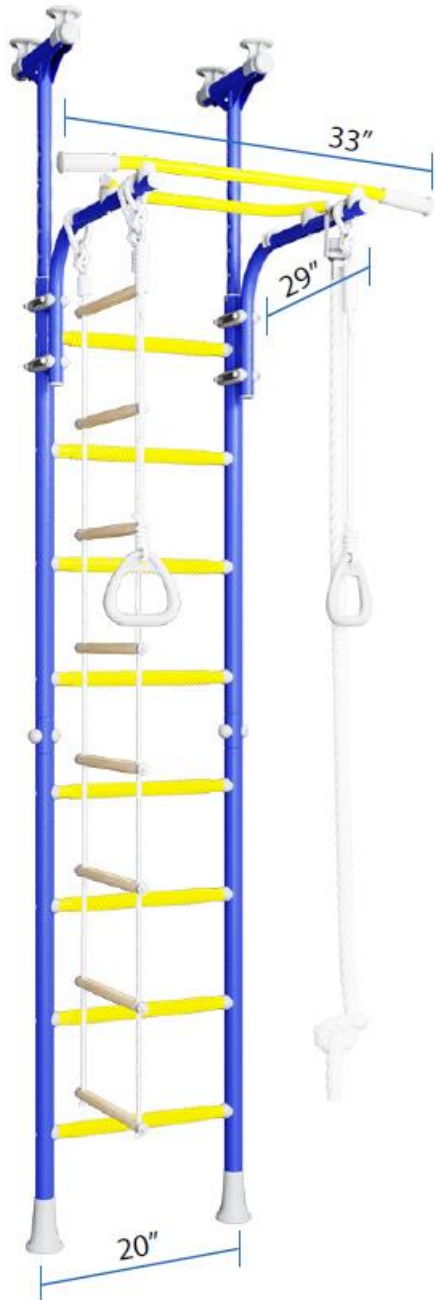

Olympian	
Type of rung	Metal covered with plastic
Components	<ul style="list-style-type: none"> - Metal ladder - Chin-up bar - Gymnastic rings - Rope ladder - Climbing rope
Way of mounting	By pressure between floor and ceiling Or By mounting to the wall (Additional hardware required)
Ceiling height range	Short Version: 6'9" – 8'9" Regular Version: 7'8" – 9'8"

Approximate floor space:

41" x 64"

Rungs:



Colors of frame:

orange

blue

LimiKids

FOR YOUR ACTIVE CHILD



Wall-mounted Chin-up Bar & Dip-Station

Material	Metal
Way of mounting	By mounting to the wall. Included 4 hooks are to be attached to the wall-studs

Color:

white

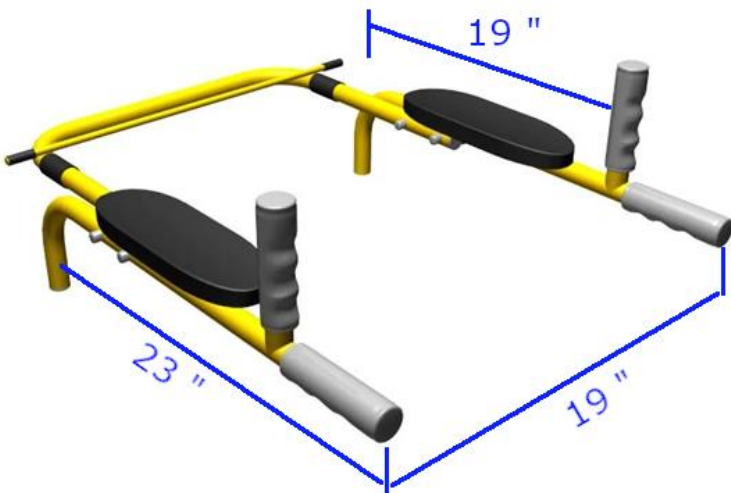

Parallel Bars

Material	Metal
Way of mounting	Stuck between the rungs of the gym (Comet, Pegasus, or Olympian)

Color:

yellow

LimiKids

FOR YOUR ACTIVE CHILD

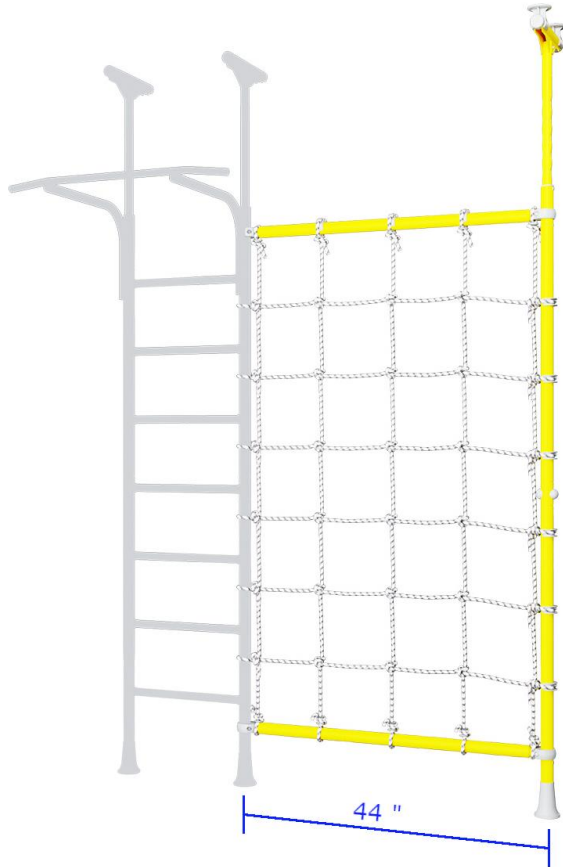

Spider Net	
Material	Metal
Components	- Net - Bar (2) - Pole
Way of mounting	By pressure between floor and ceiling To be connected to any leg of gym
Ceiling height range	Short Version: 6'9" – 8'9" Regular Version: 7'8" – 9'8"
Compatible with models	- Pegasus - Comet - Olympian

Color:

yellow

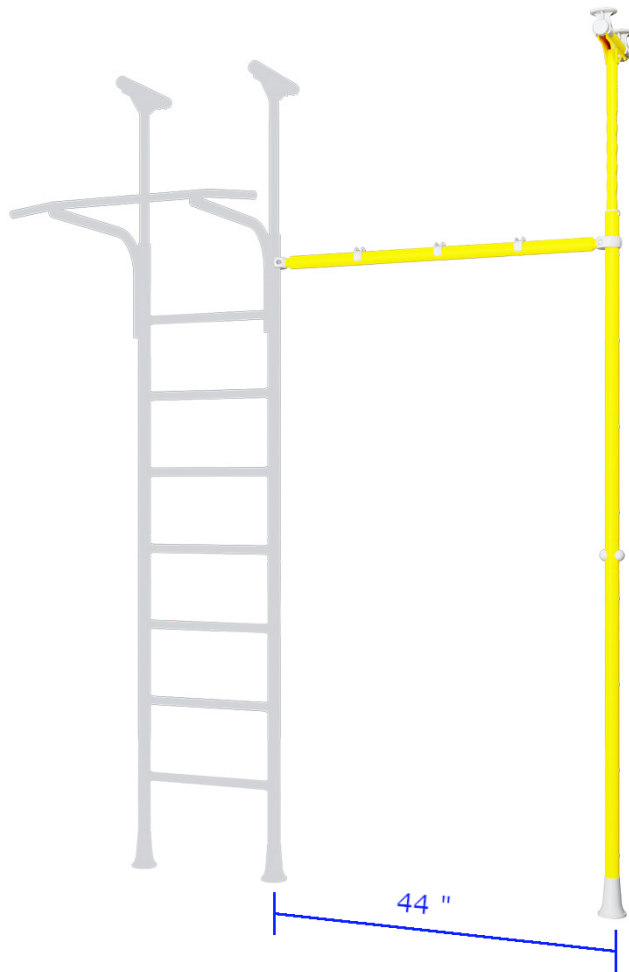

Additional Pull-up Bar	
Material	Metal
Components	- Bar - Pole
Way of mounting	By pressure between floor and ceiling To be connected to any leg of gym
Ceiling height range	Short Version: 6'9" – 8'9" Regular Version: 7'8" – 9'8"
Compatible with models	- Pegasus - Comet - Olympian

Color:

yellow

Limikids

FOR YOUR ACTIVE CHILD



Tepee Tent	
Material	Fabric
Components	- Tent - Pole (4) - Soft Pad



Colors: Beige, Zig-zag