

⚠️ READ INSTRUCTIONS FOR USE MANUAL PRIOR TO FITTING

QUICK REFERENCE CARD | ATK HYDRAPRO

1st time fitting an ATK HydraPro Knee? Have a question?

Call 408-692-5633 ext. 2 to schedule fit support or speak to our clinical specialists.

Position the knee's first axis 20mm posterior to the plumb line bisecting proximal aspect of socket

To promote ease of unlocking, increase toe load. For additional information, refer to *Instructions for Use* manual.

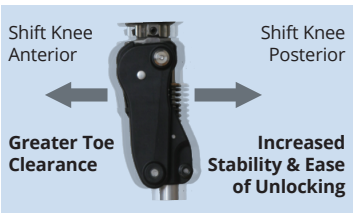

Instructions for Use, Pg. 17

SAGGITAL PLANE ALIGNMENT



Alignment Reference Line
Descends from proximal socket bisecting point

Socket Flexion
3-5° initial flexion

20mm Posterior Offset Line
Extends vertically through first axis

Foot
Per manufacturer's specifications

FLEXION STOP

In maximum flexion, it is vital that a flexion stop is in effect and contacts the All-Terrain Knee in the proper location.

CORRECT

Socket naturally contacts the body of knee below the spring assembly. A flexion stop (e.g. crepe) may need to be affixed to socket to obtain this result.



INCORRECT



Absence of Flexion Stop



Malpositioned Flexion Stop

Instructions for Use, Pg. 18

⚠️ READ INSTRUCTIONS FOR USE MANUAL PRIOR TO FITTING

EXTENSION ASSIST ADJUSTMENTS

The knee is shipped with a medium stiffness (white) extension assist spring installed. For additional options, refer to *Instructions for Use* manual.



Removal (Fig. 1)

Insert flathead screwdriver below the spring base and above horizontal shaft. Compress spring upward and pull outward.

Installation (Fig. 2)

Align horizontal groover of extension assist base with horizontal shaft prior to closing spring assembly.

Instructions for Use, Pg. 22

FRICITION MECHANISM ADJUSTMENTS

With user in parallel bars, adjust as follows:

- If knee does not reach full extension → Turn ↻ by 1/8 turn increments
- If excessive terminal impact → Turn ↻ by 1/4 turn increments



Minimum Friction Setting (MFS)

Failure to achieve MFS causes friction mechanism to loosen and fall off with use. Ensure the friction mechanism cap and disc springs are not loose (i.e. able to rattle or make noise when tapped with a finger). Note: Over-tightening may prevent AutoLock Technology from locking.

For installation & removal instructions, refer to *Instructions for Use* manual, Pg. 20



STANCE FLEXION ADJUSTMENTS

HYD-SF-02 and HYD-SF-03

Adaptor Components

- Proximal pyramid assembly
- Anterior bumper
- Posterior bumper
- Base plate
- Washer & bolt (30 Nm/ 22ft lb)

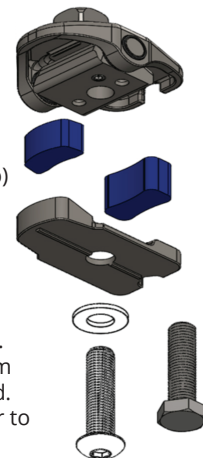

Adjustment requires use of 16mm socket.

Posterior bumper hardness selection is based on preference. The knee is shipped with medium hardness (blue) bumper installed. For additional information, refer to *Instructions for Use* manual.

Instructions for Use, Pg. 15