

# Tissue Paper Roll Clamps



Bolzoni Auramo has a wide variety of tissue paper roll clamps. Clamp capacities range from 1.500 to 6.000 kg (3,000 to 13,000 lbs), and roll diameters are up to 2.700 mm (106") in standard series.

All our standard tissue clamp models have fast and effective 180-degree rotation, which enables effective handling of both vertical and horizontal rolls.

Short and long pivoting arm design makes the clamps versatile with a wide roll diameter range.

Standard tissue clamps are designed for handling on single rolls only, split arm models for handling two rolls are available on request.

Special opening ranges, non-rotating and/or forward tilting clamps are available on request for special applications.



### Engineered to suit the application needs

Tissue paper rolls often have larger diameter than the common other paper grades. Sometimes the roll diameters can be very extensive, even larger than 3000 mm (120") diameters do exist.

The rolls are often very soft and loosely wound.

Tissue clamps are always built to be able to handle large diameter rolls. They also have higher and wider contact pads to reduce surface pressure on the soft paper.

For larger diameters and softer paper grades the contact pads have a special form which is designed to reduce point loads under the pad edges.



### Flat spot compensation

It is very common that large diameter and soft tissue rolls deform somewhat under their own weight when lowered down to the floor in horizontal position.

This deformation causes a flat area on the roll which can in some cases be several hundred millimeters wide. The flat area may cause horizontal roll handling problems unless it is compensated in the clamp design.



### Effective and fast 180 degree rotation

Series AR and RA tissue paper roll clamps have a fast and effective 180-degree rack-and-pinion rotation system.

Rotation is fast and has accurate vertical end positions with cushioning. This increases handling efficiency and reduces possibility for paper roll end damage.



### Slim and thin arms

All Bolzoni Auramo paper roll clamps have in common slim and thin arm design. This makes the clamps easier and safer to handle in confined spaces.

Arms and contact pads have smooth rounded surfaces and corners all around to reduce the possibility for the clamp damaging the roll.



### Built-in pad and arm protection

Bolzoni Auramo tissue roll clamp arms have design features which protect the arms and contact pads from wear and tear.

Arms have built-in pad protection loops. This saves the paper roll as worn pad edges can be very sharp and easily tear the paper roll.



### Specialized tissue paper contact pads

Tissue clamp contact pads have a wide area and specialized pad friction surface selected to match the operation requirements. Depending on the clamp size and application requirements, Bolzoni Auramo offers three contact pad models for tissue clamps.

Contact pads are available with a wide variety of friction surface choices to match the exact application needs.

#### Steering front edge

The pad front edge has a special form, which steers the pad easier around the roll.



#### Thin pad and arm design

The minimized pad thickness ensures good knifing properties when handling tightly stacked and bilge rolls.



#### Safe finish

All sharp edges have been carefully removed. This prevents the pad and arm from cutting the paper.



#### Smooth wear strips on short arm contact pad

Wear strips provide added safety margin against inevitable tear and wear against the floor.



#### Well protected hinge and spring system

Specialized positioning springs and limiter rods keep the pads in correct position.



#### Well-rounded, smooth pad profile

Pad corners have large-radius design and the pads have no protruding parts or edges.



#### Single Radius Pads - for harder tissue paper

Single radius pads are designed to match the varying roll diameters. Best suited for hard or medium-hard tissue paper grades.

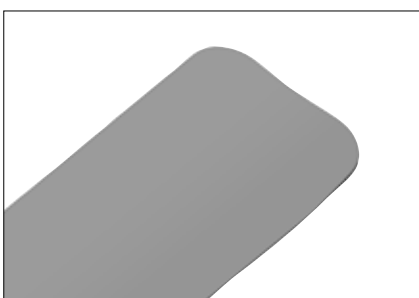

#### Triple Radius Pads - for all tissue grades

Triple radius pads have convexed upper, lower and side edges. This prevents the pad edges from cutting into the paper. These pads are suitable for all types of tissue paper, also for medium-soft and soft paper.

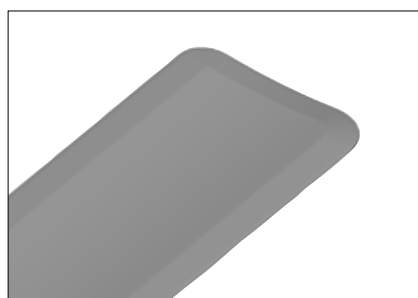

#### Convex Radius Pads - for very soft tissue

Heavy convex pads have a special form, which convexes outwards throughout the entire pad length. This enables the pad to compress the top layers of the paper roll and increase the grip. Suitable for very soft paper grades only.

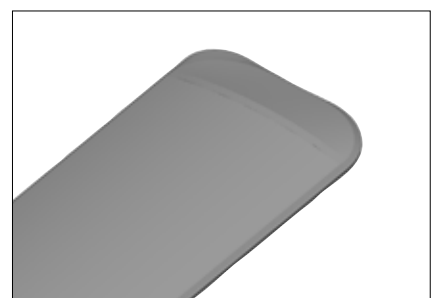

### Contact pads

Contact pads are the most important part of the clamp attachment. In most normal handling situations, the pads are the only parts of the clamp which actually are in contact with the paper roll. Therefore, Bolzoni Auramo has paid special attention in designing and manufacturing contact pads which will ensure safe and non-damaging tissue roll handling.

Typical for tissue paper rolls is a large diameter, and also roll widths can be extensive. Due to low paper grammage the rolls can be very soft as well. These properties make the tissue rolls prone to external damage and difficult to handle with normal paper handling equipment.

Bolzoni Auramo offers dedicated tissue roll clamps which are built for effective and non-damaging handling. These clamps have a wide range of specially designed contact pads.



#### Single radius, Triple radius or Convex radius pads – with wide variety of friction surface options

Select the pad model which best suits your paper rolls and handling requirements.

- Single radius pads for hard and medium-hard paper grades.
- Triple radius pads for hard, medium-hard and soft paper grades, especially on larger roll diameters.
- Convex radius pads for very soft and hard-to-handle large diameter rolls.

All pad sizes and models are available with a wide variety of friction surface choices to match the exact application needs.

#### Single Radius - Rubber faced pads

##### Pad shape:

Single radius specialized tissue paper pad.

##### Friction surface:

Black rubber layer vulcanized onto the pad base. To protect the rubber edges from wear and damage, the front, upper and lower edges of the rubber are sunk into the pad plate. Very good friction properties on all wrapper types. Resistant to wear.

##### Application:

Standard pads on many smaller diameter tissue paper roll clamp models. Optionally available for all models.



#### Triple Radius - Rubber faced pads

##### Pad shape:

Triple radius specialized tissue paper pad. Pad upper, lower and side edges convexed to prevent the pad cutting in soft paper grades

##### Friction surface:

Black rubber layer vulcanized onto the pad base. To protect the rubber edges from wear and damage, the front, upper and lower edges of the rubber are sunk into the pad plate. Very good friction properties on all wrapper types. Resistant to wear.

##### Application:

Standard pads on many large diameter tissue paper roll clamp models. Optionally available for all large diameter tissue roll clamp models.

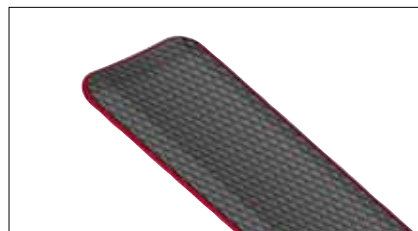

#### Convex Radius - Rubber faced pads

##### Pad shape:

Convex radius specialized tissue paper pad. Special form which convexes outwards throughout the entire pad length.

##### Friction surface:

Black rubber layer vulcanized onto the pad base. Very good friction properties on all wrapper types. Resistant to wear.

##### Application:

Optional pad for large-diameter tissue roll clamps. Recommended for very soft paper grades only.



#### Other tissue clamp contact pads options

Special pad sizes and friction surfaces are available on request.

