

Clamps with Manually Rotating Forks

Models KB-D



The Bolzoni Auramo clamps with manually rotating forks KB-D model are commonly used for handling palletized loads, drums and other baled materials.

The clamps are fitted with forks, which can be locked in 0-, 45- and 90-degree position. This makes the clamps extremely versatile for various applications.

The wide opening range enables easy and safe handling also for the loads exceeding the lift truck width.

The Bolzoni Auramo clamps with manually rotating forks are available in a wide range of capacities and options, representing the solution to the most various handling needs.

Features:

- Very rigid frame structure with single piece double "T" profile. Wide visibility window thanks to new vertical plates position at the extremity of the frame. Narrow vertical plates.
- Superior visibility through the frame grants safe and easy handling operations.
- New check valve for simple and precise arm synchronism, easy fitting, new position in the upper profile shadow granting valve protection and high visibility of the structure.
- New fixing system of the sliding pads to relief stress.
- New self-aligning cylinder fixing to avoid breakage.
- Versions with new separate side shift: cylinder position within the frame window to improve side shifting system. Upper and lower pads with greasers.



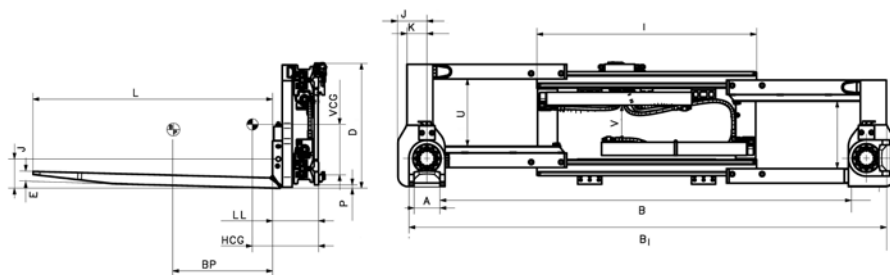

Range: 1000 Kg - 3800 Kg

- Strong double T-profile frame.
- Reduced weight, effective thickness and centre of gravity.
- Excellent visibility.
- Fork positioning at 0°, 45° and 90° positions.
- For the handling of pallets, drums, pipes, rolls, bales, crates and similar loads.

Model	Capacity	Load Centre	Opening Range	Opening Range Clamp	Fork Dimensions	Frame Width	Minimum Carriage Width	Height	Weight	Horizontal Centre of Gravity	Vertical Centre of Gravity	Effective Thickness	Side Visibility	Central Visibility	Mounting Class
	Q1/Q2 kg	BP mm	B mm	B ¹ mm	LxAxE mm	I mm	FL mm	D mm	W Kg	HCG mm	VCG mm	LL mm	U mm	V mm	ISO 2328
KB 10 D4A	1000/1400	500	360-1590	610-1840	1000x100x40	930	690	626	281	189	241	197	337	190	2 A
KB 10 D6A	1000/1400	500	360-1590	610-1840	1200x100x40	930	690	626	292	227	236	197	337	190	2 A
KB 14 D4A	1400/1800	500	300-1530	590-1820	1000x130x40	930	690	626	313	213	221	197	337	190	2 A
KB 14 D6A	1400/1800	500	300-1530	590-1820	1200x130x40	930	690	626	328	255	218	197	337	190	2 A
KB 18 D6A	1800/2300	500	400-1730	720-2050	1200x130x50	970	690	624	410	295	251	230	336	185	2 A
KB 18 D6A EU	1800/2300	500	230-1520	550-1840	1200x130x50	1100	690	624	410	269	154	230	336	185	2 A
KB 22 D6A	2200/2600	500	400-1730	720-2050	1200x130x50	970	690	624	410	295	251	230	336	185	2 A
KB 22 D6A EU	2200/2600	500	230-1520	550-1840	1200x130x50	1100	690	624	410	269	154	230	336	185	2 A
KB 28 D6B	2800/3200	500	400-1730	720-2050	1200x130x50	970	690	715	425	275	310	230	383	240	3 A
KB 28 D6B EU	2800/3200	500	230-1520	550-1840	1200x130x50	1100	690	715	453	272	313	230	383	240	3 A
KB 35 D6B	3500/3800	500	470-1970	820-2320	1200x150x50	1250	930	715	625	235	203	255	376	205	3 A
KB 35 D6B EU	3500/3800	500	180-1430	530-1780	1200x150x50	1150	930	715	592	243	203	255	376	205	3 A

Model	Ground Clearance	Fork Basic Height	Pivot Distance
	P mm	J mm	K mm
KB 10 / KB 14	15	115	105
KB 18 / KB 22	16	145	100
KB 28	45	145	100
KB 35	20	150	115

Notes:

- One hydraulic function required.
- Q1 = capacity when clamping.
- Q2 = capacity on the forks.
- 'EU' models for Europallet handling.
- Check valve with power regeneration hydraulic circuit (for KB 10 – 22).
- Pressure relief valve.
- Forks welded to the arm carriers.
- Forks: max. length 1.600 mm

Options:

- Special openings.
- Separate sideshift.
- Integral sideshift.
- Quick change lower hooks.
- Pressure gauge.
- Load backrest.

