

FOR DETAILED MANUAL AND PARTS FINDER. PLEASE GO TO HERE

有关详细的手册和零件查找器。请到这里

PER MANUALE DETAGLIATO E RICERCA PARTI. PER FAVORE, VAI QUI

FÜR DETAILLIERTE HANDBUCH UND TEILESUCHE. BITTE GEHEN SIE HIER

POUR LE MANUEL DÉTAILLÉ ET LA RECHERCHE DE PIÈCES. VEUILLEZ ALLER ICI

詳細なマニュアルと部品の詳細については。ここに行ってください



Visit us on www.carisma-shop.com
請到: www.carisma-shop.com
Visitateci su www.carisma-shop.com
Besuchen sie uns auf www.carisma-shop.com
Visitez notre site www.carisma-shop.com
www.carisma-shop.com で私運を訪問します

©2022 Carisma. All Rights Reserved. Product specifications are subject to change.

Some models shown are prototypes which may vary slightly from what is inside.

©2022 商標及著作権所有。产品规格可能有变动。显示的一些模型是初型。可能与商品内部略有不同。

©2022 Carisma. Tutti i diritti riservati. Le caratteristiche del prodotto sono soggette a modifiche.

Alcuni prodotti mostrati sono prototipi e possono differire leggermente da quanto fornito.

©2022 Carisma. Alle Rechte vorbehalten. Die Eigenschaften der Produkte können Änderungen unterliegen.

Einige dargestellte Produkte sind Prototypen und können leicht von dem Inhalt unterscheiden.

Copyright 2022 Carisma. Tous droits réservés. Les spécifications du produit peuvent changer. Certains

modèles présentés sont des prototypes qui peuvent être légèrement différents du modèle commercialisé.

©2022年カリスマ。すべての権利予約します。製品の仕様は予告変更。モデルがプロトタイプから中身が若干異なる場合があります。

Printed in China
中国印刷
Stampato in China
Bedruckt in China
Imprimé en Chine
中国で印刷されます。

MAN-600821



USER MANUAL & SETUP GUIDE

用户手册和设置指南

MANUALE D'USO E DI MONTAGGIO

Bedienungs - und Bauanleitung

Manuel de l'utilisateur et guide de réglages

ユーザー マニュアル ・ セットアップ ガイド



Trail Start



Welcome to the world of Carisma SCA-1E Adventure. This is just the starting point on a journey that for many will undoubtedly last a lifetime. Where it eventually leads you to is your own choice. The first step was simply opening the box, the next will be entirely up to you.

Find that perfect location, drive from point A to point B, soaking in the scenery along the way and truly becoming one with your environment. The World is so diverse, it's terrain varied and challenging, but the SCA-1E offers the perfect Travelling Companion to embracing it all, head on...

The rig offers tried and trusted Off Road features like a Solid Axle, 4WD Driveline, a centrally located Transmission and Motor, True 4-Link Suspension, Adjustable Coil Over, Oil Filled Shocks, and Soft Compound, Thickly Treaded Scale Tyres. The electrics Splash proof, the Steering Servo High Torque and 2.4GHz Radio System, safe and Interference Free.

The bodysell can be left completely stock or personalised to your own level of additional detail. You can alter the weight bias and how the rig physically drives by adjusting the main packs location, or adding Wheel Weights. Improve its extreme abilities by adding a Remote Winch to the front bumper and to aid Night Running, optional LED lights. The Electronic Speed Control is set into Crawler Mode as standard, offering instant reverse and an always on Drag Brakes. This improves the rigs ability to descend steep inclines under compete Electronic Descent Control.

Look at the SCA-1E as a blank sheet of paper. You decide its future feature set and abilities, and in turn it will help shape your own personal destiny. Thank you for becoming another member of the fast-growing Global Scale Community, and Carisma RC Family. We hope that you enjoy every aspect of the journey.

Life is short, so truly live it, one #CarismaScaleAdventure at a time!



SAFETY PRECAUTIONS

Thank you for your purchase of the Carisma SCA-1E Rig. With proper use and regular, basic maintenance, this rig will provide you and all those who drive it hours of reliable RC fun! Please read this manual to fully understand its features, capabilities, and the best operation of the product. Should you have a technical question or need replacement parts, please contact your local Carisma RC dealer, original place of purchase or our dedicated web Shop: <http://www.carisma-shop.com>. You may also contact us direct via e-mail at: webmaster@carisma-shop.com

WARNING

Read the **ENTIRE** instruction manual to become familiar with the features of this product before operating. This is a sophisticated hobby grade product. It must be operated with caution and common sense. It will require some basic mechanical ability. Failure to operate this product in a safe and responsible manner could result in injury or damage to the product, persons, or other property. This product is not intended for use by children without direct adult supervision. Do not use with incompatible components or alter this product in any way outside of the instructions provided by Carisma RC. This manual contains instructions for safe operation and maintenance. It is essential to read and follow all the instructions and warnings in the manual, prior to assembly, setup, or use. If you are not prepared to accept these condition, please return this product immediately to place of purchase.

CAUTION:

This product is intended for ages 14+ Users under 18 years of age require parental supervision.

Do not expose any battery or component to open flame or other source of high temperature.

You must read the enclosed instruction manual completely prior to using this product.

Do not use any charger except the one included to charge the battery.

Never leave a battery unattended during charging.

Do not expose any components to moisture.

Always avoid water exposure to all equipment that's not specifically designed and protected for this purpose.

As the end user of this product, you are solely responsible for operating in a manner that does not endanger yourself and others, or result in damage to the product, or property of others.

Always carefully follow the directions and warnings for this, and any optional equipment (chargers, etc.).

This model is controlled by a radio signal subject to interference from many sources outside your control.

Never place any portion of the vehicle in your mouth as it could cause serious injury or even death.

Always operate your vehicle in open space away from full-size vehicles, traffic, people, and animals.

Always keep a safe distance in all directions around your model to avoid collisions or injury.

Always keep all chemicals, small parts, and anything electrical out of the reach of children.

Always keep transmitter powered on while your vehicle is power on.

Always remove batteries after use or before disassembly.

Never operate your vehicle with low transmitter batteries.

Always keep your vehicle in sight and under control.

Never operate your vehicle with damaged wiring.

Always let parts cool after use before touching.

Always keep moving parts clean and dry.

Always use fully charged batteries.



WHAT'S IN THE BOX



TOOLS RECOMMENDED (NOT INCLUDED)

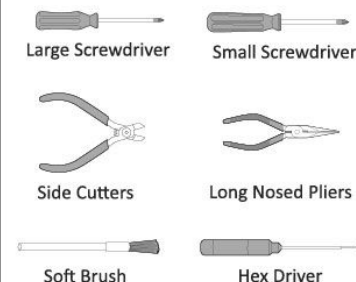

CTX-2000 2.4GHz FHSS Technology System

The following is an overview of the various functions and adjustments found on CTX-2000 radio system. It is important to read and understand about all of these functions and adjustments before driving.

FUNCTIONS

TRANSMITTER CTX-2000

Steering Wheel : Control direction (Left/Right) of the RC model.
Throttle Trigger : Control speed and direction (Forward/Brake/Backward) of the driving model.

ON / OFF Switch : Power ON / OFF the transmitter.
SW1 Button : Is used to synchronize the connection between the transmitter and the receiver. It also serves as additional function on different model.

LED Indicator : For indicating battery low, pairing in progress and normal operation.

ATV : Adjust the maximum steering angle on both sides when model turns Left / Right.

ST. Trim Dial : Adjust the neutral position of steering servo when model wheels are straight ahead.

TH. Trim Dial : To adjust the throttle position

Steering Reverse : Reverse the response direction when operating Steering Wheel.

Throttle Reverse : Reverse the response direction when operating Throttle Trigger.

Throttle Limit Switch : Set the max Forward Speed of the model.

* In general, user will experience under steer when making a wide turn at high speed or over steer when making sharp turn at high speed (easy to spin out). User should practice the Throttle and steering approach for different cornering at different speed or road surface.

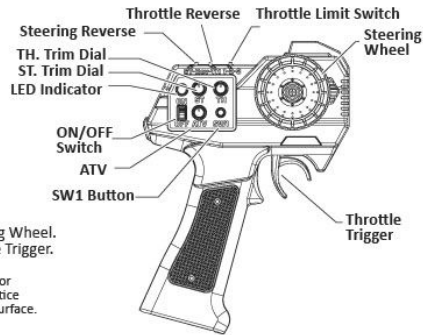

Battery Installation

1. Supplied with 4 x 1.5V AA Batteries, radio can be operated a few hours.
 Installation: Remove the battery compartment cover as shown below.

2. Install the batteries observing the polarity marked on battery compartment.

3. Then reinstall the battery compartment cover as the Picture shown below.

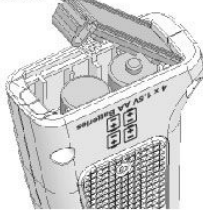

Warning :
 Never disassemble batteries or put the batteries in fire, chemical agents, otherwise they may cause personal injuries or property damages.

Battery Disposal :
 Observe corresponding regulations about wasted battery treatment regulations.
 1. After running out of power, dispose of wasted batteries in designated areas far away from water supply, household areas and planted areas.
 2. Submit the wasted batteries to specific recycling stations.

Battery LED Indicator

The LED solid on indicating that the batteries have sufficient power. When batteries voltage drops below 4 volts, LED will Flash, indicating batteries power is low and should be replaced.

Solid ON :
 Sufficient Power supply

Flashing ON :
 Time to replace batteries

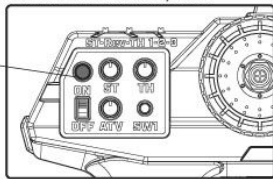

ATV

ATV enables to adjust the maximum steering angle of servo on both sides (Left and Right) when model makes steering. The ATV affects the sensitivity of servo. Reducing dual rate value can lower the sensitivity of servo and reduce the same maximum steering angle on both sides. Remember to adjust the ATV within the adjustment range.

ATV

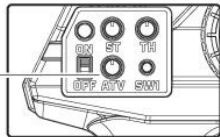

Pre-Run Check

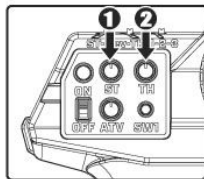

1. **Steering** : Adjust the steering trim to keep the front wheels in straight line when steering wheel remains in NEUTRAL position.

2. **Throttle** : Adjust the throttle trim to make the motor stop while throttle trigger at NEUTRAL position.

* Always turn on the transmitter first. If the LED is not solid on, you need to check whether the batteries are good or incorrectly installed.

Reversing

Steering Reverse: Reverse the response direction when operating steering wheel. Turning left steering wheel, the model turns right while turning right the model turns left.

Throttle Reverse: Reverse the response direction when operating throttle trigger. Pushing forward throttle trigger the model moves backward while pulling back, the model moves forward. If necessary you can just use a small screwdriver to adjust the responding switches.

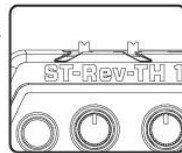

Throttle Limit Switch

The slide switch to select the max forward speed:

- 1: Slowest
- 2: Intermediate
- 3: Fastest



SCA-1E Electrics



ARC-2 Full Setup Manual



MBC-24 USB Charging

The SCA-1E comes supplied with a USB Trickle Charger. The MBC-24 is designed to charge a 7.2V NiMH battery ONLY. Note: DO NOT CHARGE ANY OTHER TYPE OF BATTERY. It is NOT intended for LiPo or Li-ion packs.

When connected to a standard USB power source, a red LED will light up indicating that the power is ON. The trickle output current is 100mA, and has a safe charging time for a fully drained battery to fully charged of about 14 hours. After charging, disconnect the USB charger, the battery should feel slightly warm. Part charged packs will peak much faster, so if the battery becomes warm early on in charge cycle, please disconnect the USB charger and run until fully discharged. It is always best to fully discharge and cycle NiMH packs. It may take a few cycles for your pack to reach its full potential.

Note: Always charge the battery under supervision and do not leave the charging battery unattended. The red LED will NOT turn off, it only indicates power is present to charger.

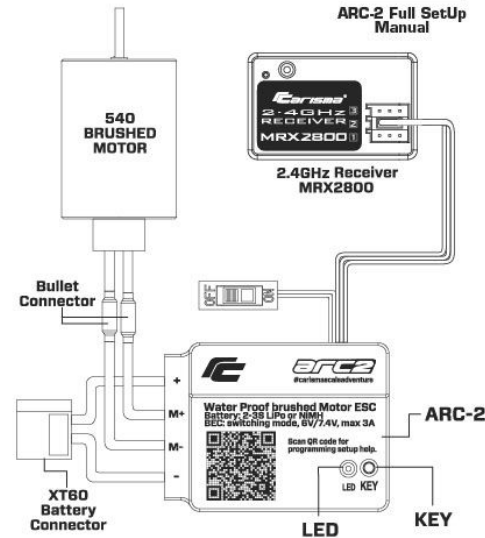

LED Battery Type Indicator (When The ESC Is Powered Up):

LED flashes for 2 seconds to indicate the currently cell type:

Green Flash: Cell Type = NiMH **Red Flash:** Cell Type = LiPo

ESC 'Mode' Indicator: (TX Throttle Remains Untouched)

- Green LED solid on (Forward/Reverse with Smart Brake)
- Fast Flashing Green LED (Forward Only with Brake)
- Slow Flashing Green LED (Beginner Mode with Smart Brake)
- Red + Green solid on (Crawler Mode with Descent Brake)

'In Use' LED Indicator:

- Forward (not full speed): All LED off
- Forward (full speed): Red LED on
- Reversing (not full speed): All LED off
- Reversing (full speed): Green LED on
- Brake: Red & Green LED solid on
- Overheat: Alternately flashing Red & Green LED quickly & beep quickly
- Motor Stalled: Flashing Red quickly 3 times, stop for a while & repeat again & beep quickly
- Under Voltage: ESC disables motor output, Green Solid ON, Red LED flashes once per second with Beep.
- Battery Over Voltage (Battery is Over 13V): Red LED & Green LED flashing together

ESC Calibration Process Using TX

1. Turn on the transmitter, ensure all parameters (D/R, Curve, ATL) on the throttle channel are at default. (For transmitter without LCD, please turn the throttle "TRIM" to exact centre.) Also please ensure the "ABS/braking function" of your transmitter is DISABLED.

2. Start with transmitter on and the ESC turned off but connected to a battery. Hold the SET button and turn on the ESC, both Red and Green LED on the ESC starts to flash (Note: the motor beeps at the same time), then release the SET button immediately. (Note: Sound level of Beeps from the motor may be low sometimes, and you can check the LED status instead).

3. **Setting Neutral Point, Full Throttle & Full Brake Endpoints:**

- Leave transmitter at the NEUTRAL position, press the SET button, the RED LED will then flash once and then the motor beeps once to confirm the ESC has accepted the neutral position.
- Pull the throttle trigger to the FULL THROTTLE position, press the SET button, the RED LED then blinks twice and the motor beeps twice confirming the ESC has accepted the full throttle endpoint.
- Push the throttle trigger to the FULL BRAKE position, press the SET button, the RED LED then blinks three times and the motor beeps three times confirming the ESC has accepted the full brake endpoint. **Calibration is Now Completed.**

Setting the ESC parameters Using The External Program Card (MPG-1)

1. Connect the ESC 3 wire ribbon cable to the program card (ensure correct polarity)
2. Connect Battery to ESC, and then power on ESC
3. Program Card LED Indicator:
 - Far Left 2 digit = Item number/Description of Function
 - Far Right digit = Value of this item
4. Program Card Key:
 - Left most key to select item
 - Next Key to decrease the value of this item
 - Next Key to increase the value of this item
 - Right most key to save the data

Item	Description	1	2	3	4	5	6	7	8	9
1	ESC Mode	Fwd/Rev/w Smart Brake	Fwd Only	Beginner w Smart Brake	Crawler(**)					
2	Battery Type	NIMH (**)	LiPo							
3	Cut-off	OFF	Auto (**)							
4	BEC Volt	6V (**)	7.4V							
5	In Crawler Mode = Descent Control in Other modes = Trail Brake	OFF	ON (**)							
6	Init Start Force	0% (**)	2%	4%	6%	8%	10%	12%	14%	16%
7	Start Punch	OFF (**)	Weakest	————— (**) —————						Strongest
8	Max Forward Power	25%	50%	75%	100% (**)					
9	Max Rev Power	25%	50% (**)	75%	100%					
10	Max Forward Acc.	10%	20%	30%	40%	50%	60%	70%	80%	100% (**)
11	Max Reverse Acc.	10%	20%	30%	40%	50%	60%	70%	80%	100% (**)
12	Max Brake Force	0%	12.50%	25%	37.50%	50%	62.5%	75%	87.5%	100% (**)
13	Init Brake Force	0% (**)	6.25%	12.50%	18.75%	25%	31.25%	37.25%	43.75%	50%
14	Drag Brake	0%	3%	5%	7%	9%	20%	30%	60%	100% (**)
15	Neutral Range	20us	25us	30us	35us	40us (**)	45us	60us	80us	120us
16	PWM Freq	1KHz	2KHz	4KHz	8KHz (**)	16KHz	32KHz			
17	ABS (not active in Crawler Mode)	OFF (**)	ON							
18	ABS Freq	Slowest	————— (**) —————						Fastest	
19	ABS Point	0%	5%	10%	15% (**)	20%	25%	30%	35%	40%
20	ABS stroke	10%	20%	30% (**)	40%	50%	60%	70%	80%	90%
21	Stall Detection	OFF	ON (**)							

(**) = default setting

Please Note:

PWM KHz Frequencies: Have the following effect on throttle finesse and ESC temp. The higher the PWM KHz value, the more throttle finesse, but the greater the increase the ESC temperature. The lower the PWM KHz value, the lower the finesse, and in turn the ESC temperature.

ABS Feature: In Crawler mode (Mode 4), No ABS is used, hence, ABS parameters are ignored in Crawler mode.

BEC Voltage: Only select 7.4V when using HV Servos & HV Compatible Receiver.



CE Compliance Information For The European Union

Carisma hereby declares that this product is in compliance with the essential requirements and other relevant provisions of the RED Directive 2014/53/EU, EN 301 489-1 V2.1.1, EN 301 489-17 V3.1.1, ETSI EN 300 328 V2.1.1

The associated regulatory agencies of the following countries recognize the noted certifications for this product as authorized for sale and use.

UK	DE	DK	BG	SE	CZ	ES	NL	SK	HU	RO	FR	PT
FI	EE	LV	LT	PL	AT	CY	SI	GR	MT	IT	IE	LU

Products: CTX-2000, ARC-2
Equipment Class: 2

FCC Information
FCC ID YDCTX-2000
Item Name : CTX-2000 2.4GHz Transmitter

The objects of declaration described above are in conformity with the requirements of the specifications listed below.
Manufactured By : Mun Ah Plastic Electronic Toys Company, Ltd
Statement - This device complies with Part 15 of the FCC Rules.

Operation is subject to the following two conditions:

- (1) this device may not cause harmful interference, and
 - (2) this device must accept any interference received, including interference that may cause undesired operation.
- Changes or modifications not expressly approved by the party responsible for compliance could void the user's authority to operate the equipment.
RF Exposure Warning:
This equipment complies with FCC radiation exposure limits set forth for an uncontrolled environment.
And should be operated with minimum distance of 20 cm between the antenna & your body.

Instructions for Disposal of WEEE by Users in the European Union

This product must not be disposed of with other waste. Instead, it is the user's responsibility to dispose of their waste equipment by handing it over to a designated collection point for the recycling of waste electrical and electronic equipment. The separate collection and recycling of your waste equipment at the time of disposal will help to conserve natural resources and ensure that it is recycled in a manner that protects human health and the environment. For more information about where you can drop off your waste equipment for recycling, please contact your local city office, your household waste disposal service or where you purchased the product.

NCC Warning Statement

Article 12

Without permission, any company, firm or user shall not alter the frequency, increase the power, or change the characteristic and functions of the original design of the certified lower power frequency electric machinery.

Article 14

The application of lower power frequency electric machineries shall not affect the navigation safety nor interfere a legal communication, if an interference is found, the service will be suspended until improvement is made and the interference no longer exists.

FCC Information

This equipment has been tested and found to comply with the limits for a Class B digital device, pursuant to part 15 of the FCC Rules. These limits are designed to provide residential protection against harmful interference in a residential installation. This equipment generates, uses, and can radiate radio frequency energy and, if not installed and used in accordance with the instructions, may cause harmful interference to radio communications. However, there is no guarantee that interference will not occur in a particular installation. If this equipment does cause harmful interference to radio or television reception, which can be determined by turning the equipment on and off, the user is encouraged to correct the interference by one or more of the following measures: Reorient or relocate the receiving antenna. Increase the separation between the equipment and the receiver. Connect the equipment into an outlet on a circuit different from that to which the receiver is connected.

FCC Warning:

The equipment may generate or use radio frequency energy. Changes or modifications to this equipment may cause harmful interference unless the modifications are expressly approved in the instruction manual. Modifications not authorized by the manufacturer may void the user's authority to operate this device. This device complies with part 15 of the FCC Rules. Operation is subject to the following two conditions (1) This device may not cause harmful interference, and (2) this device must accept any interference received, including interference that may cause undesired operation.
The device has been evaluated to meet general RF exposure requirement. The device can be used in portable exposure condition without restriction.

Limited Warranty

Warranty Period: Carisma R/C warrants that the CTX-2000 ("Product") will be free from original factory defects in materials and workmanship upon purchase ("Warranty Period"). What is Not Covered - This warranty is not transferable and does not cover (a) cosmetic damage, (b) damage due to acts of God, accident, misuse, abuse, negligence, commercial use, or due to improper use, installation, operation or maintenance, (c) modification to any part of the Product, (d) attempted service by anyone other than a Carisma R/C authorized service center, or (e) Product not purchased from an authorized Carisma RC dealer.
OTHER THAN THE EXPRESS WARRANTY ABOVE, Carisma RC MAKES NO OTHER WARRANTY OR REPRESENTATION, AND THEREFORE DISCLAIMS ANY AND ALL IMPLIED WARRANTIES, INCLUDING, WITHOUT LIMITATION, THE IMPLIED WARRANTIES OF NON-INFRINGEMENT, MERCHANTABILITY AND SUITABILITY FOR A PARTICULAR PURPOSE. THE PURCHASER ACKNOWLEDGES THAT THEY ALONE HAVE DETERMINED THAT THE PRODUCT WILL MEET THE REQUIREMENTS OF THEIR INTENDED USE.

Purchaser's Remedy - Carisma RC's sole obligation and purchaser's sole and exclusive remedy shall be that Carisma RC will, at its option, either (a) service, or (b) replace, any Product determined by Carisma RC to be defective. Carisma RC reserves the right to inspect any and all Product(s) involved in a warranty claim. Service or replacement decisions are at the sole discretion of Carisma RC. Proof of purchase is required for all warranty claims. SERVICE OR REPLACEMENT AS PROVIDED UNDER THIS WARRANTY IS THE PURCHASER'S SOLE AND EXCLUSIVE REMEDY.

Limitation of Liability

CARISMA RC SHALL NOT BE LIABLE FOR SPECIAL, INDIRECT, INCIDENTAL OR CONSEQUENTIAL DAMAGES, LOSS OF PROFITS OR PRODUCTION OR COMMERCIAL LOSS IN ANY WAY, REGARDLESS OF WHETHER SUCH CLAIM IS BASED IN CONTRACT, WARRANTY, TORT, NEGLIGENCE, STRICT LIABILITY OR ANY OTHER THEORY OF LIABILITY, EVEN IF CARISMA RC HAS BEEN ADVISED OF THE POSSIBILITY OF SUCH DAMAGES.

Further, in no event shall the liability of Carisma RC exceed the individual price of the Product on which liability is asserted. As Carisma RC has no control over use, setup, final assembly, modification or misuse, no liability shall be assumed nor accepted for any resulting damage or injury. By the act of use, setup or assembly, the user accepts all resulting liability. If you see the purchaser or user are not prepared to accept the liability associated with the use of the Product, purchaser is advised to return the Product immediately in new and unused condition to the place of purchase. This warranty gives you specific legal rights, and you may also have other rights which vary from country to country, or state to state. Carisma RC reserves the right to change or modify this warranty at any time without notice.

MUN AH PLASTIC ELECTRONIC TOYS CO., LTD.
Flat G, 21 Floor, Kingsway Industrial Building,
Phase 2, 173 - 175 Wo Yi Hop Road,
Kwai Chung, N.T., Hong Kong.

Note: For official Carisma RC spare parts, see your local hobby shop or place of purchase first. If unavailable, parts can be ordered direct at: <http://www.carisma-shop.com>

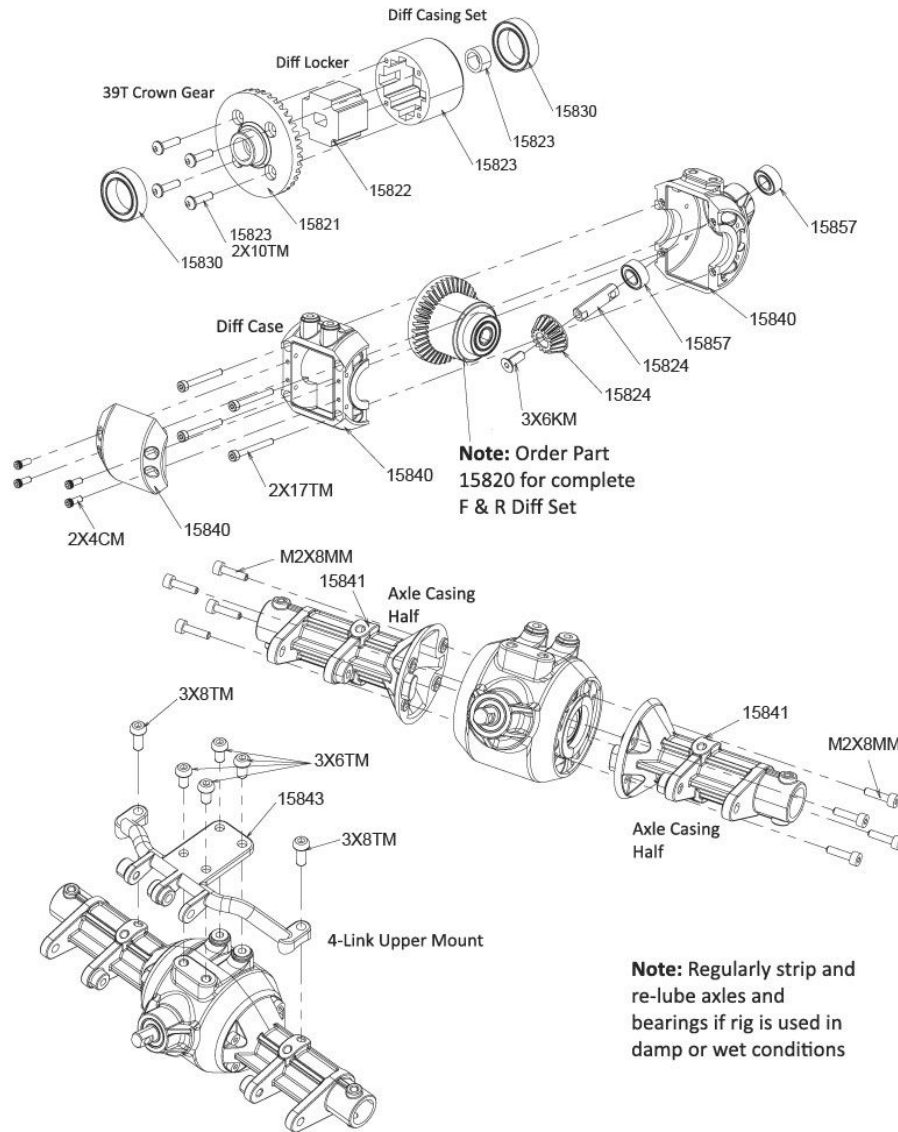

Note: Order Part 15820 for complete F & R Diff Set

Note: Regularly strip and re-lube axles and bearings if rig is used in damp or wet conditions

PART DESCRIPTION

15820	F & R Differential Set
15821	39T Differential Crown Gear
15822	Differential Locker
15823	Differential Casing Set
15824	16T Differential Input Pinion Gear
15830	SCA-1E CENTER DIFFERENTIAL SET

15840	F & R Differential Case
15841	F & R Axle Casing Half
15843	4-Link Upper Mount
15844	SCA-1E FRONT STEERING C HUB
15845	Front Steering Knuckle
15857	Bearing Set (5x10x4, 10x15x4)
15861	Front CVD Shaft

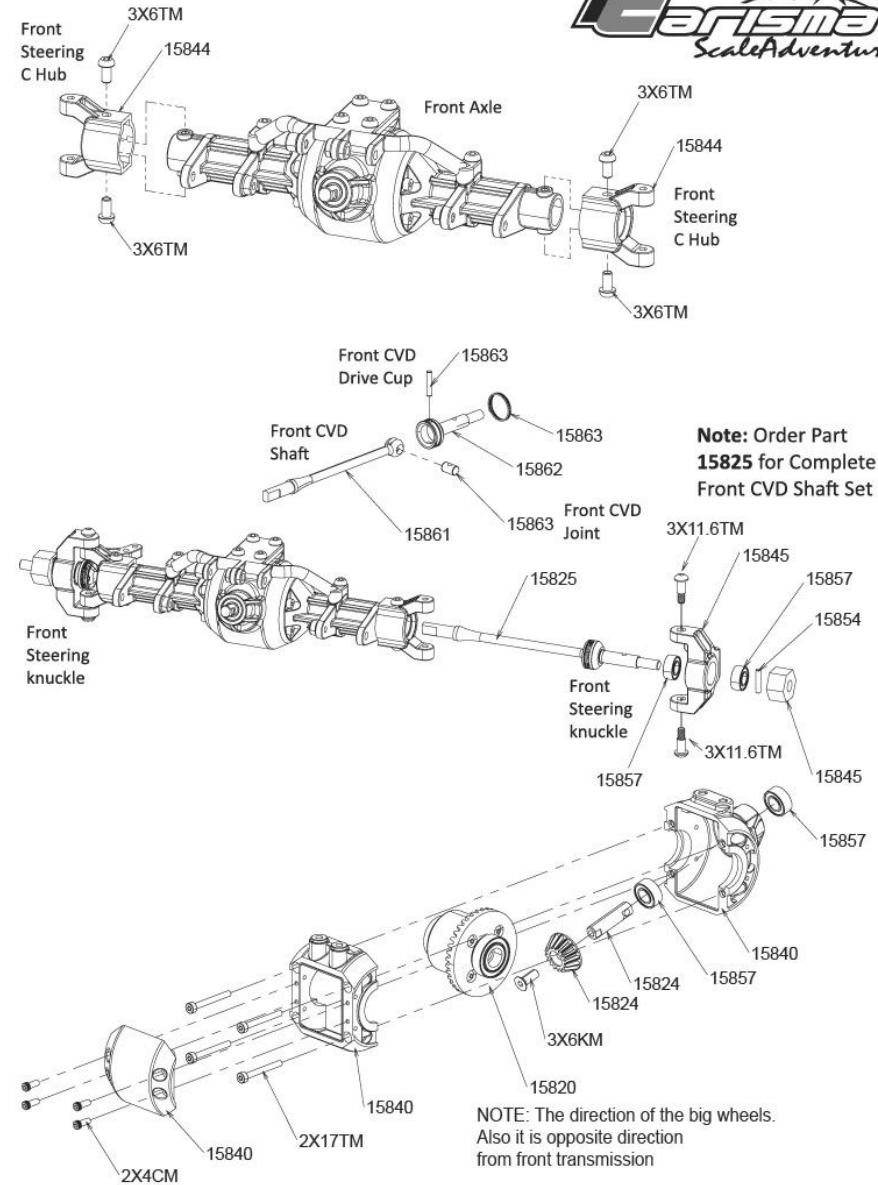

Note: Order Part 15825 for Complete Front CVD Shaft Set

NOTE: The direction of the big wheels. Also it is opposite direction from front transmission

15862	Front CVD Drive Cup
15863	Front CVD Joint
16024	SCA-1E DIFFERENTIAL TUBE SPACER

Rear Axle In Stock RTR Format

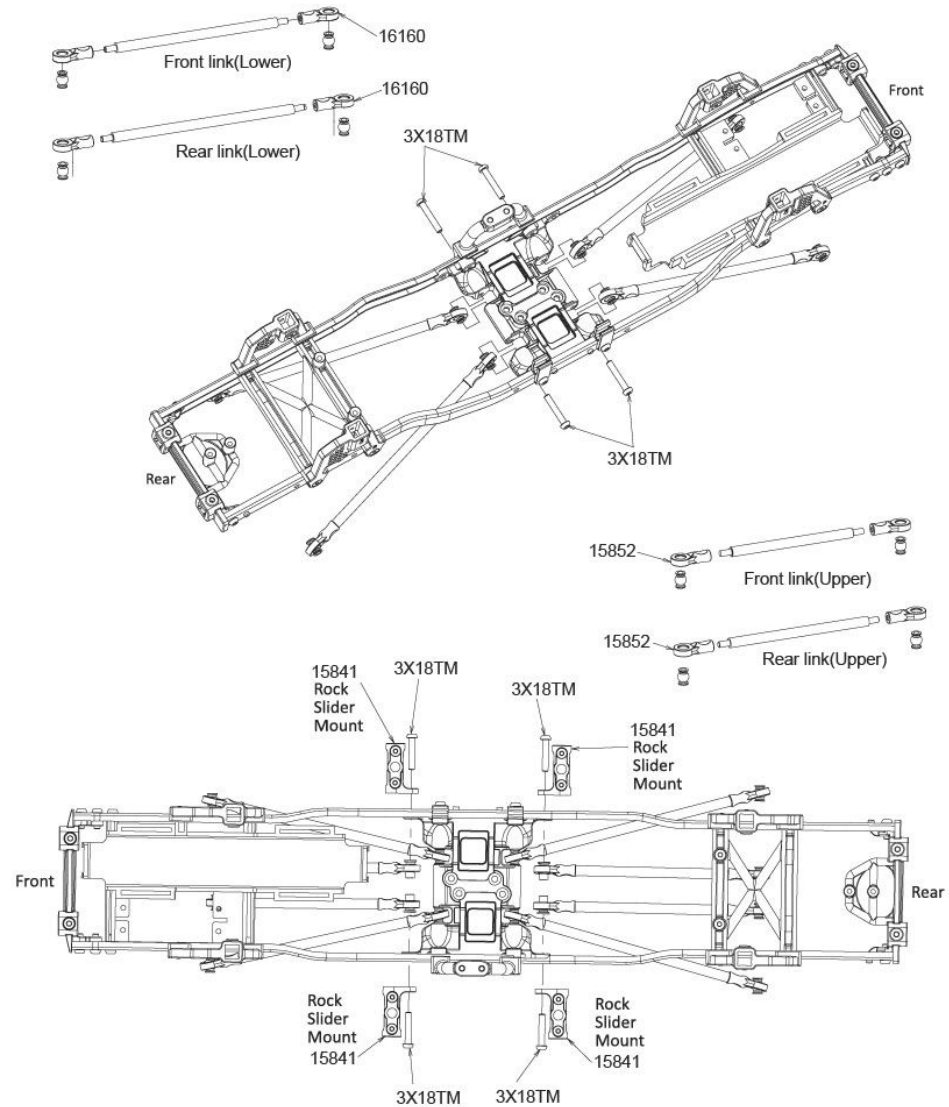
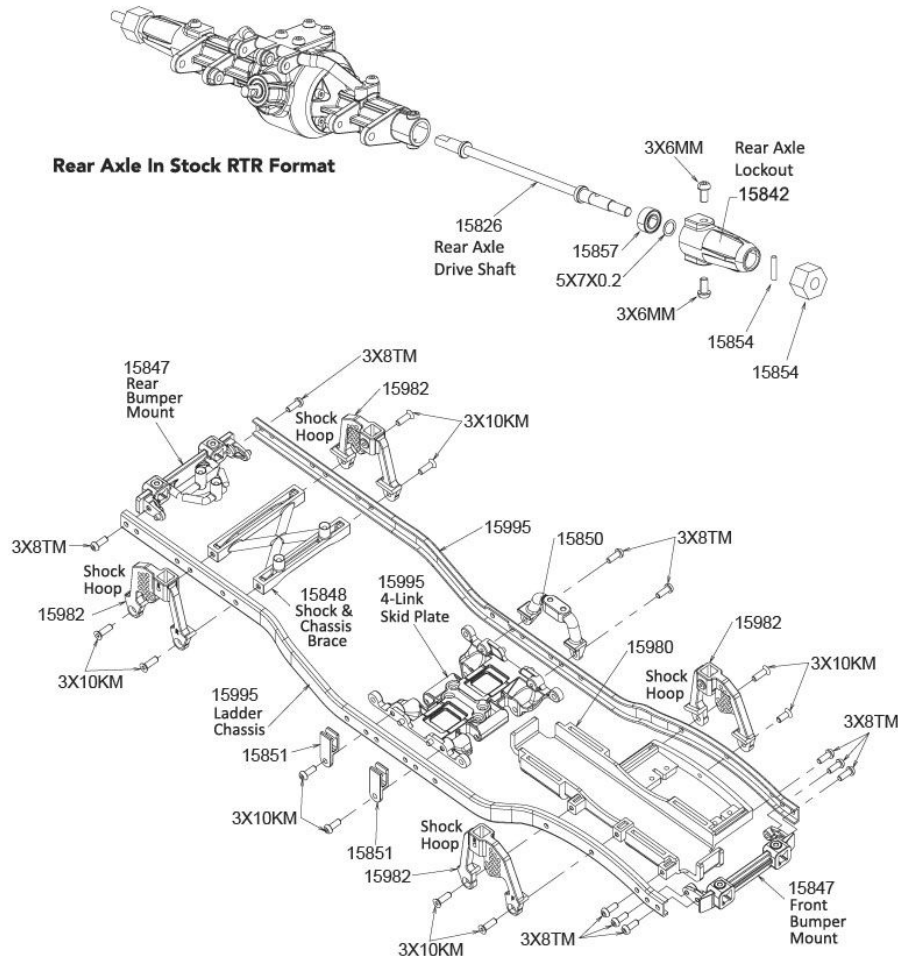

PART DESCRIPTION

15826	Rear Axle Drive Shaft	15851	Body Posts & Motor Guard
15841	F & R Axle Casing Half	15852	Steering Link
15842	Rear Axle Lockout	15857	SCA-1E Bearing & Bushing Set
15847	F & R Bumper Mount + F&R Shock Hoop	15872	4-Link Skid Plate
15848	F & R Shock & Chassis Brace	15980	SCA-1E Chassis Mounted Servo and Forward Mounted Battery Tray Set
15850	Center Differential Mount		

15982	SCA-1E F & R V2 SHOCK & BODY POST MOUNT SET
15995	SCA-1E CENTER DIFFERENTIAL SET
16160	SCA-1E Link Set

SCA-1E Shocks

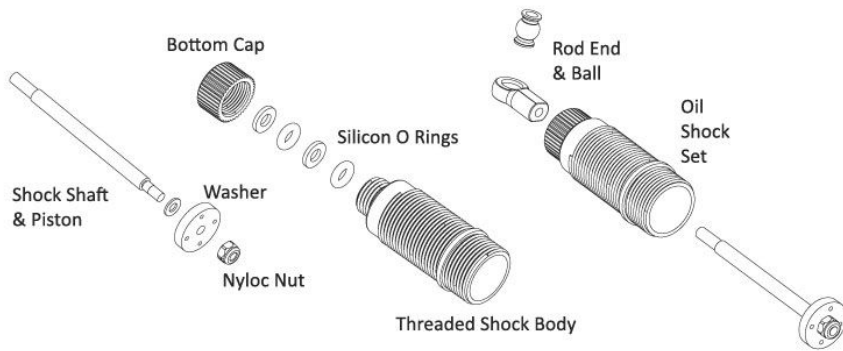

Note: Shock oil and spring choice affects the driving characteristics of your rig. The thicker the oil is, the slower the shock piston moves inside the shock body and the slower the rig can react to differences in your chosen running surface. Too thin and the rig can become unpredictable when crawling and suffer from excessive Torque Twist. This is a phenomenon where the torque of the driveline is transferred through the axles and shocks on one or more corners of the rig compress to compensate. All solid axle rigs suffer from this to some extent, but with the right oil, springs and pre-load applied to the shock/shocks that compress, this can be vastly improved.

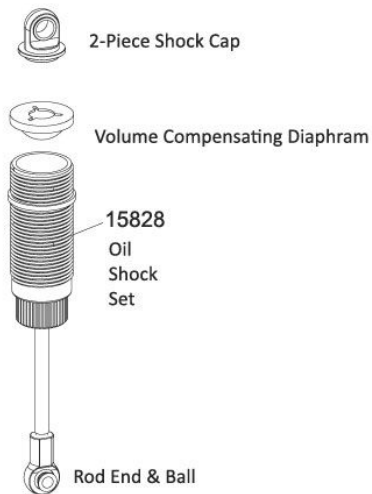

SCA-1E Stock Shock Specs:
Springs: Soft from Medium
Oil: Front = 35W Rear = 35W

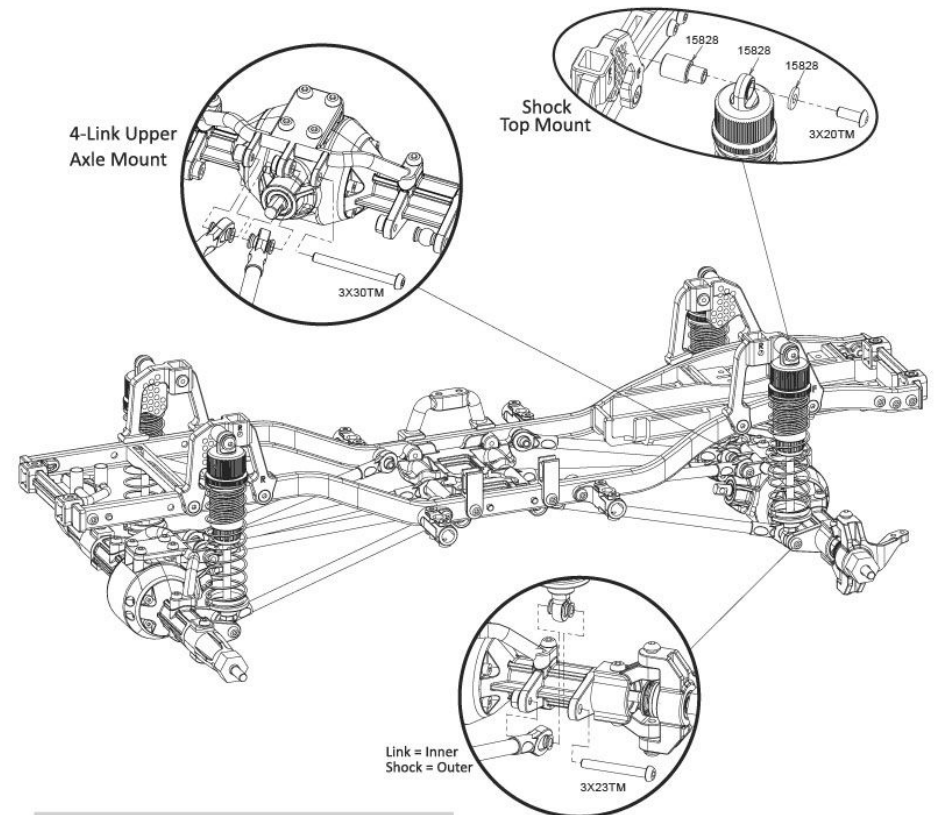
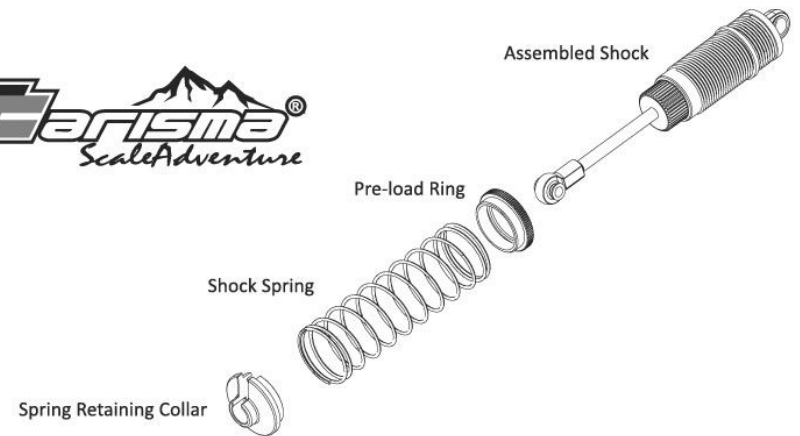

PART DESCRIPTION

15828 Oil Shocks Set

Note: Uper & lower links are “Double Triangulated” for a more stable chassis geometry & reduction in “Axle Steer”

4-Link Upper Axle Mount

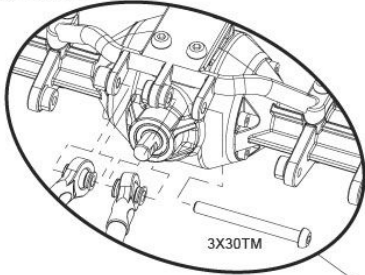

Shock Top Mount

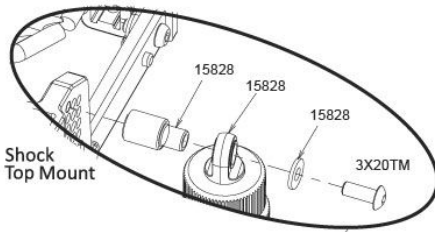

Rear Axle & Shocks

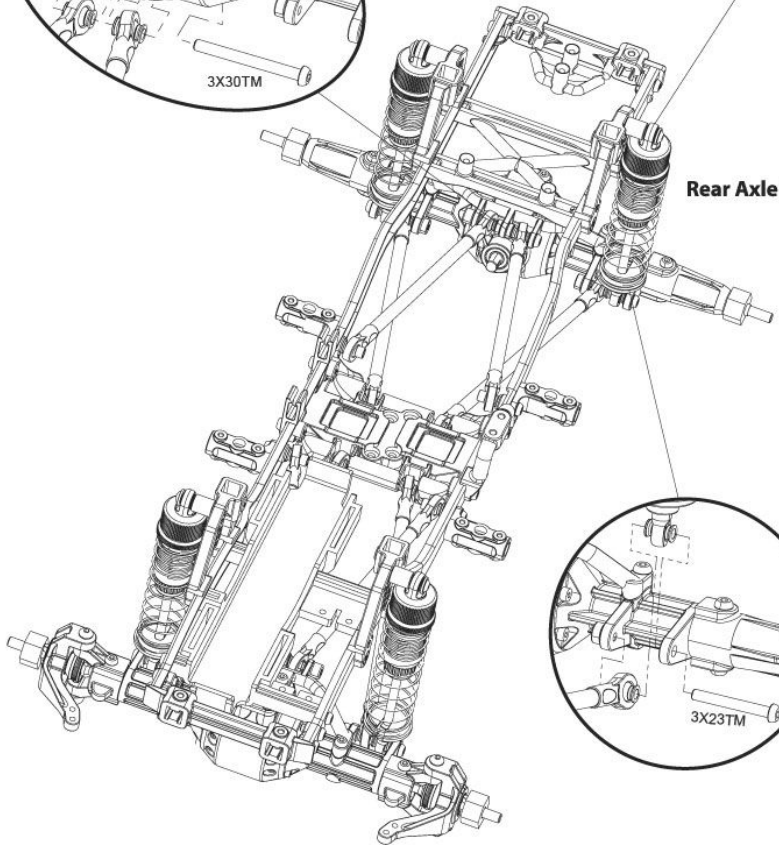

Note: Axle Steer is when an axle (front or rear) moves in a front to back arc as it articulates, making the rig crab. The end result being innacurate & unpredictable handling.

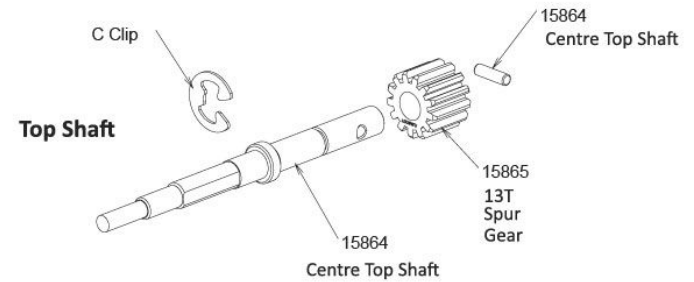

Note: With the stock 14T Pinion and 83T Spur gear the final drive ratio of the transmission is 37.34. This means that for every fifteen turns of the Motor, the Transmissions outdrives turn just once. This offers the locked axles (and in turn the wheels and tyres) a lower wheel speed and lots of crawling Torque.

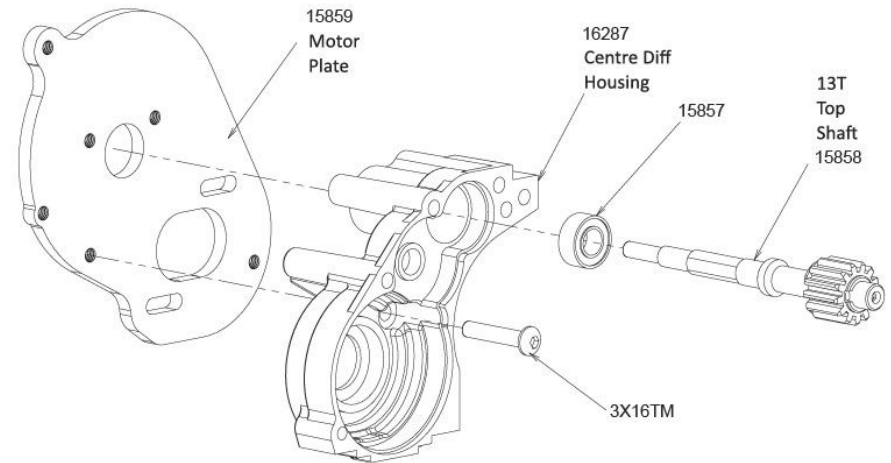

PART DESCRIPTION

- 15828 Oil Shocks Set
- 15857 Bearing Set (5x10x4, 10x15x4)
- 15858 Center Top Shaft assembly (13T)

- 15859 Motor Plate
- 15864 Center Top Shaft
- 15865 Top Spur Gear 13T
- 16287 SCA-1E COYOTE 2.1 ATT TRANSMISSION HOUSING SET

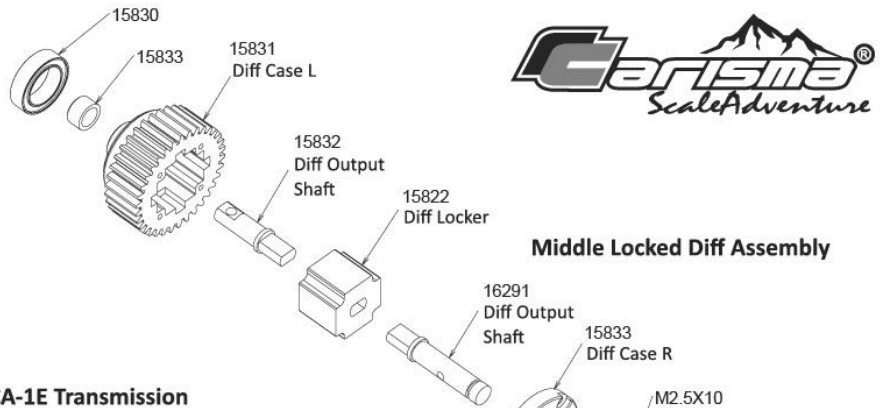

Middle Locked Diff Assembly

SCA-1E Transmission

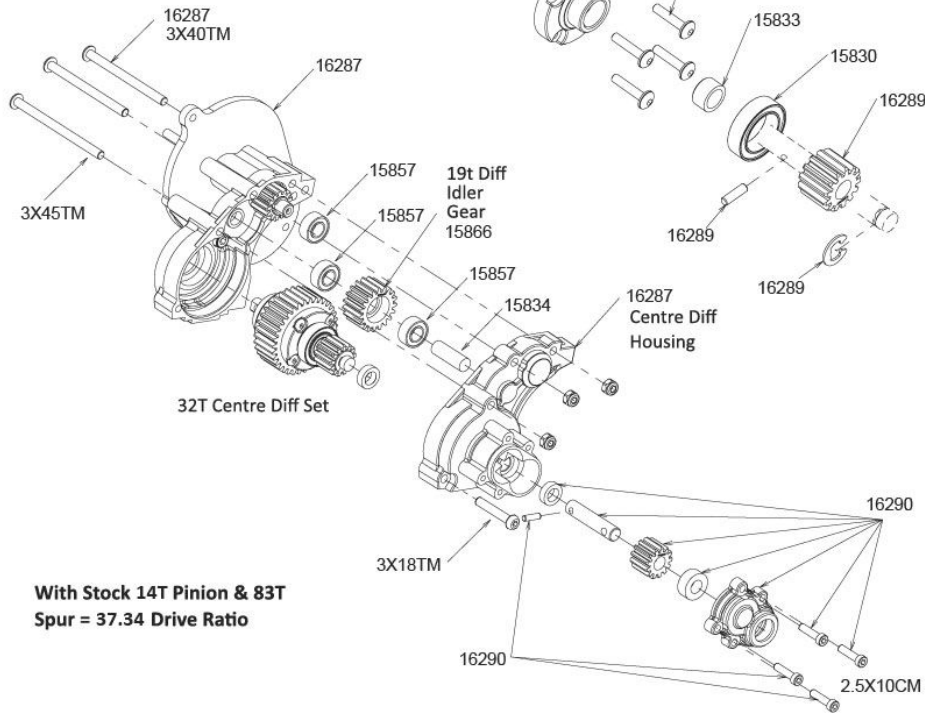

With Stock 14T Pinion & 83T Spur = 37.34 Drive Ratio

PART DESCRIPTION

- 15830 SCA-1E CENTER DIFFERENTIAL SET
- 15831 Center Differential Case - L
- 15832 Center Differential output Shaft
- 15833 Center Differential Case - R
- 15866 Differential Idler Gear 19T

- 15867 Slipper Hardware Set
- 15868 Slipper Plate Set
- 15869 Slipper Pads
- 15870 Spur Gear 83T
- 16276 SCA-1E 17T 5Pole Brushed Motor (545)
- 16286 SCA-1E MOTOR PINION GEAR 14T(48P)

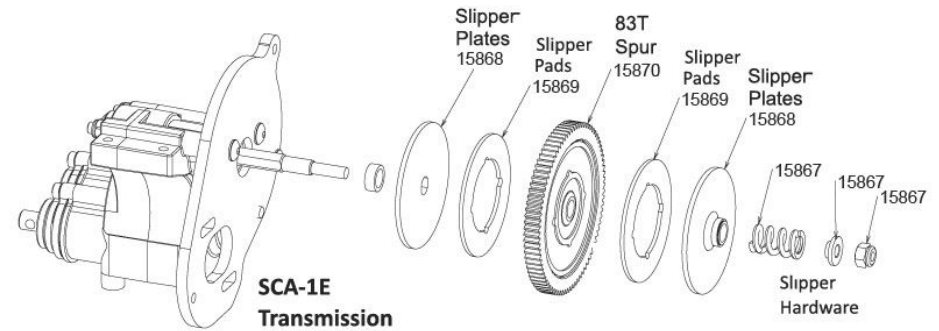

SCA-1E Transmission

Note: Setting the Pinion and Spur Gear Mesh, and the Slipper Clutch correctly are very important for smooth running and to protect the driveline from damage.

Gear Mesh: Use a thin strip of printer or note paper, and feed this between the Motors Pinion and the Spur. Press together, then tighten up motor bolts. Once paper is then pulled clear, will set the perfect gear mesh.

Slipper Clutch: Place the rig on a high grip surface, such as a carpet. The slippers spring should then be compressed all the way in using the M3 Nyloc nut, then backed off approximately 1.5 turns. The slipper should only slip in the event the driveline gets locked up under full load when Crawling.

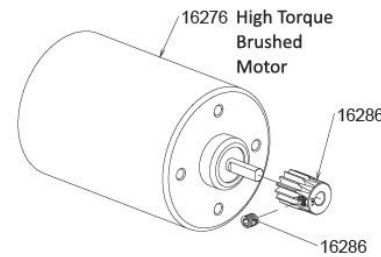

SCA-1E Motor & Transmission

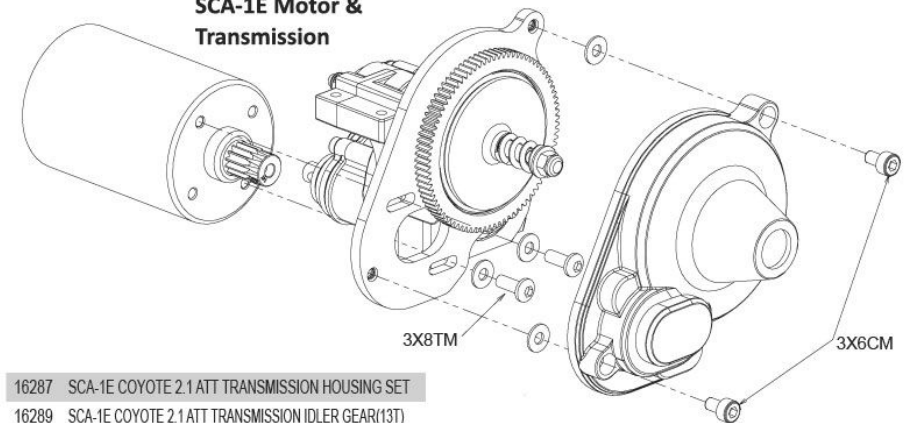

- 16287 SCA-1E COYOTE 2.1 ATT TRANSMISSION HOUSING SET
- 16289 SCA-1E COYOTE 2.1 ATT TRANSMISSION IDLER GEAR(13T)
- 16290 SCA-1E COYOTE 2.1 ATT TRANSMISSION CONVERSION SET
- 16291 SCA-1E COYOTE 2.1 ATT TRANSMISSION OUTPUT SHAFT

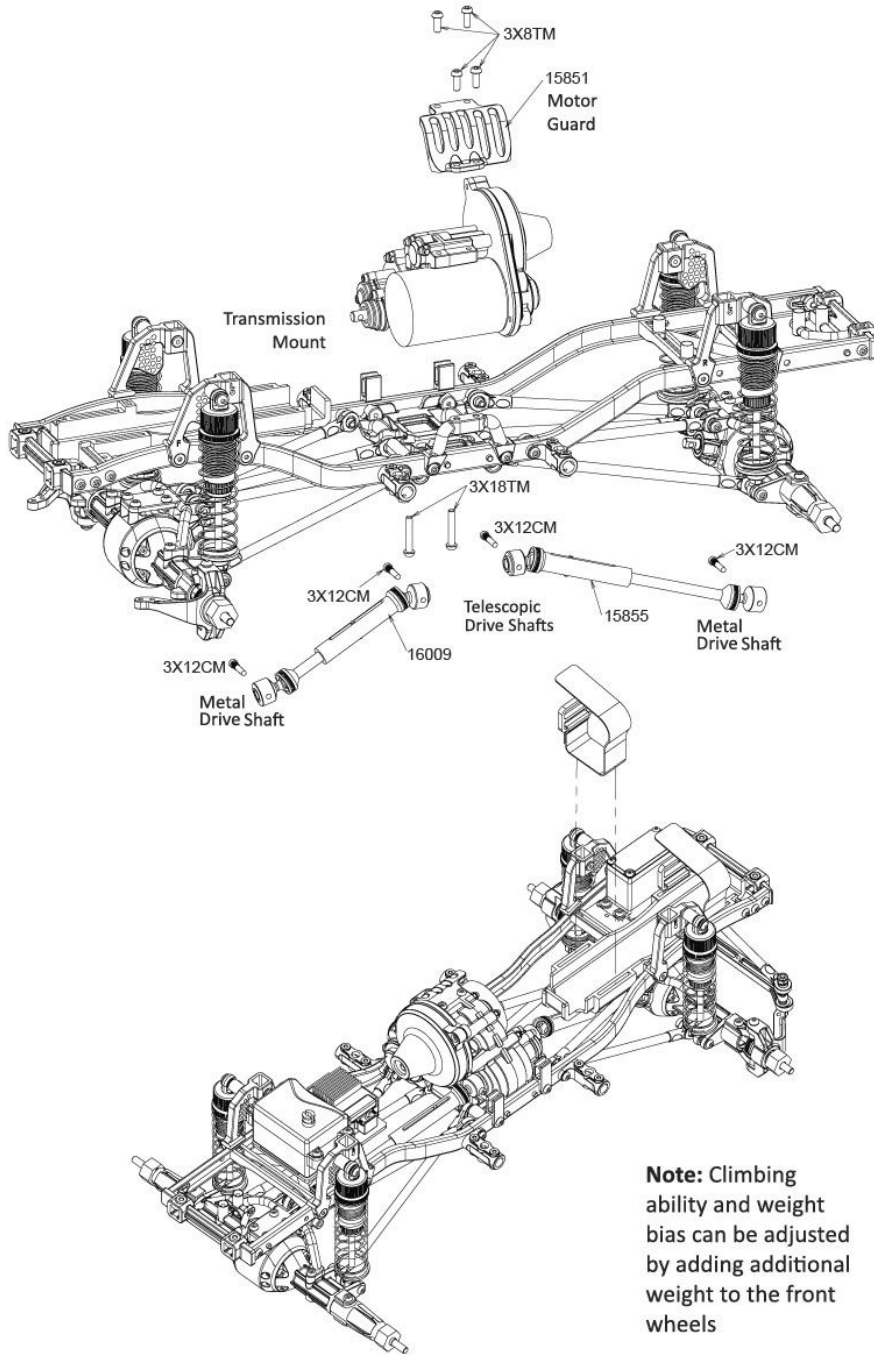

Note: Climbing ability and weight bias can be adjusted by adding additional weight to the front wheels

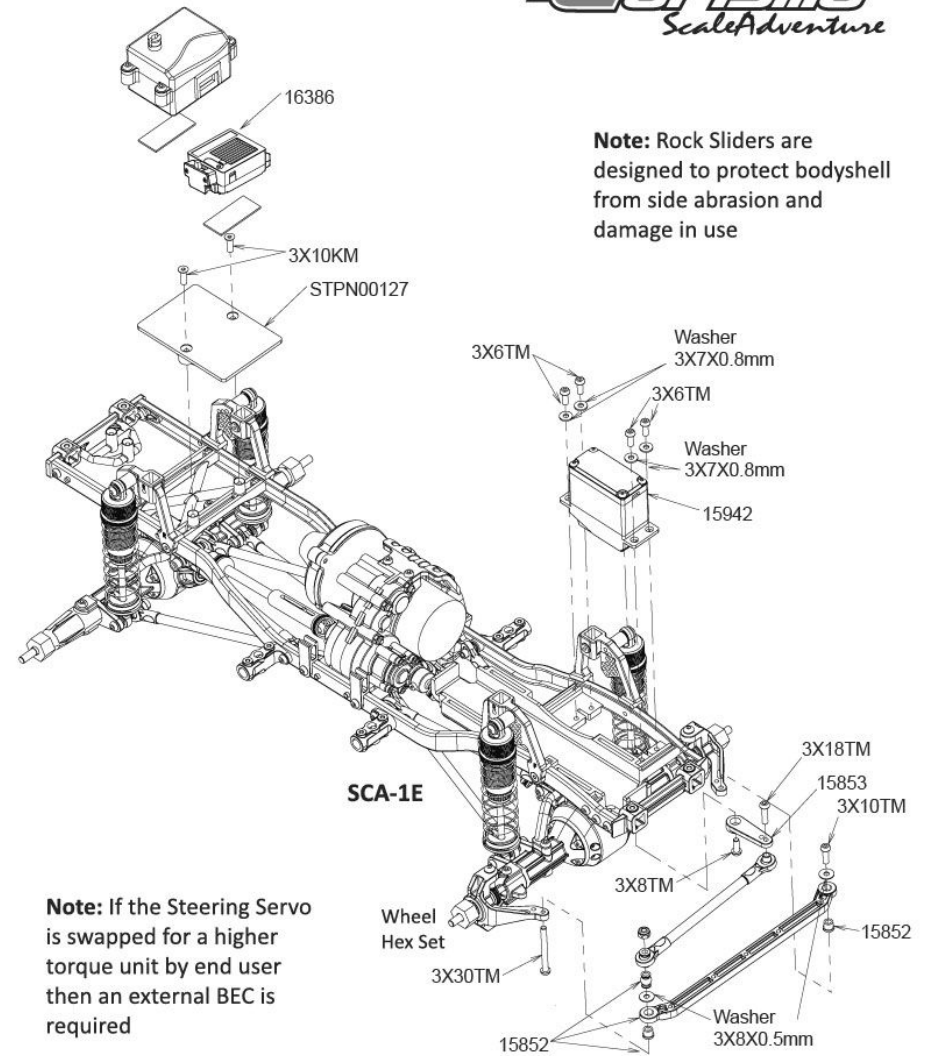

Note: Rock Sliders are designed to protect bodyshell from side abrasion and damage in use

Note: If the Steering Servo is swapped for a higher torque unit by end user then an external BEC is required

PART DESCRIPTION

- 15851 Motor Guard
- 15852 Steering Link
- 15853 Drag Link and Servo Horn

- 15855 SCA-1E Drive Shafts (Long)
- 15942 SCA-1E REPLACEMENT HIGH TORQUE SERVO
- 16009 SCA-1E DRIVE SHAFT (S)
- 16386 SCA-1E CENTER DIFFERENTIAL SET

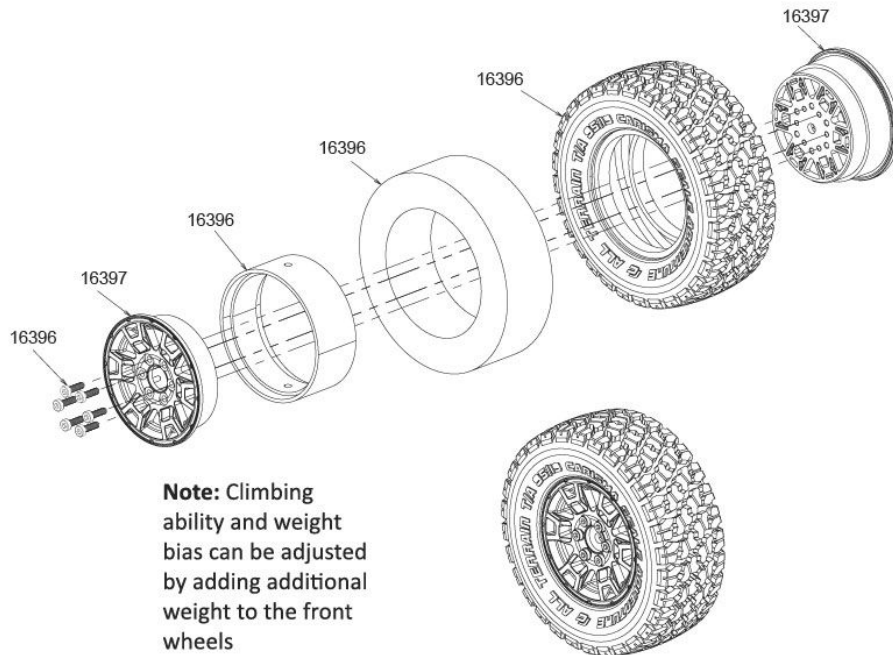

Note: Climbing ability and weight bias can be adjusted by adding additional weight to the front wheels

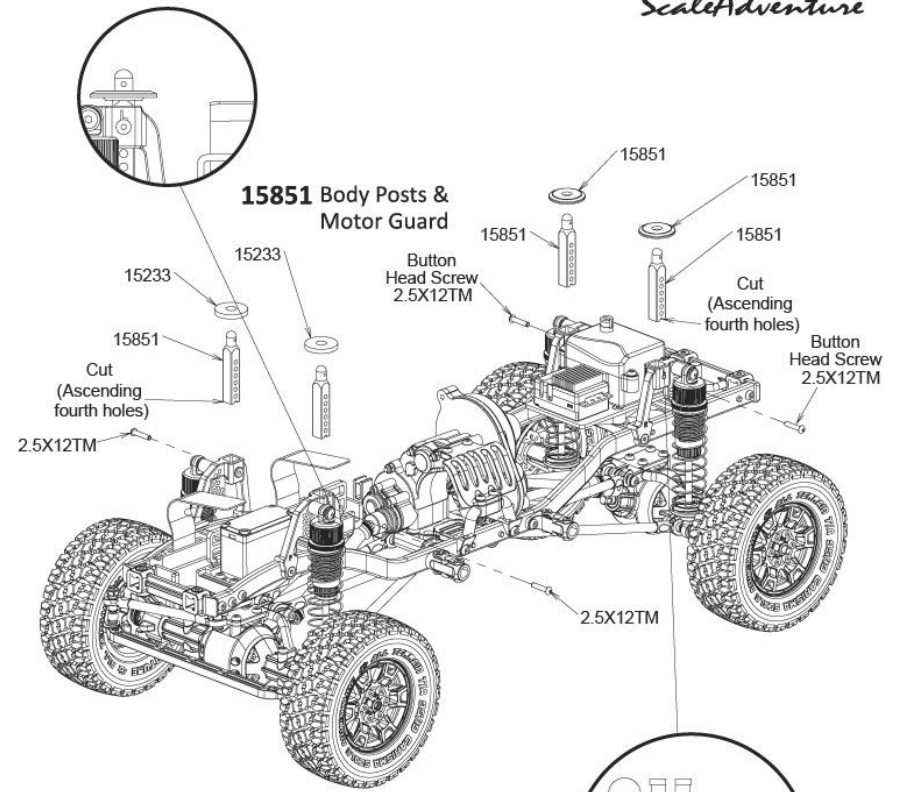
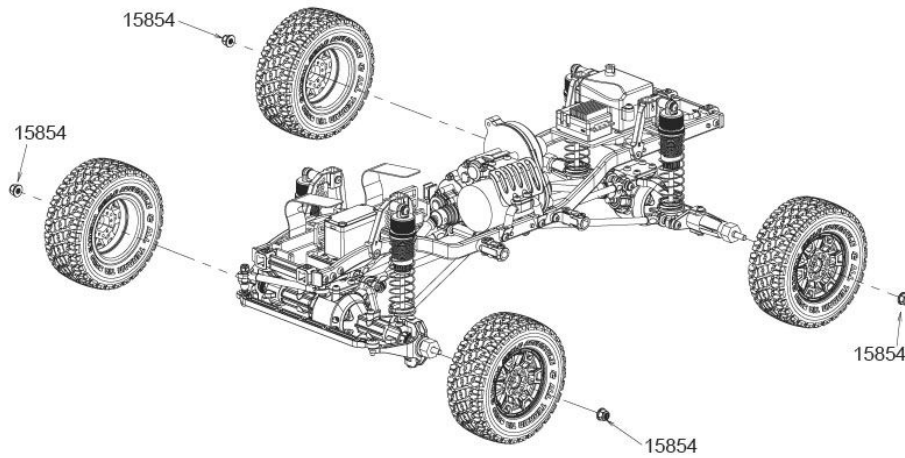

Note: The following are a list of official SCA-1E Option Parts designed to add additional strength and durability to different key areas of the rig

PART DESCRIPTION

- 15233 FOAM WASHERS SET
- 15851 Body Posts & Motor Guard
- 15854 Wheel Hex Set
- 16396 SCA-1E TOYOTA TRD PRO WHEELS & TIRES SET (PR)
- 16397 SCA-1E TOYOTA TRD PRO BEADLOCK WHEELS ONLY (PR)

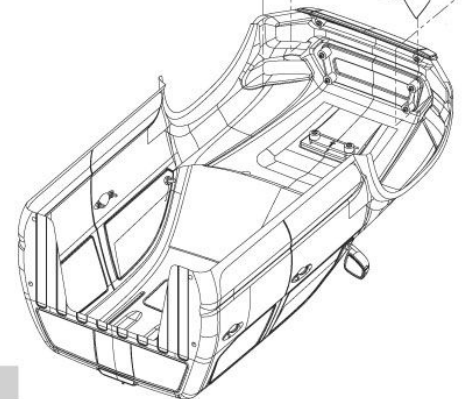
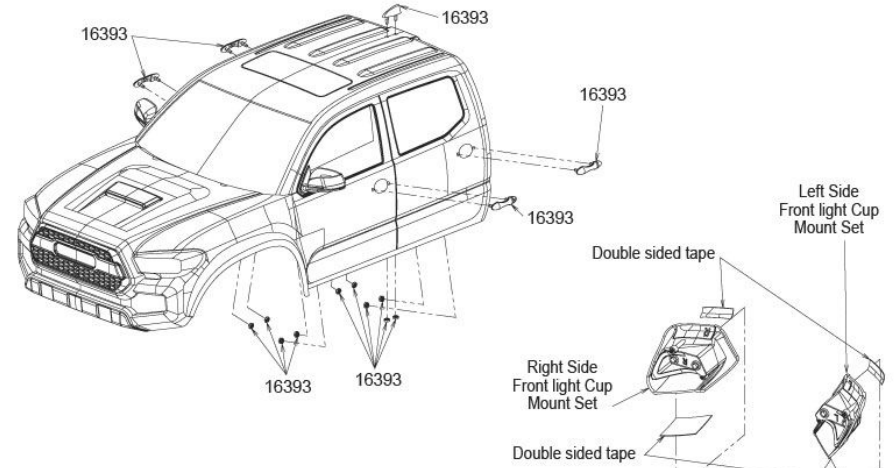
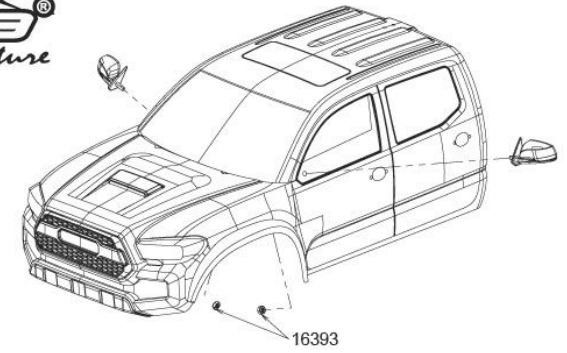
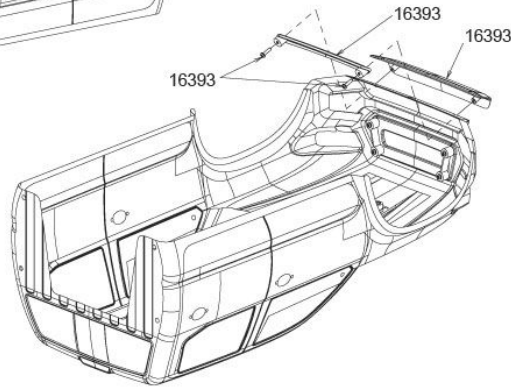
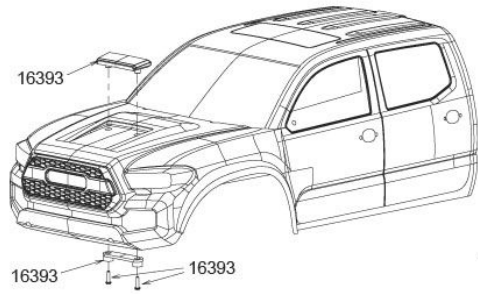
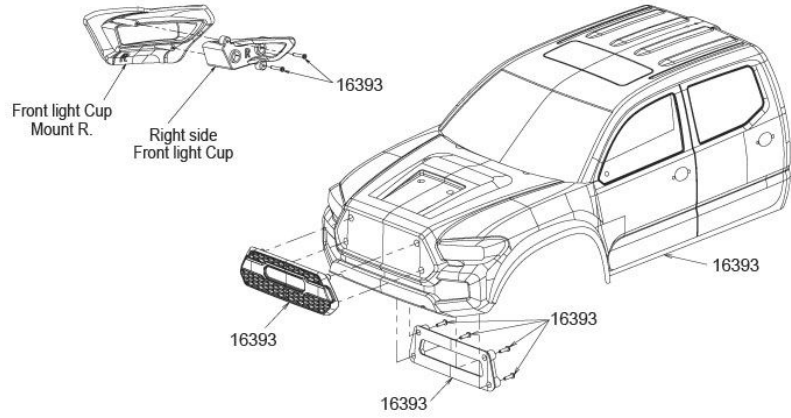
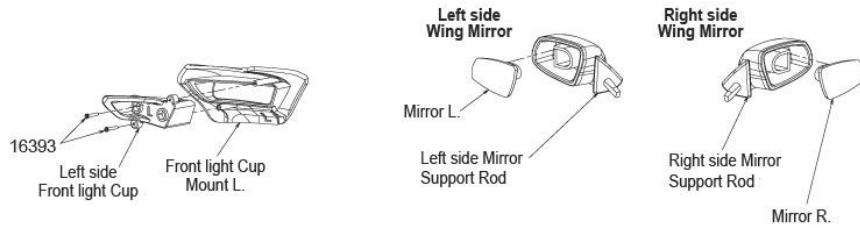

PART DESCRIPTION

16393 SCA-1E TOYOTA TRD PRO CLEAR BODY SET

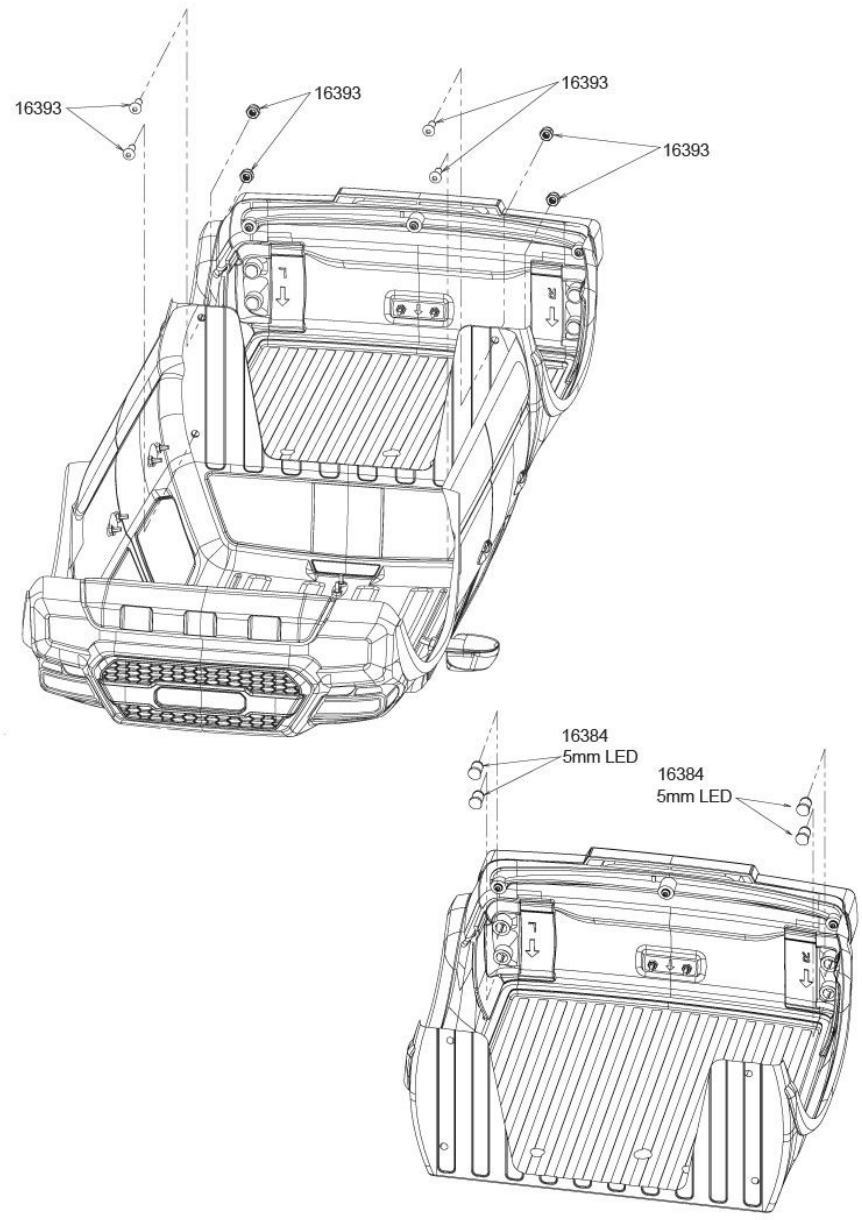
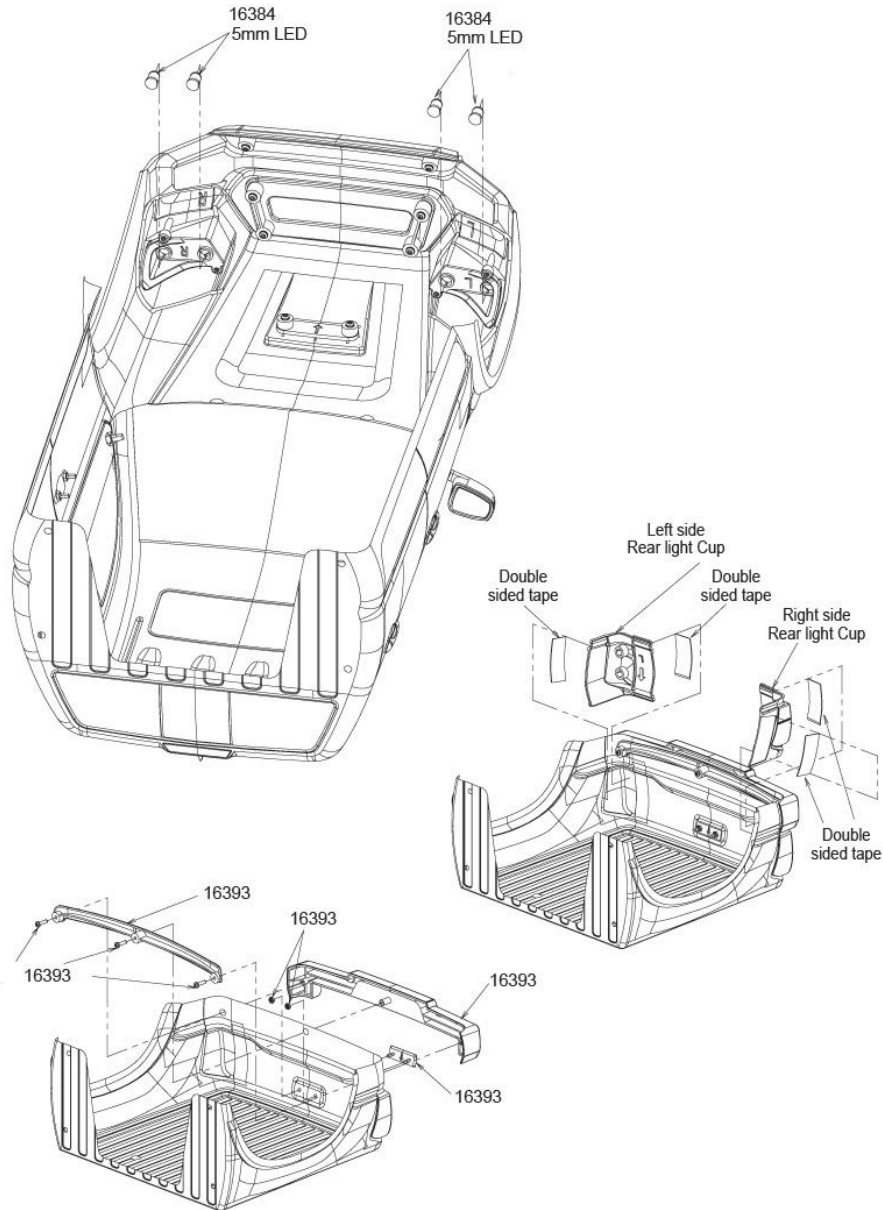

PART DESCRIPTION	
16393	SCA-1E TOYOTA TRD PRO CLEAR BODY SET
16384	SCA-1E TOYOTA TRD PRO LED SET

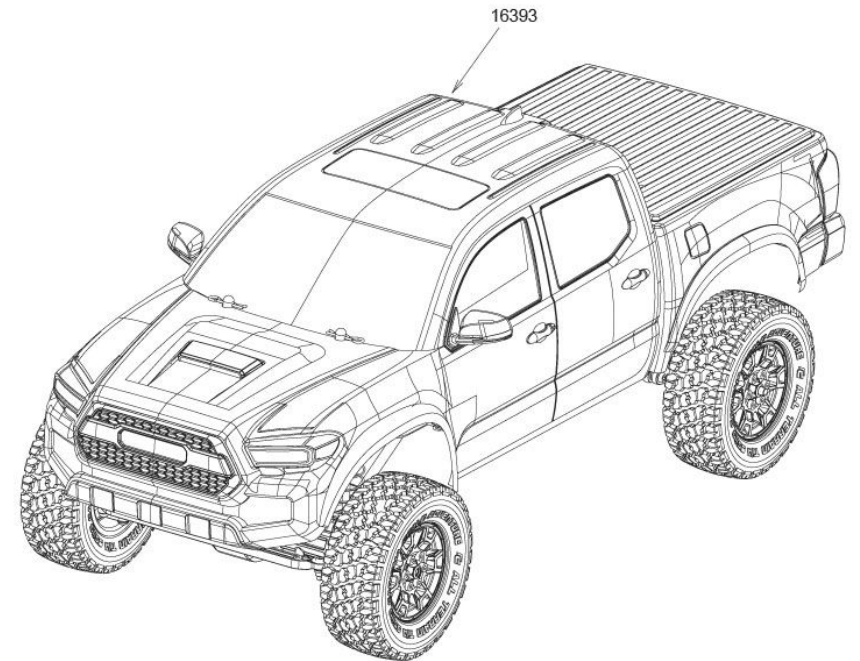
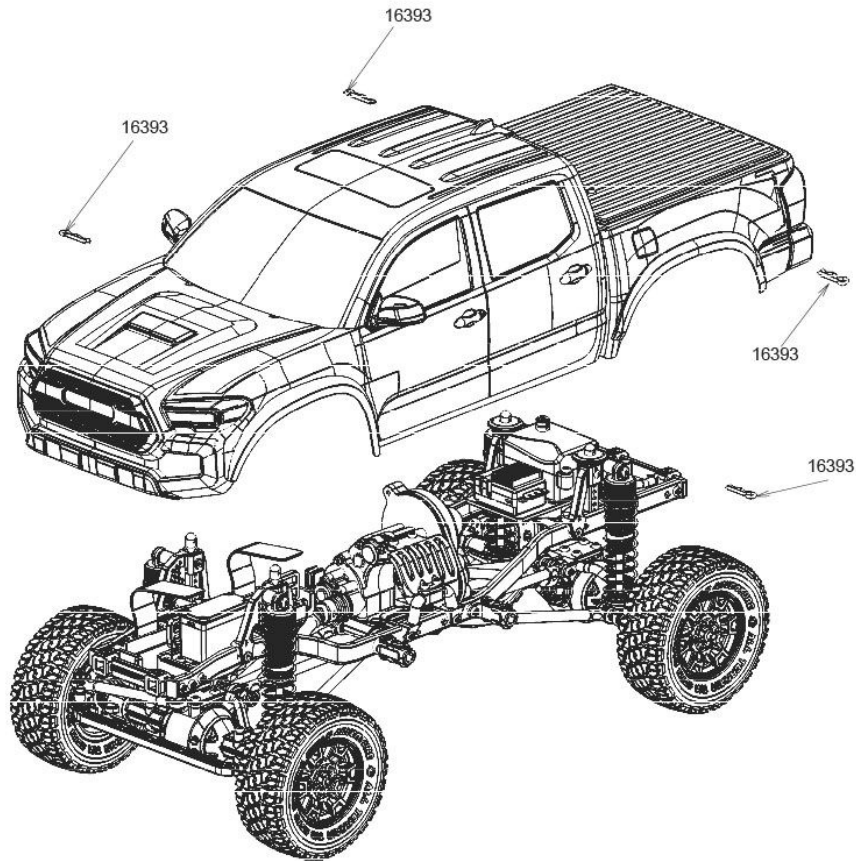

PART DESCRIPTION

16393 SCA-1E TOYOTA TRD PRO CLEAR BODY SET