

Installation instructions of Tail flame LED lights of model jets

Specifications

Voltage: 12.5V (Max 24V)

Current: 2A (Max 6A)

Weight of LED light set: 36g (No Adapter ring)

Adapter ring : 3~5g: ($\varnothing 29$ $\varnothing 30$ $\varnothing 32$ $\varnothing 36$ $\varnothing 36.6$ $\varnothing 39$ $\varnothing 40$ mm)

LED light color: Warm yellow

Luminous flux: 2880LM

Light source model: 3014

Number of light sources: 288pcs

Light source power: 0.4W

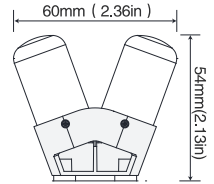

Installation diagram

As shown in the following photo:

1. Select a suitable adapter ring and install the tail LED lights on the adapter ring with screws;
2. Install the assembled LED lights set onto the motor with screws.

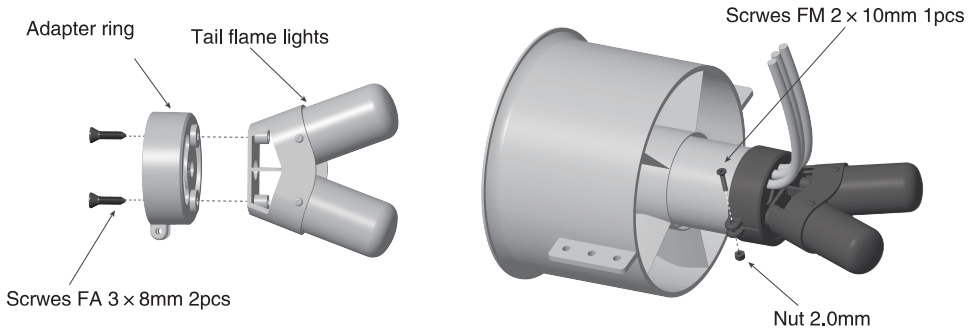

Cable connection

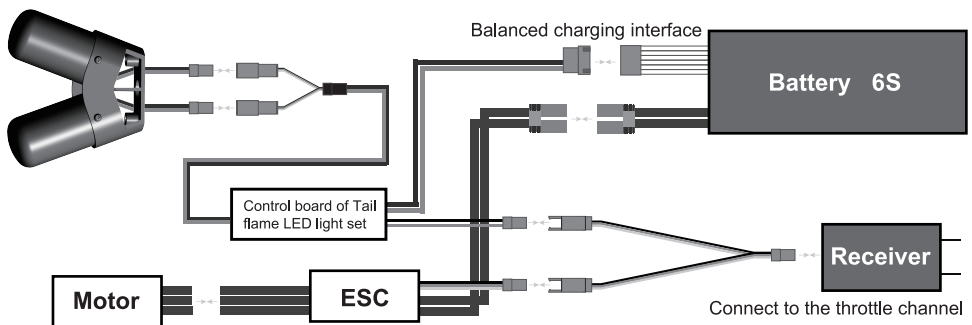

Balance Charging After Each Flight

The Freewing Tail Flame Afterburner only uses 3 cells of the battery it is connected to. This means, at the end of each flight, a slight imbalance will occur with those 3 cells being slightly lower than the others when used in conjunction with 4S or greater LiPo batteries. Be sure to balance charge your batteries after each flight. If installing this system in an actively flown model, please be aware that the Tail Flame Afterburner will draw additional current when in use, slightly shortening your overall flight time. Be sure to adjust your flying time and timer accordingly.

8S Power Systems

To safely connect your Tail Flame Afterburner to your main flight batteries when using an 8S LiPo battery setup, please follow the instructions and images below.

1. Power on your transmitter, and connect your series adapter to the ESC. Connect your batteries to the series adapter and check for proper control function of the model with the transmitter.

2. Note which battery has its ground (black) wire connected directly to the ESC's black wire and use the balance tab from this battery to connect to the Tail Flame Afterburner. Connecting the other battery's balance tab to the afterburner will cause the system to fail, and potentially cause a fire. If using a 6S and 2S battery in series for 8S, be sure to connect your 6S battery's negative (black) wire to the ESC's negative (black) wire.

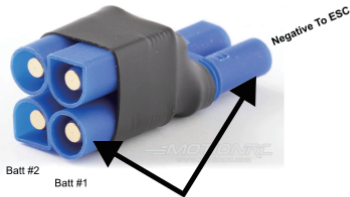
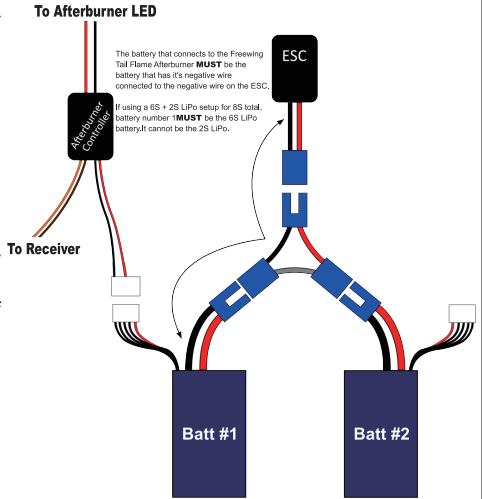

On an EC5 to EC5 series adapter, look for the two round parts of the connector that are inline. The battery that plugs its ground wire into this line is battery #1.

On an XT to XT series adapter, look for the two beveled sides of the connector that are inline. The battery that plugs its ground wire into this line is battery #1.

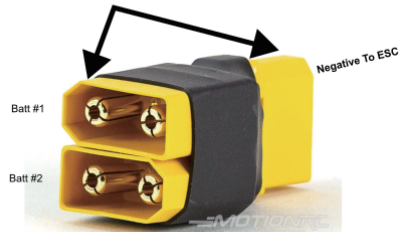

Please reference the image above for another style of series adapter, and how to note which battery to connect to the Tail Flame Afterburner. We recommend using a felt-tipped pen or paint marker to mark which side of the series adapter should be used.

Please note:

A single 8S LiPo battery cannot be used with the Freewing Tail Flame Afterburner

If using two 4S LiPos, you can cut a small notch in the connector of the Tail Flame Afterburner to allow the 4S balance tab to connect more easily..

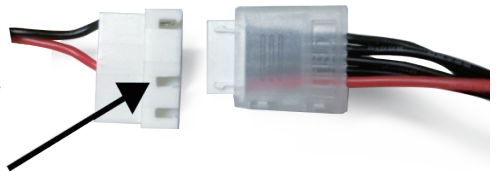

Cautions

1. Before install, do not light up for a long time to prevent circuit damage caused by high temperature.
2. Do not touch the LED set after it has been lit for a long time to prevent scalding due to high temperature.
3. During installation, do not damage the power cord to prevent short circuit.
4. Fix the power cord to prevent accidents caused by suction into the culvert after loosening.
5. Connect the battery correctly to prevent short circuit and fire.

Freewing

Dongguan Freewing Electronic Technology Ltd.
Hongkong Freewing Model Intl Ltd.

+86 769 82 669 669
www.freewingmodel.com www.sz-freewing.com
freewing@sz-freewing.com