

9000

PRODUCT NAME

9000

DIMENSIONS

Depending on the composition

GENERAL LEAD TIME

8 to 10 weeks

BRAND

Arflex

MATERIAL

Metal, Poplar Plywood, Polyurethane, Polyester, Upholstery

CUSTOMISABLE

Yes

DESIGNER

Tito Agnoli

FINISHES



Black
Lacquered
Metal Feet

PACKING DIMENSIONS

N/A

CATEGORY

System Sofa INDOOR



ADDITIONAL INFO **Fabric Options & Categories**

- T2: Cabas, Derby, Etoile
- T3: Boucle, Cherie, Lama
- T4: Hero 2 by Kvadrat, Mistral, Orbaco, Steelcut 2
- T5: Bridge, Chevy, Divina MD by Kvadrat, Gamma

Available in the leathers of Arflex collection.
Fully removable cover, except for the leather version.

COM options must be approved by Arflex to ensure suitability for upholstery.

MONOLOGUE

NEED MORE HELP?

If you require a quotation or more information about this product or brand, please get in touch with our team:

GENERAL ENQUIRIES
info@monologuelondon.com

CONTRACT ENQUIRIES
contracts@monologuelondon.com

ONLINE STORE
www.monologuelondon.com
@monologuelondon



9000

Armchair

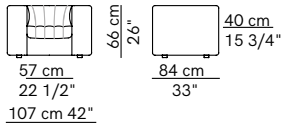

Sofa

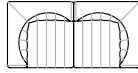
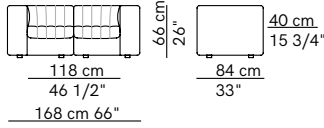

Unit with 1 armrest

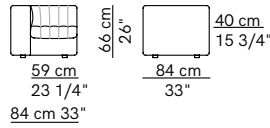

Unit without armrests

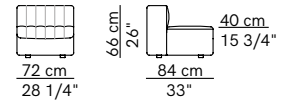

Corner unit

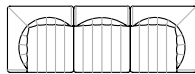
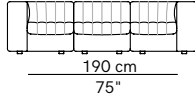
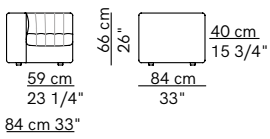

Curved unit

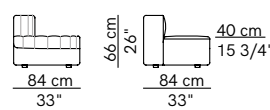

Pouf

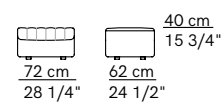

Compositions

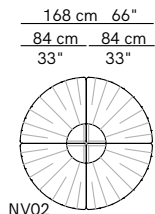

NV02

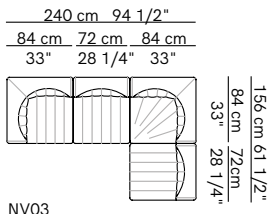

NV03

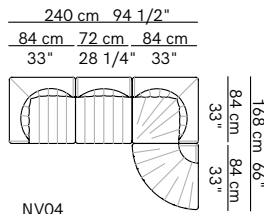

NV04

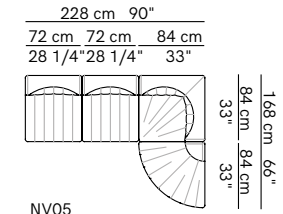

NV05

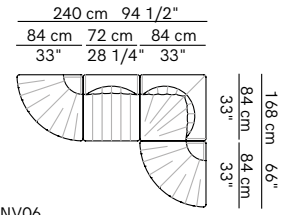

NV06

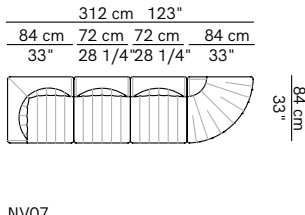

NV07

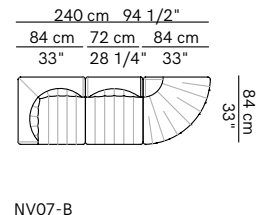

NV07-B

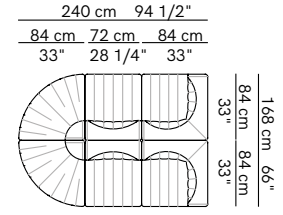

NV08

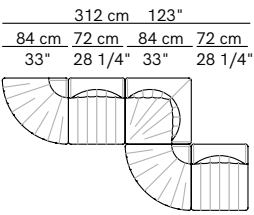

NV09

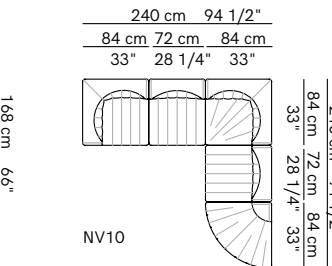

NV10

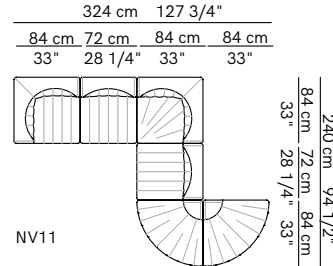

NV11

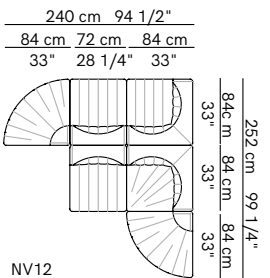

NV12

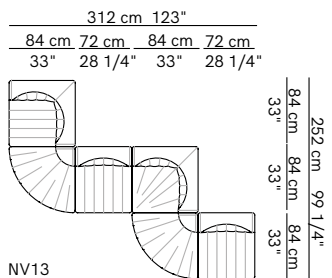

NV13

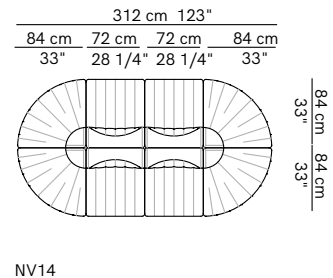

NV14