

O U T D O O R S E R I E S

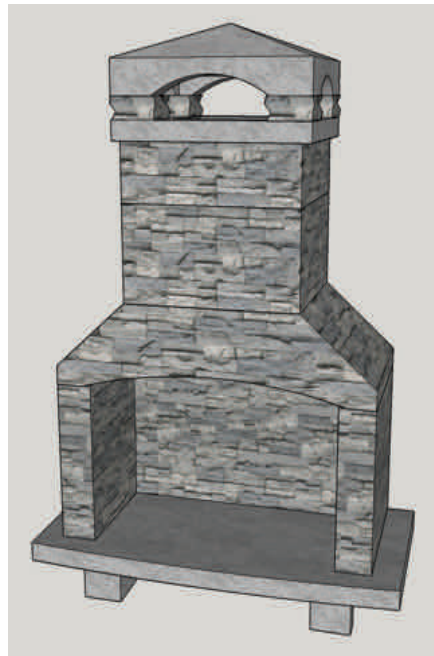

EMBERSIDE

PATIO • HEARTH • HOME



**MADE IN
THE USA**



**OUTDOOR SIENNA FIREPLACE
OSFBR-100(BROWN)
OSFGR-100(GRAY)**

INSTALLATION AND CARE MANUAL

⚠ WARNING

For Outdoor Use Only.

⚠ WARNING

Improper installation, adjustment, alteration, service or maintenance can cause injury or property damage. Read the installation, operating and maintenance instructions thoroughly before installing or servicing this equipment.

⚠ WARNING

If the information in this manual is not followed exactly, a fire or explosion may result causing property damage, personal injury or loss of life

Do not store or use gasoline or other flammable vapors and liquids in the vicinity of this or any other appliance

**Installer: Leave this manual with the appliance.
Consumer: Retain this manual for future reference.**

BEFORE YOU START

Do not alter or modify the fireplace or its components under any circumstances. Any modifications or alteration of the fireplace system, including but not limited to the fireplace and accessories, may void the warranty, listings and approvals of this system, and could result in an unsafe and potentially dangerous installation.

Before You Start

Carefully inspect the contents for shipping damage. If any parts are missing or damaged, immediately inform the dealer from whom you purchased the fireplace. Do not attempt to install any part of the fireplace unless you have all the parts in good condition.

Make Sure That You Have Received All Parts

Check your packing list to verify that all listed parts have been received. You should have the following:

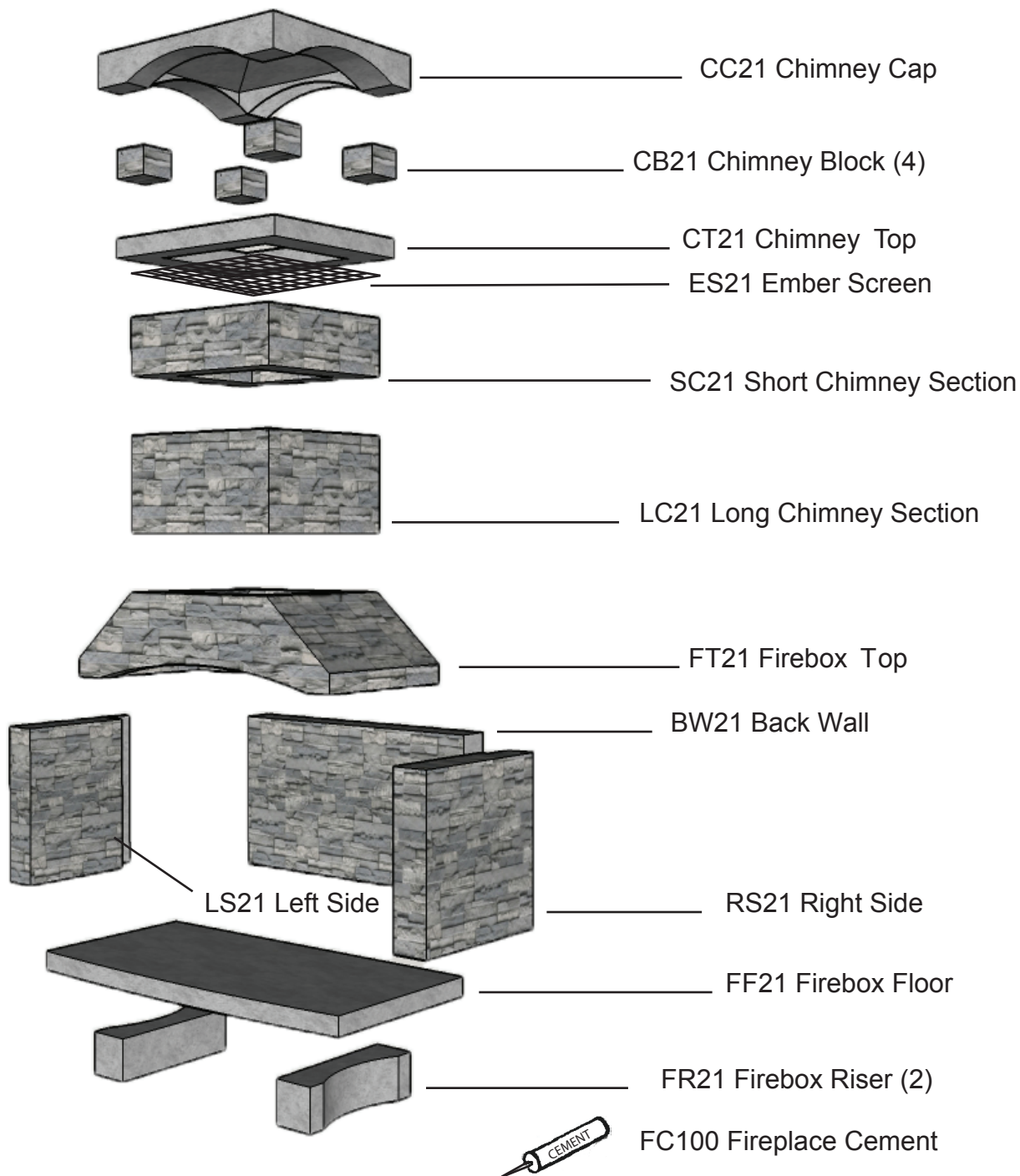

BEFORE YOU START

CONTINUED

INSTALLER/CONSUMER SAFETY INFORMATION

Read and save these instructions.

This book contains your installation instructions and should be kept in a safe place. For you to realize all the advantages and use of the reliable service that has been engineered into your Emberside fireplace, you must carefully follow all of the instructions contained in this book regarding installation and care of the fireplace.

These instructions should be read carefully in their entirety before beginning installation of the fireplace.

It is suggested that you wear work gloves and safety glasses to protect your hands and eyes when installing your fireplace.

NOTE: Authorities having jurisdiction (i.e. building inspectors, fire marshals, etc.) should be consulted before installation to determine the need to obtain a permit.

General Installation Information

In planning the installation for the appliance it is necessary to determine where the unit is to be installed and whether optional accessories are desired. If gas logs will be installed in your Sienna Fireplace, gas supply piping should also be planned and installed at this time. If installing gas logs, follow all instructions provided with that set. The following steps represent the normal sequence of installation. Each installation is unique however, and might require a different sequence.

What You Will Need For Installation

- Level
- Measuring tape
- Square

Proposition 65 Warning:
Fuels used in gas, woodburning or oil fired appliances, and the products of combustion of such fuels, contain chemicals known to the State of California to cause cancer, birth defects and other reproductive harm.
California Health & Safety Code Sec. 25249.6

FOR SAFE INSTALLATION AND OPERATION, PLEASE NOTE THE FOLLOWING

1. This appliance gives off high temperatures and should be located out of high traffic areas and away from furniture. Locate your Sienna fireplace at least 48 inches from any combustible wall at the sides or back. Provide at least 48 inches clearance to combustible items from the front opening as well.
2. Children and adults should be alerted to the hazards of the high surface temperatures of this appliance and should keep a safe distance to avoid burns or ignition of clothing.
3. Children should be carefully supervised when they are in the area of the fireplace.
4. Under no circumstances should this appliance be modified. DO NOT add any additional chimney sections of any kind to the fireplace unit.
5. Under no circumstances should this appliance be used in a screened-in porch, in a garage or under any type of roof.
6. Keep the area around your appliance clear of combustible materials, gasoline and other flammable vapor and liquids.
7. Under no circumstances should solid fuels other than wood, such as coal, paper or cardboard be used in this appliance.
8. The flow of combustion and ventilation air must not be obstructed in any way.
9. This appliance requires adequate ventilation and combustion air to operate properly. It is only intended for OUTDOOR USE.

ASSEMBLY PROCEDURE

PLEASE READ THE FOLLOWING CAREFULLY

It is not unusual for your Emberside fireplace to give off some odor the first time it is burned.

This is due to the curing of the paint and any undetected oil used in the manufacturing process.

⚠ WARNING

- This fireplace is for **OUTDOOR USE ONLY!**
- Improper installation or use of the heater can cause serious injury or death from fire, burns, explosion or carbon monoxide poisoning.

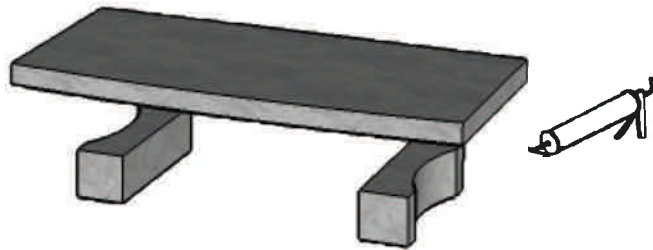

Step 1

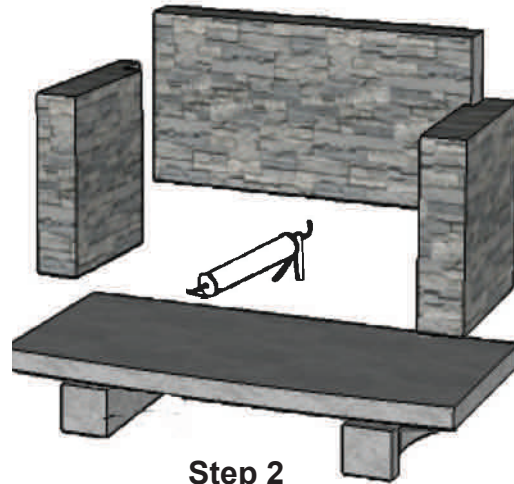

Step 2

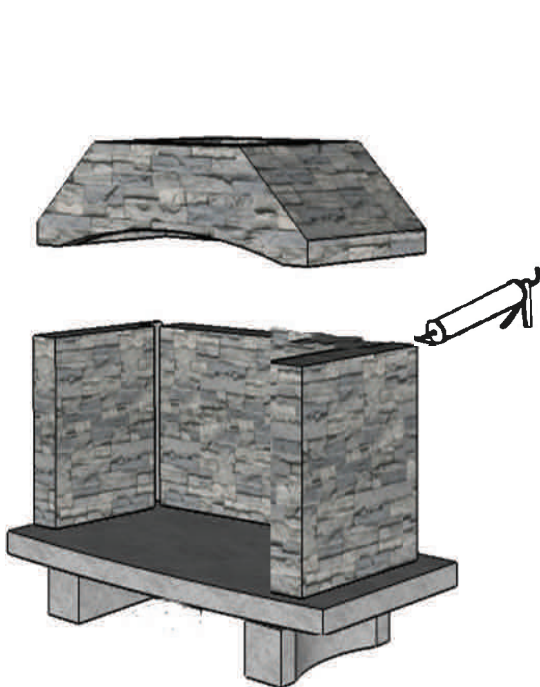

Step 3

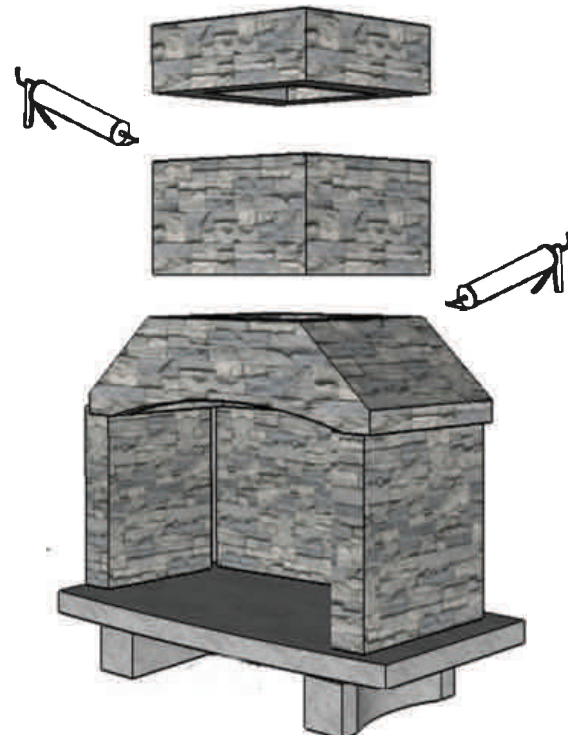

Step 4

ASSEMBLY PROCEDURE

CONTINUED

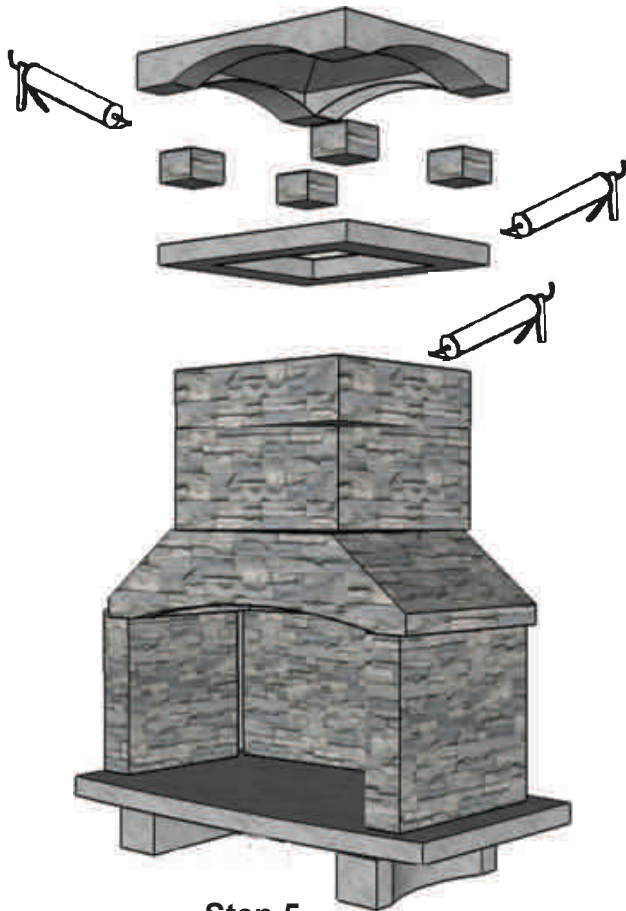

Step 5

Be careful to apply the fireplace cement sparingly, to avoid excess being squeezed out onto the surface of the stone. Excess Cement can be removed with water. Allow two or three hours drying time before building a fire in the fireplace

ACCESSORIES AVAILABLE FOR YOUR SIENNA OUTDOOR FIREPLACE

OFC-100 Fireplace Cover - Helps protect your fireplace from the elements.

OCS-100 Hooks and Grate - Use your fireplace to cook food.

PS-12 Pizza Stone - Use with OCS-100 for cooking wood-oven pizza.
Includes wire rack and pizza cutter.

LIMITED WARRANTY

Warranty shall apply to the original purchaser at the original installation point only.

Your Sienna Outdoor Fireplace is guaranteed for two (2) years against manufacturer's defects.

General Warranty: This warranty does not apply in the case of improper installation, neglect, accident, misuse, or as a result of modifications of the original product.

All costs for removal and re-installation are the expressed responsibility of the purchaser.

For repair, replacement, or service to defective part(s) please contact our Customer Service Hotline, number below. Thereafter with valid warranty registration and proof of purchase, call the Customer Service Hotline for authorization to ship defective part prepaid and insured in suitable carton back to Emberside at the following address: 213 New Porter Pike, Bowling Green KY 42103. Goods returned improperly packaged are the sole responsibility of purchaser.

It is agreed that any repair or replacement is the exclusive remedy from Emberside. In no case shall Emberside be liable for any consequential damage or breach of this or any other warranty expressed or implied whatsoever. This limitation as to consequential damages shall not apply in states where prohibited.

Purchased From: _____ Date: _____

Model:

Name: _____ Phone: _____

Address: _____

City: _____ State: _____ Zip: _____



EMBERSIDE

PATIO • HEARTH • HOME
www.emberside.com

Please photocopy and return to Emberside within 14 days of purchase.

If you have other questions, please contact the Customer Service Hotline - (800) 488-1711