

 **Manufactured for:**
Dynarex Corporation
10 Glenshaw Street
Orangeburg, NY 10962
USA • www.dynarex.com

Made in Taiwan

Reorder No. 32300-32301

dynarex
Resp-O₂™

Suction Units

Vacuum Levels up to 560 mmHg

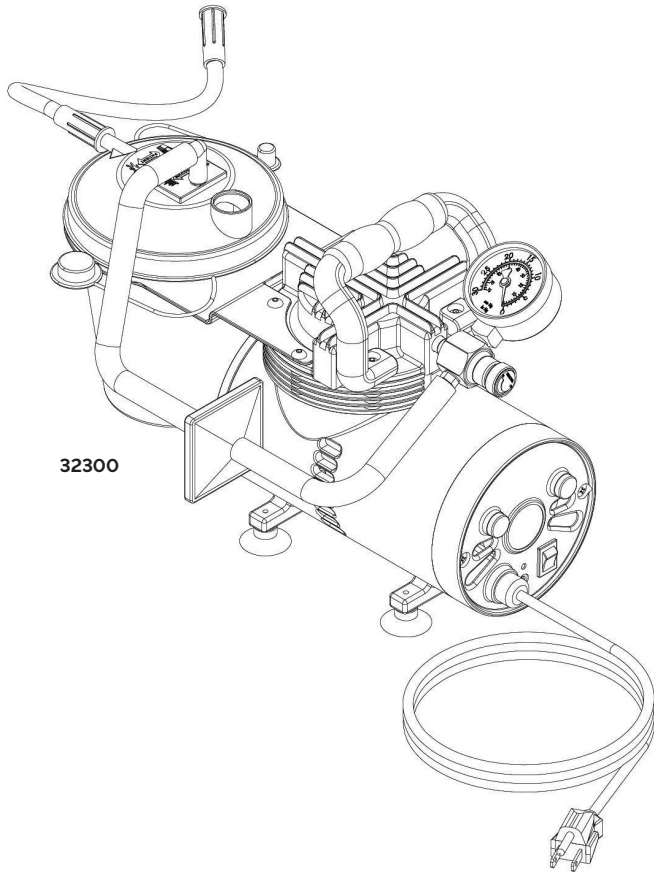

R_x Only

CAUTION: Federal (USA) law prohibits this device to sale by or on the order of a physician.

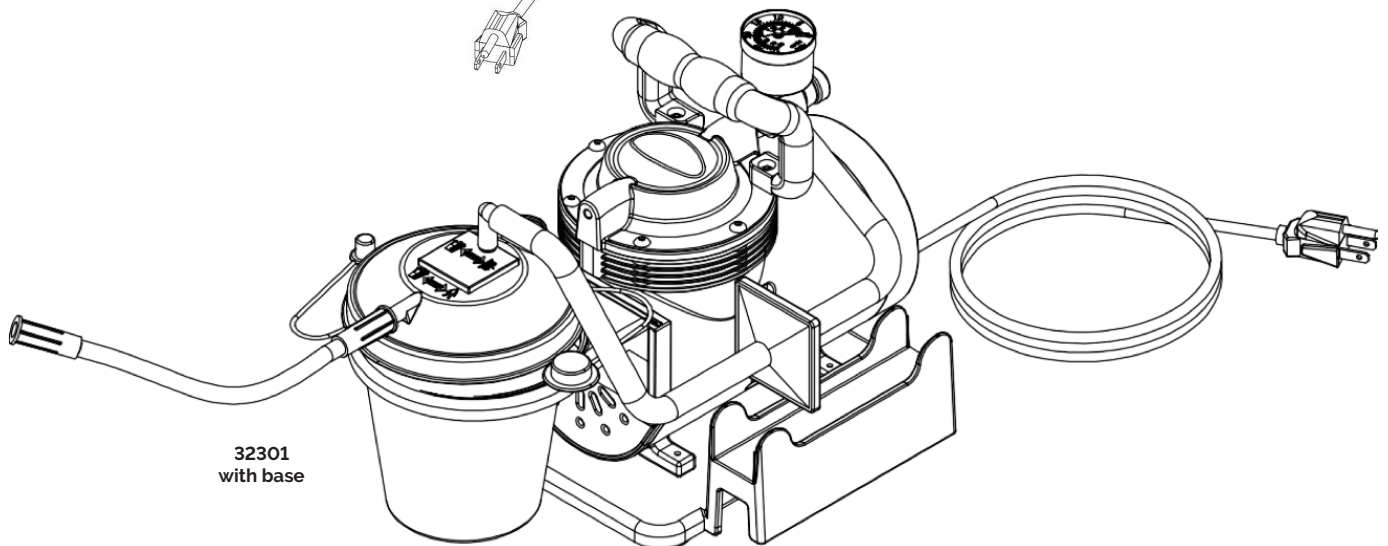

SYMBOL GLOSSARY
For an explanation of symbols
used in Dynarex packaging, visit
dynarex.com/symbols.php

R210222

SAFETY INFORMATION

WARNINGS

- Read this manual completely and become familiar with all the operating parts.
- Close supervision is required especially when the device is being used on or near children or persons with disabilities.
- Use the device only for its intended use as described within this guide.
- Proper operation of this device is necessary to avoid tissue damage, personal injury or even death. This device should not be used unless the operator has been trained and/or instructed by a physician or another qualified health care professional.
- This unit is a vacuum suction device designed for the collection of non-flammable fluid materials in medical applications only. Improper use during medical applications can cause personal injury, harm or death.
- All suctioning should be done in strict accordance to procedures that have been established by a licensed medical professional.
- Inspect the tubing and Suction Canister for leaks and cracks before each use.
- Keep the unit and power cord away from heated surfaces and sources. Never operate this product if the power cord or plug are damaged.
- Do not submerge the device in water as this will result in severe damage. Do not use near any liquid source.
- **DO NOT DISASSEMBLE THIS DEVICE.** Incorrect disassembly or any attempted repair to the device can result in an electrical shock hazard. If service is required, return your device to an authorized service center. Opening or tampering with the unit in any way will void the warranty and may cause electrical shock hazard.

ILLUSTRATION OF PARTS

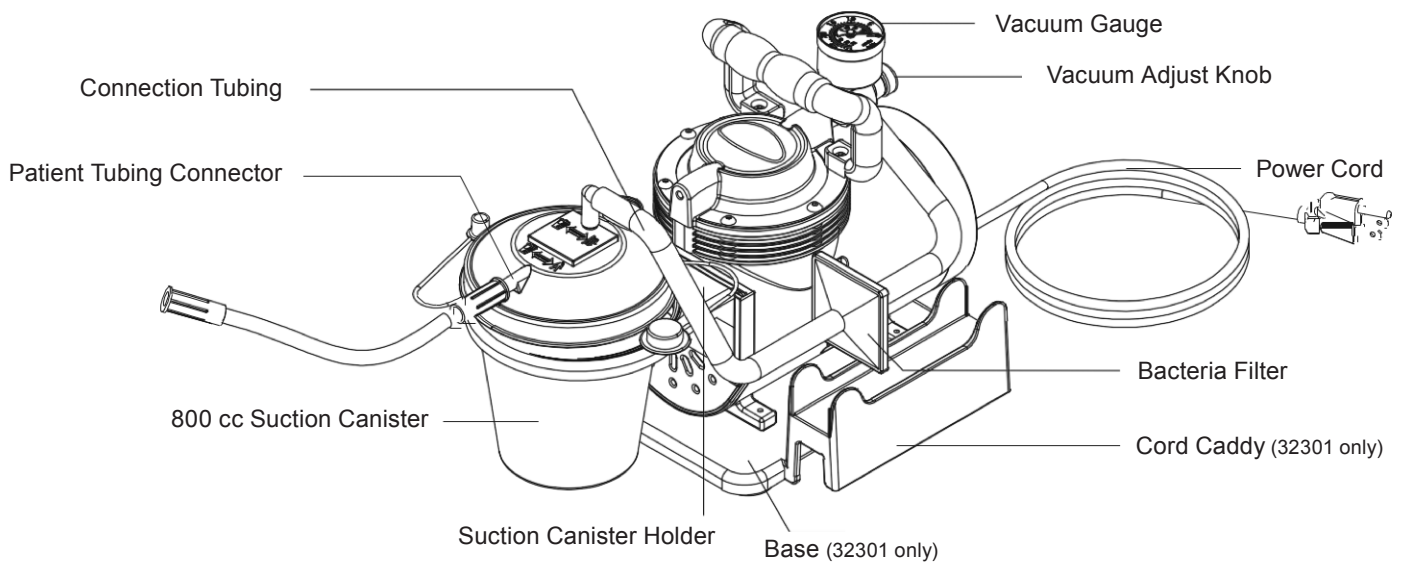
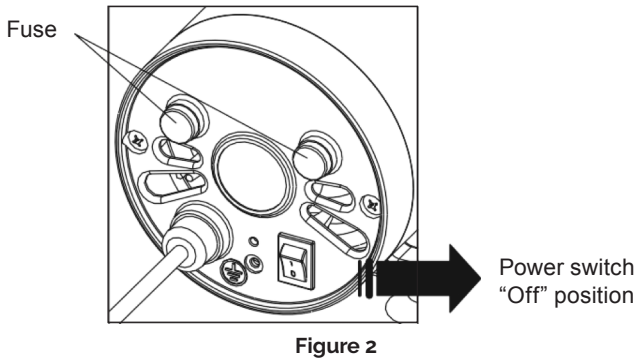

Figure 1

OPERATING INSTRUCTIONS

1. Connect either end of the 6" silicone tubing to the top of Suction Canister connector, then connect the other end to the bacteria filter. Use the other 6" silicone tube to connect the bacteria filter to the Suction Unit (Figure 6).
2. The patient tubing connects to Suction Canister (Figure 1).
3. Make sure the power switch located on the side of the unit is in the "Off" position before connecting the unit to a power source (Figure 2).



4. Turn the power switch to the "I" position, to start the device (Figure 3).

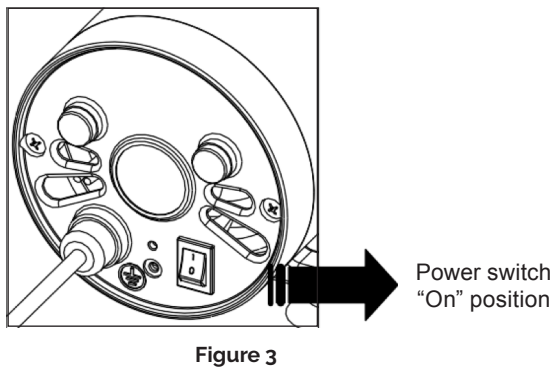

5. Adjust the suction level from 0 to 560 mmHg by turning the vacuum adjustment knob clockwise to increase and counterclockwise to decrease (Figure 4). It is recommended to test the pressure before using the device on a patient. Simply block the end of the patient hose or block the Suction Canister lid intake and allow the gauge to reach a stable vacuum reading.

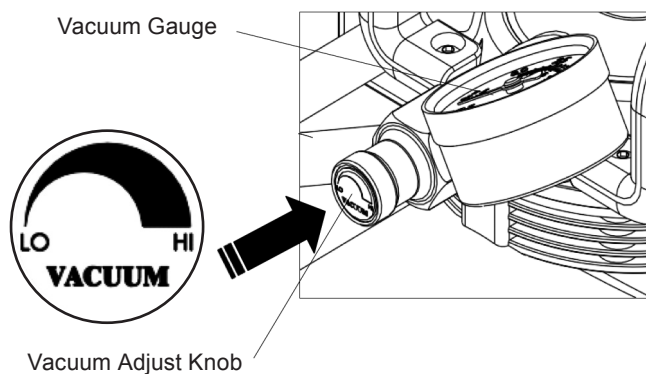

Figure 4

6. It is recommended to test the connections for any leaks prior to being used on a patient.
7. Place the tubing to the appropriate location and start to gently suction.
8. When the Suction Canister reaches a safe, full level (800 cc), the suctioning will stop automatically. The float shut-off, located under the lid, will activate to avoid over-filling (Figure 5).

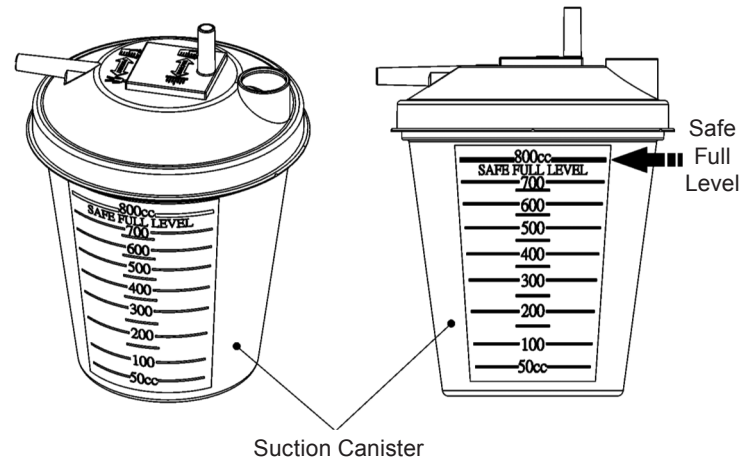

Figure 5

9. Turn the power switch to "O" position to turn off the suction motor.
10. Remove the lid and dispose the waste liquid from Suction Canister.

CAUTION:

1. When the automatic float shut-off is activated, contents in the Suction Canisters should be disposed of. Further suctioning could cause damage to the vacuum pump.
2. Should fluid be aspirated back into the unit, call an authorized service technician to inspect the vacuum pump as it may have been damaged.

MAINTENANCE

Bacteria Filter Change:

1. The bacteria filter should be replaced every two months. If overflow occurs, change the filter immediately.
2. Disconnect the filter from pressure adjustment knob tubing and the Suction Canister lid tubing (Figure 6).
3. Replace with a new bacteria filter and connect each tube as described. Use only Dynarex-approved filters. Do not substitute any other material for the bacteria filter. Improper substitution may lead to contamination or poor device performance.

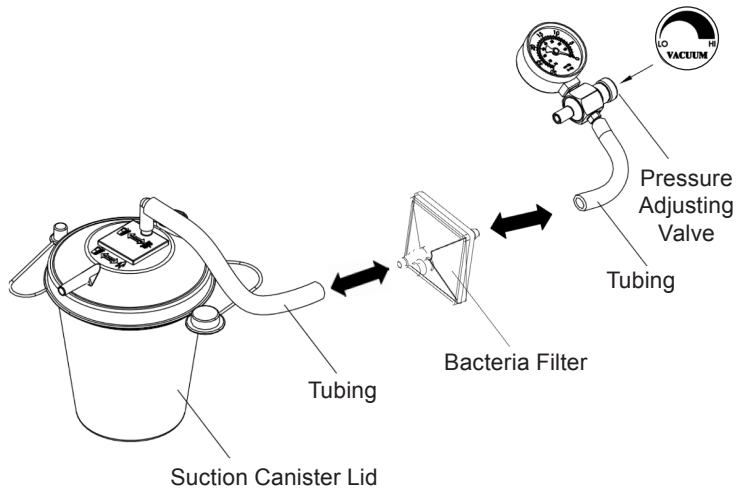

Figure 6

Fuse Change:

1. Using a screwdriver, turn to the left and pull the fuse housing out.
2. Remove the old fuse and replace with the same fuse type.
3. Replace the fuse housing, push in and turn to the right.

Fuse specification: Miniature Glass Fuse 5×20 mm, Fast Blow (Quick Acting), F2A/250V.

TROUBLESHOOTING

Your Suction Unit contains no user-serviceable parts. If you believe the device is not working properly, please take a few moments to check for these possible causes before contacting your authorized distributor.

| PROBLEM | ACTION |
|-----------------------|--|
| Unit does not turn on | <ol style="list-style-type: none"> 1. Check power source and connection 2. Ensure that the wall outlet is live 3. Check power cord is not damage |
| Motor runs, no vacuum | <ol style="list-style-type: none"> 1. Verify tubing is securely connected 2. Check for tubing leaks or kinks 3. Ensure float shut-off is not activated 4. Check the bottle for leaks or cracks |
| Low vacuum | <ol style="list-style-type: none"> 1. Use vacuum adjustment knob to increase vacuum pressure level 2. Check the system for leaks |

The motor has a thermal overload protector. If the motor over-heats, the overload protector will shut the device off. When this occurs, turn the ON/OFF switch OFF and allow the motor to cool down for approximately 5 minutes. If the device fails to start after 5 minutes, wait an additional 5 minutes before attempting to restart. If the motor still will not start, inspect the fuses. If the device still will not start, call a licensed medical equipment technician for further instruction.

SPECIFICATIONS/CLASSIFICATIONS

| | |
|---------------------------------------|---|
| Maximum Vacuum | 560 ± 3% mmHg |
| Flow Range | > 40 LPM |
| Sound Level | <58 dBA |
| Electrical Requirements | AC 115 V \sim 60Hz |
| Power Consumption | 70 watts |
| Bacteria Filter Pore Size | 0.45 microns |
| Suction Canister Capacity | 800 ml (cc) |
| Operating Temperature | 32° ~ 104°F (0° ~ 40°C) |
| Operating Humidity | 95% RH |
| Operating Atmospheric Pressure | 10.2 ~ 15.4 psig (70 ~ 106 kpa) |
| Storage Temperature | 14° ~ 158°F (-10° ~ 70°C) |
| Storage Humidity | 0 ~ 95% |
| Storage Atmospheric Pressure | 7.3 ~ 15.4psig (50 ~ 106 kpa) |
| Fuse Specification | Miniature Glass Fuse 5x20mm, Fast Blow (Quick Acting), F2A/250 V |

TWO-YEAR LIMITED WARRANTY

Your Dynarex Product is warranted to be free of defects in materials and workmanship for two (2) years from original date of purchase, for the original purchaser. This item was built to exacting standards and carefully inspected prior to shipment. This Warranty is an expression of our confidence in the materials and workmanship of our products and our assurance to the consumer of years of dependable service.

The Warranty shall not apply under the following conditions:

- Problems arising from normal wear
- Problems arising from failure to adhere to the product instructions
- Problems arising from misuse, negligence, accident or improper operation, maintenance or storage
- Problems arising from modifications or unauthorized repairs, parts or attachments
- Products where the serial number has been removed or defaced

- Problems with non-durable components, such as rubber accessories, casters, and grips, which are subject to normal wear and need periodic replacement

Dynarex shall not be liable for any consequential or incidental damages whatsoever. Dynarex shall repair or replace defective products at its option. The foregoing warranty is exclusive and in lieu of other express warranties, if any, including the implied warranties of merchantability and fitness of a particular purpose. The remedy for any violation of the implied warranty shall be limited to repair or replacement of the defective product pursuant to the terms contained herein.

If you have a question about your Dynarex device or this warranty, please contact an authorized Dynarex dealer.